

300 mm
200
100
50
10 mm

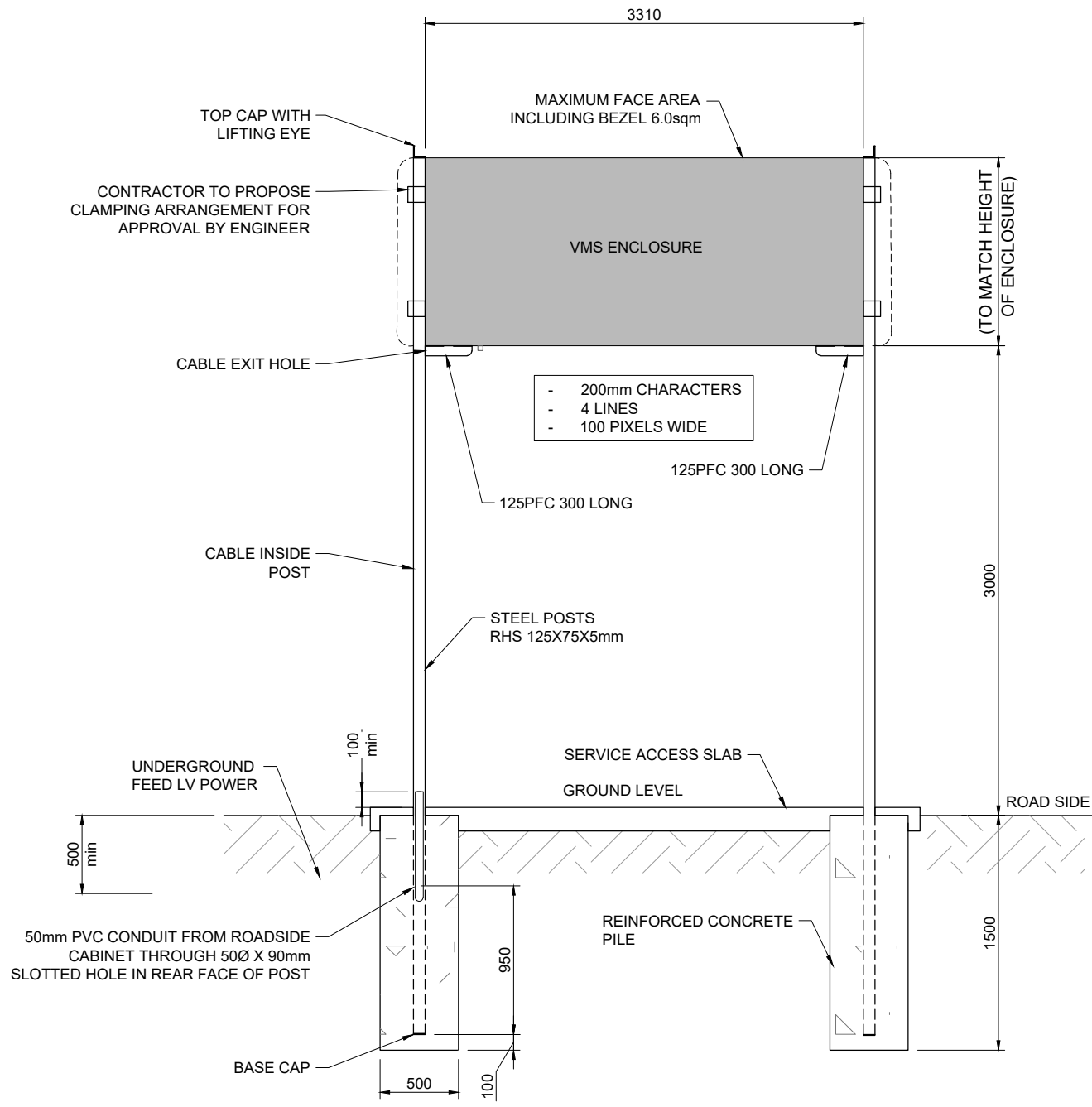

STANDARD DESIGN RURAL SIGN TYPE C
SCALE: 1:20 (A1) 1:40 (A3)

DESIGN CRITERIA

1. SITE DESIGN WIND SPEED ≤ 49 M/S (IN ACCORDANCE WITH AS/NZS 1170.2:2002 CLAUSE 2.2)
2. FOUNDATION MATERIAL TO BE IN ACCORDANCE WITH VMS SPECIFICATION NOTES
3. THIS SIGN IS SUITABLE FOR USE OUTSIDE THE CLEAR ZONE OR BEHIND A PROTECTIVE BARRIER OR IN A CLEAR ZONE IF SPEED ENVIRONMENT IS < 70 KM/H
4. USE TYPE A/B JIG TO ACHIEVE PRECISE INSIDE MEASUREMENT BETWEEN THE SUPPORT POSTS.
5. REFER TO SHEET 79 FOR SPECIFICATION NOTES.

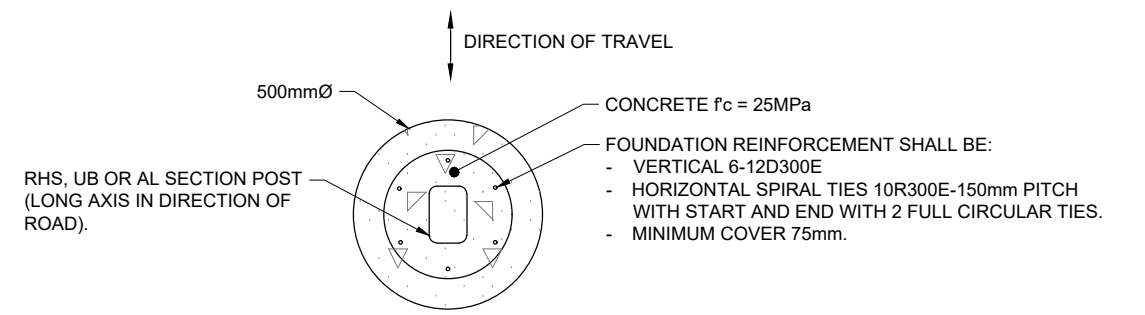

CONCRETE CYLINDER POST FOUNDATION TYPICAL CROSS SECTION
SCALE: 1:10 (A1) 1:20 (A3)

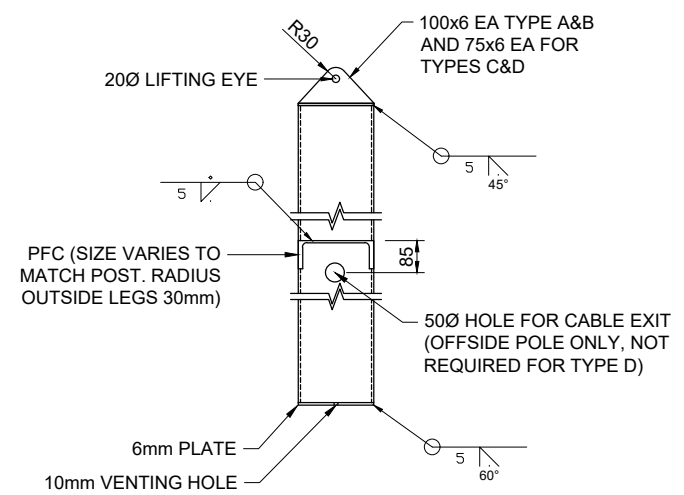

RHS POST BASE, SUPPORT & TOP CAP DETAILS
SCALE: 1:10 (A1) 1:20 (A3)

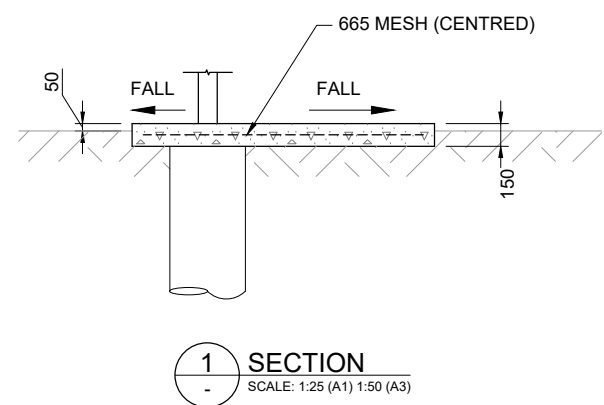

SECTION 1
SCALE: 1:25 (A1) 1:50 (A3)

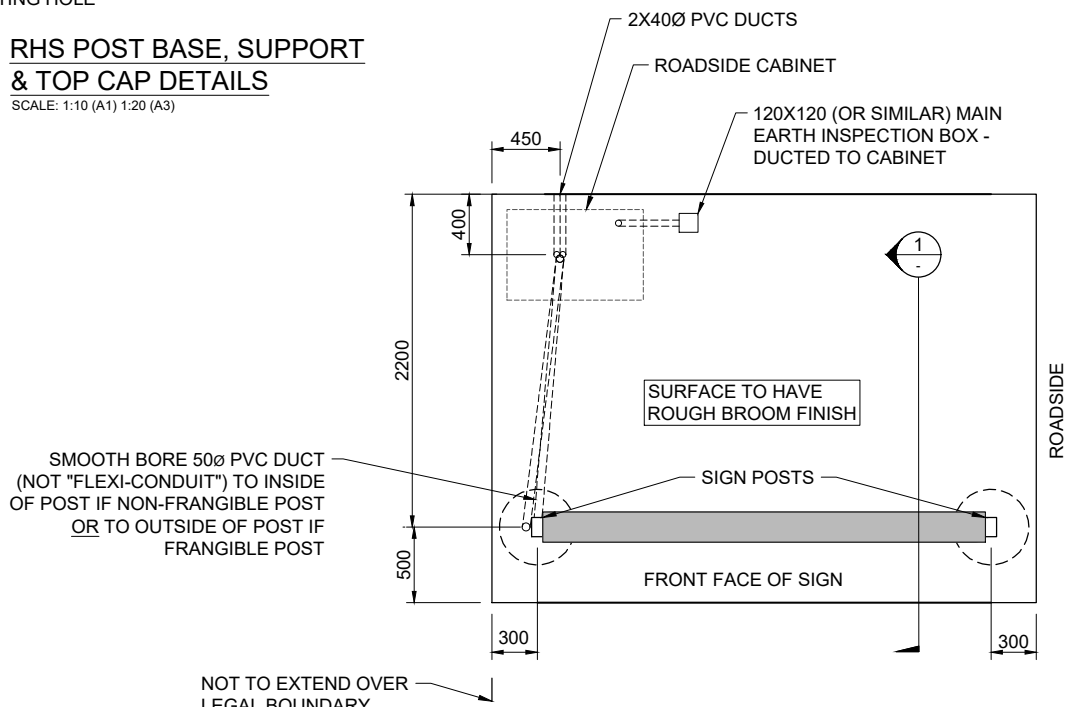

TYPICAL SERVICE ACCESS SLAB
SCALE: 1:25 (A1) 1:50 (A3)

DISCLAIMER: SEE SHEET 000-0000-0-7104-00

NO.	REVISION	DATE	BY	CHECKED	DATE
			DESIGN	N. GARNETT	11/10
			DRAWN	M. J.	11/10
			REC'D	T. L. HARRIS	10/06/18
			APPROVED	P. ROONEY	6/18
R1	ADOPTED FROM 6/1277/41/7604/5R6 AND 7R9	10/06/18	TLH		
	AMENDMENT	APP'D DATE			



WSP | OPUS
Auckland Office
+64 9 355 9500
PO BOX 5848
AUCKLAND 1141
New Zealand

TITLE		NZ TRANSPORT AGENCY INTELLIGENT TRANSPORT SYSTEMS STANDARD			
RURAL TYPE C VMS DUAL POST SUPPORT STRUCTURE					
STATUS	STANDARD	FILE	000-0000-0-7104-77-R1		
SCALE	AS SHOWN	PLOT DATE	15/06/18 @ 10:20	FEATURE IDENTIFIER	1/1061/370
		CODE	7104	SHEET	77
		REVISION			R1