

NOTE:  
EACH ADJUSTING BOLT TO BE  
FITTED WITH TWO NUTS AND  
TWO SPRING WASHERS.

ADJUSTING BOLT  
1:2

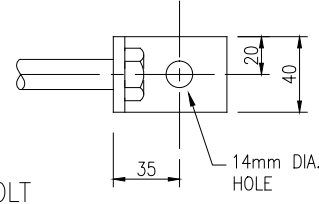

NOTE:  
GANTRY FRAME EX  
60x60x6mm M.S. ANGLE

GANTRY FRAME  
1:10

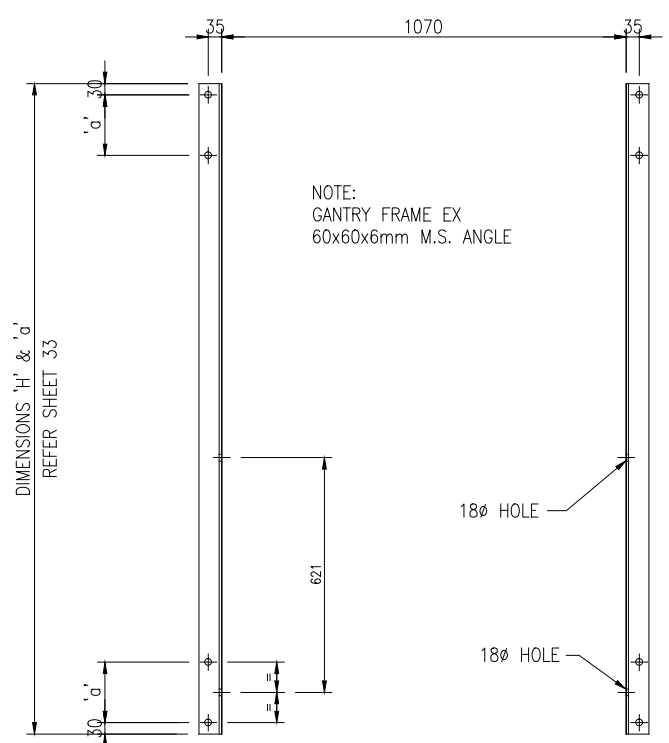
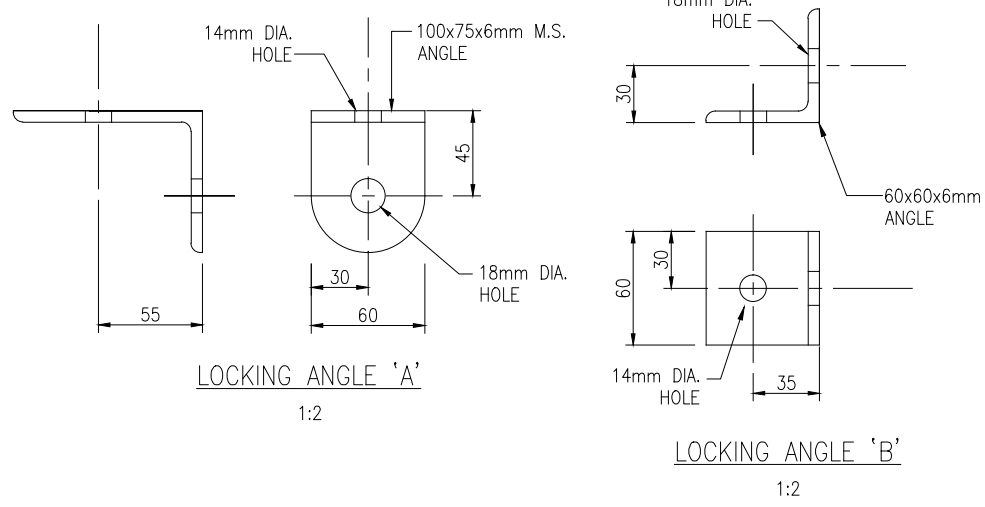

TABLE A-GANTRY SITES

GANTRY	BOLT LENGTH (mm)	ADJUSTMENT (mm)	
		L. H. 'x'	R. H. 'y'
TYPICAL STRAIGHT	120	61	61
TYPICAL ON CURVE LANE 1	180	35	87
LANE 2		9	113
LANE 3		36	140
LANE 4		36	140



- NOTES
- ALL WELDS TO BE 6mm CONTINUOUS FILLET WELDS EXCEPT WHERE SEAL WELDS MUST BE USED.
  - ALL BOLTS TO BE HOT DIP GALVANISED MILD STEEL. SPRING WASHERS TO BE USED UNDER ALL NUTS.
  - ALL STEELWORK INCLUDING NUTS, BOLTS AND WASHERS TO BE HOT-DIP GALVANISED AFTER FABRICATION IN ACCORDANCE WITH SPECIFICATION T-CES 306. VERTICAL ANGLES PAINTED MATT BLACK.
  - 'MATHOID' OR SIMILAR APPROVED GASKET MATERIAL MUST BE USED BETWEEN ALUMINIUM BACKING BOARDS AND ANY GALVANISED STEEL COMPONENTS.

DISCLAIMER: SEE SHEET 000-0000-0-7104-00

REV	DESCRIPTION	DATE	BY	CHECKED	DATE
R2	ITS STANDARDS UPDATE	5/6/15	TLH		
R1	OCTOBER 2014 UPDATE	14/10/14	TLH		
	AMENDMENT		APP'D	DATE	

APPROVED S.D HEWETT 8/11

This drawing and its contents are the property of Opus International Consultants Limited. Any unauthorised employment or reproduction, in full or in part, is forbidden.

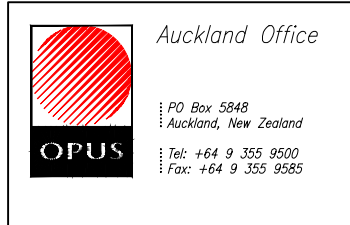

TITLE NEW ZEALAND TRANSPORT AGENCY INTELLIGENT TRANSPORT SYSTEMS STANDARD					
ADVISORY LANE SIGNALS SUPPORT DETAILS					
STATUS	STANDARD	FILE	000-0000-0-7104-63-R2		
SCALE	PLOT DATE	FEATURE IDENTIFIER	CODE	SHEET	REVISION
AS SHOWN	02/06/15 @ 14:32	1/1061/370	7104	63	R2