



Ahaura River Bridge replacement project



New Southern Road alignment

A BIG THANK YOU

We wish to take this opportunity to give a big thank you to the Ahaura community for your hospitality and patience during 2020, and to also wish you all a festive and safe Christmas.

During the year, the team has:

- › cleared and started investigating archaeological features within the project area
- › constructed bridge piles and columns with three bridge spans being installed
- › substantially constructed southern and northern approach embankments.

Please be aware that there are significant hazards on the construction site that will be present over the Christmas and New Year shutdown. Only authorised people are able to enter the site. If you have any concerns or notice anything unusual, please phone the emergency contact number at the bottom of page 2.

The new Southern Road alignment will stay open

- › Prior to the Christmas site shutdown the new southern alignment will be open to two lanes.
- › A 30km/h speed restriction will be in place – this is due to the temporary alignment over the shutdown period.
- › The temporary alignment will remain in place until the new bridge opens for traffic.
- › Your patience is appreciated – we ask all road users to follow the speed limit to ensure that the new chipseal surface remains in good condition.

The project team – Waka Kotahi, WSP, HEB Construction, Tru-Line and all the subcontractors working on the Ahaura Bridge Replacement – wish everyone a safe and festive Christmas and New Year. Stay safe on the roads.

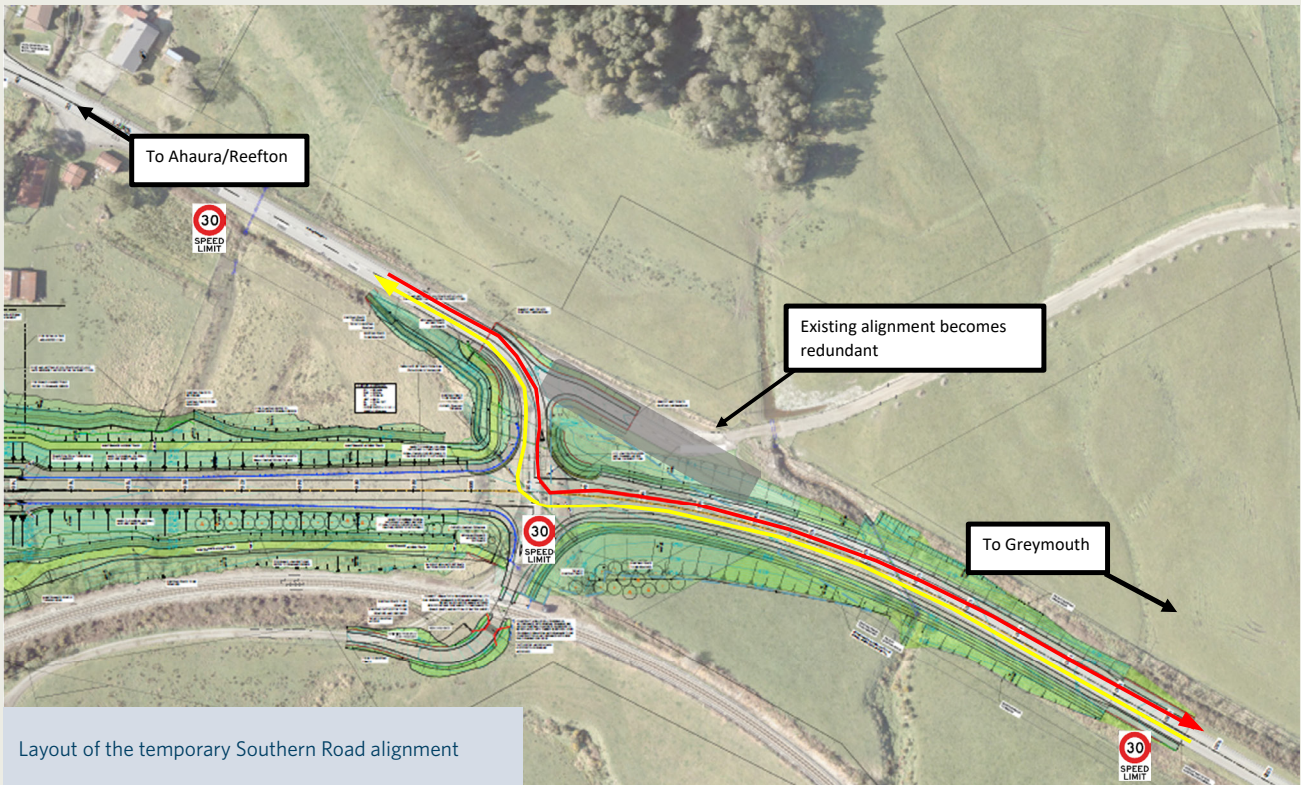

Layout of the temporary Southern Road alignment

Programme of works for 2021 includes Ahaura township

Our work in 2021 is going to see a shift to work that will have more impact within the township. We look forward to seeing more of you and working together to minimise disruption.

- › **January and February** - construction of new gabion basket retaining wall and progression of new kerb and footpath construction. These works will require a lane closure with temporary traffic management using traffic lights.



New bridge from north bank

- › **February and March** - new pavement construction will begin.

Our traffic management will change according to the work being undertaken. We are very grateful for your patience and especially your compliance with signage and speed restrictions during construction.

MORE INFORMATION



For more information on the SH7 Ahaura River Bridge replacement project, visit our website www.nzta.govt.nz/sh7-ahaura-river-bridge-replacement

Christmas shutdown period: the site will shut down on Wednesday 23 December 2020 and re-open on Tuesday 5 January 2021. During the shutdown period HEB's emergency contact number is **021 058 5255**.