

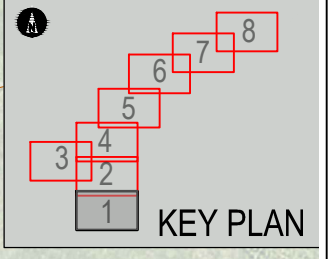

LEGEND	
EXISTING DESIGNATION BOUNDARY	DASHED BLUE LINE
EXISTING PROPERTY BOUNDARY	DASHED ORANGE LINE
CYCLE / FOOTPATH	SOLID YELLOW
TRAFFIC MEDIAN ISLAND	SOLID ORANGE
REGRADED DRIVEWAY	SOLID GREY
PROPOSED PAVEMENT WIDENING	SOLID LIGHT GREY
EARTHWORKS	BLUE LINE WITH TRIANGLES
PROPOSED CULVERT	BLUE LINE WITH CIRCLES
EXISTING CULVERT	BLACK AND WHITE DASHED
EXISTING CULVERT TO BE ABANDONED	RED AND WHITE DASHED



AERIAL IMAGERY SOURCED FROM THE LINZ DATA SERVICE  
 HTTPS://DATA.LINZ.GOV.NZ/LAYER/95497-AUCKLAND-0075M-URBAN-AERIAL-PHOTOS-2017/  
 AND LICENSED BY NORTHLAND AERIAL IMAGERY CONSORTIUM (NAIC) FOR RE-USE UNDER  
 THE CREATIVE COMMONS ATTRIBUTION 4.0 INTERNATIONAL LICENCE.

CLIENT		REV		DATE	REVISION DETAILS	APPROVED	SCALE	SIZE	FOR CONSTRUCTION	PROJECT	SAFE NETWORK PROGRAMME				
		1	2021-03-30	ISSUED FOR CONSTRUCTION	N.HOLMAN	1:250	A1	APPROVED DATE 2021-03-30 N.HOLMAN	PROJECT TITLE SH22 GLENBROOK ROAD INTERSECTION GENERAL ARRANGEMENT SHEET 1	DRAWING No. 508022 - AREA 0002 - TYPE DRG - RR - NUMBER 0101 - REV 1					
		0	2021-03-18	ISSUED FOR CONSTRUCTION	N.HOLMAN	DRAWN L.HODGSON DESIGNED P.NALIN REVIEWED G.CORIN									

LEGEND	
EXISTING DESIGNATION BOUNDARY	
EXISTING PROPERTY BOUNDARY	
CYCLE / FOOTPATH	
TRAFFIC MEDIAN ISLAND	
REGRADED DRIVEWAY	
PROPOSED PAVEMENT WIDENING	
EARTHWORKS	
PROPOSED CULVERT	
EXISTING CULVERT	
EXISTING CULVERT TO BE ABANDONED	

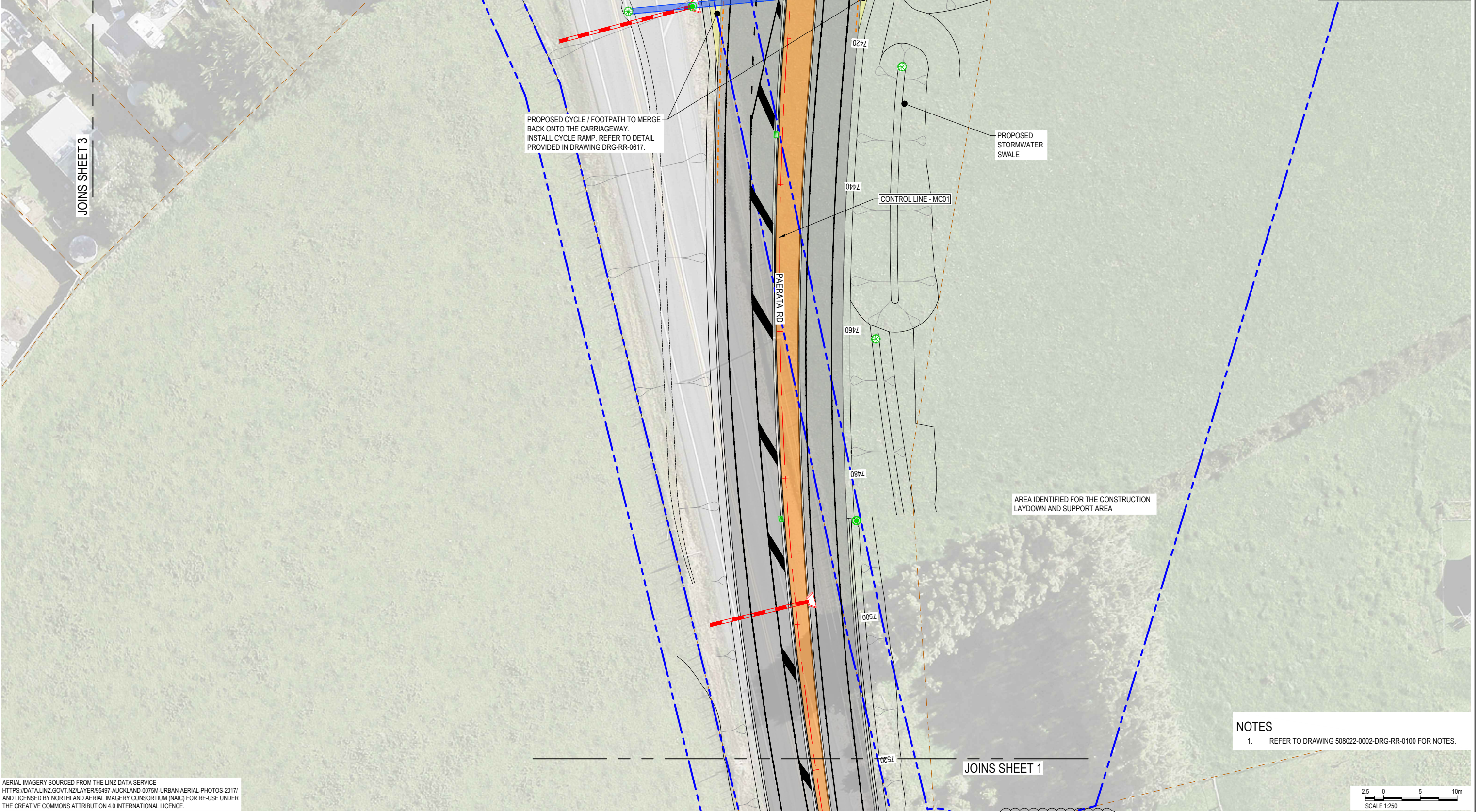
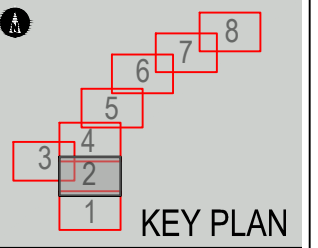

PROPOSED CYCLE / FOOTPATH TO MERGE BACK ONTO THE CARRIAGEWAY. INSTALL CYCLE RAMP. REFER TO DETAIL PROVIDED IN DRAWING DRG-RR-0617.

PROPOSED STORMWATER SWALE

CONTROL LINE - MC01

AREA IDENTIFIED FOR THE CONSTRUCTION LAYDOWN AND SUPPORT AREA

**NOTES**

- REFER TO DRAWING 508022-0002-DRG-RR-0100 FOR NOTES.

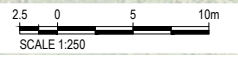

AERIAL IMAGERY SOURCED FROM THE LINZ DATA SERVICE  
 HTTPS://DATA.LINZ.GOV.NZ/LAYER/95497-AUCKLAND-0075M-URBAN-AERIAL-PHOTOS-2017/  
 AND LICENSED BY NORTHLAND AERIAL IMAGERY CONSORTIUM (NAIC) FOR RE-USE UNDER  
 THE CREATIVE COMMONS ATTRIBUTION 4.0 INTERNATIONAL LICENCE.

CLIENT



REV	DATE	REVISION DETAILS	APPROVED
1	2021-03-30	ISSUED FOR CONSTRUCTION	N.HOLMAN
0	2021-03-18	ISSUED FOR CONSTRUCTION	N.HOLMAN

SCALE	SIZE
1:250	A1
<b>DRAWN</b>	<b>APPROVED</b>
L.HODGSON	N.HOLMAN
<b>DESIGNED</b>	DATE
P.NALIN	2021-03-30
<b>REVIEWED</b>	
G.CORIN	

**FOR CONSTRUCTION**

APPROVED  
 N.HOLMAN

PROJECT	TITLE	DRAWING No.	PROJECT No.	AREA	TYPE	DISC	NUMBER	REV
SAFE NETWORK PROGRAMME	SH22 GLENBROOK ROAD INTERSECTION GENERAL ARRANGEMENT SHEET 2	508022	508022	0002	DRG	RR	0102	1



LEGEND	
EXISTING DESIGNATION BOUNDARY	DASHED BLUE LINE
EXISTING PROPERTY BOUNDARY	DASHED ORANGE LINE
CYCLE / FOOTPATH	SOLID YELLOW AREA
TRAFFIC MEDIAN ISLAND	SOLID ORANGE AREA
REGRADED DRIVEWAY	SOLID GREY AREA
PROPOSED PAVEMENT WIDENING	SOLID LIGHT GREY AREA
EARTHWORKS	BLUE LINE WITH TRIANGLES
PROPOSED CULVERT	BLUE LINE WITH CIRCLES
EXISTING CULVERT	BLACK LINE WITH CIRCLES
EXISTING CULVERT TO BE ABANDONED	RED DASHED LINE WITH CIRCLES

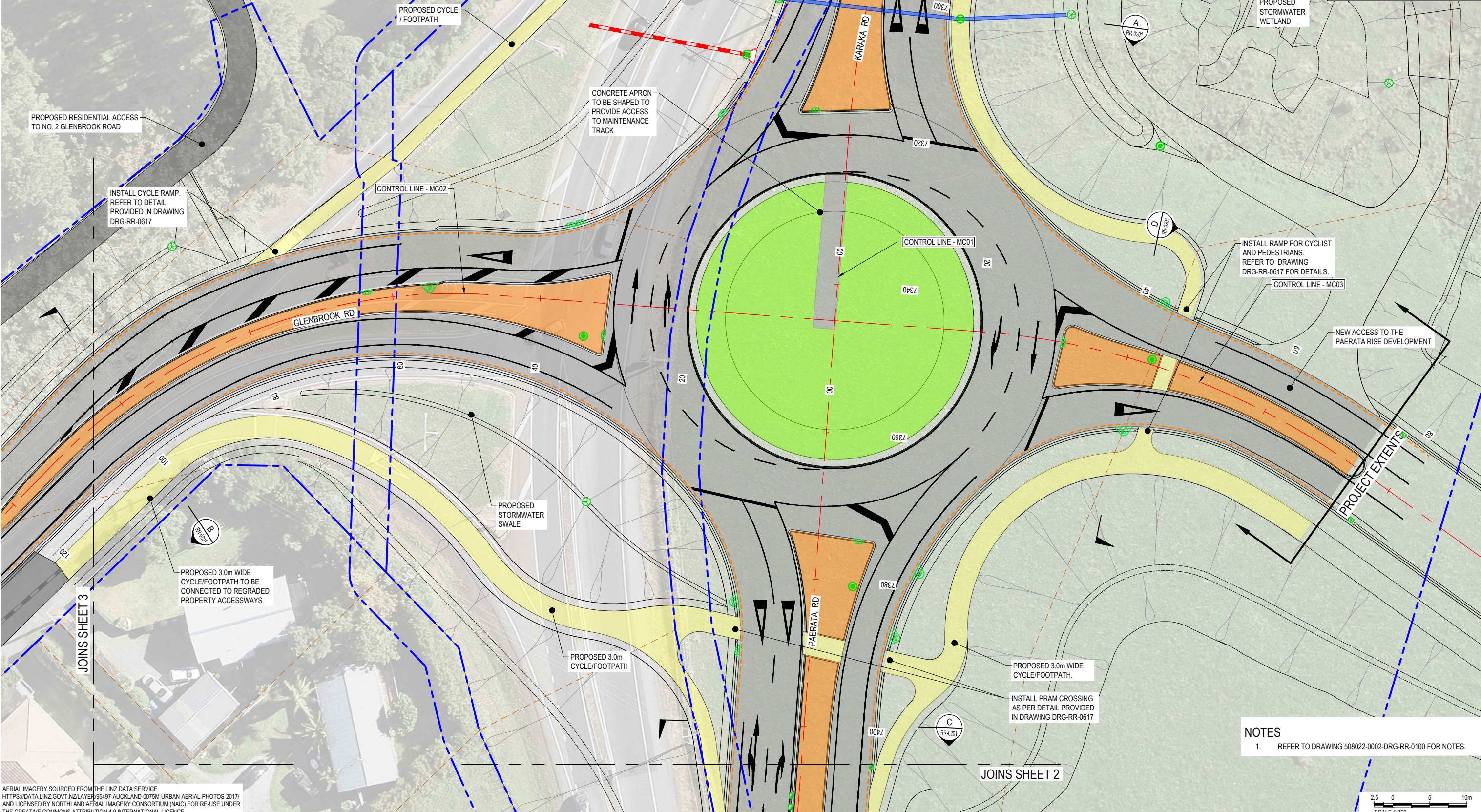
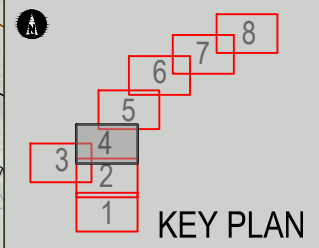

**NOTES**  
 1. REFER TO DRAWING 508022-0002-DRG-RR-0100 FOR NOTES.

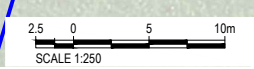

AERIAL IMAGERY SOURCED FROM THE LINZ DATA SERVICE  
[HTTPS://DATA.LINZ.GOVT.NZ/LAYERS/95497-AUCKLAND-0075M-URBAN-AERIAL-PHOTOS-2017/](https://data.linz.govt.nz/layers/95497-AUCKLAND-0075M-URBAN-AERIAL-PHOTOS-2017/)  
 AND LICENSED BY NORTHLAND AERIAL IMAGERY CONSORTIUM (NAIC) FOR RE-USE UNDER THE CREATIVE COMMONS ATTRIBUTION 4.0 INTERNATIONAL LICENCE.

CLIENT		REV		DATE	REVISION DETAILS	APPROVED	SCALE	SIZE	FOR CONSTRUCTION	PROJECT	SAFE NETWORK PROGRAMME						
WAKA KOTAHI NZ TRANSPORT AGENCY		1	2021-03-30	ISSUED FOR CONSTRUCTION	N.HOLMAN	1:250	A1	DRAWN L.HODGSON DESIGNED P.NALIN REVIEWED G.CORIN		APPROVED	DATE	SH22 GLENBROOK ROAD INTERSECTION GENERAL ARRANGEMENT SHEET 4					
		0	2021-03-18	ISSUED FOR CONSTRUCTION	N.HOLMAN						2021-03-30	DRAWING No.	PROJECT No.	AREA	TYPE	DISC	NUMBER
									N.HOLMAN		508022	0002	DRG	RR	0104	1	

File: \\server\projects\508022-0002-DRG-RR-0100\Drawings\02-0002-DRG-RR-0100.dwg  
 Plot Date: 2021-03-30 11:56:00  
 Office: Tauranga  
 Filename: p:\design\508022-0002-DRG-RR-0100.dwg  
 AUDIT: 01\Documents\Projects\508022-0002-DRG-RR-0100\Drawings\02-0002-DRG-RR-0100.dwg  
 Safe Network Programme  
 Drawing: 02-0002-DRG-RR-0100.dwg

LEGEND	
EXISTING DESIGNATION BOUNDARY	DASHED BLUE LINE
EXISTING PROPERTY BOUNDARY	DASHED ORANGE LINE
CYCLE / FOOTPATH	SOLID YELLOW
TRAFFIC MEDIAN ISLAND	SOLID ORANGE
REGRADED DRIVEWAY	SOLID GREY
PROPOSED PAVEMENT WIDENING	SOLID LIGHT GREY
EARTHWORKS	BLUE LINE WITH TRIANGLES
PROPOSED CULVERT	BLUE LINE WITH CIRCLES
EXISTING CULVERT	BLACK LINE WITH CIRCLES
EXISTING CULVERT TO BE ABANDONED	RED AND WHITE DASHED LINE

JOINS SHEET 6

KEY PLAN

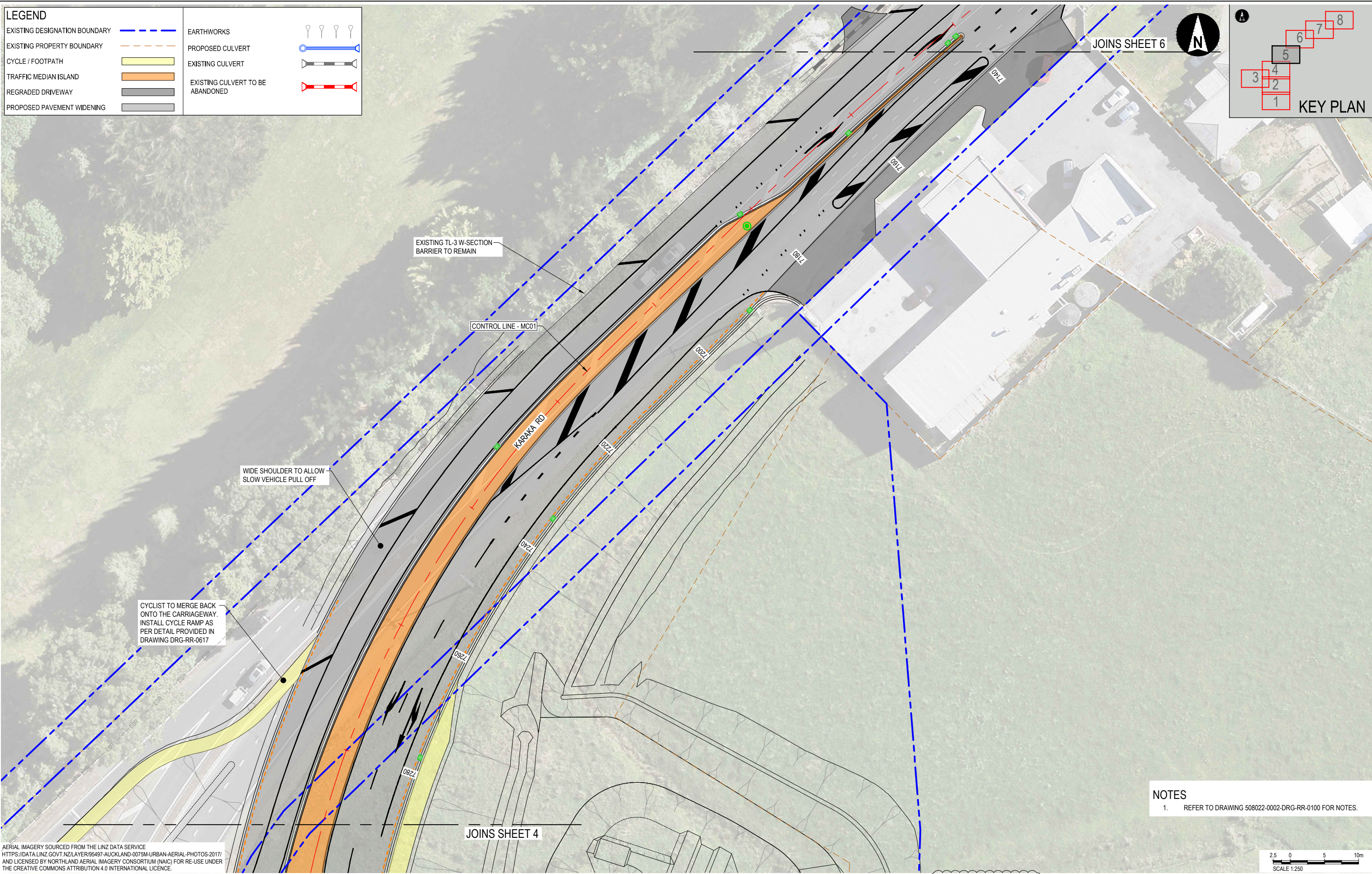

**NOTES**  
 1. REFER TO DRAWING 508022-0002-DRG-RR-0100 FOR NOTES.

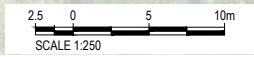

AERIAL IMAGERY SOURCED FROM THE LINZ DATA SERVICE  
[HTTPS://DATA.LINZ.GOVT.NZ/LAYER/95497-AUCKLAND-0075M-URBAN-AERIAL-PHOTOS-2017](https://data.linz.govt.nz/layer/95497-auckland-0075m-urban-aerial-photos-2017)  
 AND LICENSED BY NORTHLAND AERIAL IMAGERY CONSORTIUM (NAIC) FOR RE-USE UNDER THE CREATIVE COMMONS ATTRIBUTION 4.0 INTERNATIONAL LICENCE.

<b>CLIENT</b>		<b>REV</b>		<b>DATE</b>	<b>REVISION DETAILS</b>	<b>APPROVED</b>	<b>SCALE</b>	<b>SIZE</b>	<b>FOR CONSTRUCTION</b>	<b>PROJECT</b>	<b>SAFE NETWORK PROGRAMME</b>										
WAKA KOTAHI NZ TRANSPORT AGENCY		1	2021-03-30	ISSUED FOR CONSTRUCTION	N.HOLMAN	1:250	A1	<b>DRAWN</b> L.HODGSON <b>DESIGNED</b> P.NALIN <b>REVIEWED</b> G.CORIN		<b>APPROVED</b> DATE 2021-03-30 N.HOLMAN	<b>TITLE</b>	SH22 GLENBROOK ROAD INTERSECTION GENERAL ARRANGEMENT SHEET 5									
		0	2021-03-18	ISSUED FOR CONSTRUCTION	N.HOLMAN							<b>DRAWING No.</b>	508022	<b>AREA</b>	0002	<b>TYPE</b>	DRG	<b>DISC</b>	RR	<b>NUMBER</b>	0105

File: \\server\projects\508022\508022-0002-DRG-RR-0100.dwg  
 Plot Date: 2021-03-30 11:57:00  
 Client: Waka Kotahi  
 Project: SH22 Glenbrook Rd Intersection  
 Drawing: 508022-0002-DRG-RR-0100.dwg  
 Scale: 1:250  
 Author: P. Nalin  
 Designer: P. Nalin  
 Checker: G. Corin  
 Approver: N. Holman  
 Date: 2021-03-30







LEGEND	
EXISTING DESIGNATION BOUNDARY	
EXISTING PROPERTY BOUNDARY	
CYCLE / FOOTPATH	
TRAFFIC MEDIAN ISLAND	
REGRADED DRIVEWAY	
PROPOSED PAVEMENT WIDENING	
EARTHWORKS	
PROPOSED CULVERT	
EXISTING CULVERT	
EXISTING CULVERT TO BE ABANDONED	

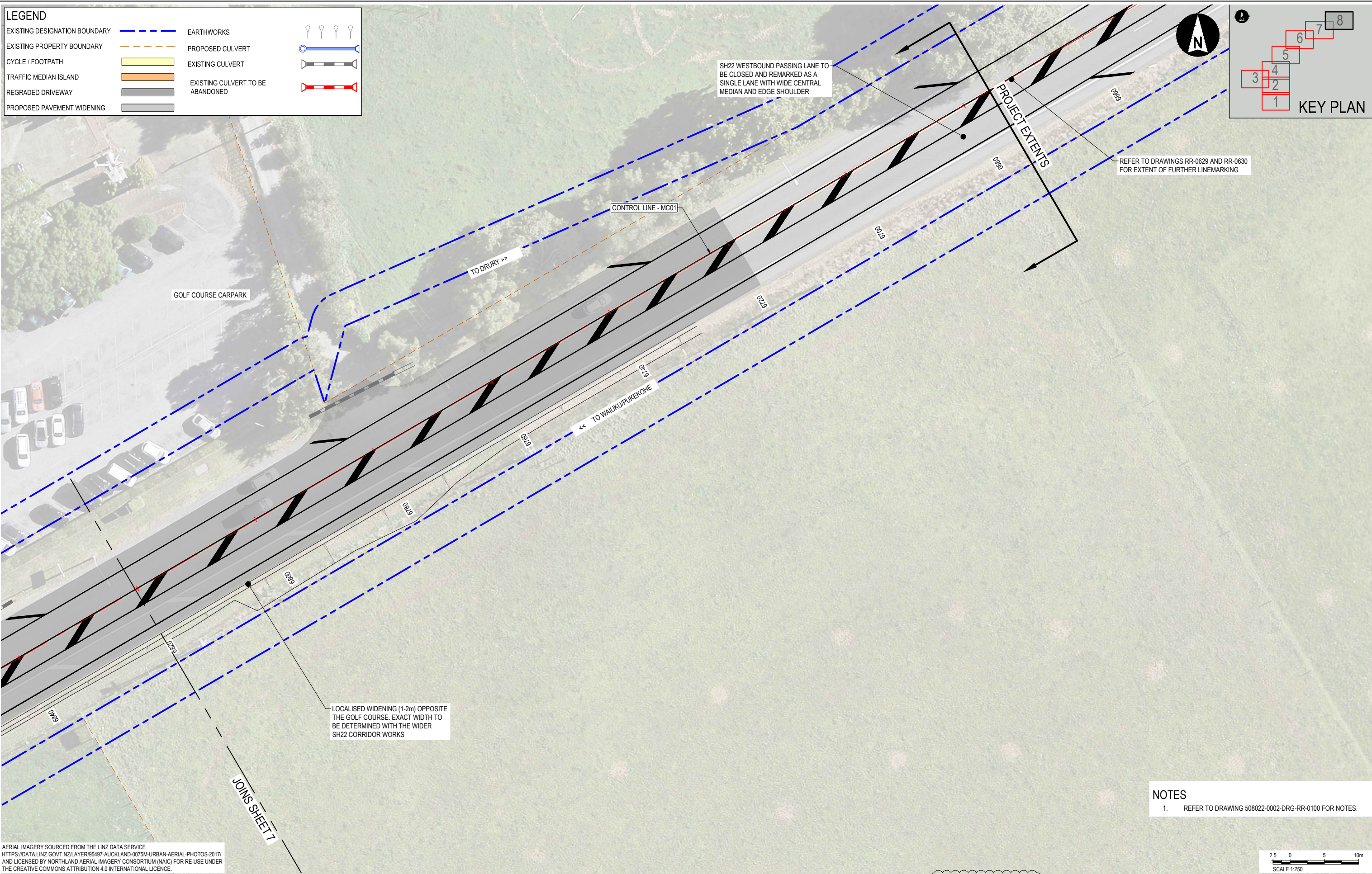
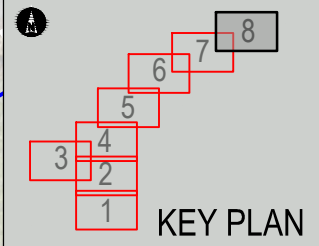

**NOTES**  
 1. REFER TO DRAWING 508022-0002-DRG-RR-0100 FOR NOTES.

AERIAL IMAGERY SOURCED FROM THE LINZ DATA SERVICE  
 HTTPS://DATA.LINZ.GOVT.NZ/LAYER/95497-AUCKLAND-0075M-URBAN-AERIAL-PHOTOS-2017/  
 AND LICENSED BY NORTHLAND AERIAL IMAGERY CONSORTIUM (NAIC) FOR RE-USE UNDER  
 THE CREATIVE COMMONS ATTRIBUTION 4.0 INTERNATIONAL LICENCE.

<b>CLIENT</b>		<b>WAKA KOTAHU</b> NZ TRANSPORT AGENCY	
<b>REV</b>	<b>DATE</b>	<b>REVISION DETAILS</b>	<b>APPROVED</b>
1	2021-03-30	ISSUED FOR CONSTRUCTION	N.HOLMAN
0	2021-03-18	ISSUED FOR CONSTRUCTION	N.HOLMAN
		<b>SCALE</b>	<b>SIZE</b>
		1:250	A1
		<b>DRAWN</b>	<b>APPROVED</b>
		L.HODGSON	N.HOLMAN
		<b>DESIGNED</b>	<b>DATE</b>
		P.NALIN	2021-03-30
		<b>REVIEWED</b>	<b>DATE</b>
		G.CORIN	
		<b>FOR CONSTRUCTION</b>	
		<b>PROJECT</b>	SAFE NETWORK PROGRAMME
		<b>TITLE</b>	SH22 GLENBROOK ROAD INTERSECTION GENERAL ARRANGEMENT SHEET 8
<b>DRAWING No.</b>	<b>PROJECT No.</b>	<b>AREA</b>	<b>TYPE</b>
508022	0002	DRG	RR
<b>NUMBER</b>	<b>REV</b>	<b>DISC</b>	<b>NUMBER</b>
0108	1		