

LONGITUDINAL SECTION - MAIN ALIGNMENT
 SCALE HORIZ = 1:5000 VERT = 1:1000

CHAINAGE 1700 TO 3400

NOTES:

Original Scale (A3)

Revision	Amendment	NRN	Date
1	AEE LODGEMENT	NRN	15.03.12



Project: MACKAYS TO PEKA PEKA EXPRESSWAY	
Title: PROPOSED EXPRESSWAY LONGITUDINAL SECTION SHEET 1 OF 6	
Status: - FOR CONSENTING	Rev.
Document ID: M2PP-AEE-DWG	1
Drawing No: CV-GP-101	

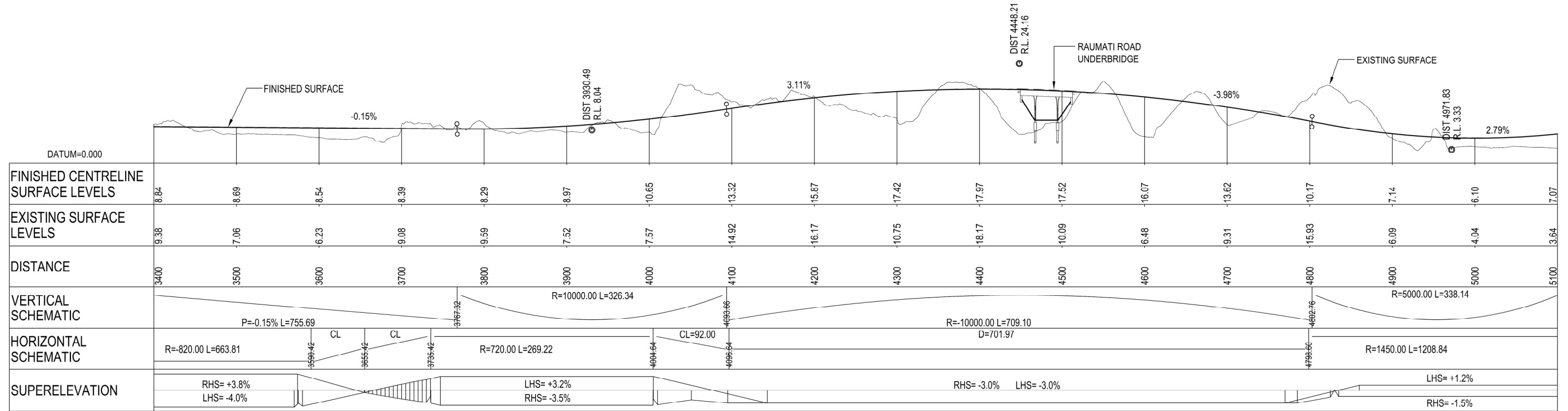

LONGITUDINAL SECTION - MAIN ALIGNMENT

CHAINAGE 3400 TO 5100

SCALE HORIZ = 1:5000 VERT = 1:1000

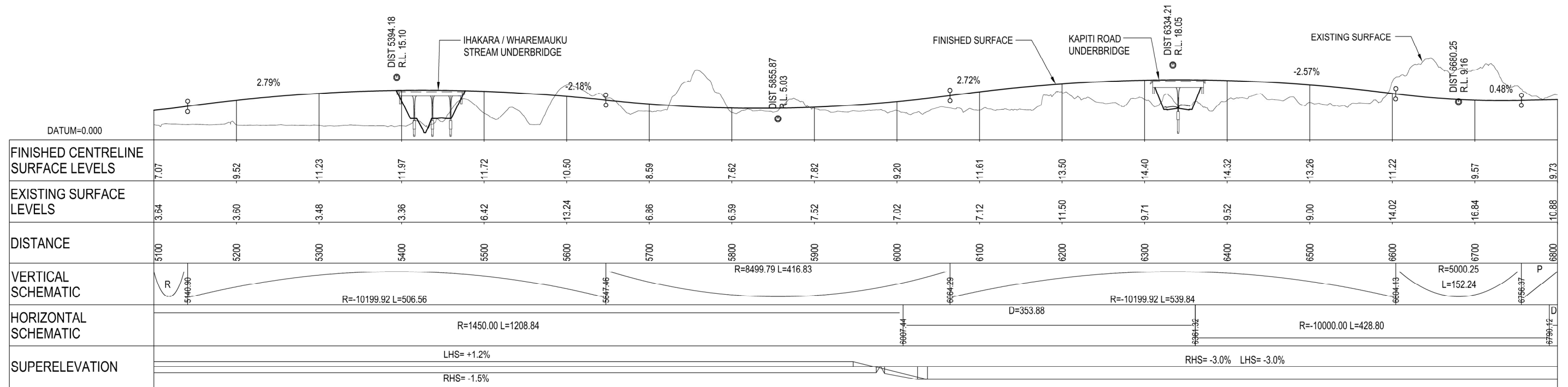

LONGITUDINAL SECTION - MAIN ALIGNMENT

CHAINAGE 5100 TO 6800

SCALE HORIZ = 1:5000 VERT = 1:1000

NOTES:

Original Scale (A3)

1	AEE LODGEMENT	NRN	15.03.12
Revision:	Amendment	Approved:	Date:



MACKAYS TO PEKA PEKA EXPRESSWAY

PROPOSED EXPRESSWAY LONGITUDINAL SECTION SHEET 2 OF 6

Status: FOR CONSENTING

Document ID: M2PP-AEE-DWG Rev: 1

Drawing No: CV-GP-102

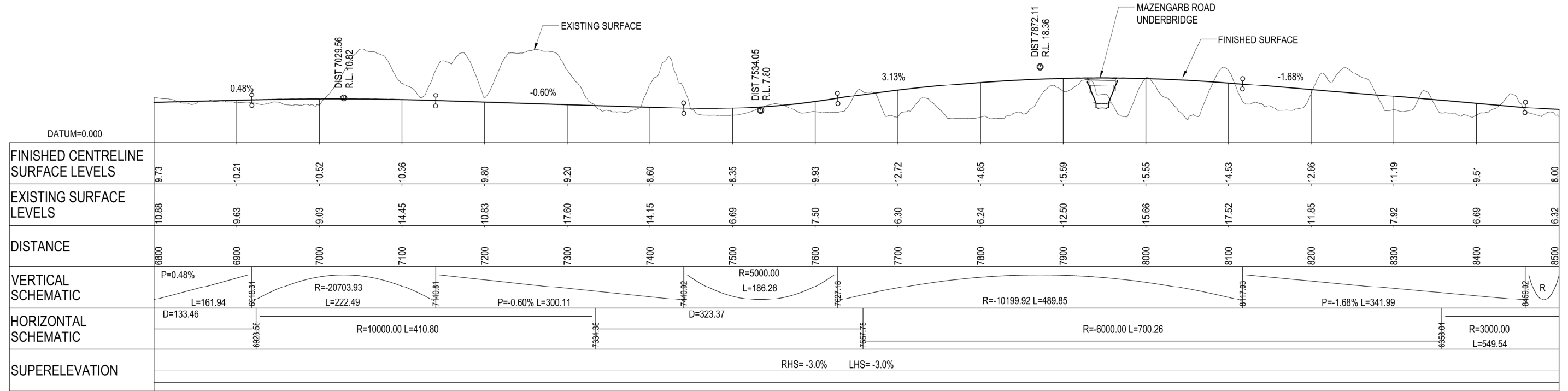

LONGITUDINAL SECTION - MAIN ALIGNMENT

CHAINAGE 6800 TO 8500

SCALE HORIZ = 1:5000 VERT = 1:1000

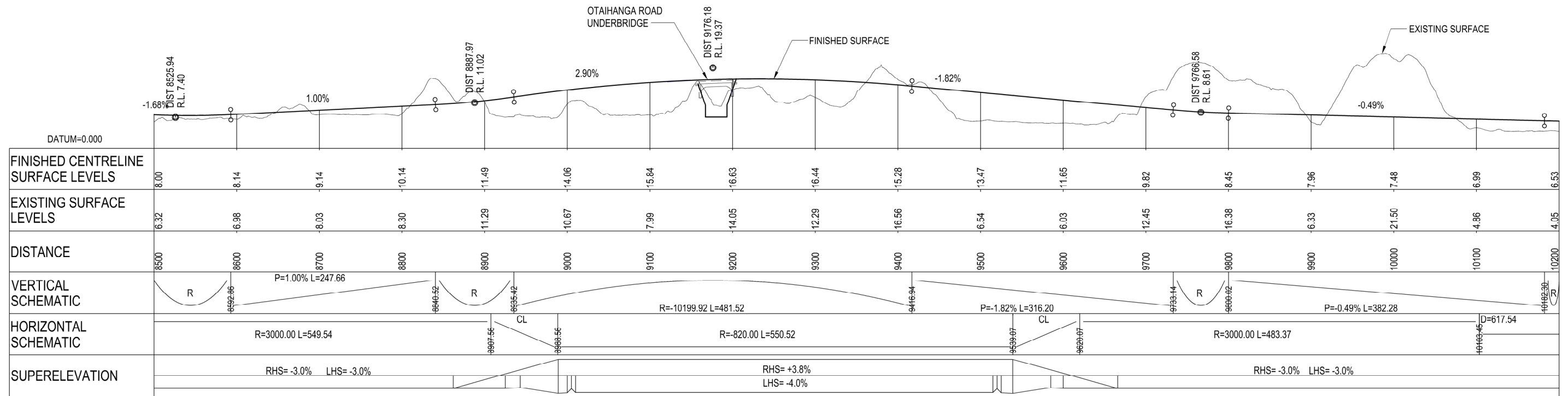

LONGITUDINAL SECTION - MAIN ALIGNMENT

CHAINAGE 8500 TO 10200

SCALE HORIZ = 1:5000 VERT = 1:1000

NOTES:
Original Scale (A3)

1	AEE LODGEMENT	NRN	15.03.12
Revision:	Amendment	Approved:	Date



Project: MACKAYS TO PEKA PEKA EXPRESSWAY	
Title: PROPOSED EXPRESSWAY LONGITUDINAL SECTION SHEET 3 OF 6	
Status: FOR CONSENTING	Rev: 1
Document ID: M2PP-AEE-DWG	Rev: 1
Drawing No: CV-GP-103	1

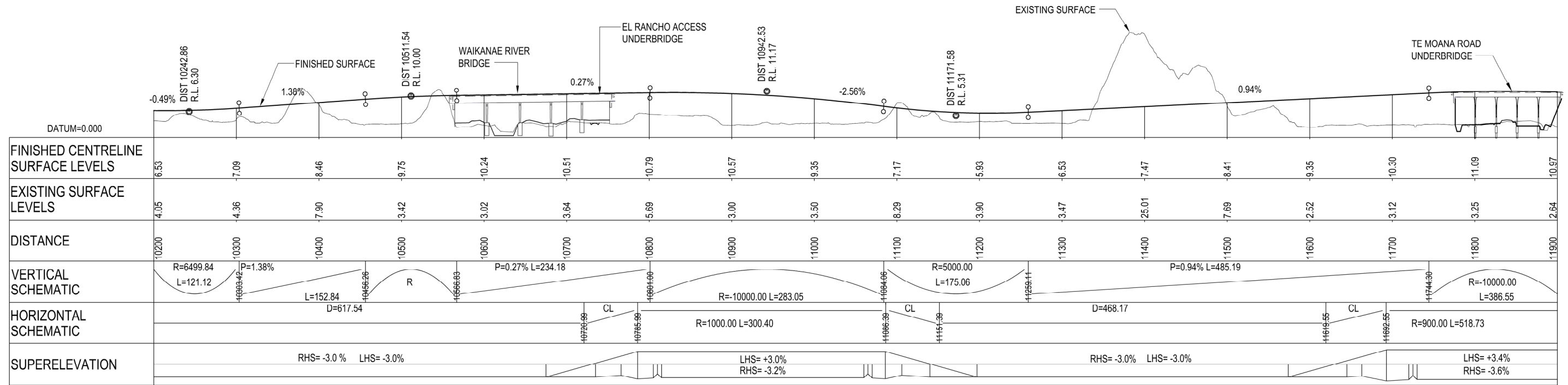

LONGITUDINAL SECTION - MAIN ALIGNMENT

CHAINAGE 10200 TO 11900

SCALE HORIZ = 1:5000 VERT = 1:1000

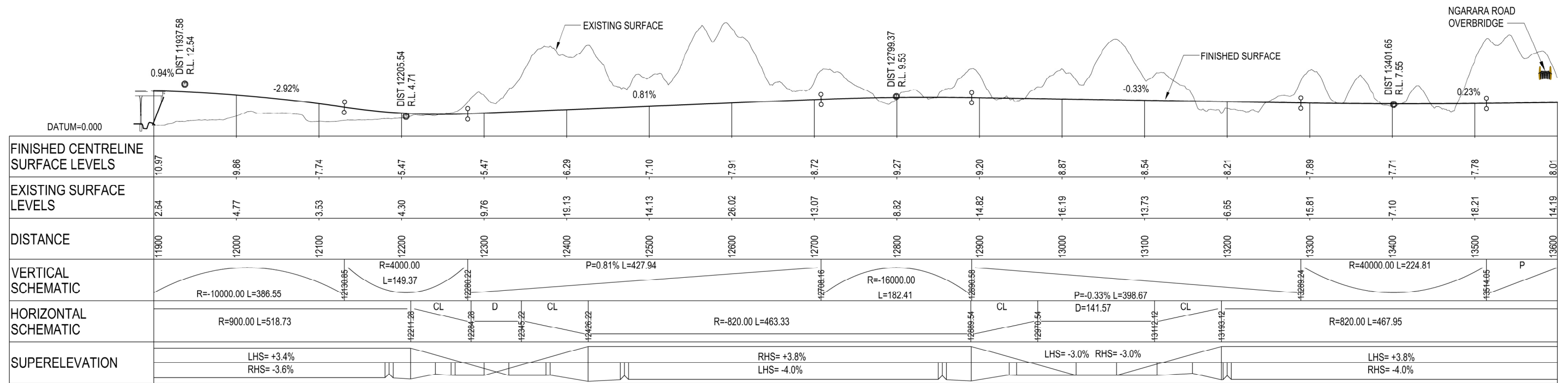

LONGITUDINAL SECTION - MAIN ALIGNMENT

CHAINAGE 11900 TO 13600

SCALE HORIZ = 1:5000 VERT = 1:1000

NOTES:	Original Scale (A3)
--------	---------------------

1	AEE LODGEMENT	NRN	15.03.12
Revision:	Amendment	Approved:	Date:



MACKAYS TO PEKA PEKA EXPRESSWAY

PROPOSED EXPRESSWAY LONGITUDINAL SECTION SHEET 4 OF 6

Status: FOR CONSENTING

Document ID: M2PP-AEE-DWG Rev. 1

Drawing No: CV-GP-104

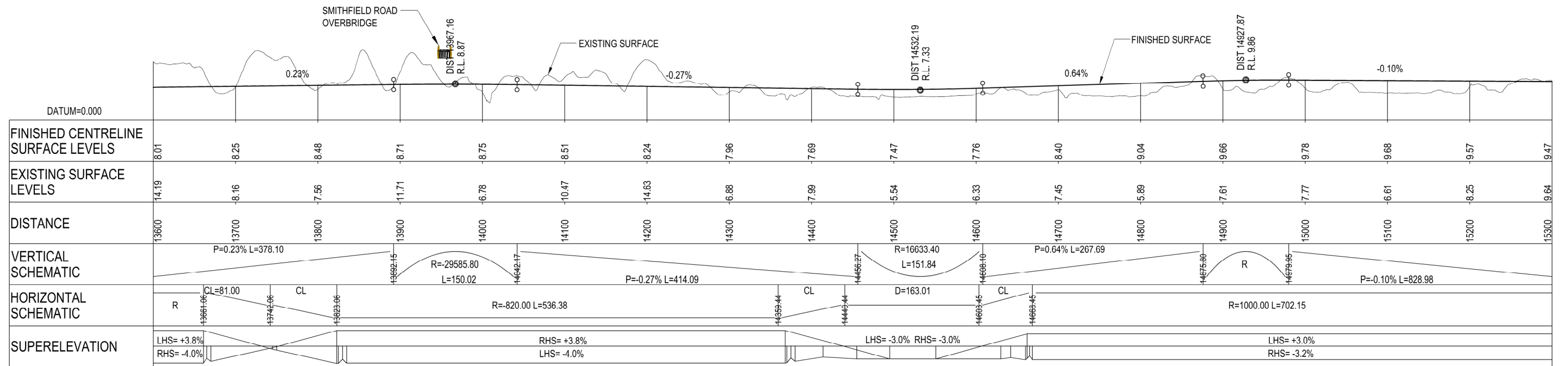

LONGITUDINAL SECTION - MAIN ALIGNMENT

CHAINAGE 13600 TO 15300

SCALE HORIZ = 1:5000 VERT = 1:1000

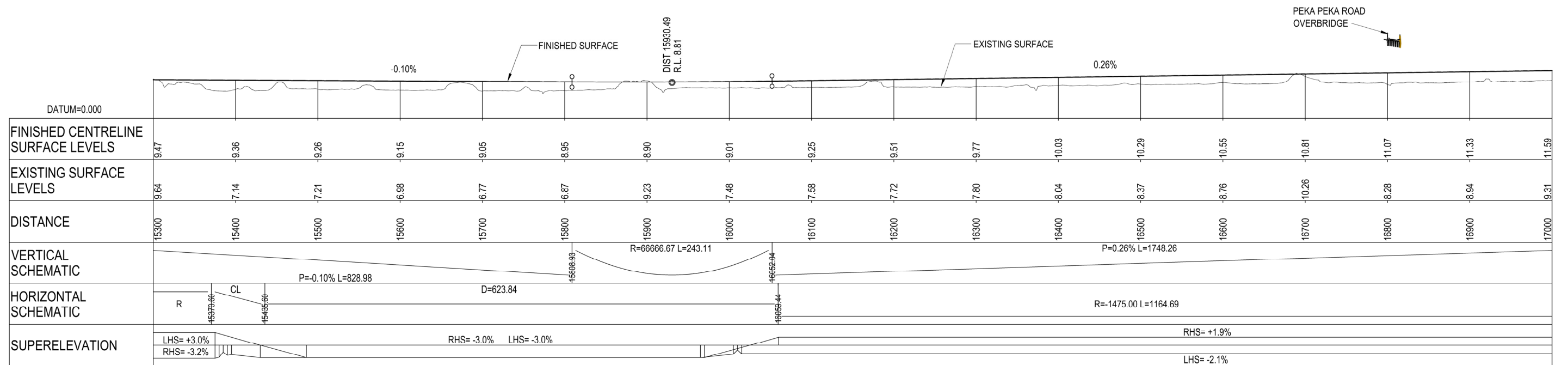

LONGITUDINAL SECTION - MAIN ALIGNMENT

CHAINAGE 15300 TO 17000

SCALE HORIZ = 1:5000 VERT = 1:1000

NOTES:

Original Scale (A3)

1	AEE LODGEMENT	NRN	15.03.12
Revision	Amendment	Approved	Date



Project: **MACKAYS TO PEKA PEKA EXPRESSWAY**

Title: **PROPOSED EXPRESSWAY LONGITUDINAL SECTION SHEET 5 OF 6**

Status: FOR CONSENTING

Document ID: M2PP-AEE-DWG Rev. 1

Drawing No: **CV-GP-105**

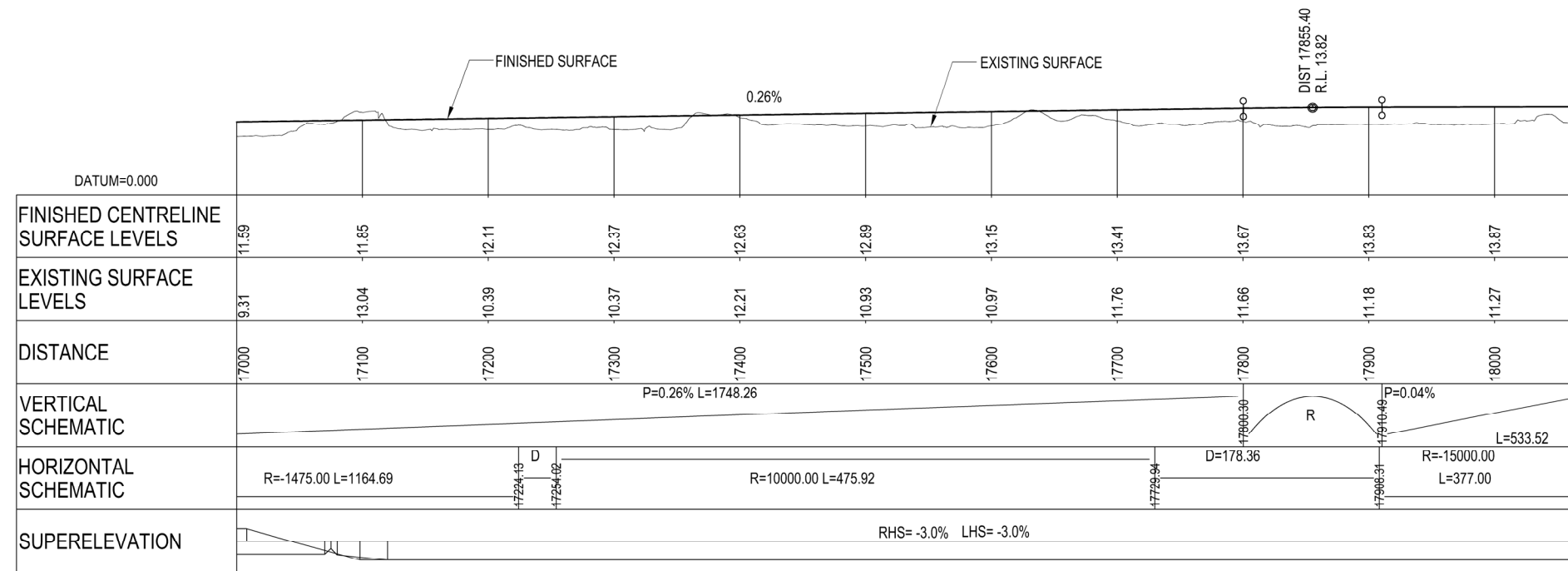

LONGITUDINAL SECTION - MAIN ALIGNMENT

CHAINAGE 17000 TO 18073

SCALE HORIZ = 1:5000 VERT = 1:1000

NOTES:

Original Scale (A3)

Revision	Amendment	Approved	Date
1	AEE LODGEMENT	NRN	15.03.12



Project: **MACKAYS TO PEKA PEKA EXPRESSWAY**

Title: **PROPOSED EXPRESSWAY LONGITUDINAL SECTION SHEET 6 OF 6**

Status: FOR CONSENTING

Document ID: M2PP-AEE-DWG

Drawing No: **CV-GP-106**

Rev: 1

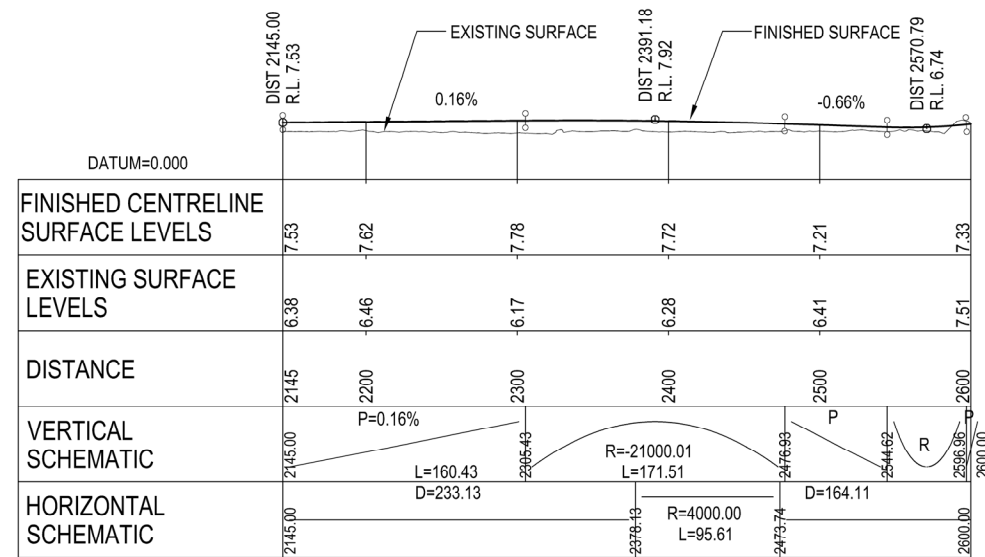

LONGITUDINAL SECTION - NORTH BOUND OFF RAMP

SCALE HORIZ = 1:5000 VERT = 1:1000

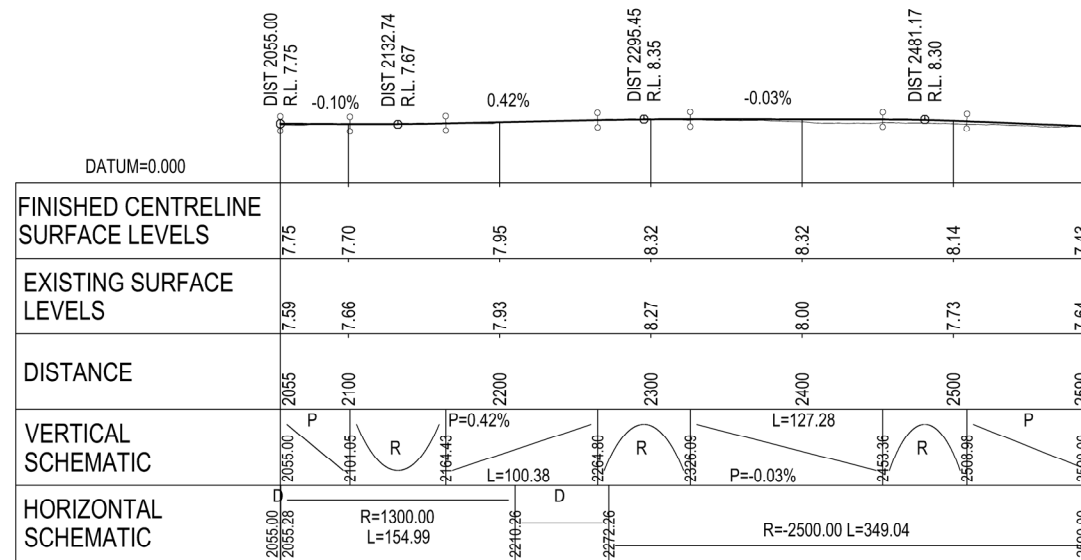

LONGITUDINAL SECTION - SOUTH BOUND ON RAMP

SCALE HORIZ = 1:5000 VERT = 1:1000

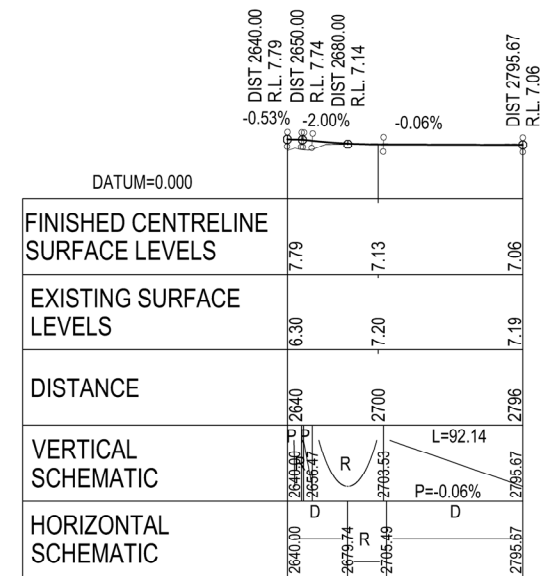

LONGITUDINAL SECTION - EXISTING SH1 TIE - IN RAMP

SCALE HORIZ = 1:5000 VERT = 1:1000

NOTES:

Original Scale (A3)		
1 AEE LODGEMENT	NRN	15.03.12
Revision: Amendment	Approved:	Date:



Project: MACKAYS TO PEKA PEKA EXPRESSWAY	
Title: POPLAR AVENUE INTERCHANGE LONGITUDINAL SECTION ON RAMPS & OFF RAMPS	
Status: FOR CONSENTING	Rev: 1
Document ID: M2PP-AEE-DWG	Drawing No: CV-GP-120

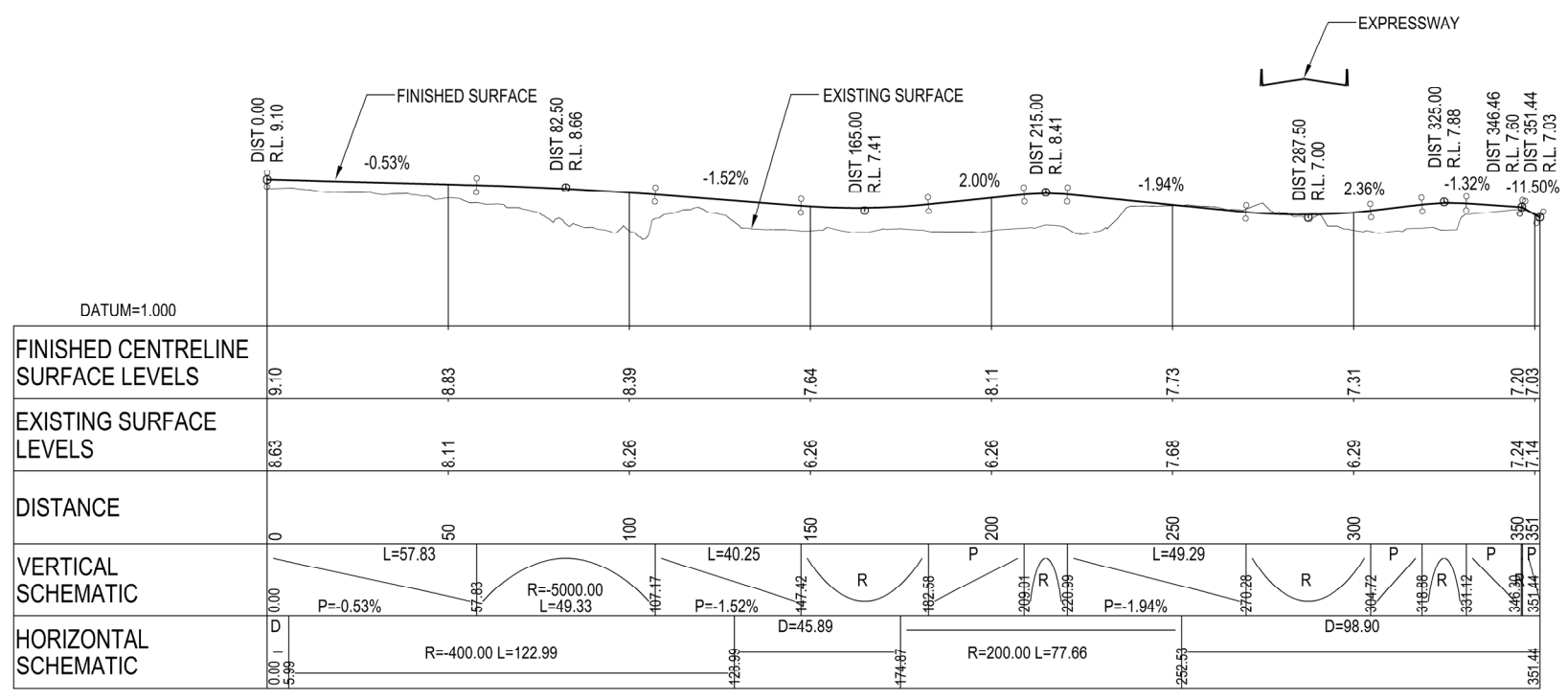

LONGITUDINAL SECTION - POPLAR AVENUE REALIGNMENT
 SCALE HORIZ = 1:2000 VERT = 1:400

NOTES:

Original
Scale (A3)

1	AEE LODGEMENT	NRN	15.03.12
Revision:	Amendment	Approved:	Date:



Project: **MACKAYS TO PEKA PEKA EXPRESSWAY**

Title: **POPLAR AVENUE INTERCHANGE
LONGITUDINAL SECTION
POPLAR AVENUE REALIGNMENT**

Status: - FOR CONSENTING

Document ID: M2PP-AEE-DWG Rev. 1

Drawing No: **CV-GP-121**

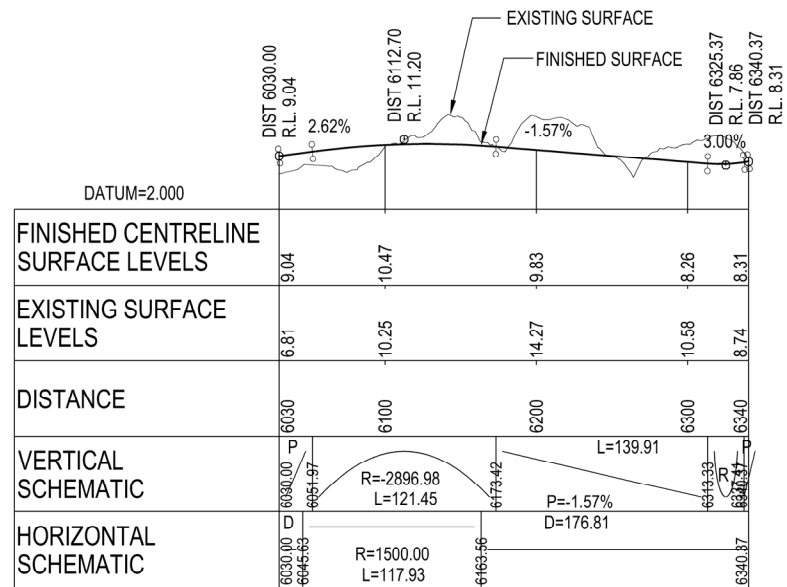

LONGITUDINAL SECTION - NORTH BOUND OFF RAMP
SCALE HORIZ = 1:5000 VERT = 1:1000

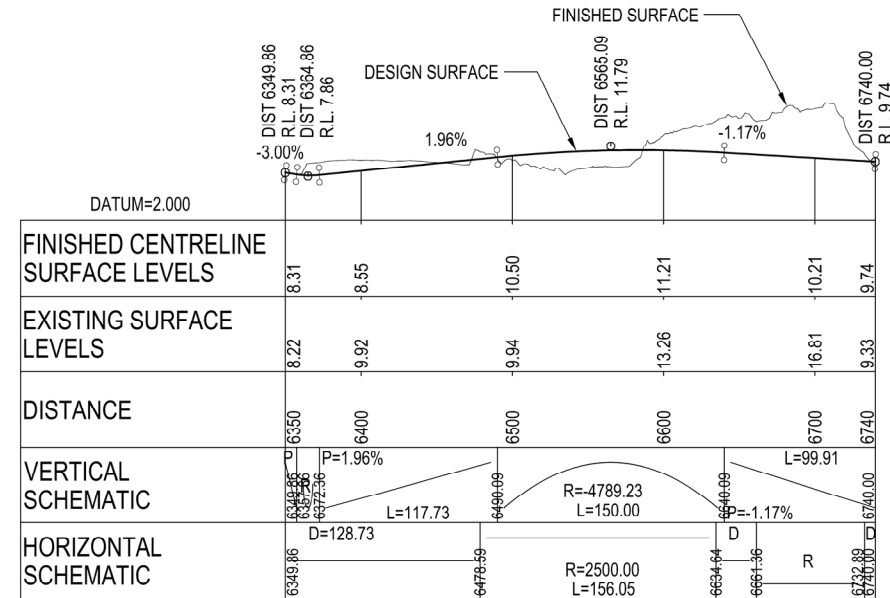

LONGITUDINAL SECTION - NORTH BOUND ON RAMP
SCALE HORIZ = 1:5000 VERT = 1:1000

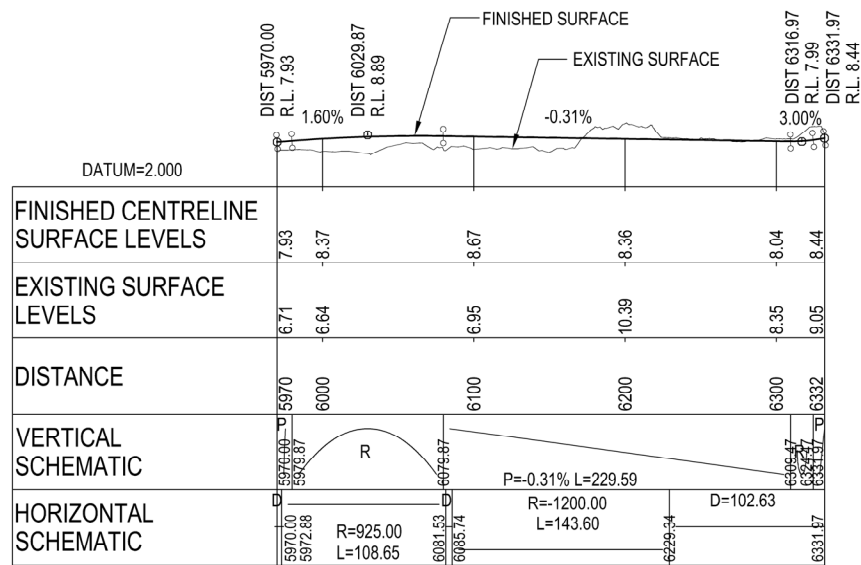

LONGITUDINAL SECTION - SOUTH BOUND ON RAMP
SCALE HORIZ = 1:5000 VERT = 1:1000

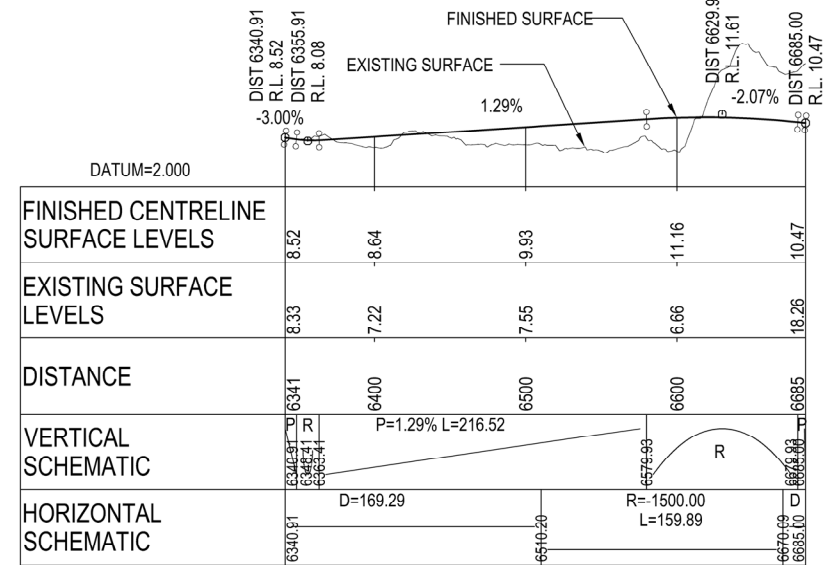

LONGITUDINAL SECTION - SOUTH BOUND OFF RAMP
SCALE HORIZ = 1:5000 VERT = 1:1000

NOTES:

Original Scale (A3)

1	AEE LODGEMENT	NRN	15.03.12
Revision:	Amendment	Approved:	Date:



Project: **MACKAYS TO PEKA PEKA EXPRESSWAY**

Title: **KAPITI ROAD INTERCHANGE LONGITUDINAL SECTION ON RAMPS & OFF RAMPS**

Status: FOR CONSENTING

Document ID: M2PP-AEE-DWG

Drawing No: **CV-GP-122**

Rev: 1

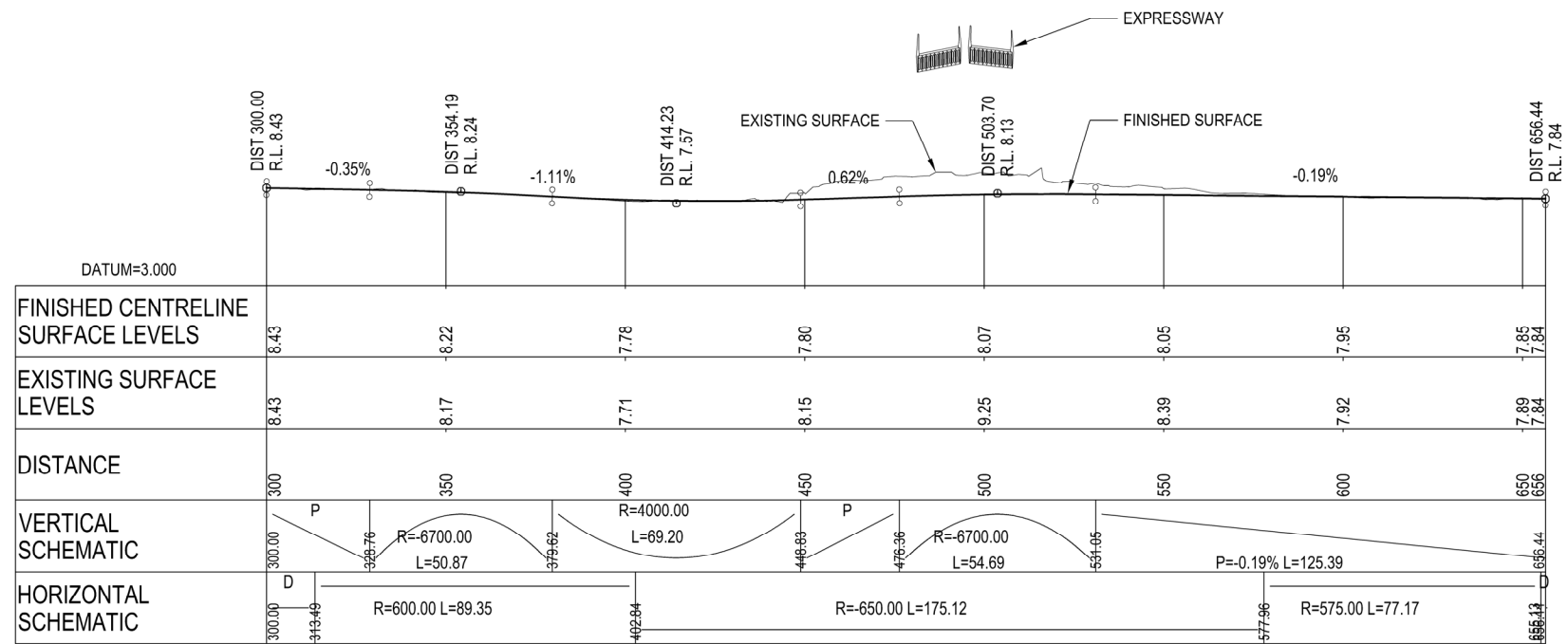

LONGITUDINAL SECTION - KAPITI ROAD REALIGNMENT

SCALE HORIZ = 1:2000 VERT = 1:400

NOTES:

Original Scale (A3)

1	AEE LODGEMENT	NRN	15.03.12
Revision	Amendment	Approved	Date



Project: MACKAYS TO PEKA PEKA EXPRESSWAY	
Title: KAPITI ROAD INTERCHANGE LONGITUDINAL SECTION KAPITI ROAD REALIGNMENT	
Status: FOR CONSENTING	Rev. 1
Document ID: M2PP-AEE-DWG	Drawing No: CV-GP-123

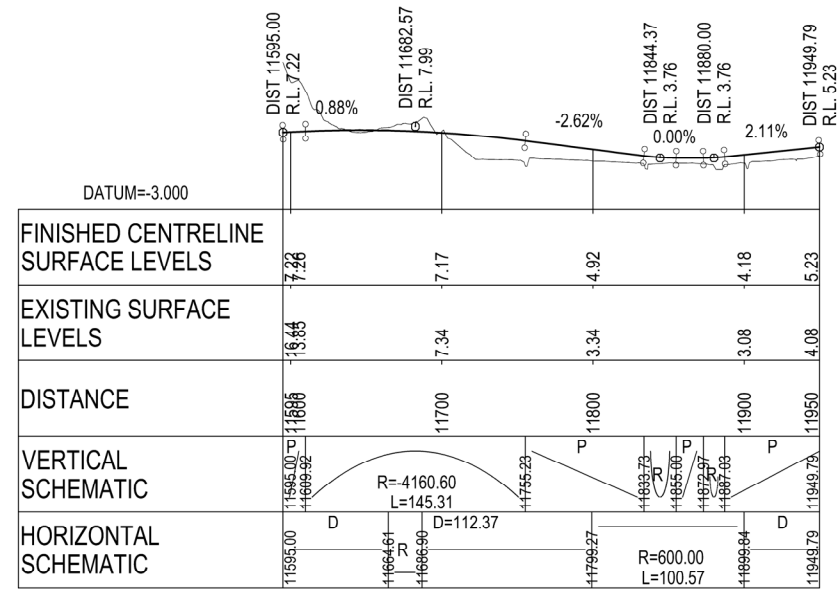

LONGITUDINAL SECTION - NORTH BOUND OFF RAMP

SCALE HORIZ = 1:5000 VERT = 1:1000

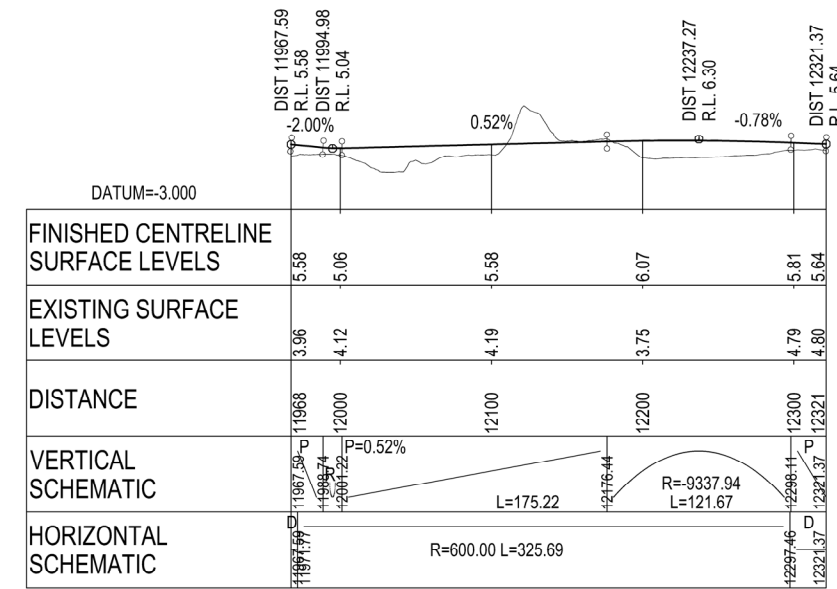

LONGITUDINAL SECTION - NORTH BOUND ON RAMP

SCALE HORIZ = 1:5000 VERT = 1:1000

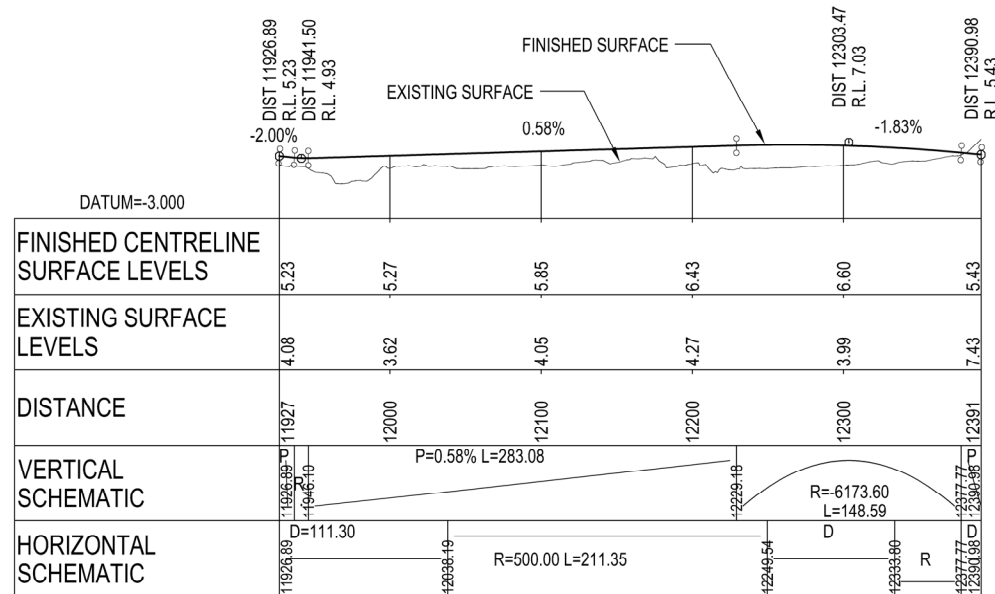

LONGITUDINAL SECTION - SOUTH BOUND ON RAMP

SCALE HORIZ = 1:5000 VERT = 1:1000

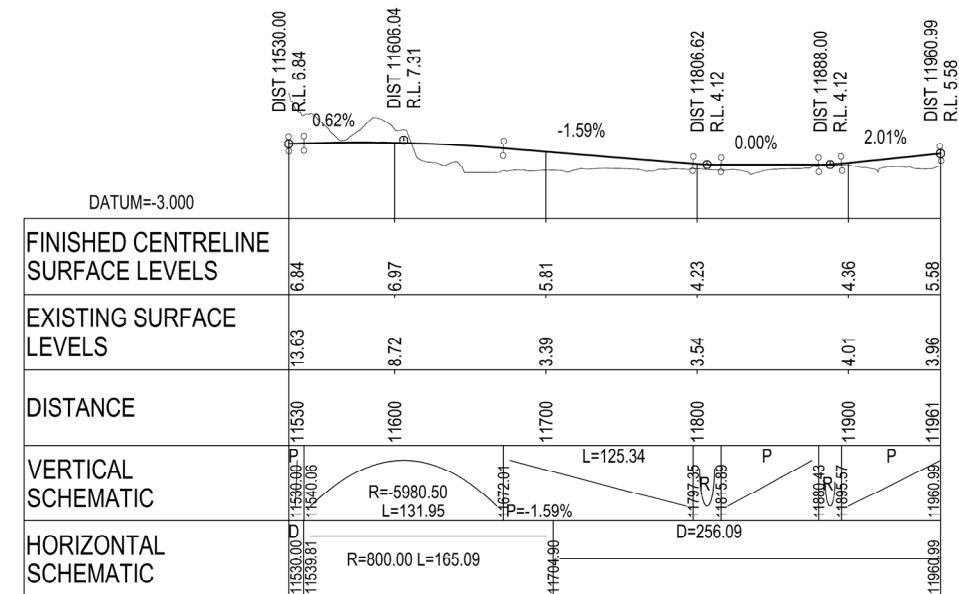

LONGITUDINAL SECTION - SOUTH BOUND OFF RAMP

SCALE HORIZ = 1:5000 VERT = 1:1000

NOTES:	Original Scale (A3)
1 AEE LODGEMENT	NRN 15.03.12
Revision: Amendment	Approved: Date

1	AEE LODGEMENT	NRN	15.03.12
Revision:	Amendment	Approved:	Date



Project: **MACKAYS TO PEKA PEKA EXPRESSWAY**

Title: **TE MOANA ROAD INTERCHANGE LONGITUDINAL SECTION ON RAMPS & OFF RAMPS**

Status: FOR CONSENTING

Document ID: M2PP-AEE-DWG Rev. 1

Drawing No: **CV-GP-124**

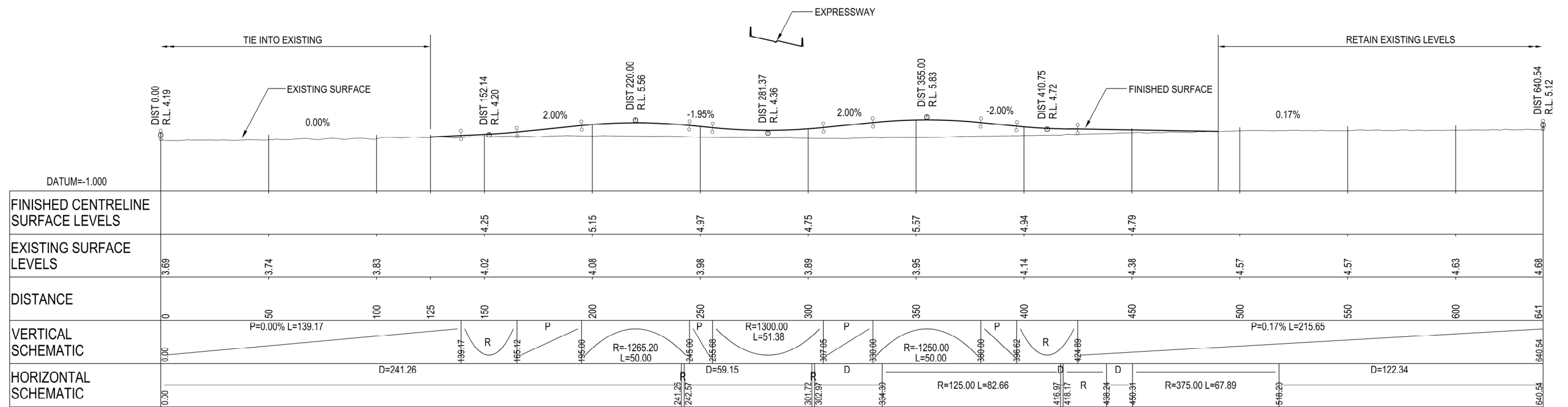

LONGITUDINAL SECTION - TE MOANA ROAD REALIGNMENT

SCALE HORIZ = 1:2000 VERT = 1:400

NOTES:

Original Scale (A3)

1	AEE LODGEMENT	NRN	15.03.12
Revision:	Amendment:	Approved:	Date:



Project: **MACKAYS TO PEKA PEKA EXPRESSWAY**

Title: **TE MOANA ROAD INTERCHANGE
LONGITUDINAL SECTION
TE MOANA ROAD REALIGNMENT**

Status: FOR CONSENTING

Document ID: M2PP-AEE-DWG Rev. 1

Drawing No: **CV-GP-125**

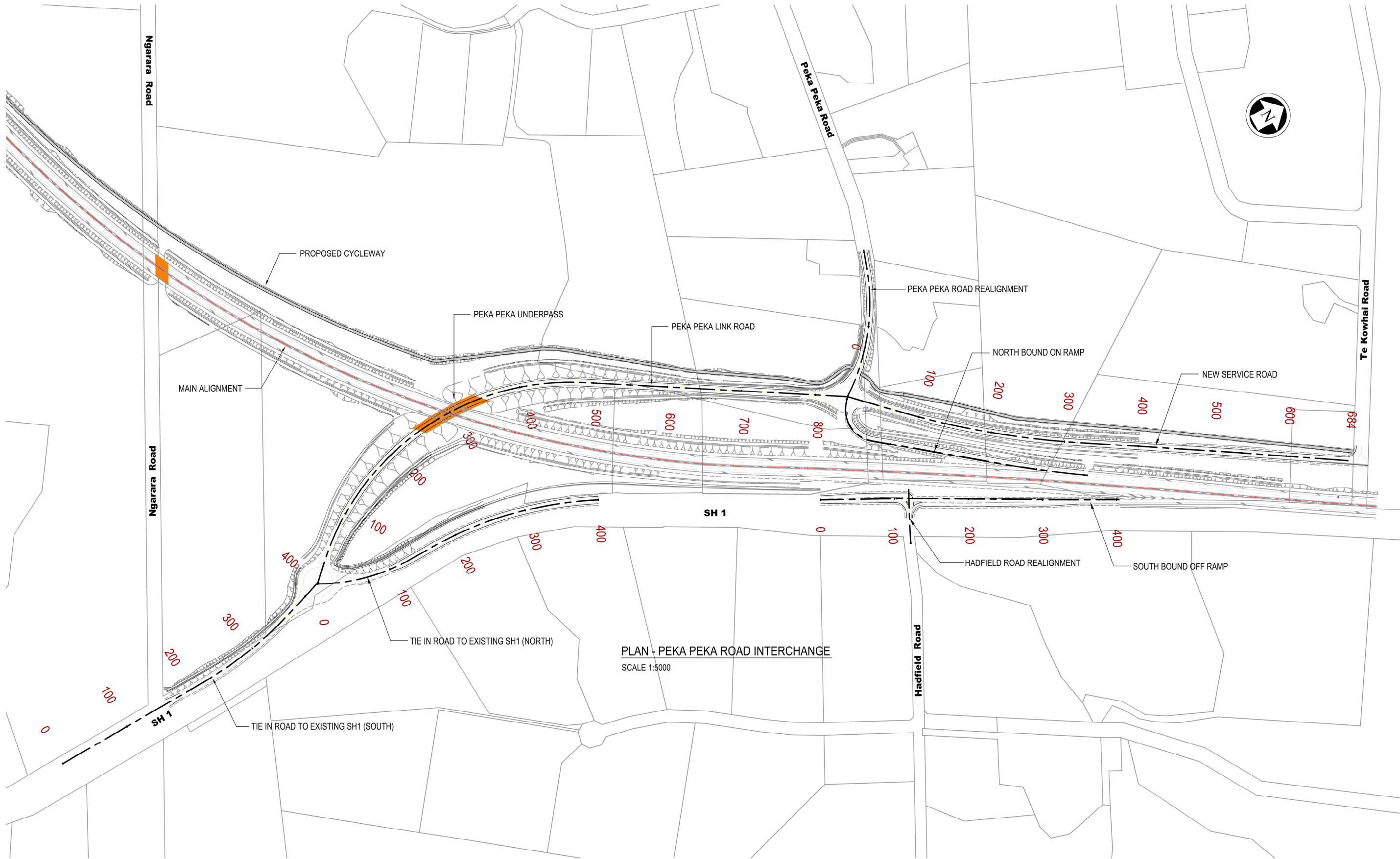

PLAN - PEKA PEKA ROAD INTERCHANGE
SCALE 1:5000

NOTES:

Original Scale (A3)				
1	AEE LODGEMENT	NRN	15.03.12	
Revision:	Amendment	Approved:	Date:	



Project: MACKAYS TO PEKA PEKA EXPRESSWAY	
Title: PEKA PEKA ROAD INTERCHANGE LAYOUT PLAN	
Status: FOR CONSENTING	
Document ID: M2PP-AEE-DWG	Rev:
Drawing No: CV-GP-126	1

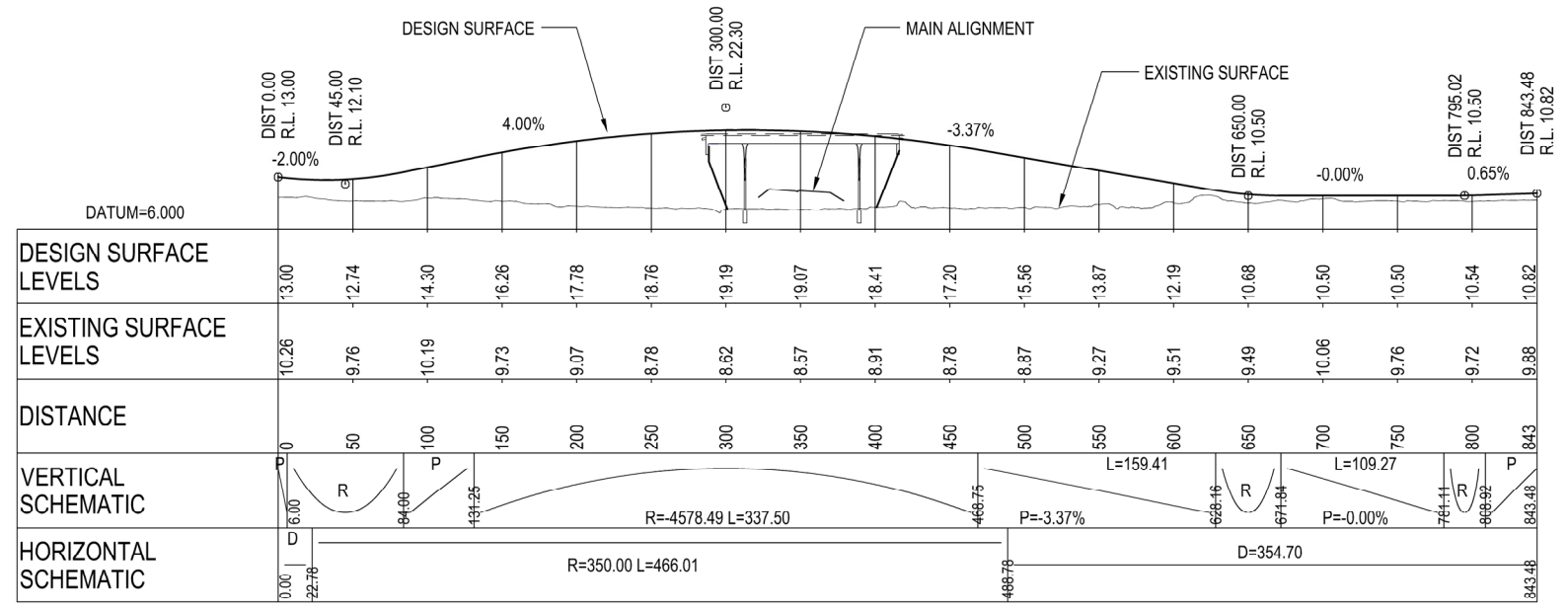

LONGITUDINAL SECTION - PEKA PEKA LINK ROAD
SCALE HORIZ = 1:5000 VERT = 1:1000

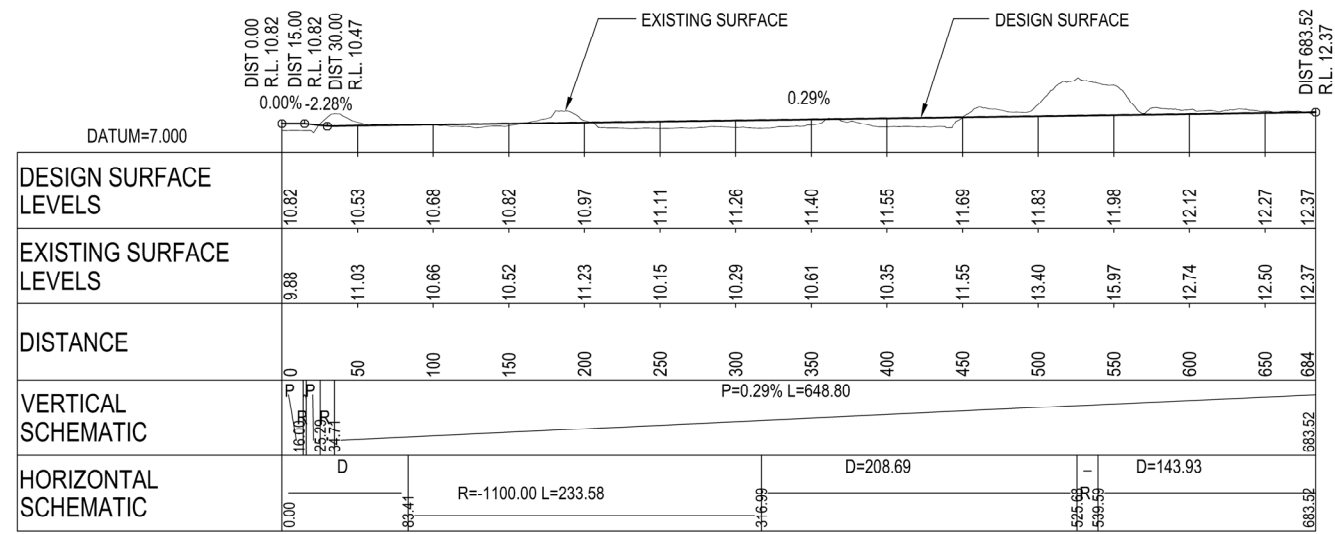

LONGITUDINAL SECTION - NEW SERVICE ROAD
SCALE HORIZ = 1:5000 VERT = 1:1000

NOTES:

Original Scale (A3)

Revision	Amendment	Approved	Date
1	AEE LODGEMENT	NRN	15.03.12



MACKAYS TO PEKA PEKA EXPRESSWAY

Project: PEKA PEKA ROAD INTERCHANGE
LONGITUDINAL SECTION
PEKA PEKA LINK ROAD & NEW SERVICE ROAD

Status: FOR CONSENTING

Document ID: M2PP-AEE-DWG
Drawing No: CV-GP-127

Rev: 1

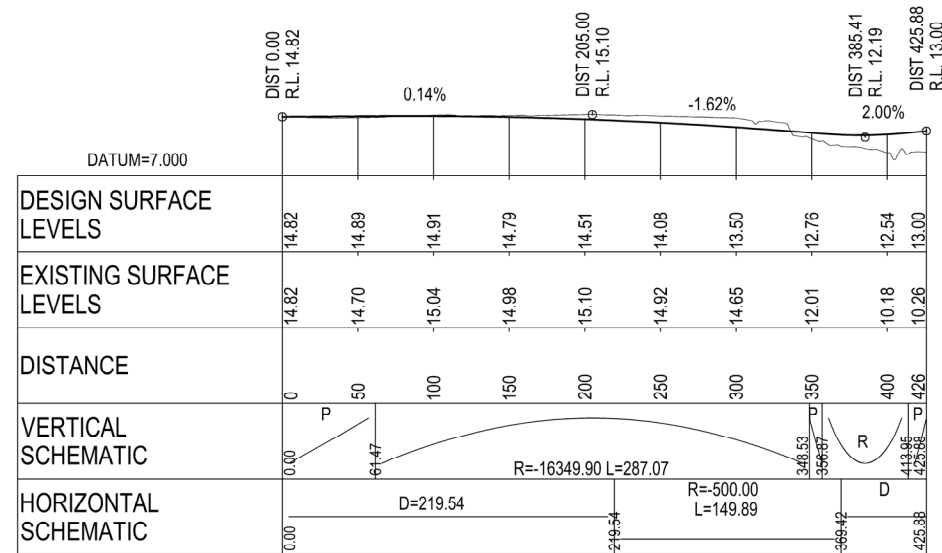

LONGITUDINAL SECTION - TIE IN ROAD TO EXISTING SH1 (SOUTH)

SCALE HORIZ = 1:5000 VERT = 1:1000

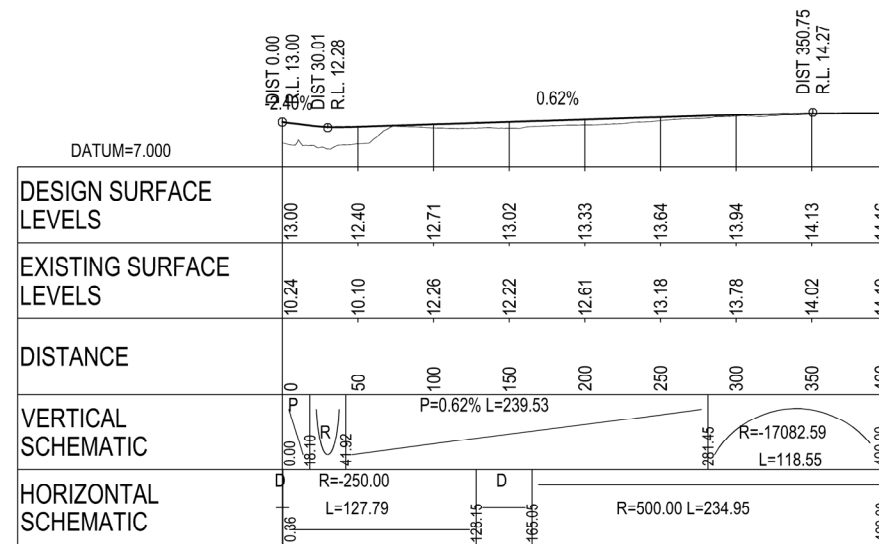

LONGITUDINAL SECTION - TIE IN ROAD TO EXISTING SH1 (NORTH)

SCALE HORIZ = 1:5000 VERT = 1:1000

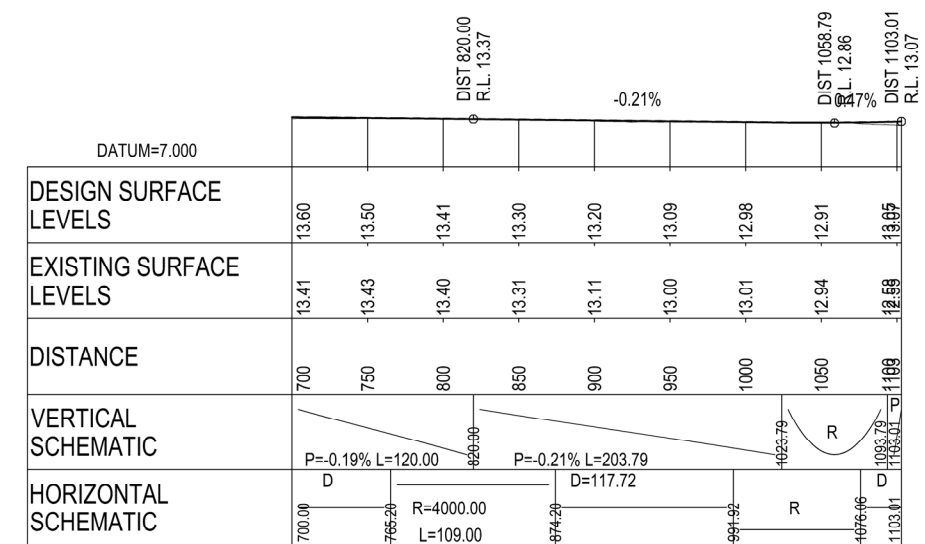

LONGITUDINAL SECTION - SOUTH BOUND OFF-RAMP

SCALE HORIZ = 1:5000 VERT = 1:1000

NOTES:

Original Scale (A3)				
1	AEE LODGEMENT	NRN	15.03.12	
Revision	Amendment	Approved	Date	



Project: MACKAYS TO PEKA PEKA EXPRESSWAY	
Title: PEKA PEKA ROAD INTERCHANGE LONGITUDINAL SECTION TIE IN ROAD TO SH1 & SOUTH BOUND OFF RAMP	
Status: FOR CONSENTING	Rev: 1
Document ID: M2PP-AEE-DWG	Drawing No: CV-GP-128

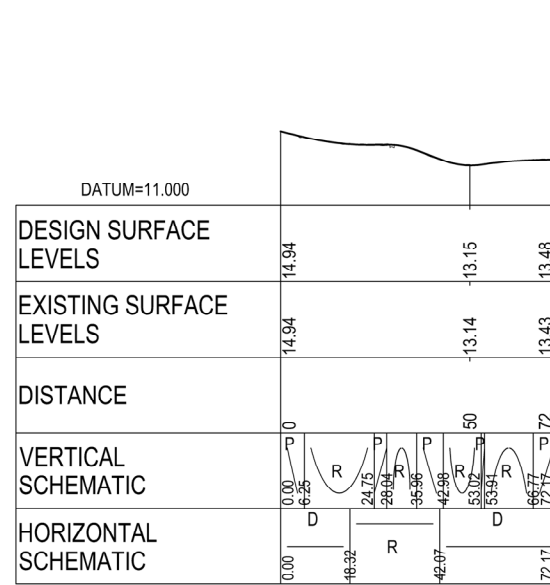

LONGITUDINAL SECTION - HADFIELD ROAD

SCALE HORIZ = 1:2000 VERT = 1:400

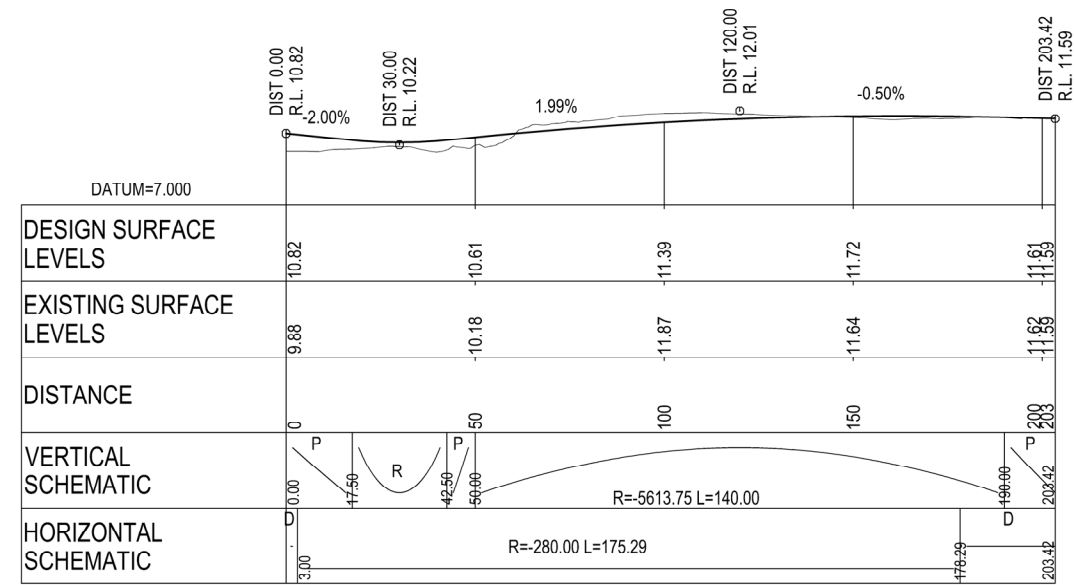

LONGITUDINAL SECTION - PEKA PEKA ROAD REALIGNMENT

SCALE HORIZ = 1:2000 VERT = 1:400



LONGITUDINAL SECTION - NORTH BOUND ON-RAMP

SCALE HORIZ = 1:2000 VERT = 1:400

NOTES:

Original Scale (A3)

1	AEE LODGEMENT	NRN	15.03.12
Revision:	Amendment	Approved:	Date:



Project: MACKAYS TO PEKA PEKA EXPRESSWAY	
Title: PEKA PEKA ROAD INTERCHANGE LONGITUDINAL SECTION HADFIELD ROAD & PEKA PEKA ROAD	
Status: FOR CONSENTING	Rev: 1
Document ID: M2PP-AEE-DWG	Drawing No: CV-GP-129

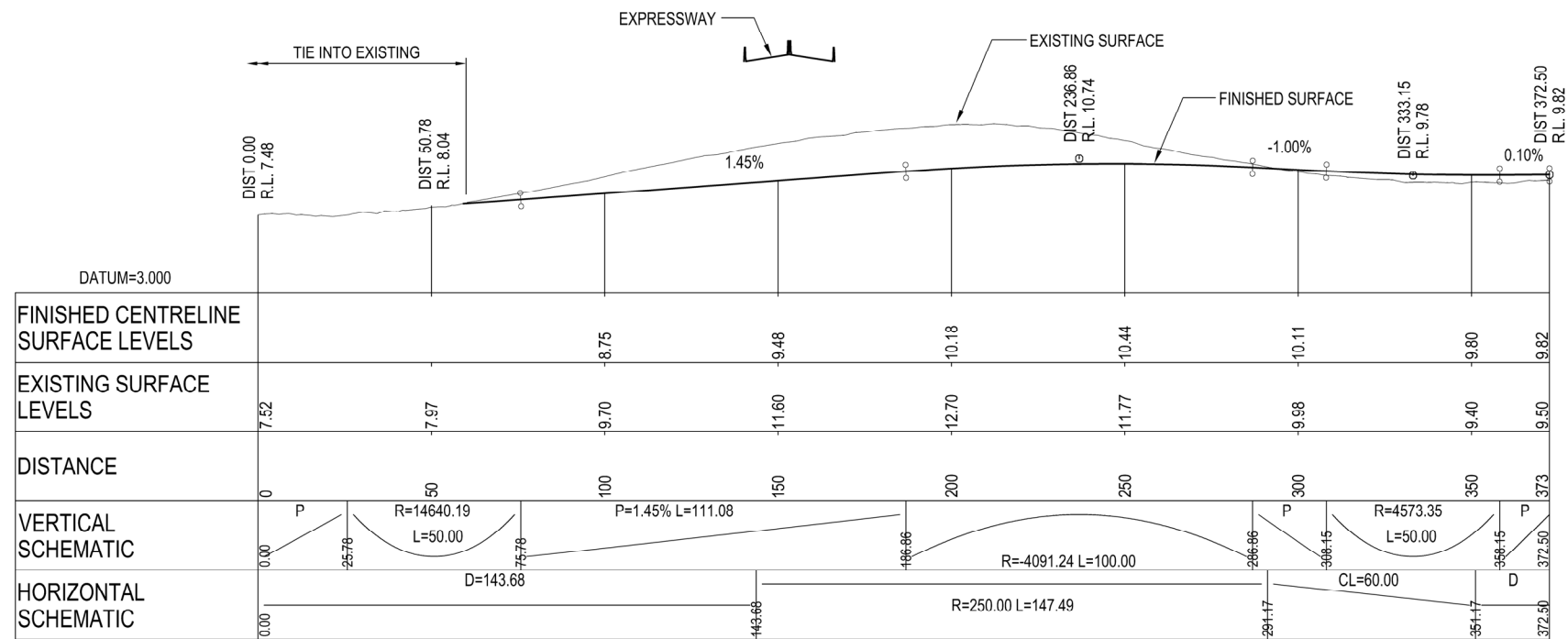

LONGITUDINAL SECTION - MAZENGARB ROAD REALIGNMENT
 SCALE HORIZ = 1:2000 VERT = 1:400

NOTES:

Original Scale (A3)

Revision	Amendment	Approved	Date
1	AEE LODGEMENT	NRN	15.03.12



Project: **MACKAYS TO PEKA PEKA EXPRESSWAY**

Title: **MAZENGARB ROAD LONGITUDINAL SECTION**

Status: FOR CONSENTING

Document ID: M2PP-AEE-DWG

Drawing No: **CV-GP-130**

Rev: 1

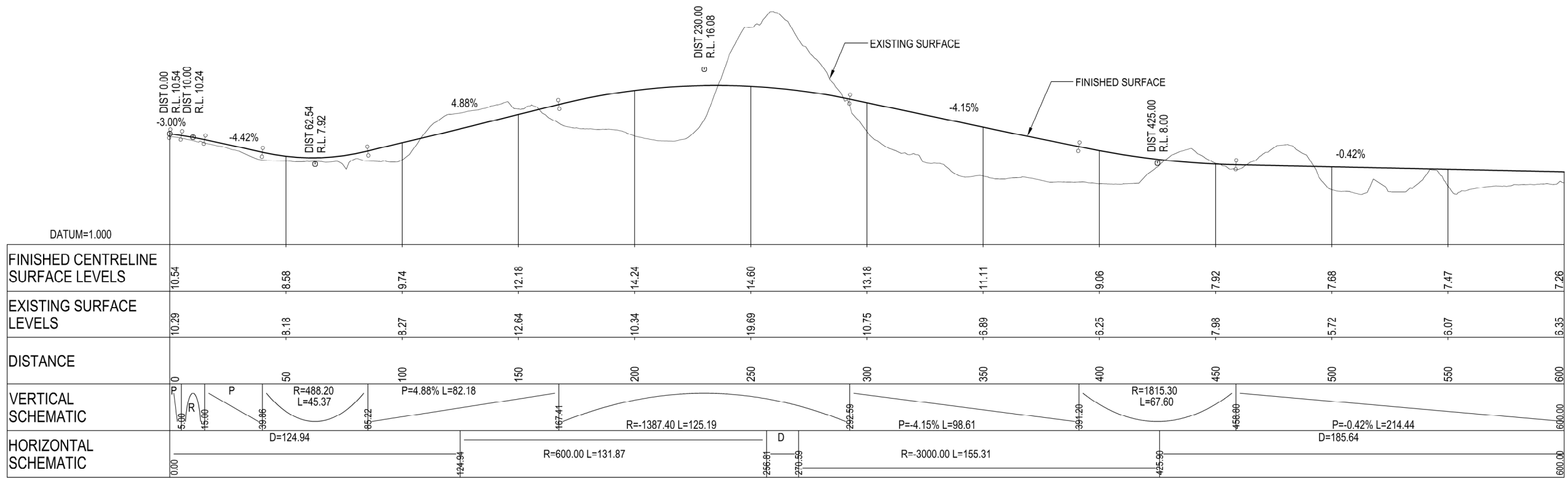

LONGITUDINAL SECTION - OTAIHANGA ACCESS ROAD

SCALE HORIZ = 1:2000 VERT = 1:400

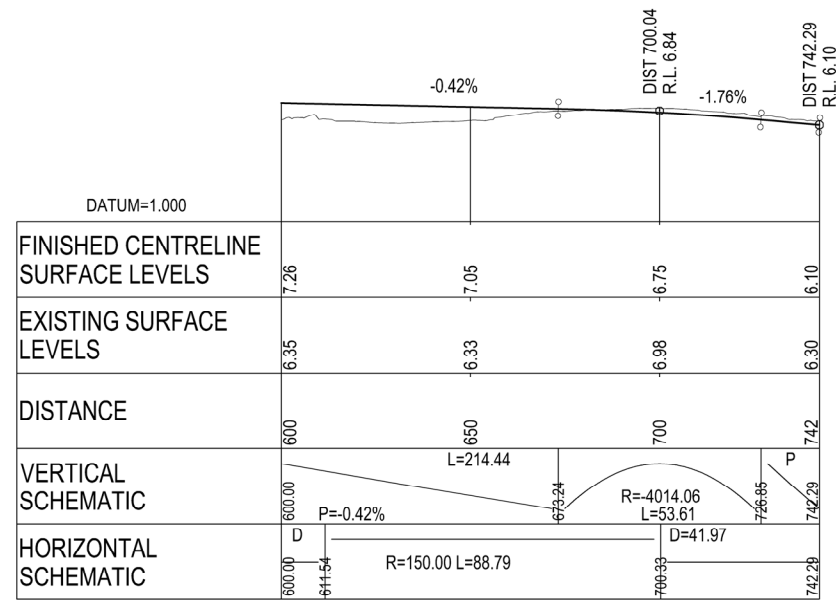

LONGITUDINAL SECTION - OTAIHANGA ACCESS ROAD

SCALE HORIZ = 1:2000 VERT = 1:400

NOTES:

Original Scale (A3)

1	AEE LODGEMENT	NRN	15.03.12
Revision:	Amendment	Approved:	Date:



Project: **MACKAYS TO PEKA PEKA EXPRESSWAY**

Title: **OTAIHANGA ACCESS ROAD LONGITUDINAL SECTION**

Status: FOR CONSENTING

Document ID: M2PP-AEE-DWG

Drawing No: **CV-GP-131**

Rev: 1

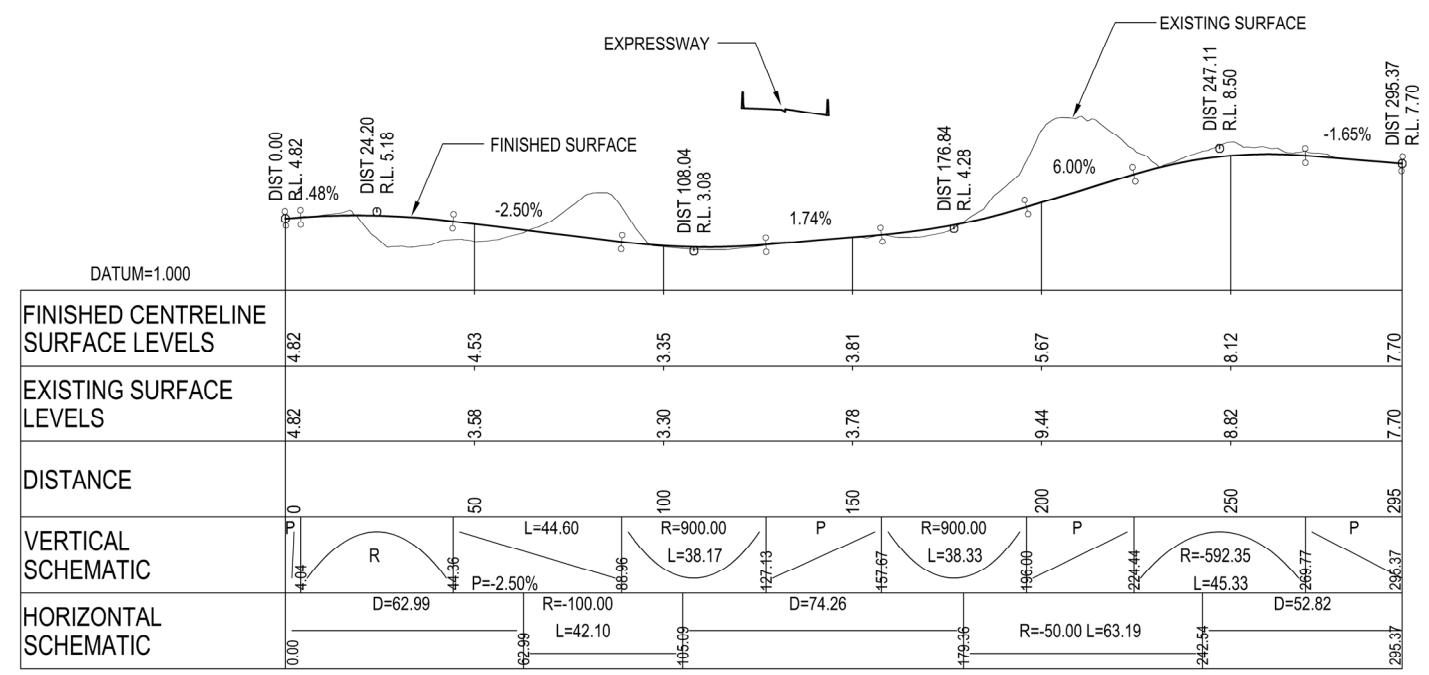

LONGITUDINAL SECTION - EL RANCHO ACCESS ROAD
 SCALE HORIZ = 1:2000 VERT = 1:400

NOTES:

Original Scale (A3)

1	AEE LODGEMENT	NRN	15.03.12
Revision	Amendment	Approved	Date



Project: **MACKAYS TO PEKA PEKA EXPRESSWAY**

Title: **EL RANCHO ACCESS ROAD LONGITUDINAL SECTION**

Status: FOR CONSENTING

Document ID: M2PP-AEE-DWG

Drawing No: **CV-GP-133**

Rev: 1

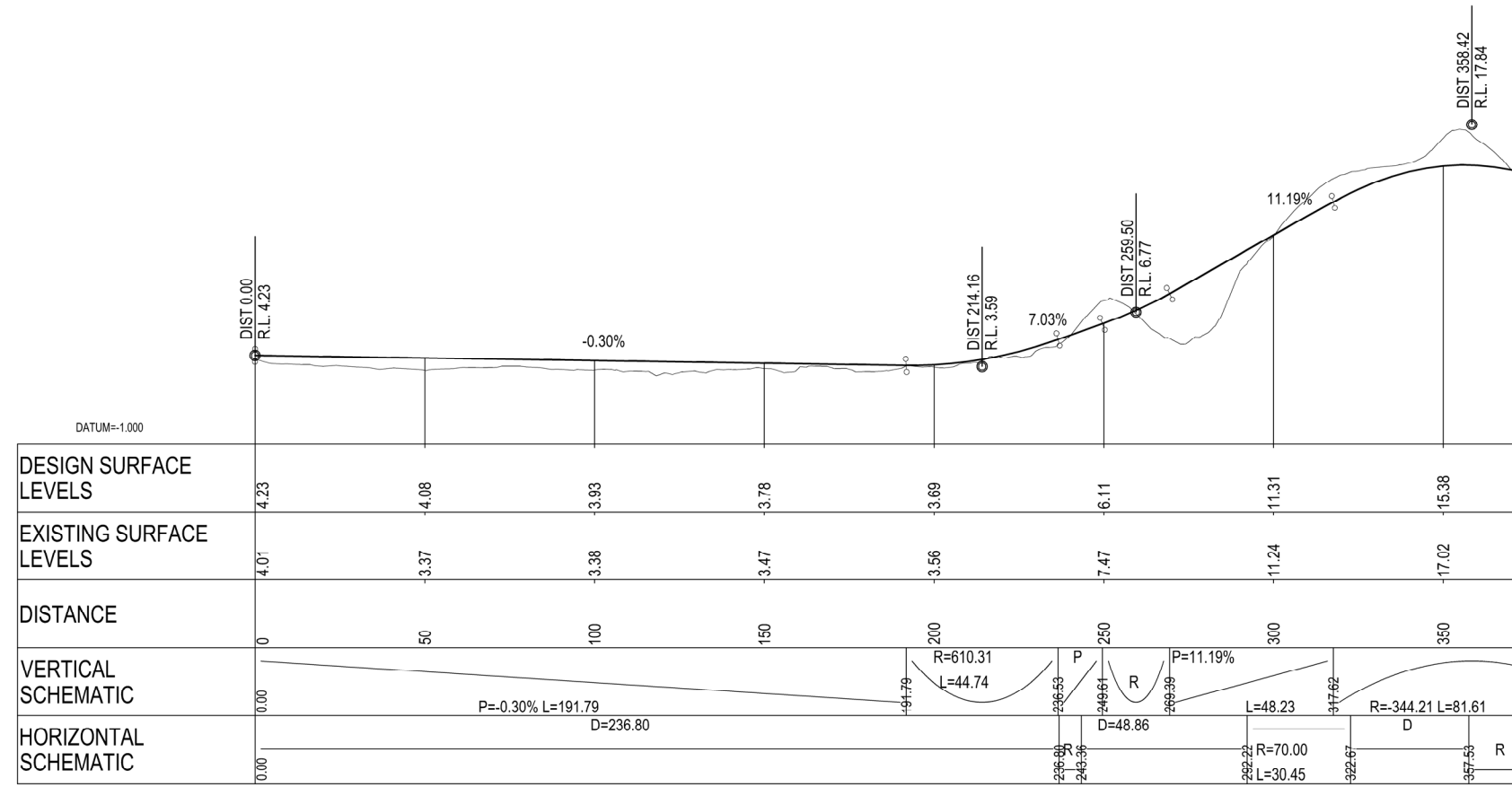

LONGITUDINAL SECTION - ACCESS ROAD OFF TE MOANA ROAD

SCALE HORIZ = 1:2000 VERT = 1:400

NOTES:

Original Scale (A3)

1	AEE LODGEMENT	NRN	15.03.12
Revision	Amendment	Approved	Date



Project: **MACKAYS TO PEKA PEKA EXPRESSWAY**

Title: **ACCESS ROAD OFF TE MOANA ROAD LONGITUDINAL SECTION**

Status: FOR CONSENTING

Document ID: M2PP-AEE-DWG Rev.

Drawing No: **CV-GP-134**

1

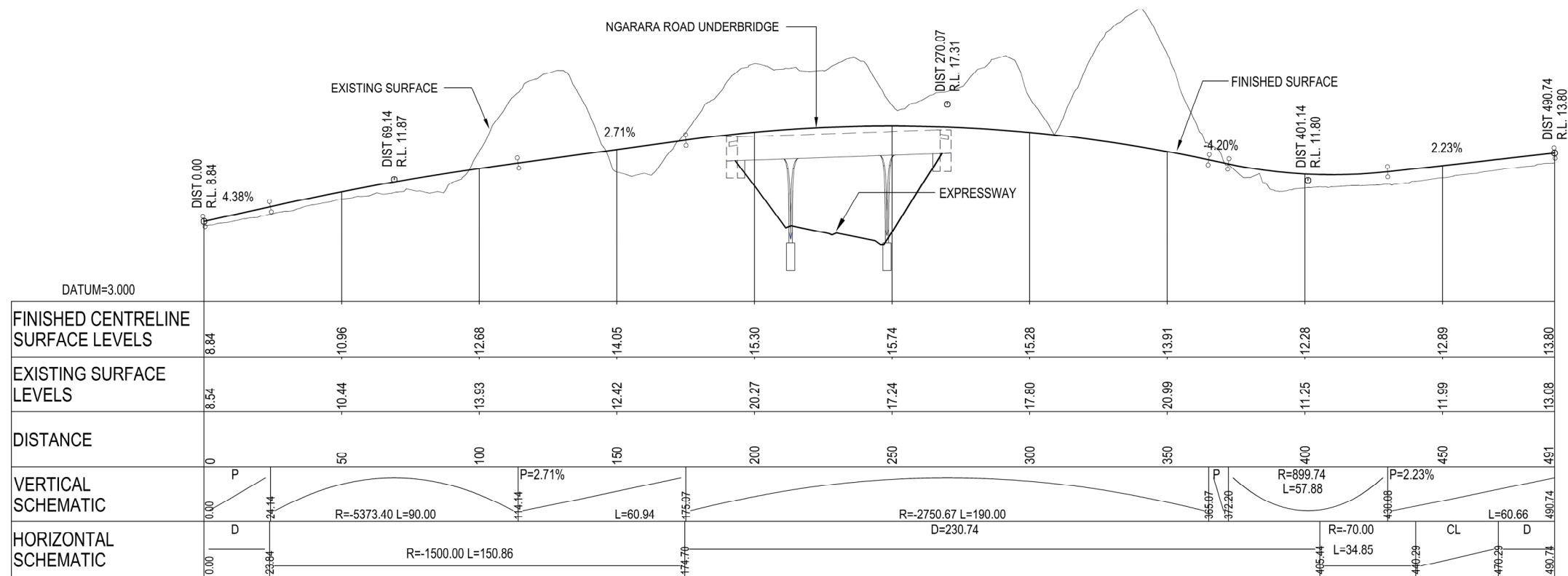

LONGITUDINAL SECTION - NGARARA ROAD REALIGNMENT

SCALE HORIZ = 1:2000 VERT = 1:400

NOTES:

Original Scale (A3)

1	AEE LODGEMENT	NRN	15.03.12
Revision	Amendment	Approved	Date



Project: MACKAYS TO PEKA PEKA EXPRESSWAY	
Title: NGARARA ROAD REALIGNMENT LONGITUDINAL SECTION	
Status: FOR CONSENTING	Rev. 1
Document ID: M2PP-AEE-DWG	Drawing No: CV-GP-135

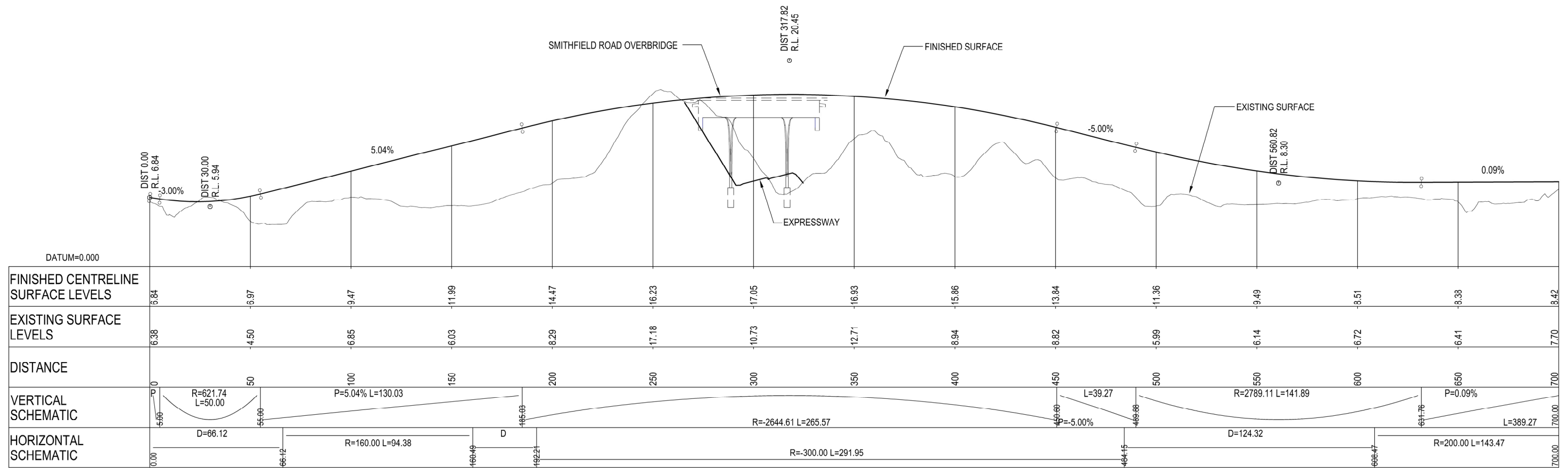

LONGITUDINAL SECTION - SMITHFIELD ROAD REALIGNMENT

SCALE HORIZ = 1:2000 VERT = 1:400

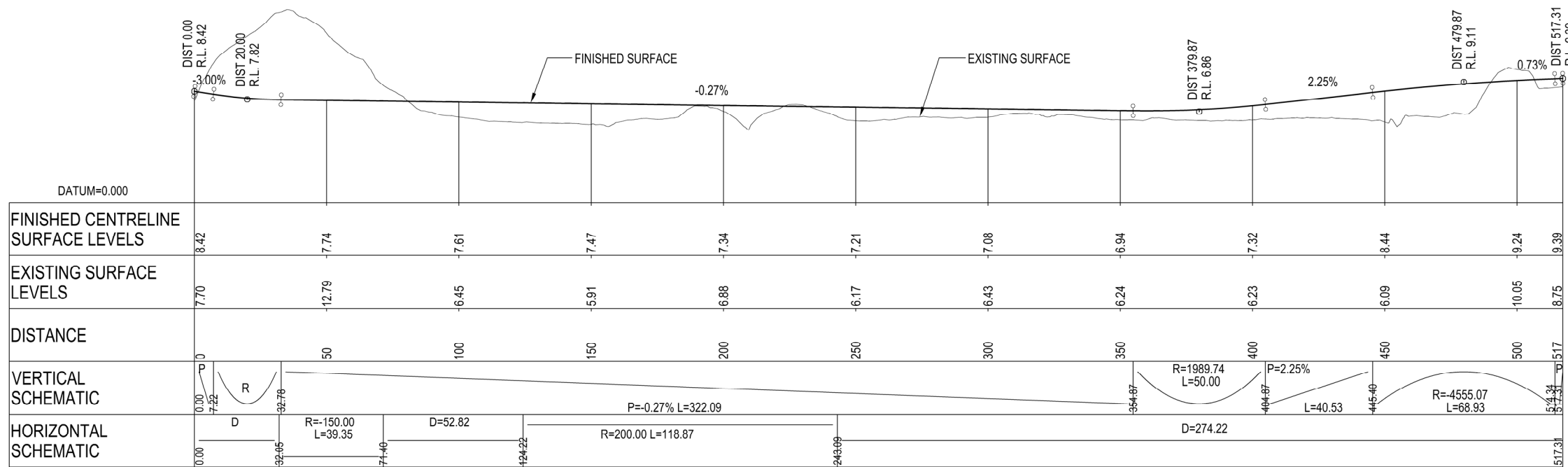

LONGITUDINAL SECTION - SMITHFIELD ROAD REALIGNMENT

SCALE HORIZ = 1:2000 VERT = 1:400

NOTES:

Original Scale (A3)

1	AEE LODGEMENT	NRN	15.03.12
Revision:	Amendment	Approved:	Date:



Project: **MACKAYS TO PEKA PEKA EXPRESSWAY**

Title: **SMITHFIELD ROAD REALIGNMENT LONGITUDINAL SECTION**

Status: FOR CONSENTING

Document ID: M2PP-AEE-DWG Rev. 1

Drawing No: **CV-GP-136**