





-  PROPERTY IDENTIFICATION NUMBER
-  CADASTRAL BOUNDARIES
-  PROPOSED DESIGNATION
-  REMOVED FROM PROPOSED DESIGNATION



1	Issued For Board of Inquiry	BAP	LH	JC	27/06/17
No	Issued Status	Drawn	Check'd	App'd	Date



NZ TRANSPORT AGENCY
WAKA KOTAHĀ



East West Link

Project		EAST WEST LINK	
Drawing Title		PROPOSED DESIGNATION OVERVIEW	
Drawing Number	AEE-NOR-100	Rev No.	1

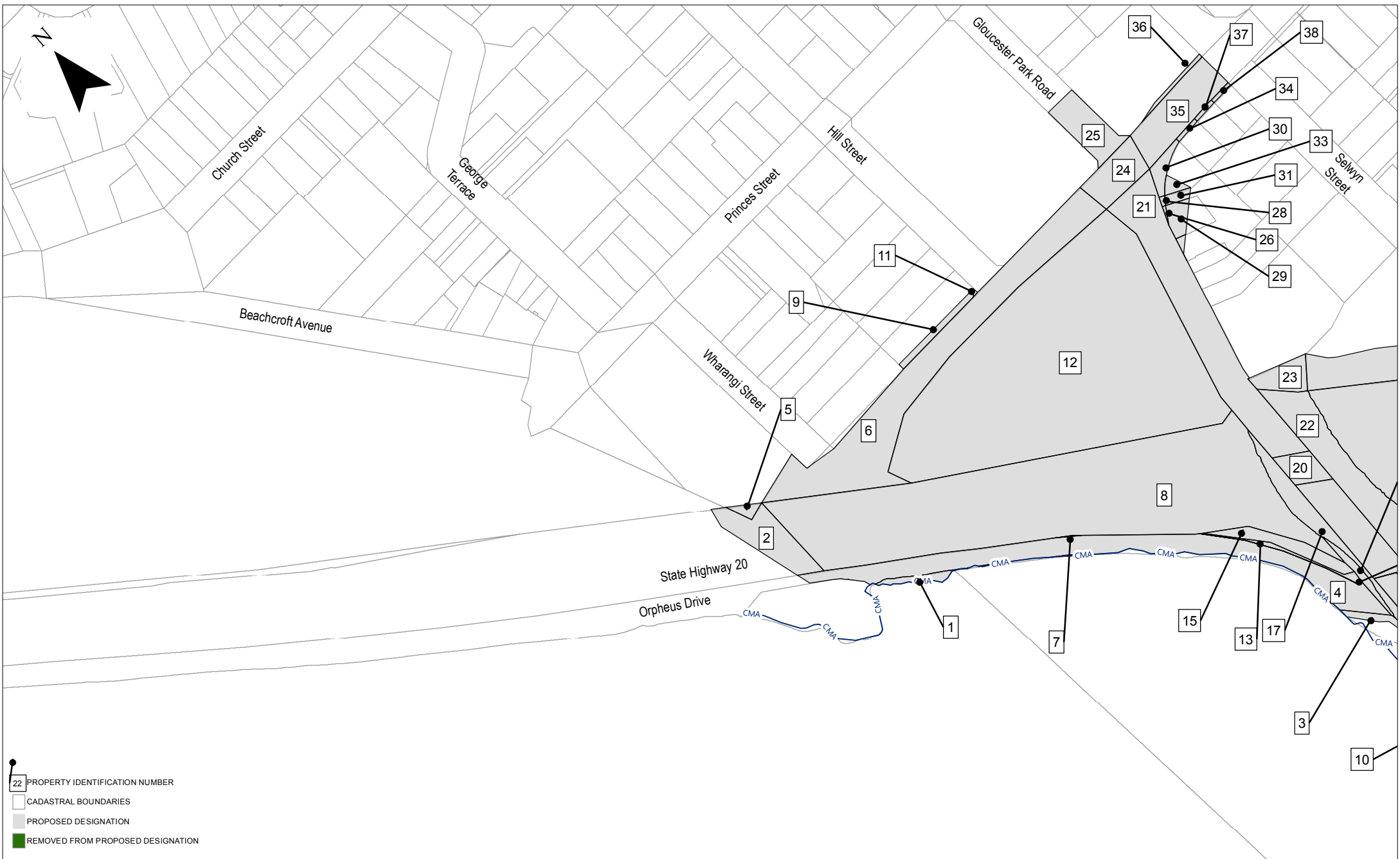

- 22 PROPERTY IDENTIFICATION NUMBER
- CADASTRAL BOUNDARIES
- PROPOSED DESIGNATION
- REMOVED FROM PROPOSED DESIGNATION

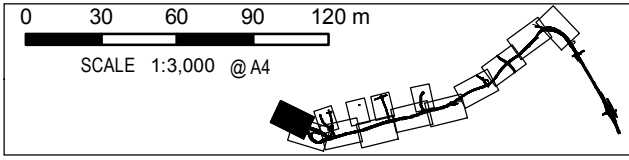

No	Issued Status	Drawn	Check'd	App'd	Date
1	Issued For Board of Inquiry	BAP	LH	JC	27/06/17

NZ TRANSPORT AGENCY
WAKA KOTAHĪ

East West Link

Project	EAST WEST LINK	
Drawing Title	PROPOSED DESIGNATION NEILSON STREET INTERCHANGE SHEET 1	
Drawing Number	AEE-NOR-101	Rev No. 1

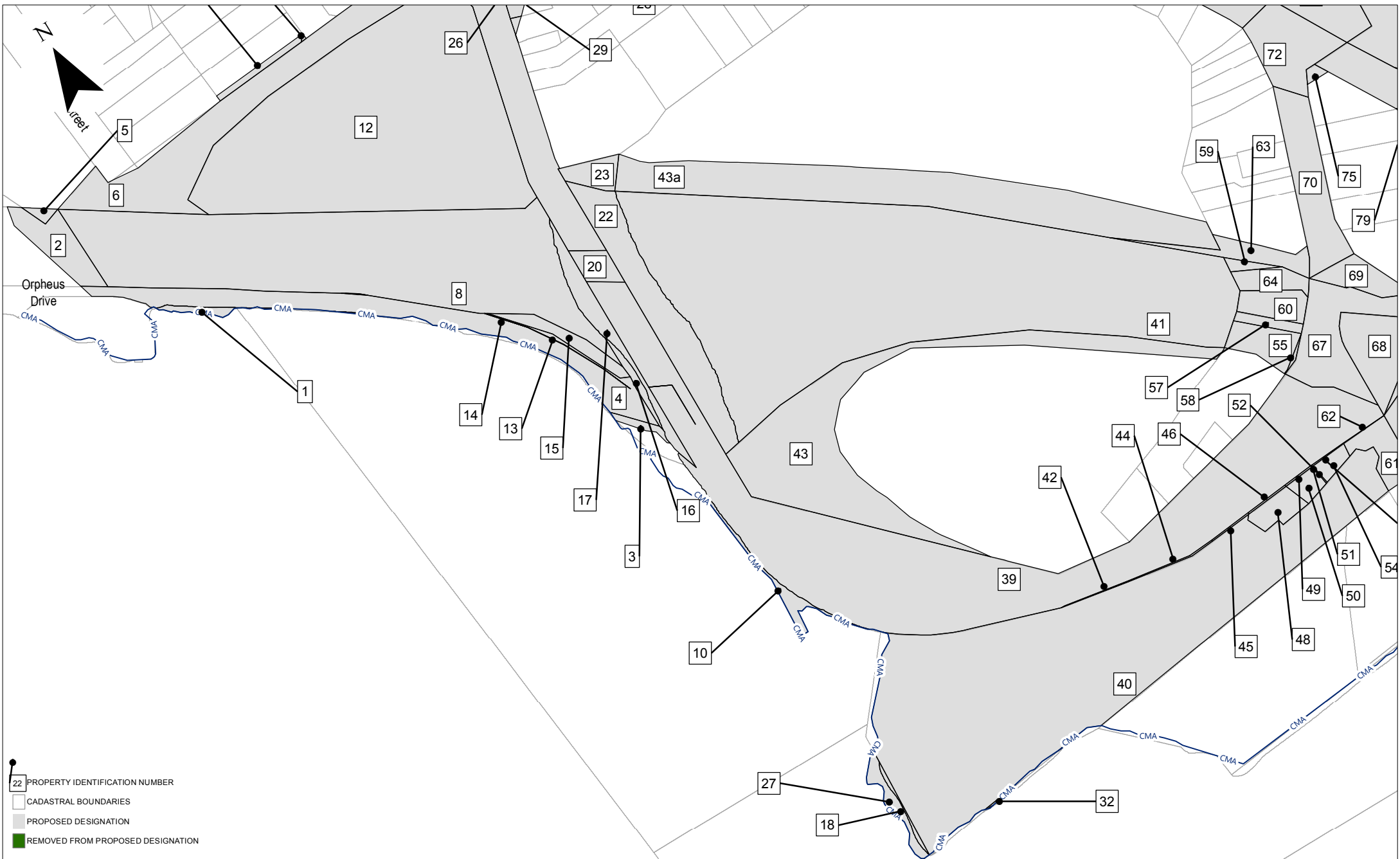

- 22 PROPERTY IDENTIFICATION NUMBER
- CADASTRAL BOUNDARIES
- PROPOSED DESIGNATION
- REMOVED FROM PROPOSED DESIGNATION

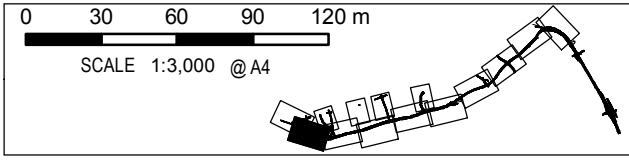

1	Issued For Board of Inquiry	BAP	LH	JC	27/06/17
No	Issued Status	Drawn	Check'd	App'd	Date

NZ TRANSPORT AGENCY
WAKA KOTAHĪ

East West Link

Project	EAST WEST LINK	
Drawing Title	PROPOSED DESIGNATION NEILSON STREET INTERCHANGE SHEET 2	
Drawing Number	AEE-NOR-102	Rev No. 1

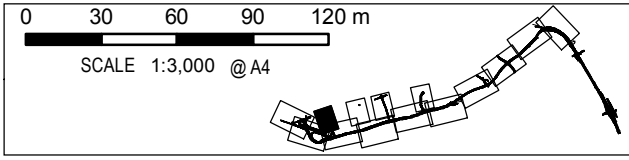
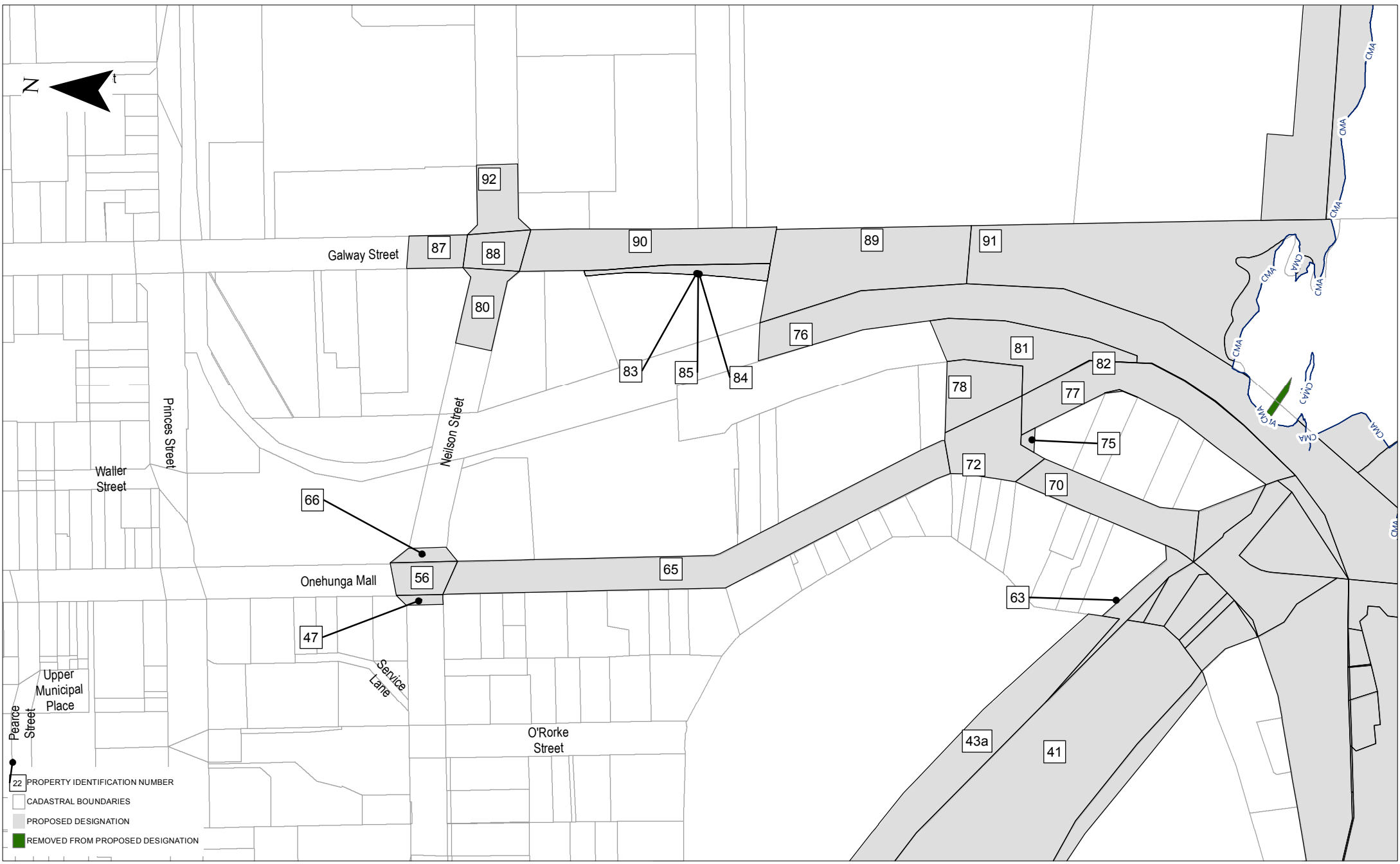

1	Issued For Board of Inquiry	BAP	LH	JC	27/06/17
No	Issued Status	Drawn	Check'd	App'd	Date

Project	EAST WEST LINK	
Drawing Title	PROPOSED DESIGNATION NEILSON STREET INTERCHANGE LOCAL ROADS - SHEET 03	
Drawing Number	AEE-NOR-103	Rev No. 1

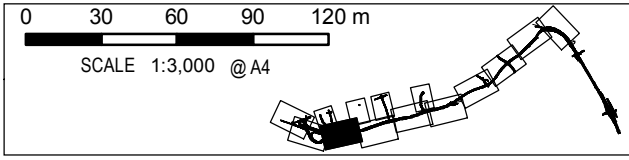
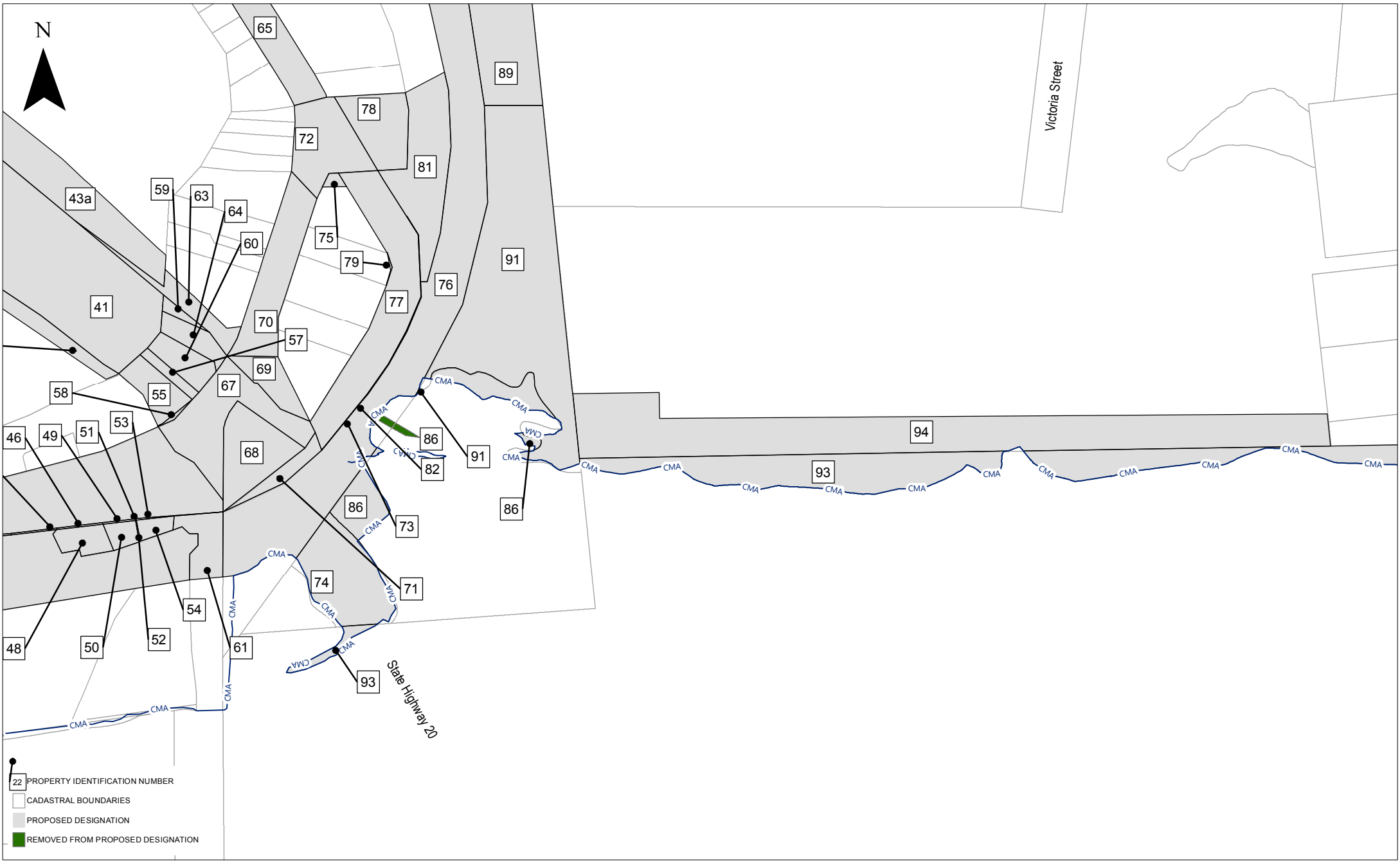

No	Issued Status	Drawn	Check'd	App'd	Date
1	Issued For Board of Inquiry	BAP	LH	JC	27/06/17

Project	EAST WEST LINK	
Drawing Title	PROPOSED DESIGNATION EAST WEST LINK / GALWAY STREET SHEET 4	
Drawing Number	AEE-NOR-104	Rev No. 1

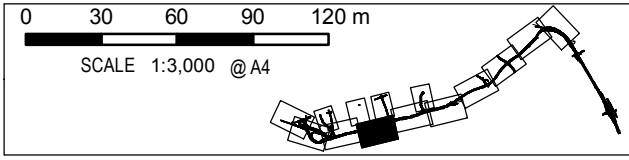
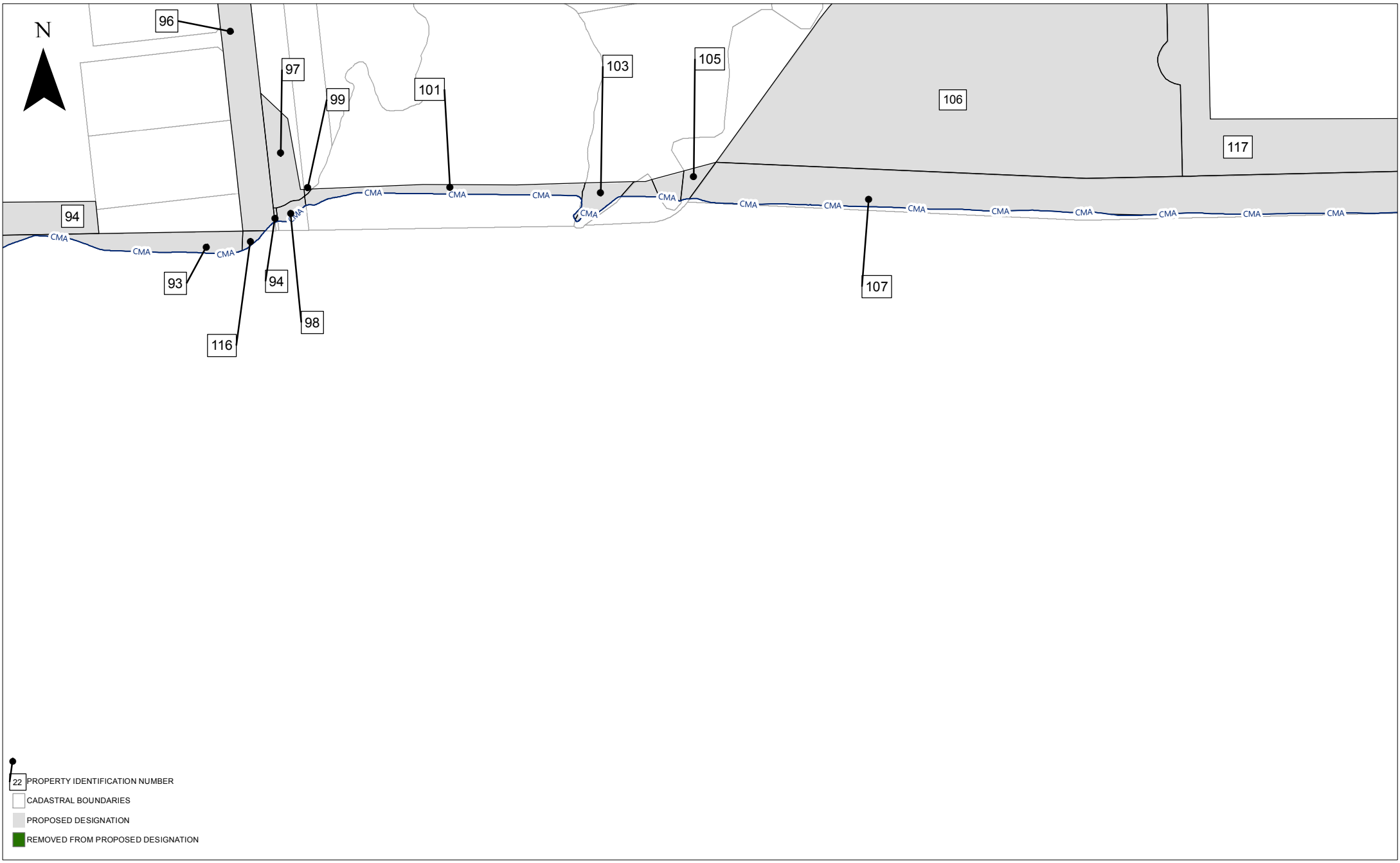

No	Issued Status	Drawn	Check'd	App'd	Date
1	Issued For Board of Inquiry	BAP	LH	JC	27/06/17

NZ TRANSPORT AGENCY
WAKA KOTAHI

East West Link

Project	EAST WEST LINK	
Drawing Title	PROPOSED DESIGNATION EMBANKMENT - SHEET 5	
Drawing Number	AEE-NOR-105	Rev No. 1



- 22 PROPERTY IDENTIFICATION NUMBER
- CADASTRAL BOUNDARIES
- PROPOSED DESIGNATION
- REMOVED FROM PROPOSED DESIGNATION

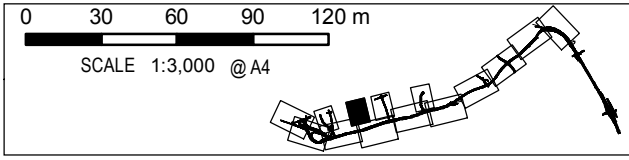

No	Issued Status	Drawn	Check'd	App'd	Date
1	Issued For Board of Inquiry	BAP	LH	JC	27/06/17

Project	EAST WEST LINK	
Drawing Title	PROPOSED DESIGNATION ALFRED STREET - SHEET 06	
Drawing Number	AEE-NOR-106	Rev No. 1

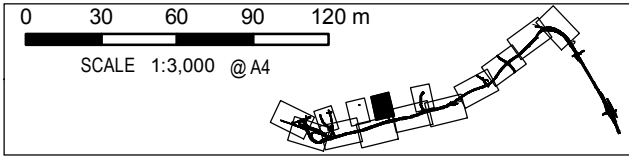

No	Issued Status	Drawn	Check'd	App'd	Date
1	Issued For Board of Inquiry	BAP	LH	JC	27/06/17

Project	EAST WEST LINK	
Drawing Title	PROPOSED DESIGNATION CAPTAIN SPRINGS ROAD - SHEET 07	
Drawing Number	AEE-NOR-107	Rev No. 1

N



- 22 PROPERTY IDENTIFICATION NUMBER
- CADASTRAL BOUNDARIES
- PROPOSED DESIGNATION
- REMOVED FROM PROPOSED DESIGNATION

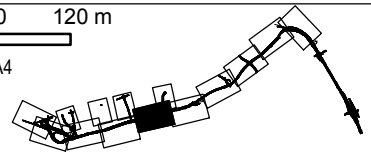
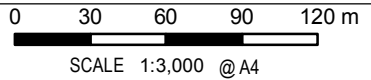

1	Issued For Board of Inquiry	BAP	LH	JC	27/06/17
No	Issued Status	Drawn	Check'd	App'd	Date

 East West Link	Project	EAST WEST LINK
	Drawing Title	PROPOSED DESIGNATION EMBANKMENT - SHEET 8
	Drawing Number	AEE-NOR-108
		Rev No. 1



- 22 PROPERTY IDENTIFICATION NUMBER
- CADASTRAL BOUNDARIES
- PROPOSED DESIGNATION
- REMOVED FROM PROPOSED DESIGNATION

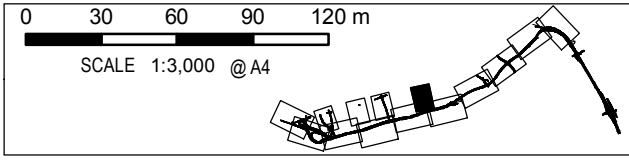

1	Issued For Board of Inquiry	BAP	LH	JC	27/06/17
No	Issued Status	Drawn	Check'd	App'd	Date

East West Link

Project	EAST WEST LINK
Drawing Title	PROPOSED DESIGNATION PORTS LINK - SHEET 09
Drawing Number	AEE-NOR-109
Rev No.	1

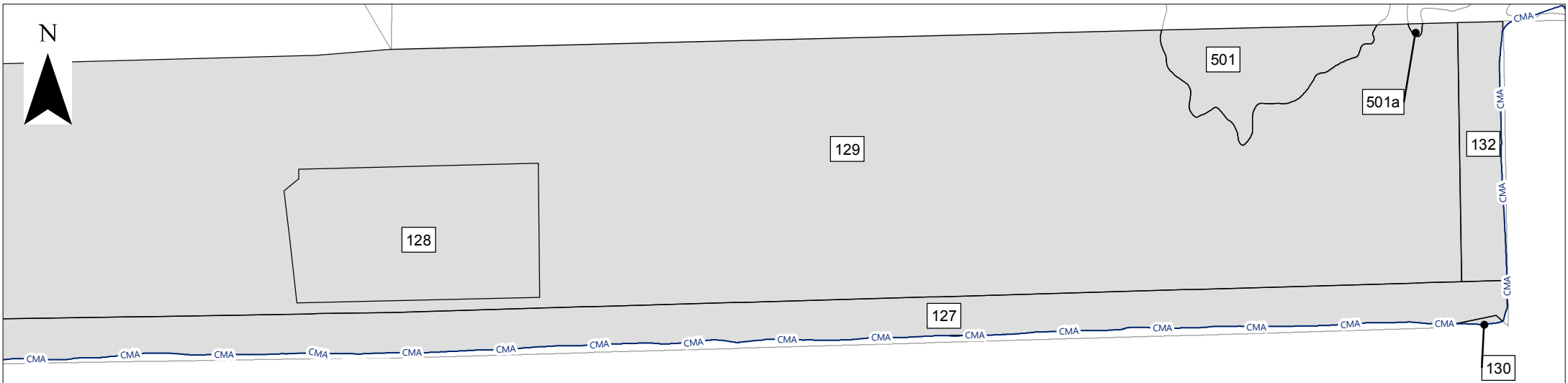

- 22 PROPERTY IDENTIFICATION NUMBER
- CADASTRAL BOUNDARIES
- PROPOSED DESIGNATION
- REMOVED FROM PROPOSED DESIGNATION

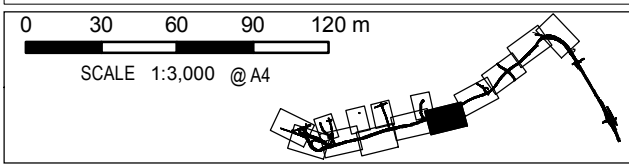

No	Issued Status	Drawn	Check'd	App'd	Date
1	Issued For Board of Inquiry	BAP	LH	JC	27/06/17

Project	EAST WEST LINK	
Drawing Title	PROPOSED DESIGNATION EMBANKMENT/ANNS CREEK - SHEET 10	
Drawing Number	AEE-NOR-110	Rev No. 1

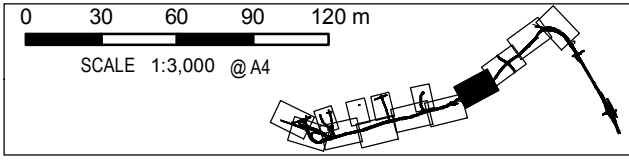
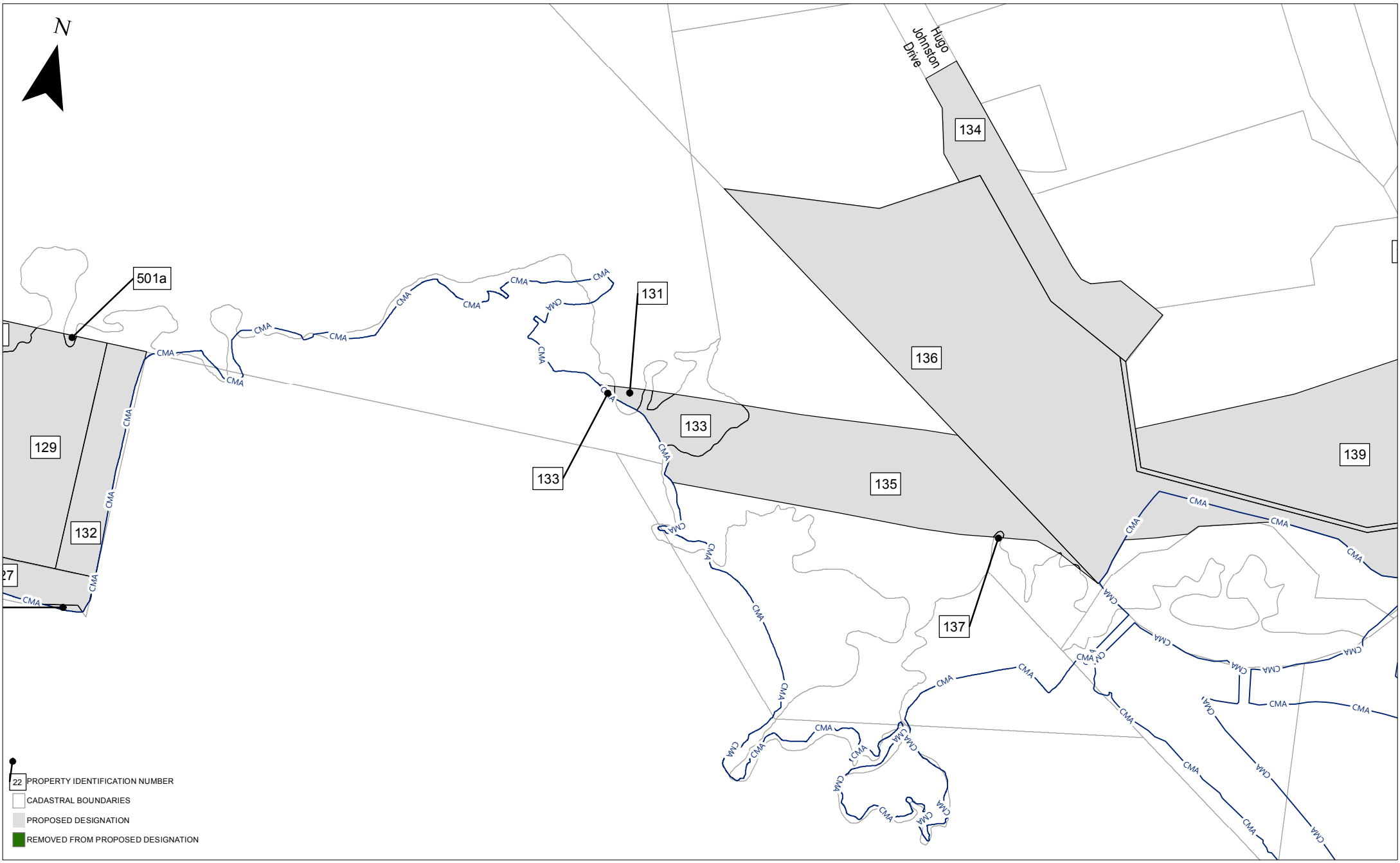

No	Issued Status	Drawn	Check'd	App'd	Date
1	Issued For Board of Inquiry	BAP	LH	JC	27/06/17

NZ TRANSPORT AGENCY
WAKA KOTAHĪ

East West Link

Project	EAST WEST LINK	
Drawing Title	PROPOSED DESIGNATION ANNS CREEK - SHEET 11	
Drawing Number	AEE-NOR-111	Rev No. 1

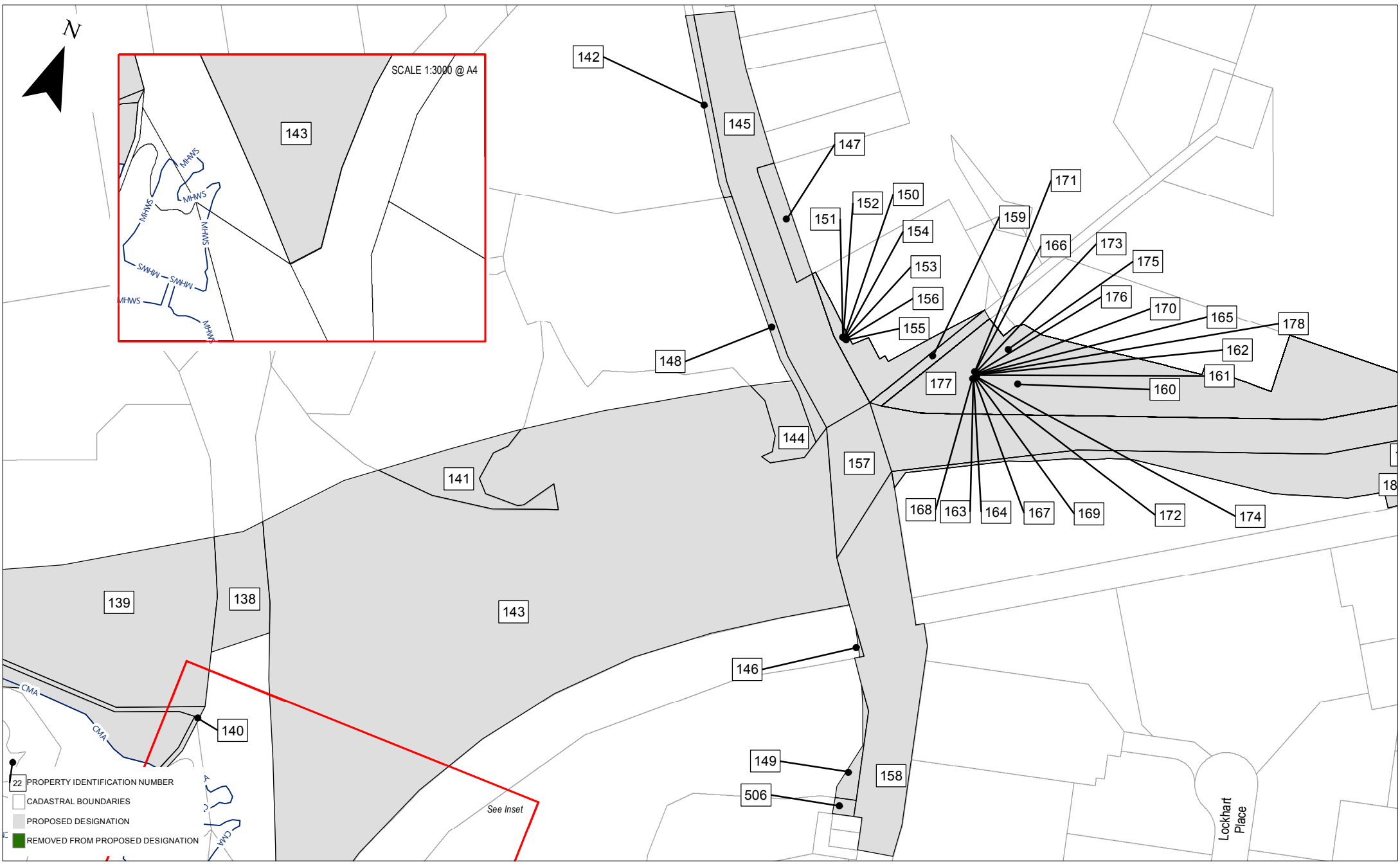
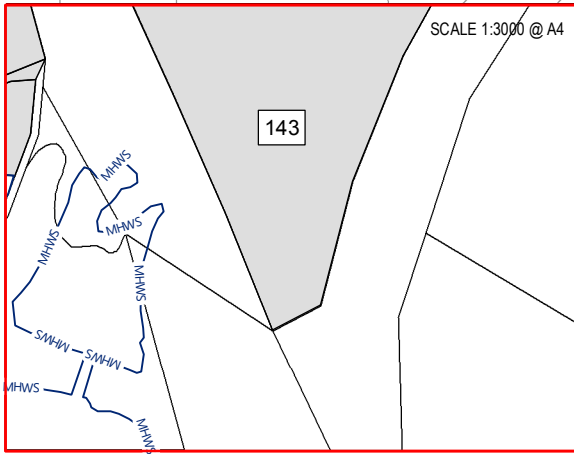

- 22 PROPERTY IDENTIFICATION NUMBER
- CADASTRAL BOUNDARIES
- PROPOSED DESIGNATION
- REMOVED FROM PROPOSED DESIGNATION

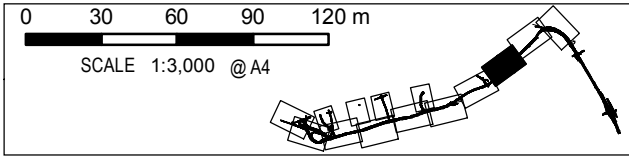

1	Issued For Board of Inquiry	BAP	LH	JC	27/06/17
No	Issued Status	Drawn	Check'd	App'd	Date

Project	EAST WEST LINK	
Drawing Title	PROPOSED DESIGNATION ANNS CREEK/SYLVA PARK ROAD SHEET 12	
Drawing Number	AEE-NOR-112	Rev No. 1

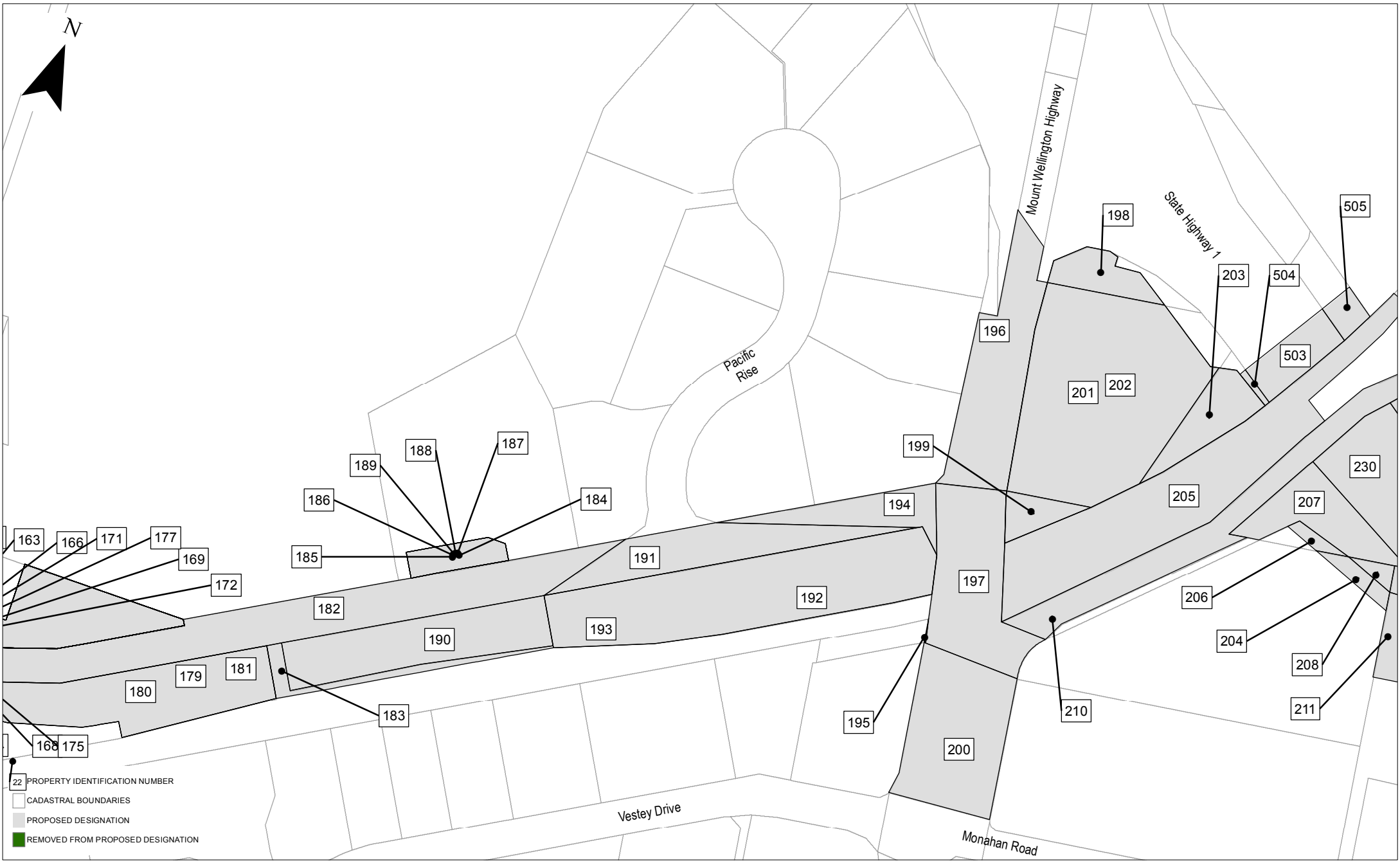

- 22 PROPERTY IDENTIFICATION NUMBER
- CADASTRAL BOUNDARIES
- PROPOSED DESIGNATION
- REMOVED FROM PROPOSED DESIGNATION

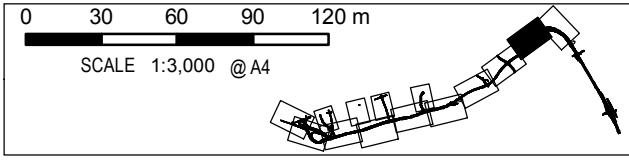

No	Issued Status	Drawn	Check'd	App'd	Date
1	Issued For Board of Inquiry	BAP	LH	JC	27/06/17

NZ TRANSPORT AGENCY
WAKA KOTAHĪ

East West Link

Project	EAST WEST LINK	
Drawing Title	PROPOSED DESIGNATION ANNS CREEK/SYLVA PARK ROAD SHEET 13	
Drawing Number	AEE-NOR-113	Rev No. 1

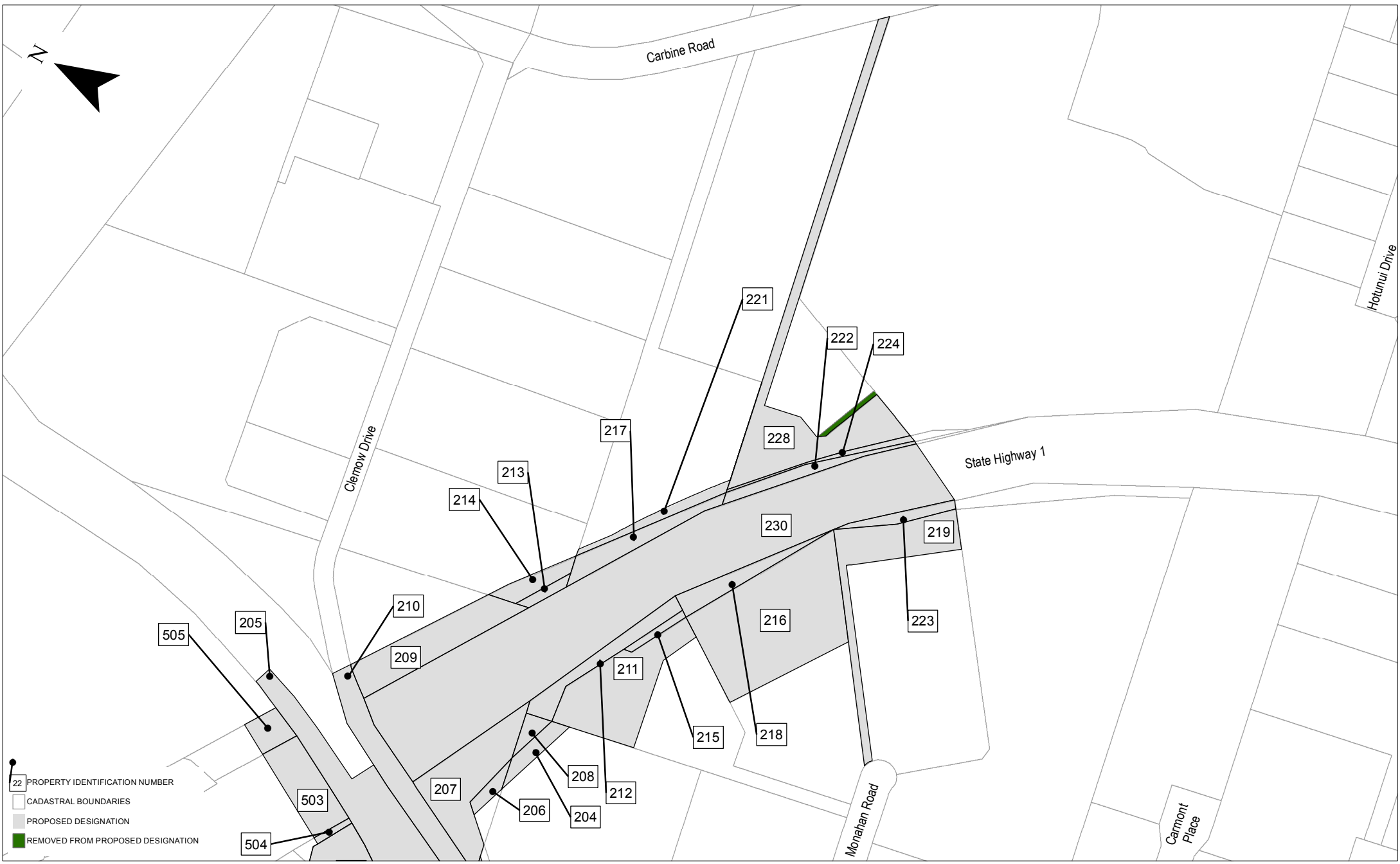

- 22 PROPERTY IDENTIFICATION NUMBER
- CADASTRAL BOUNDARIES
- PROPOSED DESIGNATION
- REMOVED FROM PROPOSED DESIGNATION

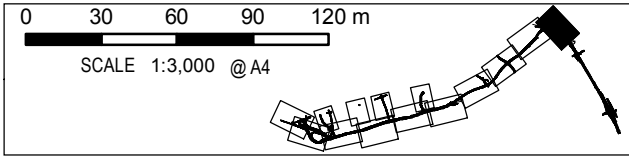

1	Issued For Board of Inquiry	BAP	LH	JC	27/06/17
No	Issued Status	Drawn	Check'd	App'd	Date

NZ TRANSPORT AGENCY
WAKA KOTAHĪ

East West Link

Project	EAST WEST LINK	
Drawing Title	PROPOSED DESIGNATION SH1/SYLVA PARK RAMPS - SHEET 14	
Drawing Number	AEE-NOR-114	Rev No. 1

Property Reference	Title	Legal Description	Address	December 2016 Land to be Designated (m ²)(approx)	June 2017 Land to be Designated (m ²)(approx)
1		Hydro		183	183
2		Road	State Highway 20	1188	1188
3	NA9B/1172	Part Tidal Lands Manukau Harbour Provincial Superintendents Grant	1 Orpheus Drive, Onehunga	159	159
4		Road	1 Orpheus Drive, Onehunga	4180	4180
5		Road	State Highway 20	107	107
6		Road	State Highway 20 off ramp	5620	5620
7		Road	Orpheus Drive	3	3
8		Road	State Highway 20	16095	16095
9	NA8D/1266	Lot 1 DP 55520	2 Hill Street, Onehunga	239	239
10		Part Tidal Lands Manukau Harbour Survey Office Plan 17449	1 Orpheus Drive, Onehunga	433	433
11		Road	Neilson Street on ramp	7	7
12	NA79D/201	Lot 1 DP 135208	11 Gloucester Park Road, Onehunga	18913	18913
13		Section 105 SO 443549	11 Gloucester Park Road, Onehunga	11	11
14	684126	Section 106 SO 443549		16	16
15		Road	Orpheus Drive	597	597
16		Road	Orpheus Drive	217	217
17		Road	Onehunga Harbour Road	1075	1075
18		Part Lot 6 DP 135212		104	104
20		Road	State Highway 20	458	458
21		Road	Gloucester Park Road, Onehunga	4118	4118
22		Road	State Highway 20	3352	3352
23	NA66B/285	Lot 1 DP 116495	62 Onehunga Mall, Onehunga	529	529
24		Road	Neilson Street	890	890
25		Road	Gloucester Park Road, Onehunga	945	945
26		Section 1 SO 463454	Gloucester Park Road, Onehunga	13	13
27		Part Lot 6 DP 135212		421	421
28		Section 2 SO 463454	Gloucester Park Road, Onehunga	18	18
29	634840	Section 12 SO 463454	10 Gloucester Park Road, Onehunga	251	251
30		Section 3 SO 463454	Neilson Street, Onehunga	238	238
31	634834	Section 13 SO 463454	10 Gloucester Park Road, Onehunga	136	136
32		Part Lot 6 DP 135212		16	16
33	634837	Section 14 SO 463454	31 Neilson Street, Onehunga	102	102
34		Section 4 SO 463454	Neilson Street, Onehunga	42	42
35		Road	Neilson Street, Onehunga	1552	1552
36		Section 11 SO 463454	Neilson Street, Onehunga	108	108
37		Section 5 SO 463454	Neilson Street, Onehunga	40	40
38		Section 6 SO 463454	Neilson Street, Onehunga	38	38
39		Road	Onehunga Harbour Road, Onehunga	20853	20853
40	NA79D/208	Lot 5 DP 135212	55 Onehunga Harbour Road, Onehunga	23255	23255
41		Road	State Highway 20	30397	30397
42		Part Provincial Superintendents GRANT		21	21
43	NA67C/132	Allot 2 Sec 50 VILL OF Onehunga	62 Onehunga Mall, Onehunga	7369	7369
43a	NA67C/132	Allot 1 Sec 50 VILL OF Onehunga	62 Onehunga Mall, Onehunga	8007	8007
44		Part Allot 19 Sec 30 VILL OF Onehunga		45	45
45		Part Allot 24 Sec 30 VILL OF Onehunga		27	27
46		Part Allot 18 Sec 30 VILL OF Onehunga		28	28
47		Road	Neilson Street, Onehunga	159	159
48	NA75C/79	Part Allot 18 Sec 30 VILL OF Onehunga	17 Onehunga Harbour Road, Onehunga	518	518
49		Part Allot 18 Sec 30 VILL OF Onehunga		21	21
50	NA75C/79	Part Allot 17 Sec 30 VILL OF Onehunga	19 Onehunga Harbour Road, Onehunga	280	280
51		Part Allot 17 Sec 30 VILL OF Onehunga		1	1
52	NA75C/79	Part Allot 17 Sec 30 VILL OF Onehunga		9	9
53		Part Allot 17 Sec 30 VILL OF Onehunga		15	15
54	NA75C/79	Part Allot 17 Sec 30 VILL OF Onehunga	21 Onehunga Harbour Road, Onehunga	242	242
55		Road	State Highway 20	833	833
56		Road	Neilson Street, Onehunga	709	709
57		Road	State Highway 20	258	258
58		Road	State Highway 20	36	36
59		Road	State Highway 20	149	149
60		Road	State Highway 20	707	707
61		Road	Onehunga Harbour Road, Onehunga	857	857
62		Stopped Road Survey Office Plan 61058		3	3
63	NA68B/92	Lot 1 DP 118654	62 Onehunga Mall, Onehunga	872	872
64		Road	State Highway 20	573	573
65		Road	Onehunga Mall	6537	6537
66		Road	Neilson Street	287	287
67		Road	State Highway 20	2639	2639
68		Road	State Highway 20	1795	1795
69		Road	State Highway 20	779	779
70		Road	Onehunga Mall	2342	2342
71		Road	State Highway 20	473	473
72		Road	Onehunga Harbour Road, Onehunga	1928	1928
73		Part Lot 2 DP 78168	Onehunga Harbour Road, Onehunga	10	10
74	NA79D/206	Lot 3 DP 135212	Onehunga Harbour Road, Onehunga	2496	2496

Property Reference	Title	Legal Description	Address	December 2016 Land to be Designated (m ²)(approx)	June 2017 Land to be Designated (m ²)(approx)
75	NA90D/45	Allot 26 Sec 30 VILL OF Onehunga	45 Onehunga Mall, Onehunga	89	89
76	NA34B/815	Part Lot 2 DP 78168	Onehunga Harbour Road, Onehunga	11600	11552
77		Road	Onehunga Harbour Road, Onehunga	3841	3841
78	NA55A/1469	Allot 28 Sec 30 VILL OF Onehunga	49/53 Onehunga Mall, Onehunga	1499	1499
79		Part Allot 14 Sec 30 VILL OF Onehunga	Onehunga Harbour Road, Onehunga	11	11
80		Road	Neilson Street, Onehunga	1138	1138
81	NA88A/502	Lot 1 DP 148012	51 Onehunga Mall, Onehunga	2807	2807
82		Part Lot 2 DP 78168	Onehunga Harbour Road, Onehunga	39	39
83	NA114A/189	Lot 1 DP 83928	10C Galway Street, Onehunga	648	648
84	NA114A/188	Lot 1 DP 83928	10A Galway Street, Onehunga		
85	NA114A/187	Lot 1 DP 83928	10B Galway Street, Onehunga		
86		Lot 2 DP 135212	Onehunga Harbour Road, Onehunga	1835	1835
87		Road	Galway Street, Onehunga	715	715
88		Road	Neilson Street, Onehunga	846	846
89	NA79C/555	Lot 1 DP 134890	2 Galway Street, Onehunga	5214	5214
90		Road	Galway Street, Onehunga	3644	3644
91	NA79D/204	Lot 1 DP 135212	2A Galway Street, Onehunga	10007	10007
92		Road	Neilson Street, Onehunga	1118	1118
93		Hydro		7497	7497
94	NA75B/609	Part Lot 1 DP 25356	12A Alfred Street, Onehunga	11041	11041
95		Road	Alfred Street, Onehunga	1695	1695
96		Road	Alfred Street, Onehunga	9757	9757
97	NA5D/49	Part Allot 80 SM LOTS NEAR Onehunga	Alfred Street, Onehunga	1010	1010
98	NA5D/49	Lot 2 DP 25356	Alfred Street, Onehunga	157	157
99	NA5D/49	Allot 87 SM LOTS NEAR Onehunga	Alfred Street, Onehunga	11	11
100	NA126A/34	Lot 2 DP 197172	7 Alfred Street, Onehunga	127	127
101	NA5D/49	Lot 6 DP 25356	Alfred Street, Onehunga	1038	1038
102		Road	Neilson Street, Onehunga	6066	6066
103	NA2D/763	Allot S45 SM LOTS NEAR Onehunga	Alfred Street, Onehunga	664	664
104	NA47A/1200	Part Allot 48 SM LOTS NEAR Onehunga	175 Neilson Street, Onehunga	47	47
105	169420	Lot 3 DP 329311	Alfred Street, Onehunga	391	391
106	570696	Section 1 SO 410849	60 Captain Springs Road, Onehunga	43377	43377
107	NA47B/1066	Lot 3 DP 90270	Captain Springs Road, Onehunga	11057	11057
108		Road	Captain Springs Road, Onehunga	916	916
109	NA55B/946	Part Allot 86 SM LOTS NEAR Onehunga	96 Captain Springs Road, Onehunga	5	5
110		Lot 5 DP 32371		11	11
111	NA28A/755	Allot 96 SM LOTS NEAR Onehunga	98 Captain Springs Road, Onehunga	21	21
112		Road	Neilson Street, Onehunga	472	472
113		Lot 6 DP 30886		11	11
114		Road	Captain Springs Road, Onehunga	6267	6267
115	NA47D/321	Lot 1 DP 90441	249 Neilson Street, Onehunga	148	148
116		Hydro		111	111
117	169419	Part Lot 1 DP 90270	69 Captain Springs Road, Onehunga	10237	10237
118		Road	Neilson Street, Onehunga	3215	3215
119	NA47B/1067	Lot 4 DP 90270		3306	3306
120	NA129C/906	Lot 1 DP 200894	5-9 Miami Parade, Onehunga	12045	12045
121	NA73A/107	Lot 1 DP 125073		2636	2636
122	NA32C/1384	Lot 3 DP 76300	13 Miami Parade, Onehunga	2908	2908
123		Road	Miami Parade, Onehunga	293	293
124	NA79D/202	Lot 1 DP 135209	39 Miami Parade, Onehunga	9981	9826
125		Part Tidal Lands Manukau Harbour Survey Office Plan 47311		321	321
126		Part Tidal Lands Manukau Harbour Block V Otahuhu Survey District		114	114
127	NA53C/560	Lot 1 DP 98342		25986	25986
128	527870	Part Lot 2 DP 98342	59 Miami Parade, Penrose	10076	10076
129	NA53C/561	Part Lot 2 DP 98342	59 Miami Parade, Penrose	127139	127139
130		Hydro		64	64
131		Part Allot 45 Sec 17 SBRS OF Auckland		277	277
132	NA58A/668	Lot 1 DP 105353		3379	3379
133		Part Tidal Lands Manukau Harbour Survey Office Plan 53682		1687	1687
134		Lot 15 DP 127210	Hugo Johnston Drive, Penrose	5735	5735
135		Part Allot 6 & 7 Sec 17 SBRS OF Auckland		10993	10993
136	NA76A/550	Lot 4 DP 129768	141 Hugo Johnston Drive, Penrose	30315	30315
137		Part Tidal Lands Manukau Harbour Survey Office Plan 47311		22	22
138		Railway	North Auckland Line - Rail Corridor	2223	2223
139	NA109D/643	Lot 1 DP 178192	164 Hugo Johnston Drive, Penrose	13611	13611
140	40711	Lot 19 DP 129768	Hugo Johnston Drive, Penrose	957	957
141	115791	Lot 3 DP 328383	787 Great South Road, Penrose	1999	1999
142		Section 1 SO 350422	Great South Road, Penrose	574	574
143	NA125B/43	Section 1 SO 69440	791 Great South Road, Penrose	59677	59677
144	115789	Lot 1 DP 328383	781 Great South Road, Penrose	1143	1143
145		Road	Great South Road, Penrose	6936	6936
146		Railway	North Island Main Trunk - Rail Corridor	26	26

Property Reference	Title	Legal Description	Address	December 2016 Land to be Designated (m ²)(approx)	June 2017 Land to be Designated (m ²)(approx)
147		Section 2 SO 350422	Great South Road, Penrose	813	813
148		Lot 6 DP 328383	Great South Road, Penrose	861	861
149	NA99D/778	Lot 1 DP 165508	801 Great South Road, Mount Wellington	340	340
150	NA107C/885	Part Allot 251 Sec 12 SBRS OF Auckland	1016 Great South Road, Mount Wellington	1440	1440
151	NA107C/880	Part Allot 251 Sec 12 SBRS OF Auckland	1016B Great South Road, Mount Wellington		
152	NA102D/952	Part Allot 251 Sec 12 SBRS OF Auckland	1016F Great South Road, Mount Wellington		
153	NA107C/882	Part Allot 251 Sec 12 SBRS OF Auckland	1016D Great South Road, Mount Wellington		
154	NA107C/879	Part Allot 251 Sec 12 SBRS OF Auckland	1016A Great South Road, Mount Wellington		
155	NA107C/883	Part Allot 251 Sec 12 SBRS OF Auckland	1016E Great South Road, Mount Wellington		
156	NA107C/881	Part Allot 251 Sec 12 SBRS OF Auckland	1016C Great South Road, Mount Wellington		
157		Road	Great South Road, Penrose	2199	2199
158		Road	Great South Road, Penrose	7399	7399
159	NA9B/28	Part Hamlins GRANT	1018B Great South Road, Greenlane	540	540
160	NA74D/195	Lot 3 DP 120402	20 Sylvia Park Road, Mount Wellington	11862	11862
161	NA74D/191	Lot 3 DP 120402	20F Sylvia Park Road, Mount Wellington		
162	NA74D/190	Lot 3 DP 120402	20E Sylvia Park Road, Mount Wellington		
163	NA74D/880	Lot 3 DP 120402	20N Sylvia Park Road, Mount Wellington		
164	NA74D/187	Lot 3 DP 120402	20B Sylvia Park Road, Mount Wellington		
165	NA84A/349	Lot 3 DP 120402	20L Sylvia Park Road, Mount Wellington		
166	NA78D/596	Lot 3 DP 120402	22 Sylvia Park Road, Mount Wellington		
167	NA77D/981	Lot 3 DP 120402	20Q Sylvia Park Road, Mount Wellington		
168	NA74D/881	Lot 3 DP 120402	20O Sylvia Park Road, Mount Wellington		
169	NA74D/189	Lot 3 DP 120402	20D Sylvia Park Road, Mount Wellington		
170	NA81B/581	Lot 3 DP 120402	20P Sylvia Park Road, Mount Wellington		
171	NA74D/188	Lot 3 DP 120402	20C Sylvia Park Road, Mount Wellington		
172	NA77D/710	Lot 3 DP 120402	24 Sylvia Park Road, Mount Wellington		
173	NA81B/583	Lot 3 DP 120402	20R Sylvia Park Road, Mount Wellington		
174	NA74D/194	Lot 3 DP 120402	20I Sylvia Park Road, Mount Wellington		
175	NA74D/193	Lot 3 DP 120402	20H Sylvia Park Road, Mount Wellington		
176	NA74D/879	Lot 3 DP 120402	20M Sylvia Park Road, Mount Wellington		
177	NA74D/186	Lot 3 DP 120402	20D Sylvia Park Road, Mount Wellington		
178	NA74D/192	Lot 3 DP 120402	20G Sylvia Park Road, Mount Wellington		
179	614588	Lot 1 DP 65735	13 Sylvia Park Road, Mount Wellington	7254	7254
180	NA87A/213	Lot 1 DP 65735	13 Sylvia Park Road, Mount Wellington		
181	566972	Lot 1 DP 65735	13 Sylvia Park Road, Mount Wellington		
182		Road	Sylvia Park Road, Mount Wellington	14781	14781
183		Railway	North Island Main Trunk - Rail Corridor	881	881
184	NA75D/314	Lot 10 DP 126310	8E Sylvia Park Road, Mount Wellington	961	961
185	NA75D/315	Lot 10 DP 126310	8 Sylvia Park Road, Mount Wellington		
186	NA75D/310	Lot 10 DP 126310	8A Sylvia Park Road, Mount Wellington		
187	NA75D/312	Lot 10 DP 126310	8C Sylvia Park Road, Mount Wellington		
188	NA75D/311	Lot 10 DP 126310	8B Sylvia Park Road, Mount Wellington		
189	NA75D/313	Lot 10 DP 126310	8D Sylvia Park Road, Mount Wellington		
190	NA25A/941	Lot 1 DP 68984	9 Sylvia Park Road, Mount Wellington	4877	4877
191		Road	Sylvia Park Road, Mount Wellington	3658	3658
192	NA25A/942	Lot 2 DP 68984	1 Sylvia Park Road, Mount Wellington	9910	9910
193	560832	Lot 2 DP 68984	1 Sylvia Park Road, Mount Wellington		
194		Road	Sylvia Park Road, Mount Wellington	1958	1958
195	NA76A/800	Lot 2 DP 129910	451 Mount Wellington Highway, Mount Wellington	7	7
196		Road	Mount Wellington Highway, Mount Wellington	5330	5330
197		Road	Mount Wellington Highway, Mount Wellington	5109	5109
198	NA132B/787	Lot 1 DP 203872	400 Mount Wellington Highway, Mount Wellington	1312	1312
199	NA133C/256	Lot 1 DP 193989	430 Mount Wellington Highway, Mount Wellington	849	849
200		Road	Mount Wellington Highway, Mount Wellington	5579	5579
201	NA133C/233	Lot 1 DP 188694	430 Mount Wellington Highway, Mount Wellington	12032	12032
202	467447	Lot 1 DP 188694 (this is a lease of 16014m ² registered over only property reference 201, but includes the land in property references 198, 199 and 203)	430 Mount Wellington Highway, Mount Wellington	-	-
203	NA132B/788	Lot 2 DP 203872	450 Mount Wellington Highway, Mount Wellington	1821	1821
204	NA63A/803	Part Lot 2 DP 40344	2 Monahan Road, Mount Wellington	457	457
205		Railway	North Island Main Trunk - Rail Corridor	9567	9567
206	NA63A/803	Section 37 Block II Otahuhu SD	2 Monahan Road, Mount Wellington	252	252
207		Road	State Highway 1	2565	2565
208		Road	State Highway 1	243	243
209		Road	State Highway 1	2169	2169
210		Road	Clemow Drive, Mount Wellington	4632	4632
211	NA6B/265	Part Lot 1 DP 54821	4 Monahan Road, Mount Wellington	2945	2945
212		Road	State Highway 1	1036	1036
213		Road	State Highway 1	199	199

Property Reference	Title	Legal Description	Address	December 2016 Land to be Designated (m ²)(approx)	June 2017 Land to be Designated (m ²)(approx)
214		Road	State Highway 1	521	521
215		Road	State Highway 1	192	192
216	NA10C/298	Part Lot 2 DP 54821	6 Monahan Road, Mount Wellington	5834	5834
217		Road	State Highway 1	974	974
218		Road	State Highway 1	794	794
219	NA45C/753	Part Lot 2 DP 88040	8 Monahan Road, Mount Wellington	2331	2331
221	NA72A/244	Lot 2 DP 123390	99A Carbine Road, Mt Wellington	514	514
222		Road	State Highway 1	614	614
223		Road	State Highway 1	395	395
224		Marked D SO 63588	State Highway 1	254	254
228	NA60C/968	Part Lot 1 DP 108502	103 Carbine Road, Mount Wellington	4402	4274
230		Road	State Highway 1	16758	16758
501	NA52B/757	Allot 53 Sec 17 SBRS OF Auckland	Neilson Street, Onehunga	4146	4146
501a	NA52B/757	Allot 54 Sec 17 SBRS OF Auckland	Neilson Street, Onehunga	42	42
503		Road	State Highway 1	1475	1475
504		Road	State Highway 1 off ramp	99	99
505		Road	State Highway 1 off ramp	492	492
506	42274	Lot 2 DP 165508	811-813 Great South Road	132	132