

A new tool for CoPTTM

One size fits all

Delineation-Fencing-Barricades



The situation – delineation-fencing-barricades

Key tools in TTM are:

- Cones for delineation
- Fences for separation
- Barricades for closures



The situation – delineation-fencing-barricades

These tools are often
used in other roles:

- Cones for fencing
- Fences for delineation
- Plastic Barricades for safety barriers



There can be problems

- Cones are blown or knocked over



There can be problems

- Barricades are mistaken for barriers and will not stop a car penetrating the worksite.



- [01-Crash.flv](#)

There can be problems

- A recent trend has been to use barriers as barricades.



There can be problems

- Fences do not always separate and protect.



There can be problems

- Fences require additional delineation.

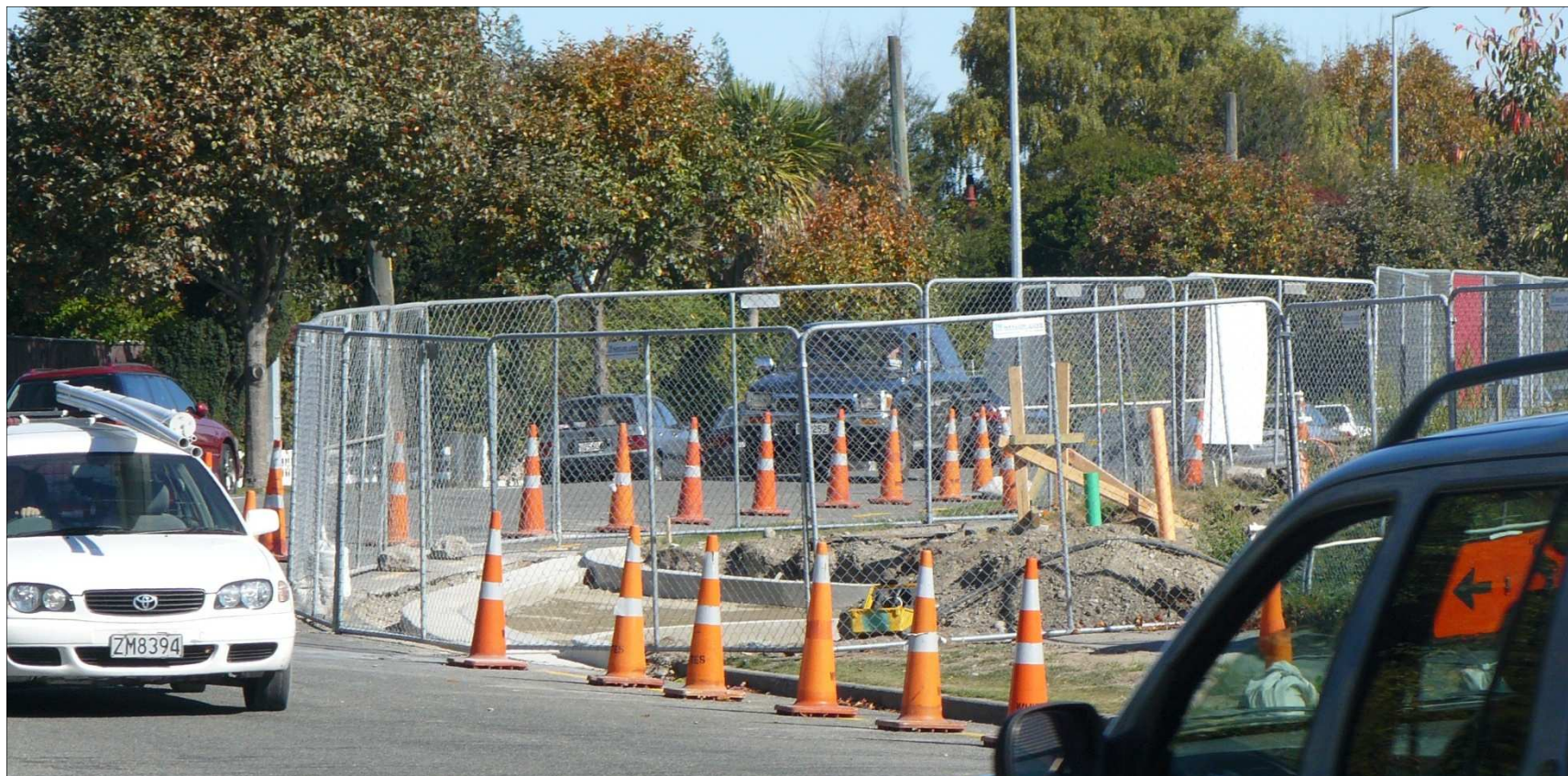



NZ TRANSPORT AGENCY
WAKA KOTAHI

Is there a solution?

**Is there a way we can tidy
up this situation?**

What do Cones, Fences and Barricades have in Common?

Colour

- Cones and barricades must be **fluorescent orange** with:
 - chromaticity coordinates - table 2.5 of AS/NZS 1906.1:2007,
 - minimum luminance factors - table 2.8 of AS/NZS 1906.1:2007.
 - Fences do not require a colour

What do Cones, Fences and Barricades have in Common?

Height

- Cones have a minimum height of **900mm**
- Fences must be **1000 mm**
- Barricades with sight boards have a minimum height of **975mm**

What do Cones, Fences and Barricades have in Common?

Retro-reflectivity

Cones must have white retro-reflective bands that are:

- class 1 high intensity sheeting in table 2.2 of AS/NZS 1906.1:2007, and
- Bands must conform to the width and height requirements
- Fences and barricades do not require retro-reflective bands, but must have a line of cones facing the traffic

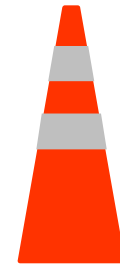



NZ TRANSPORT AGENCY
WAKA KOTAHI

What is the solution?

**Lets start at the
beginning with a cone**

Delineators

Cone

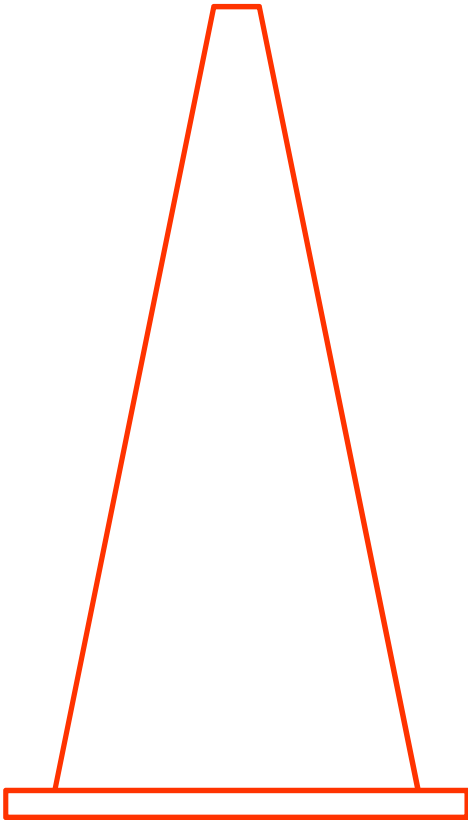

Delineators

Cone

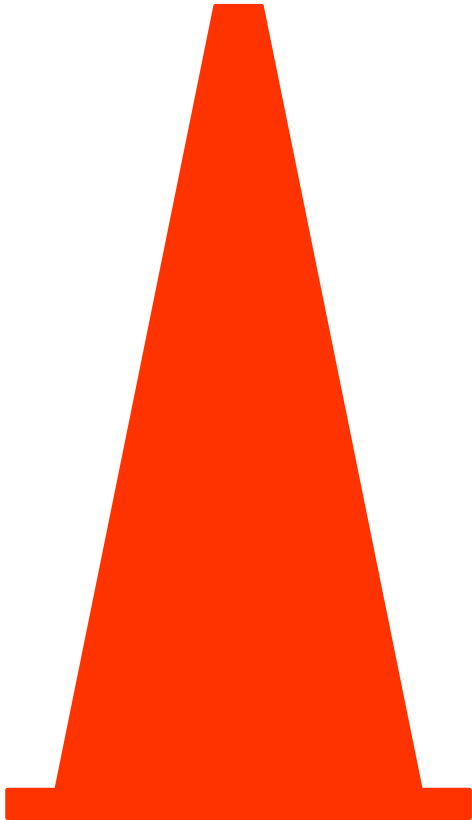

Delineators

Cone

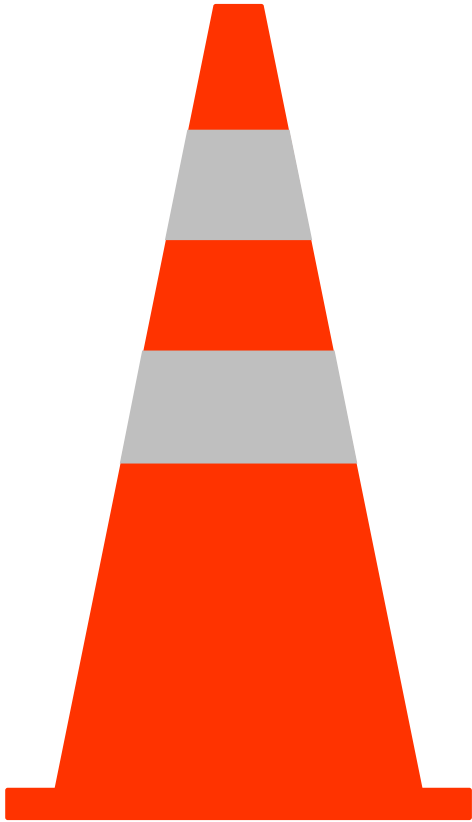

Delineators

Cone

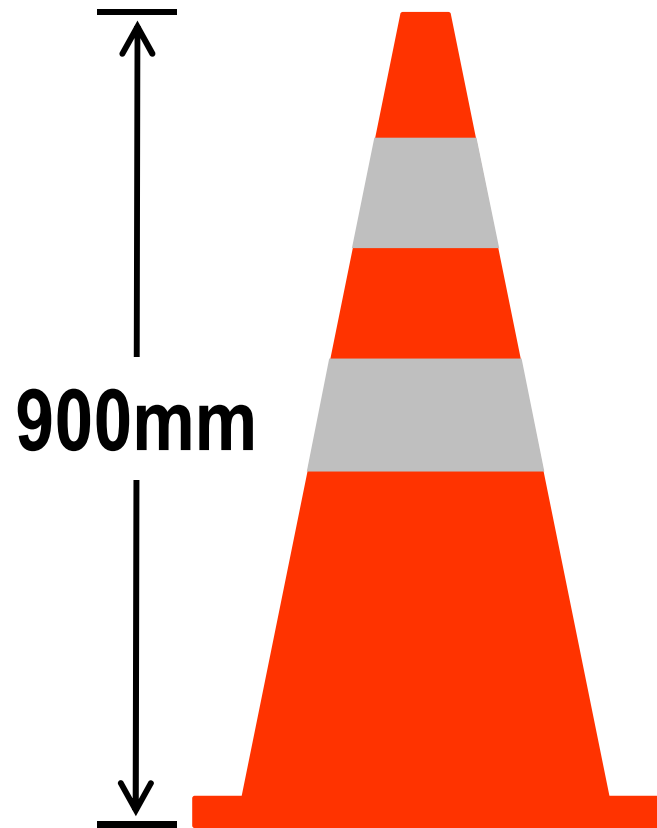

Delineators

Cone

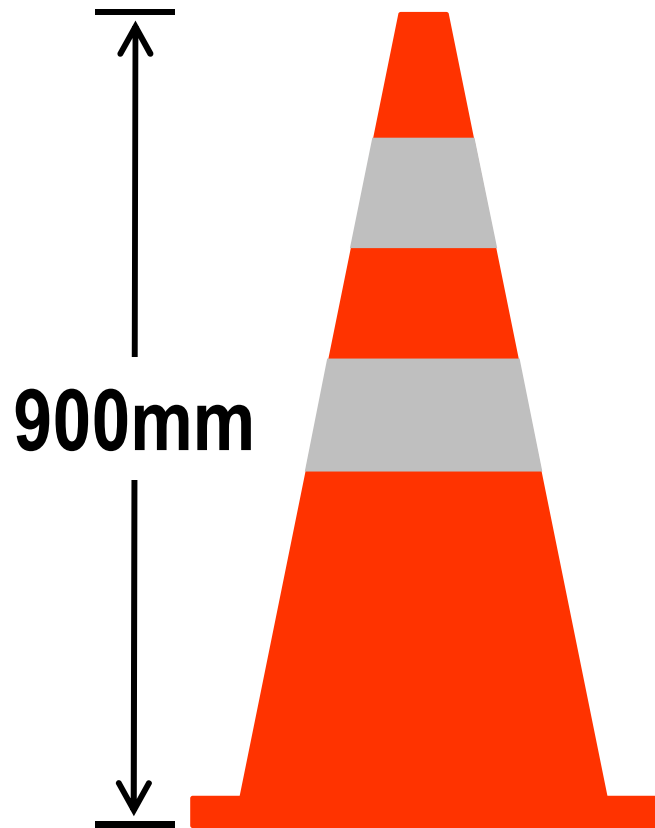

Tubular delineator

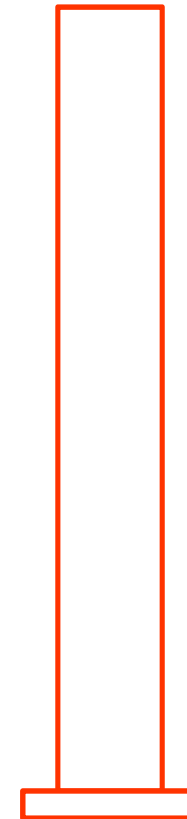

Delineators

Cone

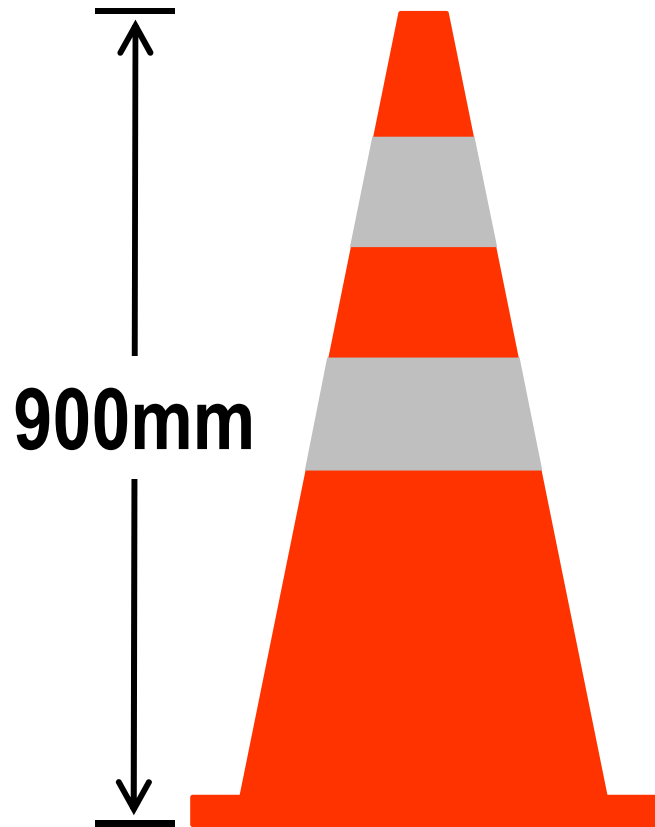

Tubular delineator



Delineators

Cone

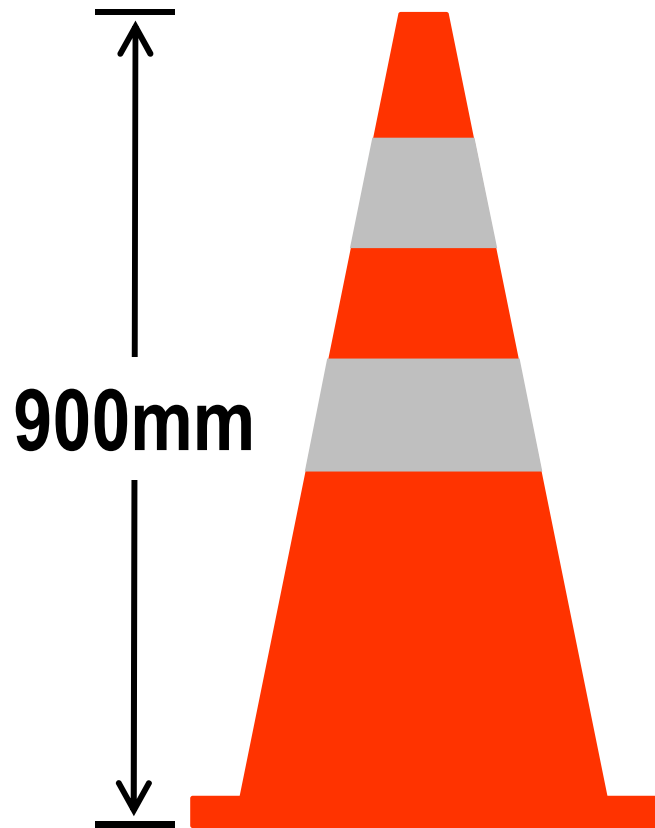

Tubular delineator

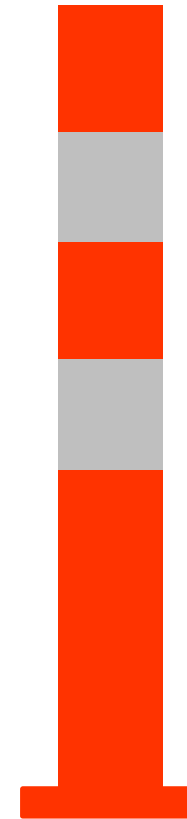

Delineators

Cone

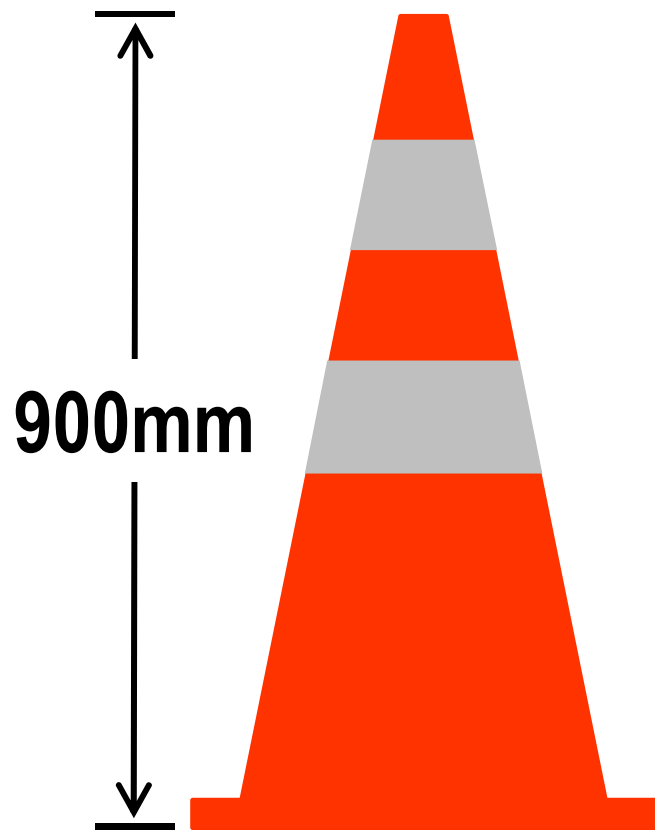

Tubular delineator

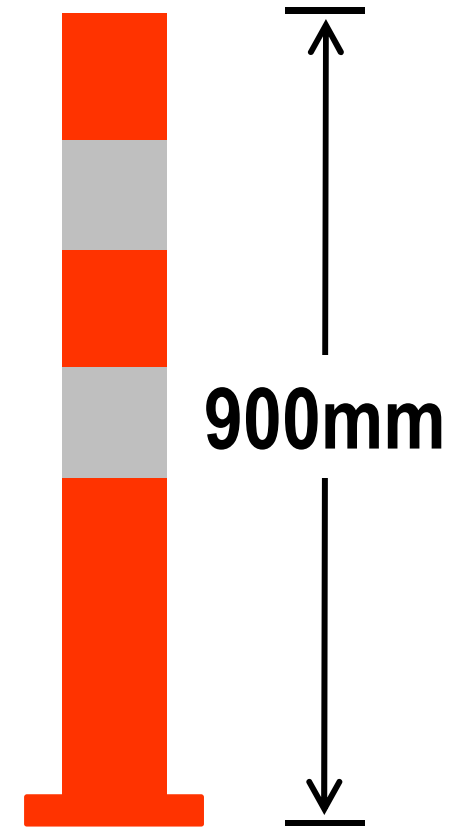

Barricades



Barricades

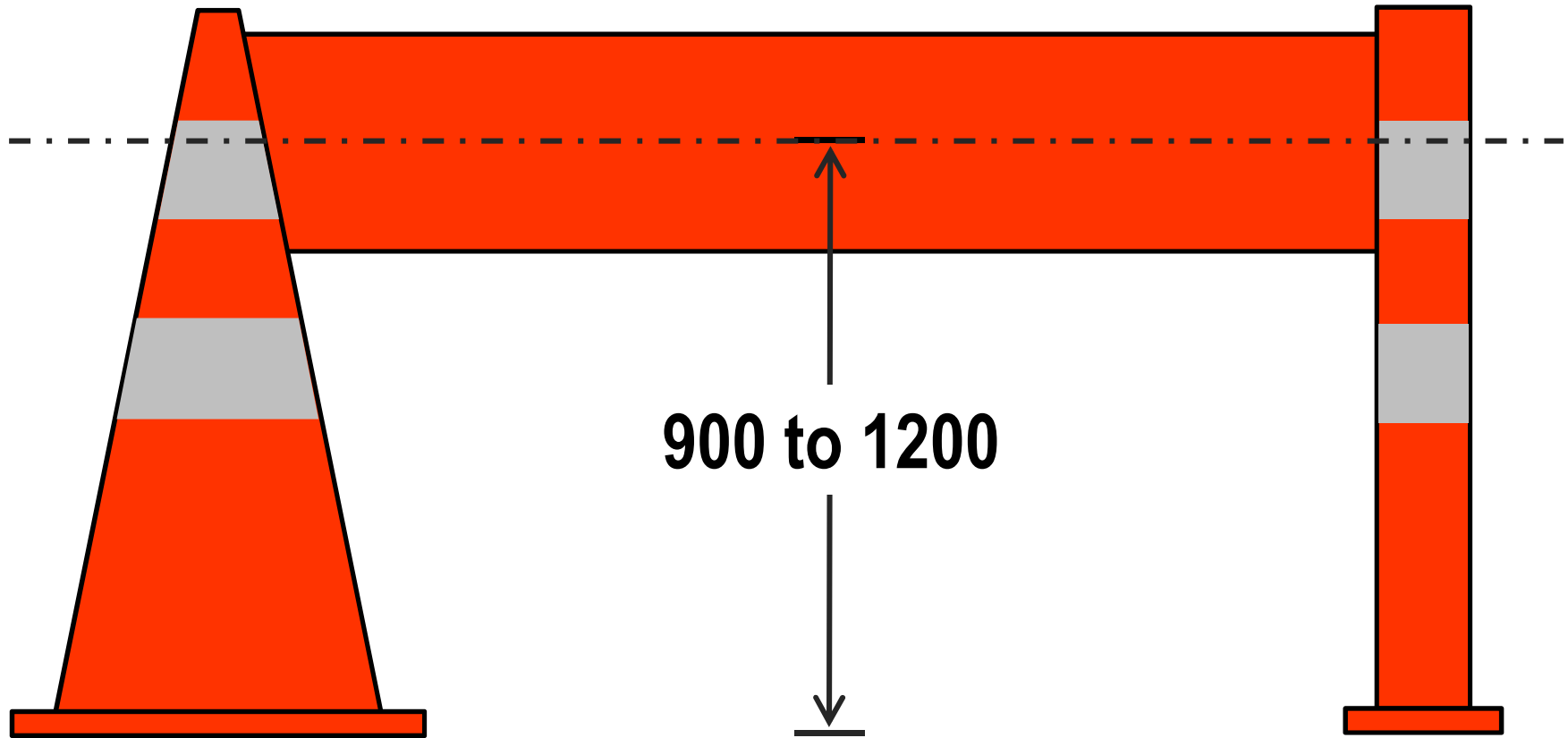

Barricades

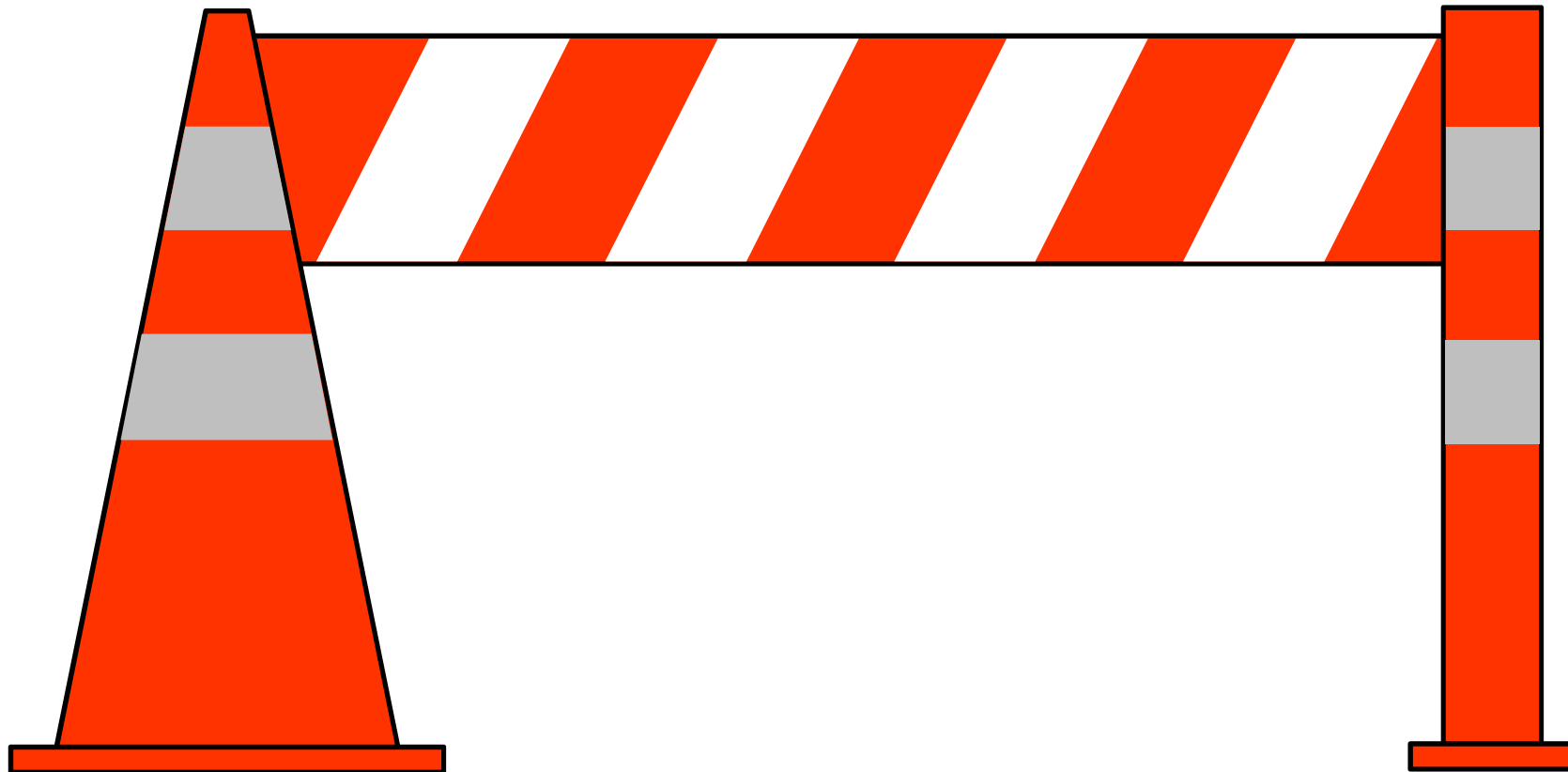

Fences

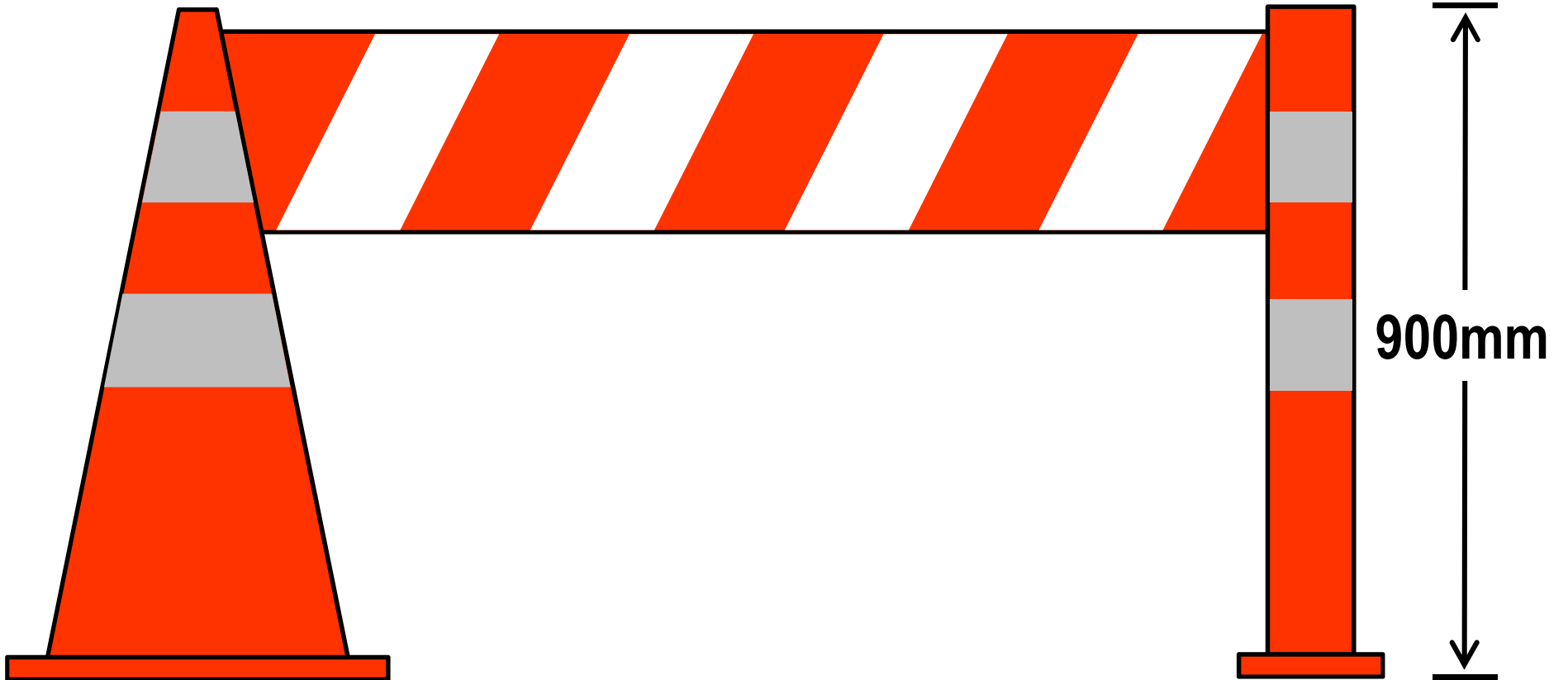

Fences

Secure top and bottom rail & at least 1m high

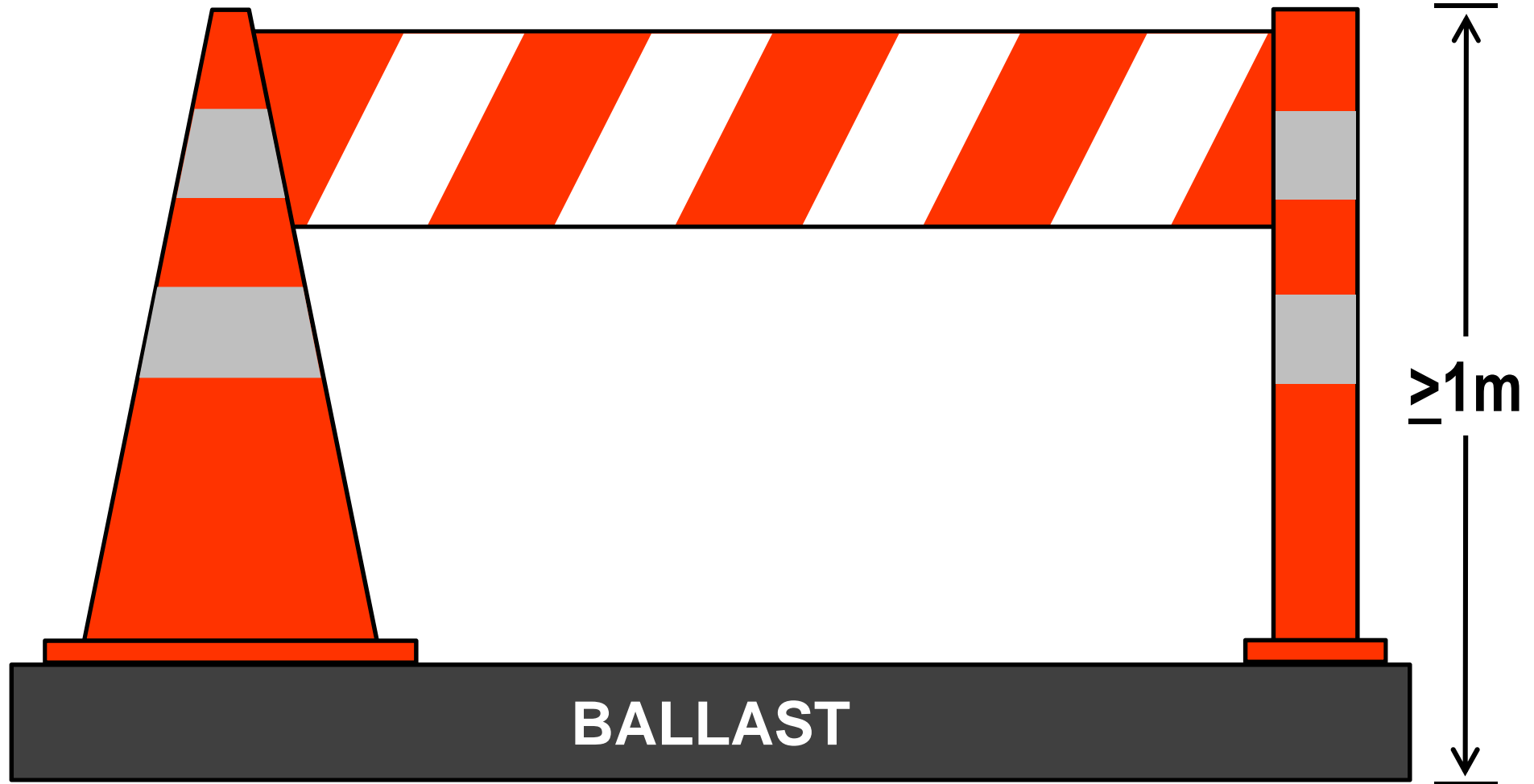

Fences

Child proof infill

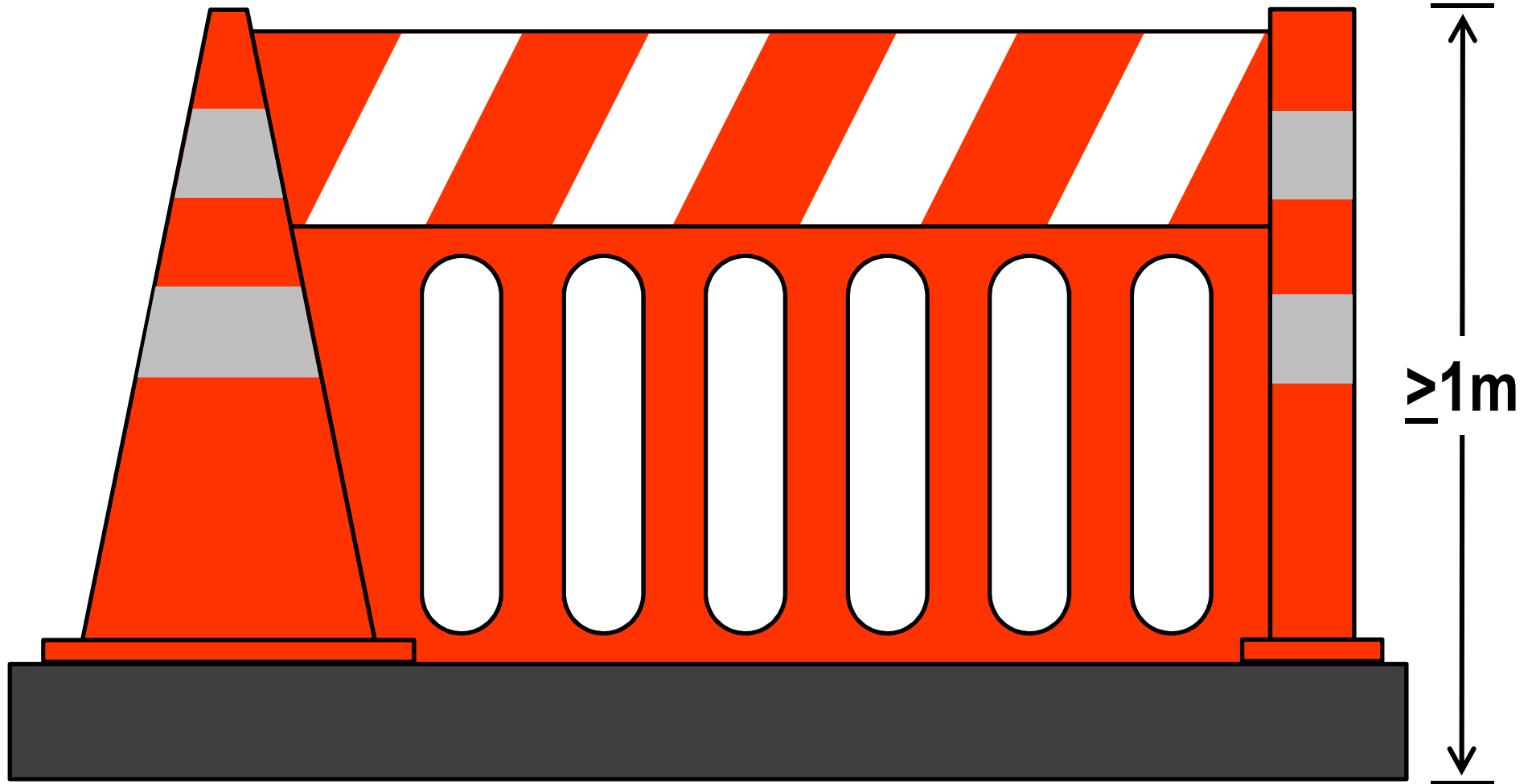

Fences

Clip together

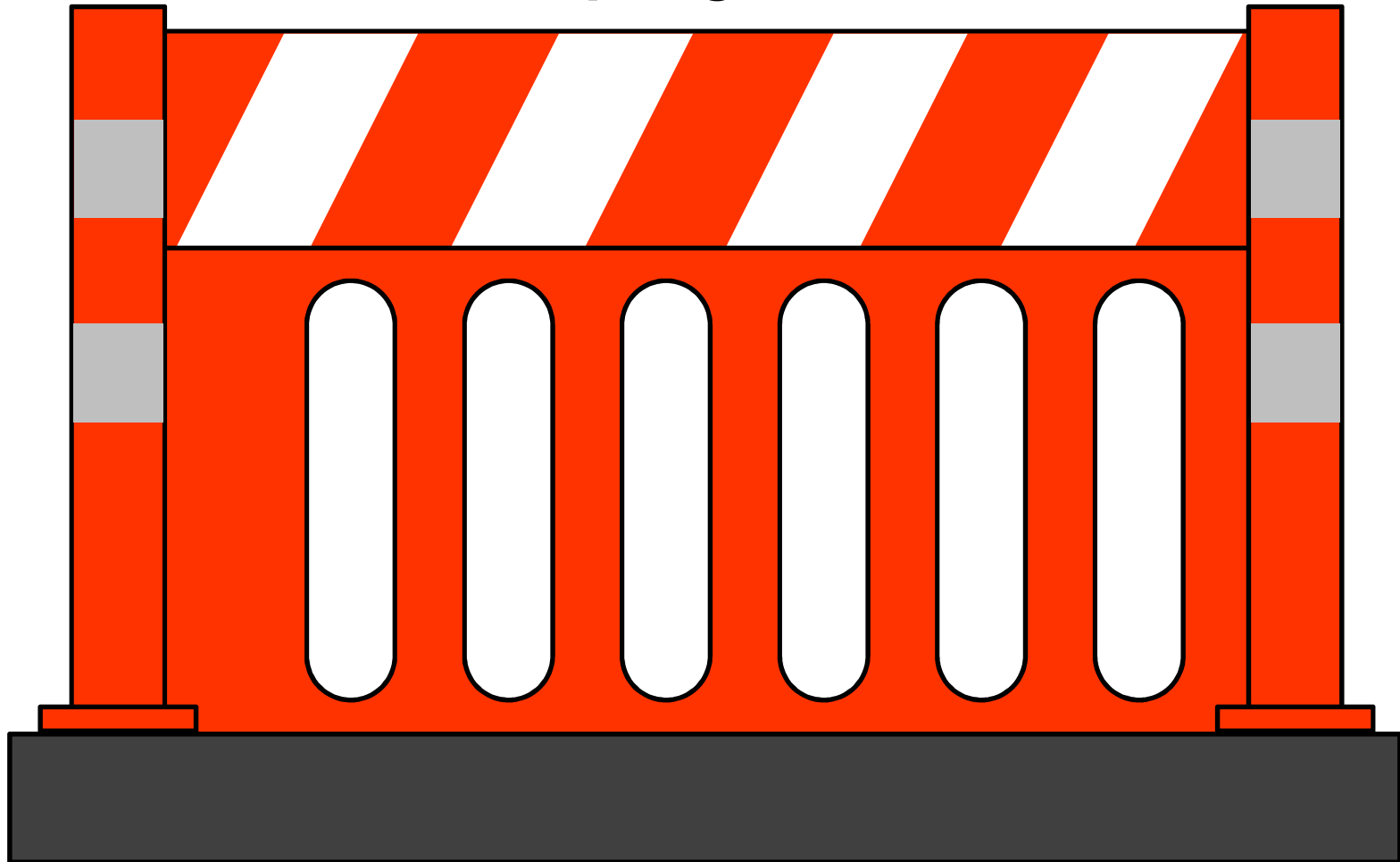

Fences

Clip together

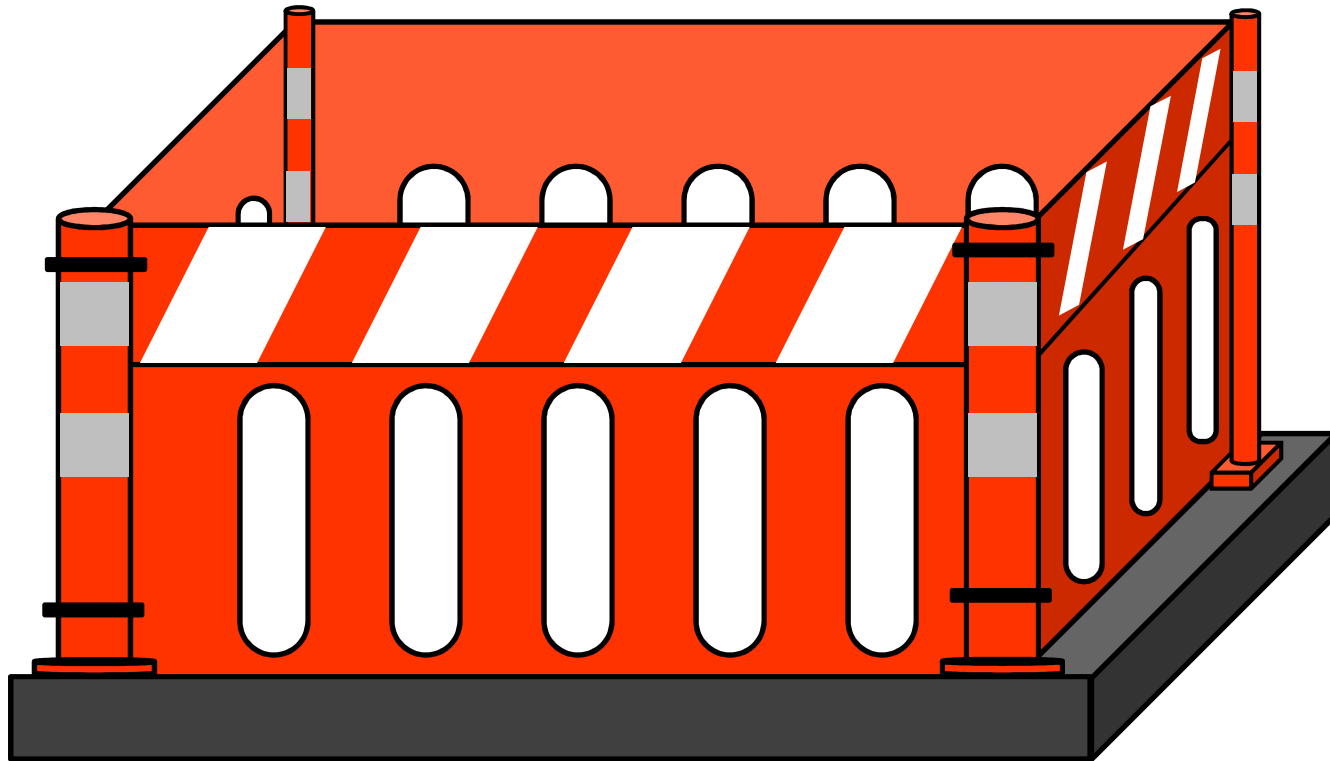

Fences

Clip together

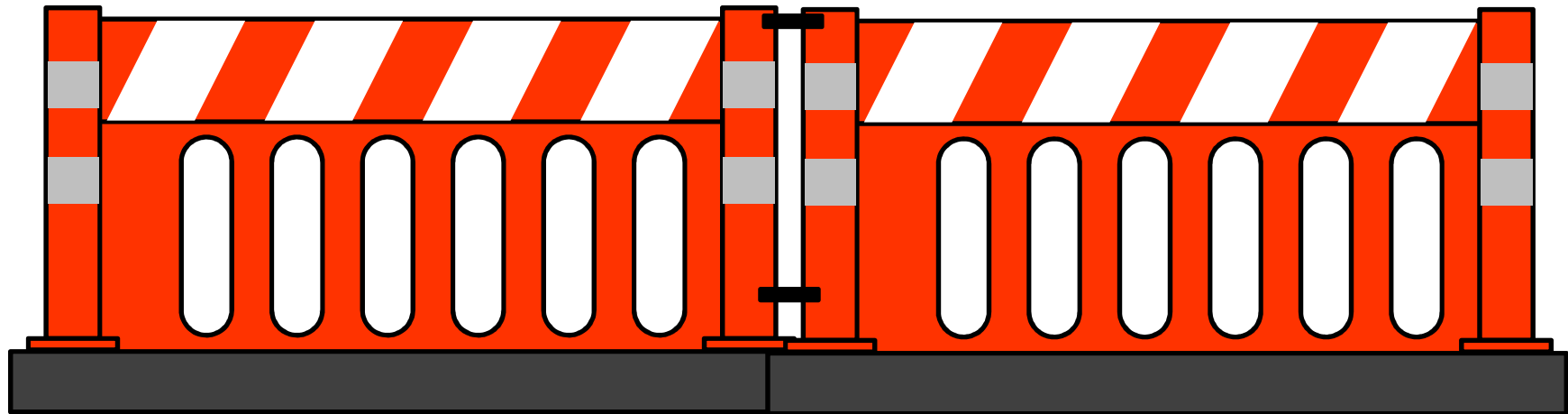

Advantages

- A single tool to provide both a fence and delineation in areas < 65 km/h
- Avoid a false sense of security provided by imitation barriers
- Save money, no need to use barriers
- More stable than cones

Draft Specification and Planning Meeting

NZTA has:

- developed a draft specification
- planned a consultation meeting for Friday 16 August 2013 – For a copy of the draft specification and /or to attend the meeting email:
 - Copttm.consult@nzta.govt.nz