

Through extensive consultation with Iwi, ACC and the Alliance design team, a set of design ideas and concepts were generated at a broad scale for the VPT route and immediate context. Encompassing cultural values, history and geology, these concepts have been developed and refined, continually influencing the design process.

● KI TAI
- the sea

Westhaven Drive retaining wall
Reference is given to the ocean through the abstracted form of a fish which has been used to create a textural relief within the retaining wall.

● KUPENGA
- fish net

Pedestrian bridge
The pedestrian bridge and the link with Jacob's ladder forms a re-connection between the land and the sea. The cladding of the bridge is representative of a draped fish net.

● POUHERE KUTA
- lashing and binding of structural elements using kuta

Egress structures
Design of the egress structures reflects the concepts of lashing and binding while the form and materials respond sympathetically to the immediate context of Victoria Park.



● TE ROUTU UREIA

Point Erin
Landscape design responds to former foreshore environment

● KI UTA
- land / foreshore

St. Mary's Bay Acoustic barrier
Form of barrier responds to ebb and flow of foreshore environment and reflects the form of the cliffline

● TE ONEROA A HUATAU
- long beach of Huatau

Westhaven Drive TL5 barrier
Text relief in barrier facing Westhaven drive

● TE TO
- Te To Point

Westhaven Drive TL5 barrier
The retaining wall adjacent to the VCC land is split into a lower and upper part, with the upper making reference to palisading and relating to concepts of kupenga, lashing and binding.

● WAIKOKOTA
- a shallow bay abundant with shellfish

Rob Roy sector
The former shallow foreshore and river mouth is reflected in the ground plane, while lighting installations reference the historical planting of native kuta reed beds.

● TUNA MAU
- a stream abundant with eels

Tunnel approach retaining walls
The precast cladding for the approach walls have a tilted form of 50 - 100mm as a representation of the form of an eel, also responding to the curvature of the alignment

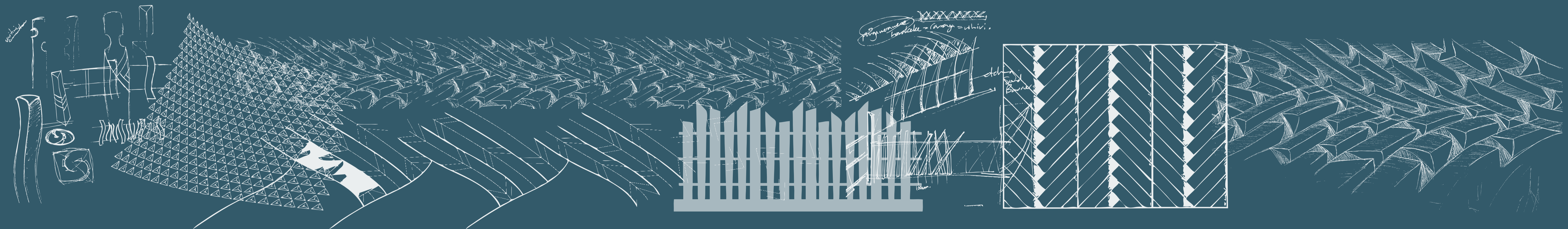

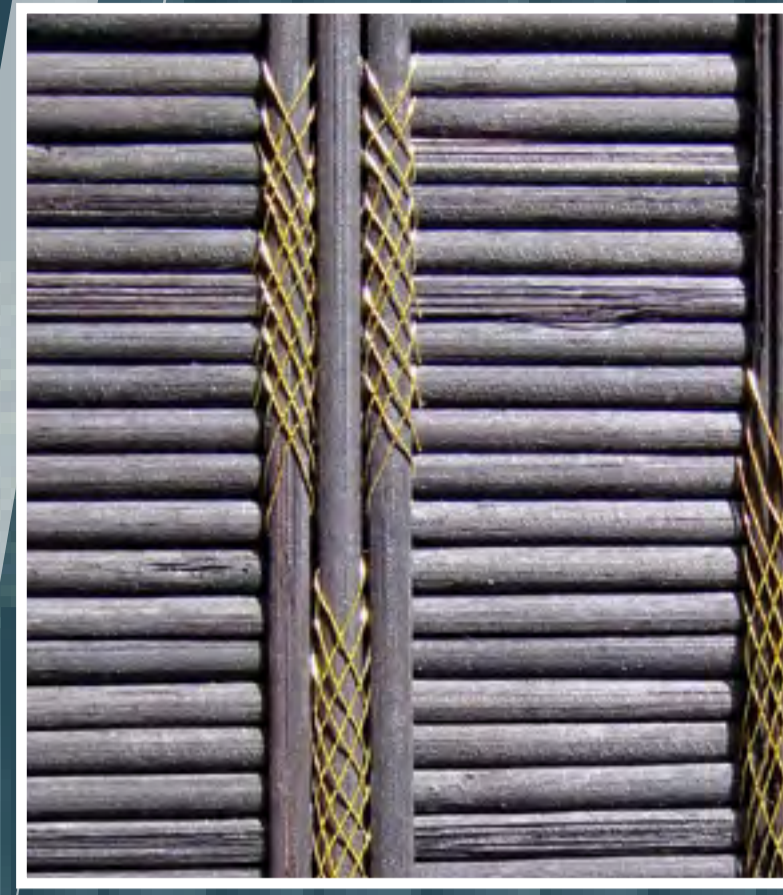

egress structures

Pouhere kuta Lashing and binding of structural elements using kuta

The tunnel egress structures form *sculptural elements* that sit sympathetically within the context of Victoria Park. Historic references to *lashing and binding* inform the detailed design components, responding to and reinforcing the *conceptual language* running throughout the VPT route.

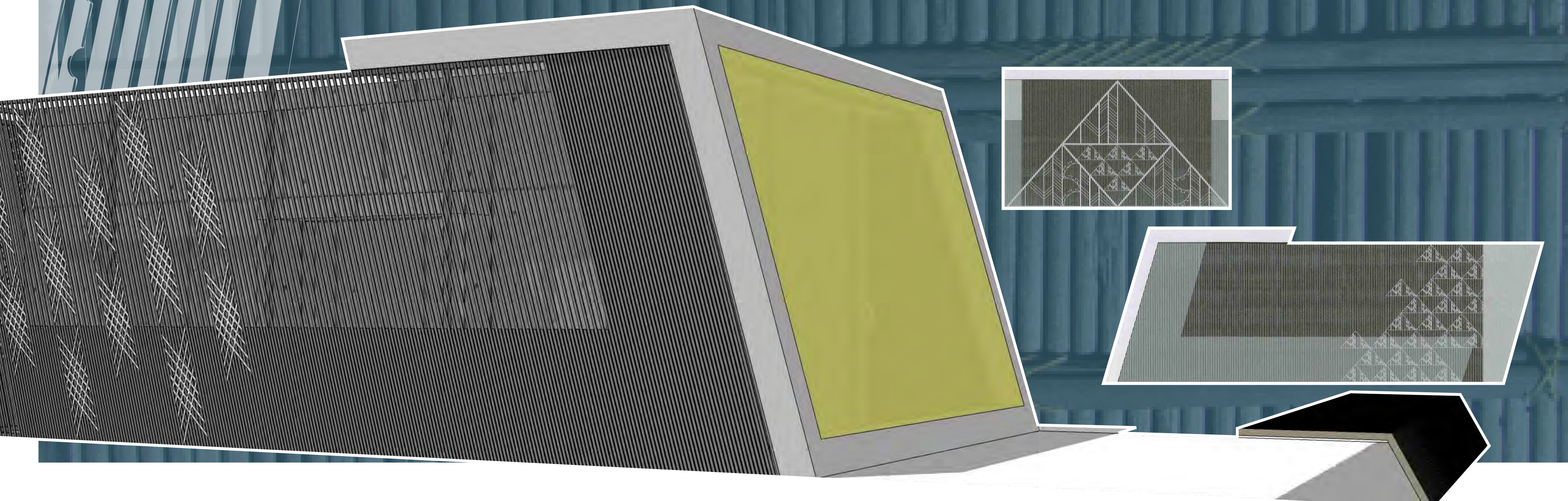

DRAFT

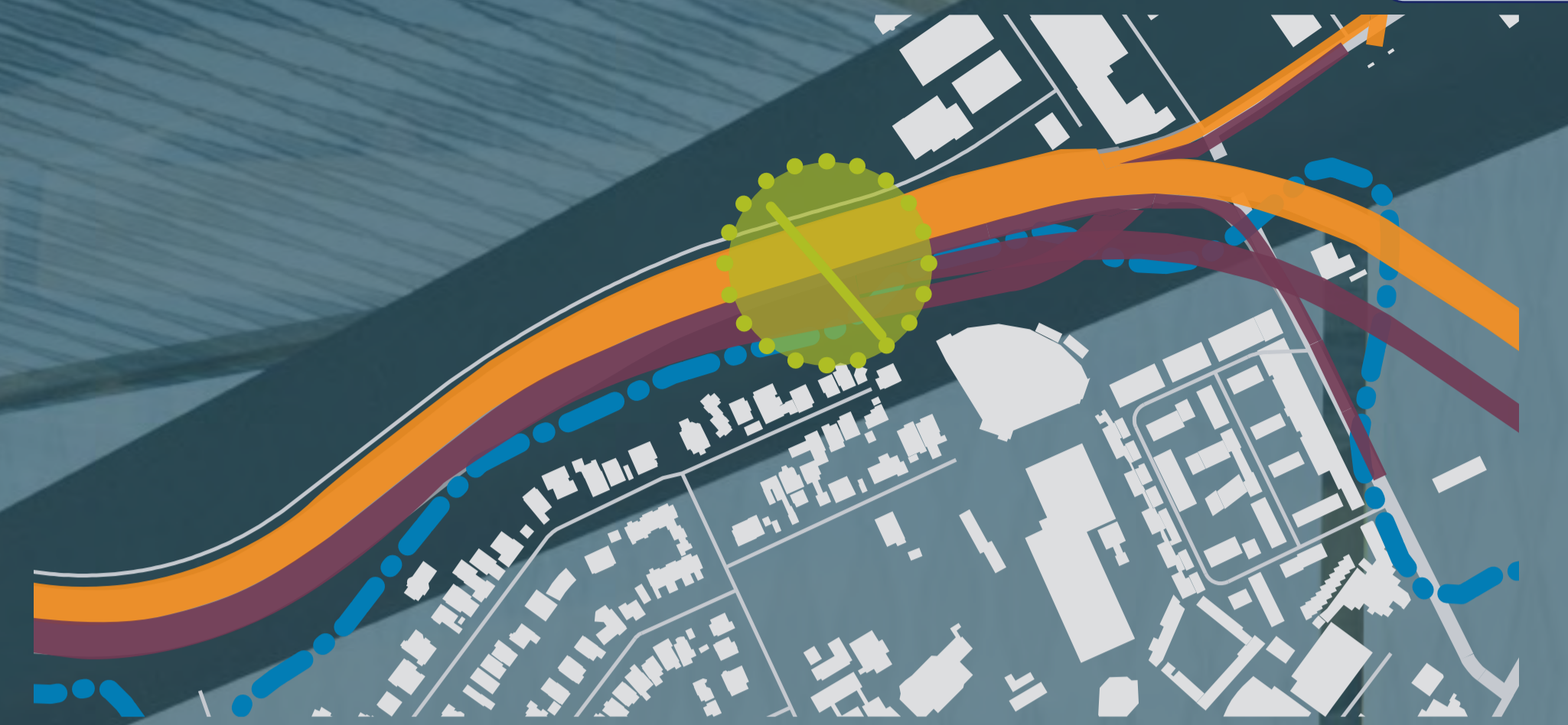
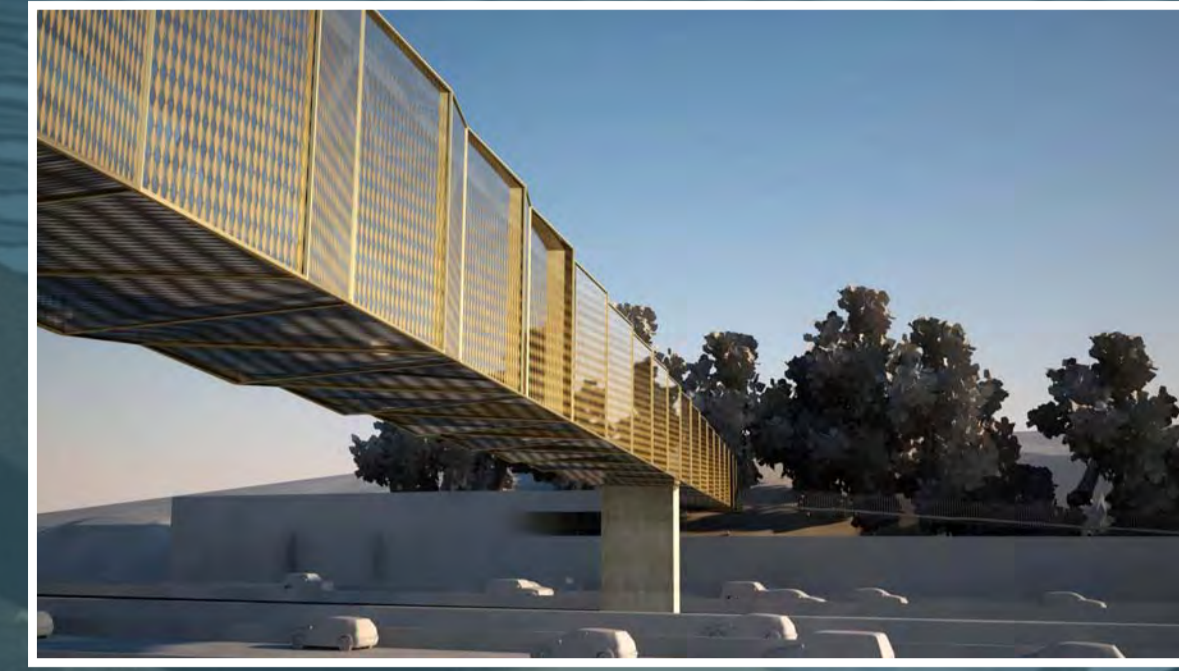

jacob's ladder footbridge

Kupenga Fish Net

The pedestrian bridge and tie-ins form a reconnection between *land and sea*, with the cladding of the bridge depicting the form of a *draped fish net*. Etched glass panels cast *fragmented patterns*, capturing the pedestrian in a *net of shadow and light*.



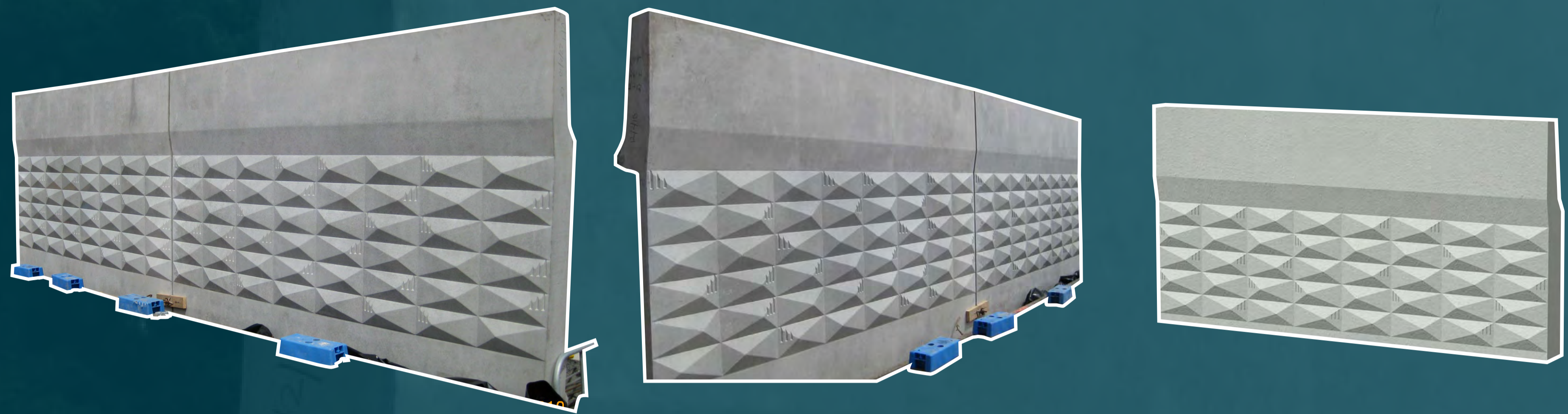

westhaven walls and barriers

Ki Tai The Sea Ki Uta Land / Foreshore Te oneroa a Huatau Long Beach of Huatau

Textural relief within the retaining wall creates subtle undulations of light and shadow, denoting the *abstracted form of a fish*; a symbol of *the ocean* and a *source of life*. Text relief within the barriers recognises *traditional iwi references* and *historic place names*. The *undulating form* of the acoustic barrier reflects the *ebb and flow* of the foreshore environment, while also responding to the *contour of the cliffline*.

