

SOUTHERN  
CORRIDOR  
IMPROVEMENTS

Project  
Update



Aerial photograph of Orams Road Bridge. The new asphalt shows where the eastern span has been replaced.

## ORAMS ROAD BRIDGE RE-OPENED

*The Orams Road Bridge re-opened to traffic on 8 October, ending a 5-month closure of the road to enable us to upgrade the Southern Motorway (SH1).*

The eastern span of the bridge, the portion over the southbound motorway lanes, was completely demolished and replaced with a longer span. This longer span can accommodate the extra southbound

motorway lane which is to be constructed underneath. Orams Road provides a busy connection between Manukau and Manurewa, including connecting to local schools and to the Botanic Gardens.

## WORK OVER THE HOLIDAYS

The festive season is upon us and it is a busy time on our roads as people go about Christmas shopping and head away for the holiday period.

During December, we limit works that could slow down already busy traffic.

However, our crews continue to work through December and January. This includes work over the rail corridor at Takanini from 27 December to 7 January when the rail line is closed for maintenance works.



## PROGRESS UPDATE

### SEPTEMBER

- Services, including a gas main, were moved to enable construction of the additional southbound motorway lane next to the Botanic Gardens.
- The concrete deck was poured and barriers installed for the new southbound bridge over the railway line near Takanini Interchange.
- Piling began in the Pahurehure Inlet area which will support the shared pedestrian and cycle path on a boardwalk over the water.

### OCTOBER

- Orams Road Bridge re-opened to traffic and pedestrians.
- 24 bridge beams were lifted into place above Great South Road as part of the bridge widening to carry the additional southbound motorway lane.
- Support piles were installed to support the temporary southbound traffic at Pahurehure Inlet as described on page 3.

### NOVEMBER

- Foundations were installed for two of the new Puhinui Stream bridges near the Botanic Gardens.
- Site clearing work began on the northbound on-ramp loop at Takanini Interchange.
- Work sites were established at Pahurehure Esplanade Reserve and Pescara Point Reserve, ready to construct the new pedestrian bridge over the motorway.

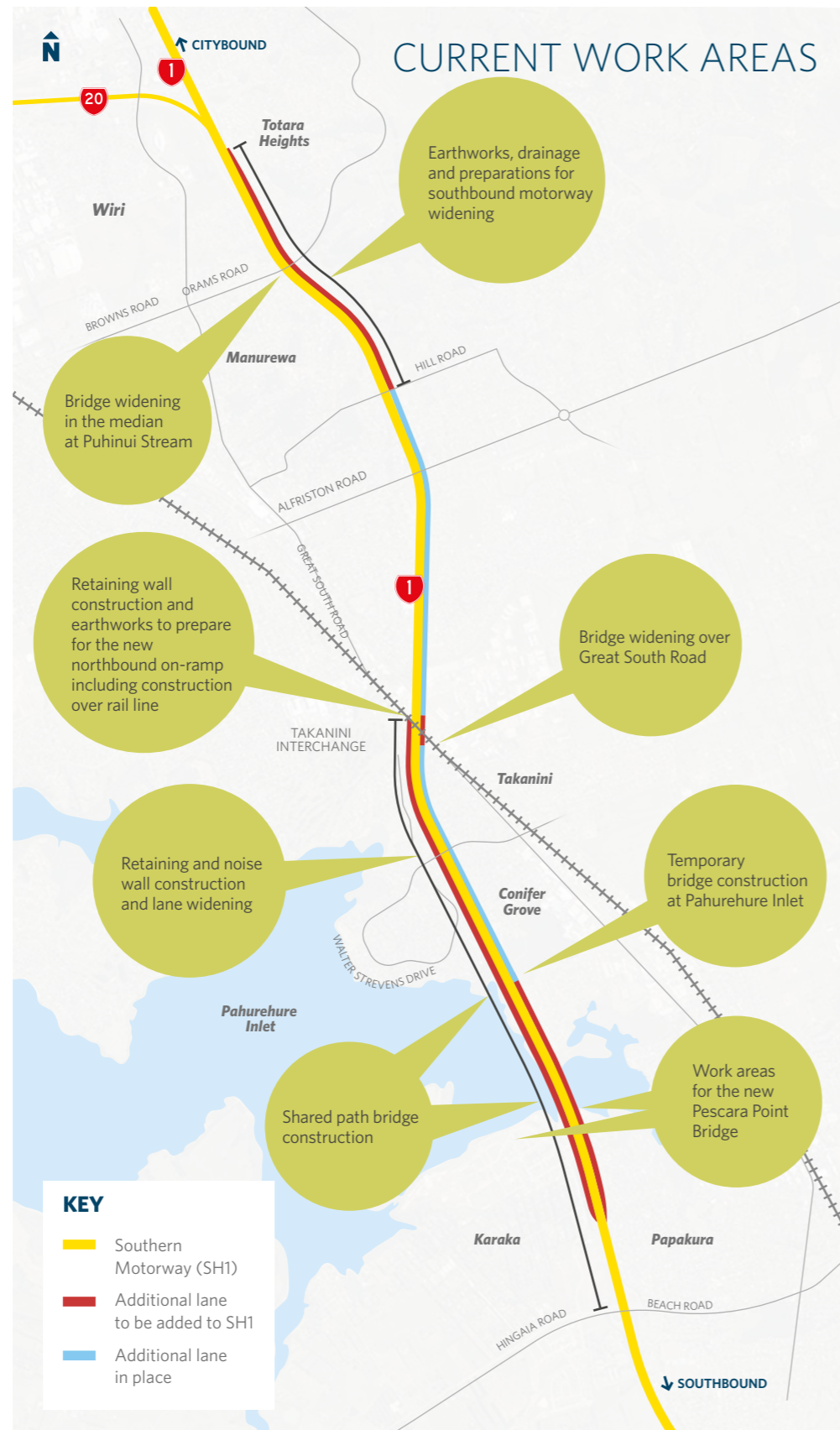

## KEEP INFORMED

We aim to keep everyone up to date with progress and planned work.

A weekly traffic notice is sent via email advising of road closures and impacts. We also send a monthly update of construction and progress photographs.

Visit our website or email us if you would like to receive one or both of these.

## NEW PAHUREHURE INLET BRIDGE

The northernmost bridges over the Pahurehure Inlet will be replaced with a new more resilient and safer single span bridge.

To undertake this work while also keeping the motorway operating requires careful planning and a staged approach. A temporary bridge will be constructed southbound. Traffic will then move across to enable us to demolish the old bridges and construct the new one, as shown below.

Traffic lane changes will take place:

- Mid-late January 2018
- August 2018
- March 2019



Aerial view of Pahurehure Inlet bridges. Construction progress of the widening areas is shown on either side of the bridge.

### STAGING CONSTRUCTION OF THE PAHUREHURE BRIDGE REPLACEMENT

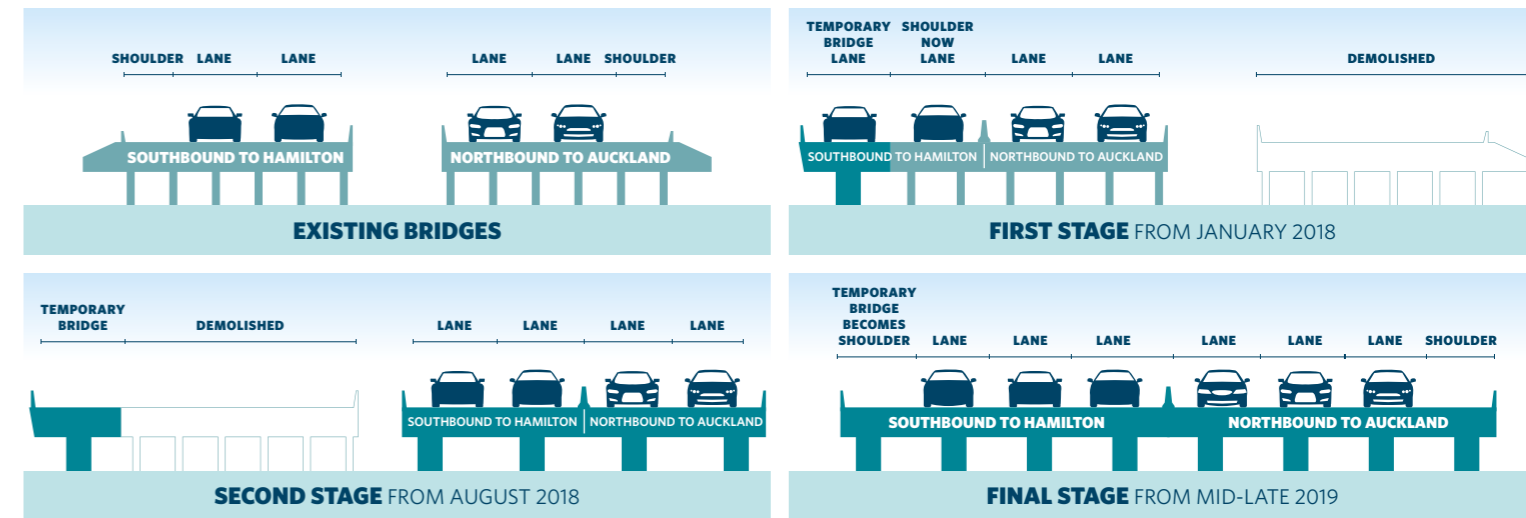

## SOUTHBOUND LANE SPLIT AT TAKANINI

From mid-January through to early April 2018, motorway lanes on SH1 travelling southbound over Takanini overbridge will be split to create a safe work zone between the lanes. The lanes will be split just before the Takanini southbound off-ramp, for approximately 800 metres, before converging again before the motorway on-ramp. Drive with care through this area as you get used to this new layout.

Splitting the lanes will enable our crew to connect the newly constructed portion of bridge to the existing motorway. The construction activity is known as a 'stitch'. The stitch involves breaking the concrete barrier and existing edge of the bridge. Steel reinforcement is then connected to the existing bridge reinforcement and new concrete poured to fill the area in between.

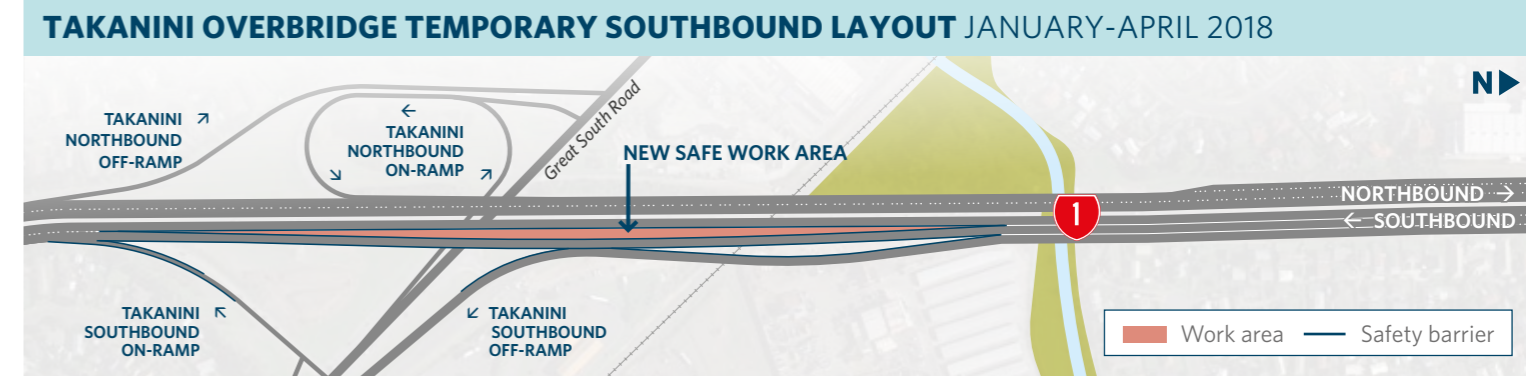

## TIMELINE

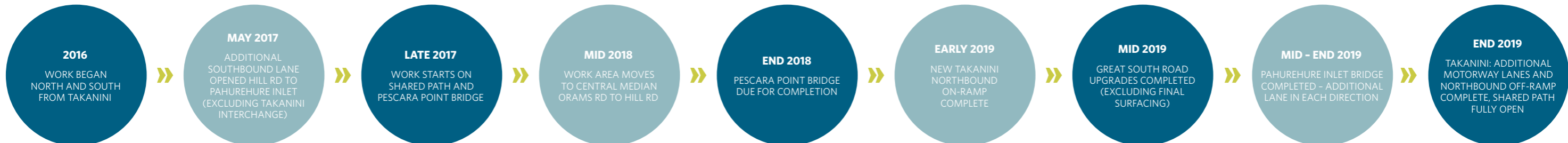





▲ New noise walls in place between Takanini Interchange and the Pahurehure Inlet. All plantings are native and include two types of climbers. *Muehlenbeckia* – common name Mingimingi and *Tecomanthe Speciosa* – common name Three Kings Vine.

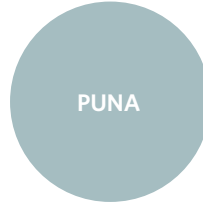

## NOISE WALL DESIGN

You will have noticed the permanent noise walls being progressively constructed along sections of the motorway in the project area. Noise walls are designed to deflect noise upwards and away from properties along the motorway boundary.

Along the northbound side of the motorway between Pahurehure Inlet and Takanini Interchange, the walls are currently being erected as we complete work to retaining walls and drainage.

Along the southbound side between Takanini Interchange and Papakura Interchange, noise walls are nearly complete. In most areas, we are applying the finishing touches which includes painting various colours onto the concrete panels.

The colours are derived from the Toi Māori palette used on the existing noise walls at Takanini and Papakura. They reflect authentic pigments used by Māori in early meeting houses, Kowhaiwhai and carvings. The arrangement of these colours was developed in conjunction with mana whenua and represents traditional land use along the motorway.

In Manurewa between Alfriston Road and Takanini Interchange, noise wall patterns have been designed to tie-in with the existing noise walls in the area.

▲ The five colours you can expect to see painted on the noise walls.

To request a translation of this information please email [southernCorridor@nzta.govt.nz](mailto:southernCorridor@nzta.govt.nz) or call 0508 NZTA SCI (0508 6982 724).

Ki te hiahia kia reo Maori tenei panui, tuku imera ki [southernCorridor@nzta.govt.nz](mailto:southernCorridor@nzta.govt.nz) waea atu ranei ki 0508 NZTA SCI (0508 6982 724).

若需要该信息及《反馈表》中文译本，请发送电子邮件至 [southernCorridor@nzta.govt.nz](mailto:southernCorridor@nzta.govt.nz) 或致电 0508 NZTA SCI (0508 6982 724)

A manaomia se faaliliuina o nei faamatalaga ma pepa e tusia mai ai ni manatu, faamolemole emeli mai ile [southernCorridor@nzta.govt.nz](mailto:southernCorridor@nzta.govt.nz) poo le telefoni 0508 NZTA SCI (0508 6982 724)

## MORE INFO

Freephone:

**0508 NZTA SCI (0508 6982 724)**

Website: [www.nzta.govt.nz/auckland-southern-corridor](http://www.nzta.govt.nz/auckland-southern-corridor)

Visit: **8-12 Great South Road, Takanini (behind Gull)**

Email:

[southernCorridor@nzta.govt.nz](mailto:southernCorridor@nzta.govt.nz)