

This monthly update provides an overview of works on the SH16 Lincoln to Westgate Upgrade.

SH16 LINCOLN TO WESTGATE UPGRADE
Construction Update



Lane layout changes from April 2017

Motorists using SH16 from Westgate to Lincoln Road will notice lane layout changes from April.

A short section of the right hand lane (lane three) city bound will be closed to traffic to create a safe work area for the construction team to widen the motorway, and complete piling work for the new HuruHuru Bridge. The new bridge will replace the existing structure and will provide more height clearance from the motorway.

These works are required to complete the upgrade of the wider Western Ring Route which will offer motorists more travel options when completed in early 2019.

We thank you for your continued patience while we upgrade this section of the network.

The SH16 Lincoln to Westgate Upgrade will provide road users and local residents with a range of benefits:

- additional motorway lanes and bus

- shoulder lanes in each direction
- extend the Northwestern Cycleway from Lincoln Road to Westgate Bridge
- replace bridges over Royal Road, HuruHuru Road and HuruHuru Creek
- an improved Royal Road interchange for safer and easier access to the motorway
- noisewalls
- safety barriers
- stormwater run-off treatment
- and landscaping.

MEET KAT JACKSON, QUALITY MANAGER



What do you do on the project?

I'm the Quality Manager. This means that I provide systems and tools so that the team can build the job to a high standard. I also have some involvement with managing our resource consents. The Safety Manager and I work closely together to ensure that the construction team plan and execute their work appropriately.

How did you get into your line of work?

I am a civil engineer by profession. For many years I worked in more traditional construction engineering roles, until an opportunity came up to try Quality Management as something different. I enjoy that this role is an interface between the construction/design/client teams.

You might be surprised to know...

I was the first person on either side of my family to complete a university degree.

Bridge construction begins

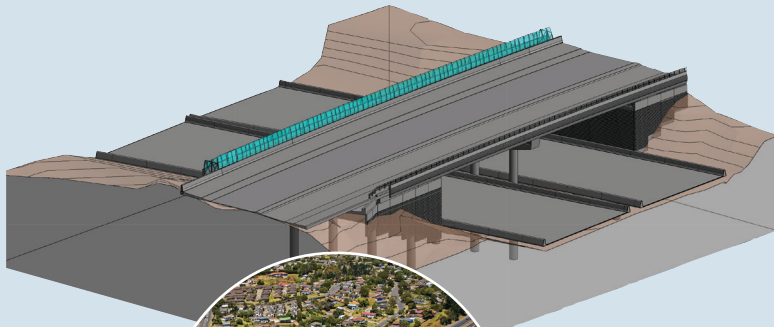

Royal Road Bridge

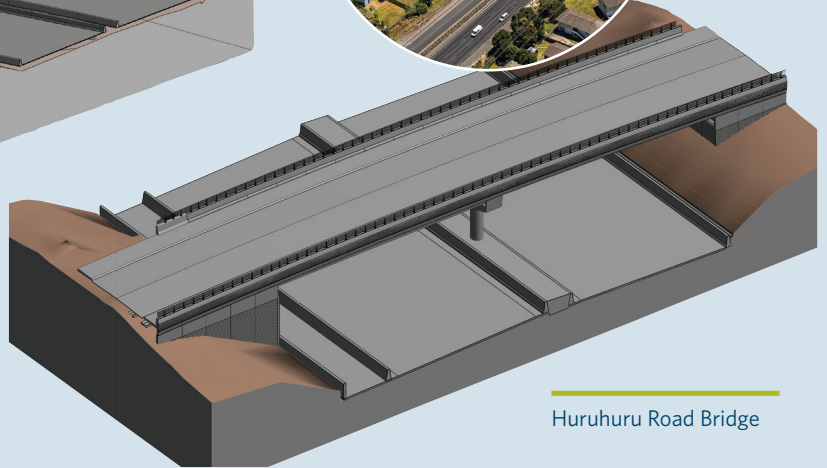

Huru Road Bridge

WHAT WE NEED TO DO:

- Demolish the footpaths at the northern end of the bridge
- Build one side of the new bridge starting with the piles that will support the bridge mid-March 2017
- Place piers in the centre median in May/June 2017
- Beams will be installed mid-July/August 2017
- Switch traffic onto the new bridge - October 2017
- Close the existing bridge - October 2017
- Demolish the existing bridge - October/November 2017
- Build the other side of the bridge starting with the piles - November 2017

BRIDGE COMPLETE JUNE 2018

WHAT WE NEED TO DO:

- Demolish the footpath at the southern end of the bridge
- Build one side of the new bridge starting with the piles that will support the bridge in April 2017
- Place piers in the centre median May/June 2017
- Install end July/August 2017
- Switch traffic onto the new bridge - November 2017
- Close the existing bridge - November 2017
- Demolish the existing bridge - November/December 2017
- Build the other side of the bridge starting with the piles - November 2017

BRIDGE COMPLETE JULY 2018

MORE INFORMATION

If you have any questions, or would like to receive this update, please contact Sheila Herrick at Hawkins Infrastructure, email: sheila.herrick@hawkins.co.nz | mobile 022 687 0391 | freephone: 0800 4444 449.