



Artist impression of the new interchange and gateway arches.



EXPECT DELAYS



Delays at the Russley Road/Memorial Avenue intersection

Delays of up to 20 minutes are possible at the Russley Road/Memorial Avenue intersection from Friday 4 August to Sunday 6 August, as work on the Russley Road upgrade continues.

Motorists travelling to and from Christchurch International Airport or other time critical destinations are advised to plan ahead and consider taking other routes, or allow plenty of extra travel time.

During the work on 4-6 August, people travelling to Christchurch International Airport are urged to take Harewood Road or the new Southern Airport Access to avoid delays. (See the detour map below.)

If you plan to travel through the intersection please allow plenty of additional time to get to your destination.

Pay extra attention to the signage to ensure you get into the correct lane early and be courteous to other drivers who will also be getting used to the change.

This work is weather dependent and will be postponed to the next suitable day if required.

Thank you for your patience and understanding while the work is underway.

Cyclists and pedestrians

Cyclists and pedestrian access will be maintained through the intersection during the work. Please follow the signage in place.

Cyclists travelling on State Highway 1 Russley Road are reminded to use the existing detour routes to access Christchurch International Airport.

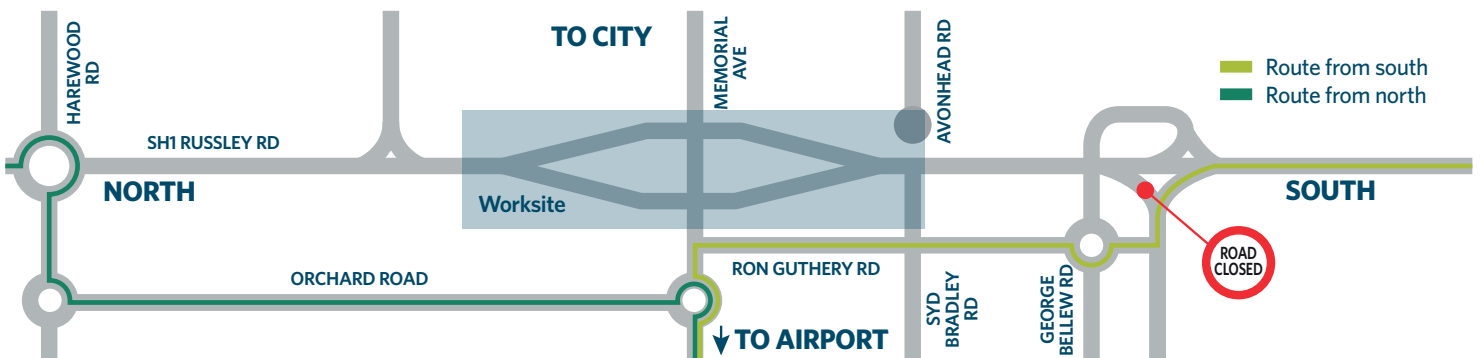

New road layout: What's happening on 4-6 August

The Russley Road upgrade project team are removing the temporary roundabout and replacing it with a permanent intersection with traffic lights.

From 4 to 6 August, the existing traffic lights will be turned off and speed restrictions, lane closures and other traffic management will be in place. These changes will create delays for motorists.

Once the work is finished, traffic heading off State Highway 1 Russley Road onto Memorial Avenue or to Christchurch International

Airport will turn and travel under the new bridge. (See map below.)

This change will allow the project team to complete the new road on top of the bridge, with the aim of completing the overall project by early 2018.

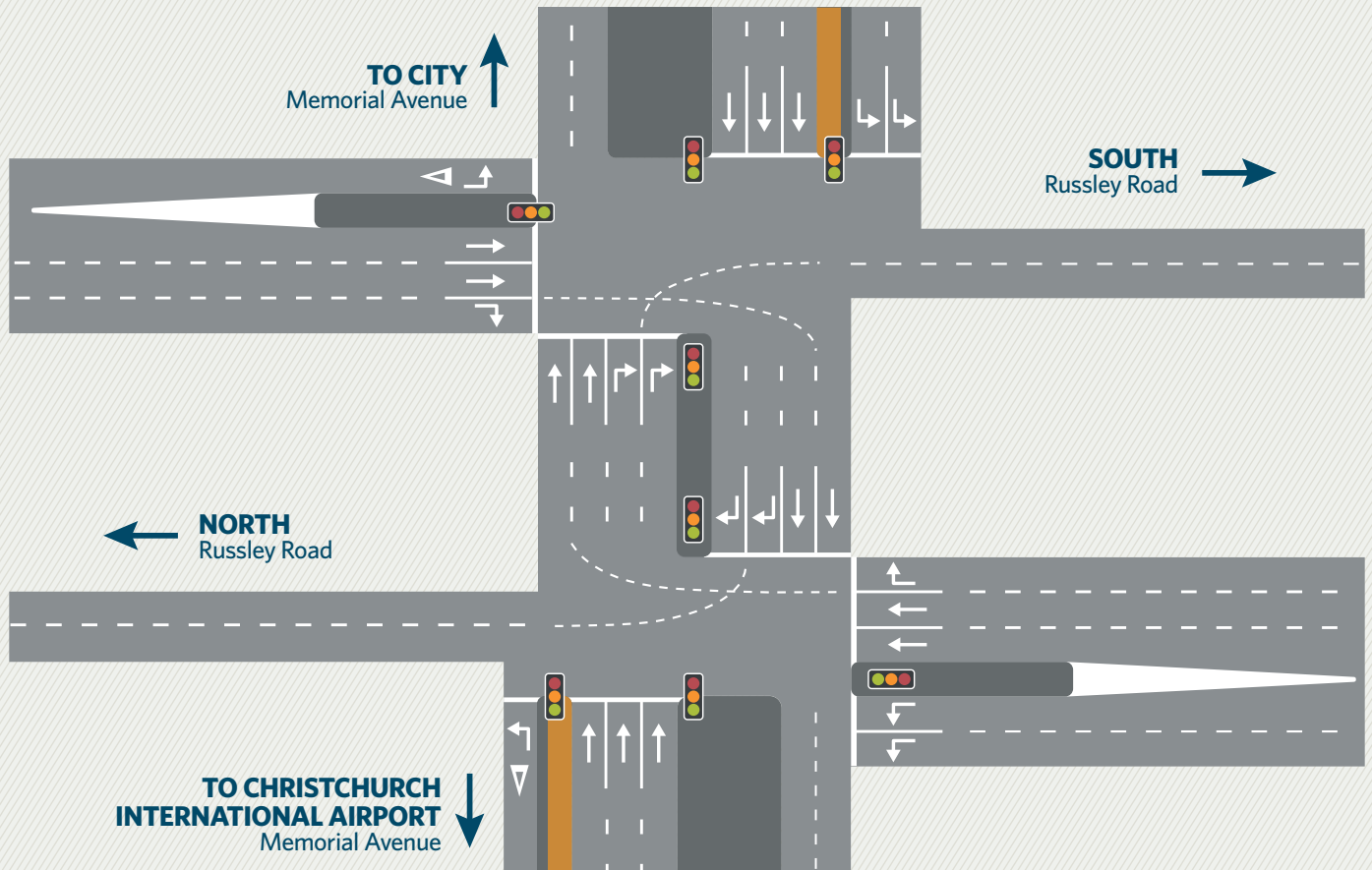

Background on the Russley Road upgrade

The upgrade is a key part of the government's Christchurch Motorways programme, which is designed to enable growth and address congestion as the city and Canterbury region grows.

The project involves upgrading Russley Road (SH1) to a four-lane highway and the construction of a major interchange at the Russley Road/Memorial Avenue intersection, that includes a gateway arch designed to welcome travellers to Christchurch.

More information can be found at: www.nzta.govt.nz/projects/christchurch-motorways/christchurch-western-corridor



Keeping you informed

For more information
on the project phone



McConnell Dowell Downer
03 359 0700 or
NZ Transport Agency
03 964 2800

For information on roadworks
and detours in the region

 www.nzta.govt.nz
 0800 444 449

or follow the Transport Agency
on Facebook or Twitter.

Follow us on

 [nztasouthisland](https://www.facebook.com/nztasouthisland)
 [nztacwc](https://twitter.com/nztacwc)

Check for traffic delays at

 www.tfc.govt.nz