

How we got here

We've spoken to the local community in the past about safety on SH1. You can find out more about our consultation and what people said at nzta.govt.nz/projects/sh1-north-canterbury-corridor

Here's a summary of the changes we've made since then:

New

Wide centrelines (rather than median barrier) will be installed between Saltwater Creek and Tulls Road, just north of Waikuku.

New

Pegasus roundabout will have a single through lane and raised safety platforms to reduce people's speeds through the currently two-lane roundabout. Improved footpath layouts and a refuge in the median will make it safer for people walking, cycling and scooting through the area to cross the highway. A safer speed limit of 60km/h is being proposed through the Interim Speed Management Plan.

New

The intersection of Rangiora Woodend Road and SH1 will be changed to left-in and left-out turns only. This will make it safer for people turning on or off the highway as they won't cross oncoming traffic in this busy location.

Decision

We decided on new traffic lights at the intersection of Woodend Road and SH1 as this will make it safer and easier for people to enter, exit and make right turns onto the highway. Raised safety platforms approaching the lights will slow traffic and improve safety for people walking, cycling and scooting.

Decision

We decided on a roundabout south of Woodend Beach Road as it's a safer option than traffic lights due to the high speed (80km/h) approach from the south. Roundabouts are also a preferred option for rural intersections like this, rather than traffic lights, as they manage vehicle speeds more appropriately.



Our work in North Canterbury

Completed

- ✓ New speed limits between Waikuku and Williams Street since December 2020 are helping people feel safer to walk, bike, or travel on the highway.
- ✓ The signalised pedestrian crossing on SH1 near Woodend School is making it safer for school children and the local community to cross the highway.
- ✓ New painted median at the northern and southern ends of Waikuku is providing extra separation for traffic and reminding people to slow down through the township, and around the Waikuku Beach Road intersection.
- ✓ Median and side safety barriers along sections of the motorway between the Cam River and Tram Road are reducing the risk of head-on crashes and vehicles running off the road.

Underway

- We're returning to work on SH1 between the Cam River bridge and the SH71 (Lineside Rd) overbridge in the new year, for a scheduled reseal. The new chip seal will provide better traction for vehicles and a hard-wearing surface. The new chip will have time to 'bed in' before we return to complete the final step, applying high performance line markings and 'rumble strips'.
- We're designing safety improvements on SH71 (Lineside Road) between Rangiora and SH1, with a focus on reducing crashes on the straights and at intersections and railway crossings. This work is ongoing, and we will share these plans when they're ready.

Looking ahead

- We're aiming to start construction on the Saltwater Creek to Cam River safety improvements in 2024, following completion of design, consenting and property processes.
- The Woodend Bypass route is designated in the Waimakariri District Council's district plan, and the land is protected for a four-lane highway. The bypass, like other similar projects across the country, will continue to be assessed for priority and funding. Our work in North Canterbury won't affect the timing or potential funding of the bypass but will help make the road safer for everyone in the meantime.
- We've received feedback from the community about further encouraging walking and cycling around Woodend. While the level of infrastructure required is not within the scope of this project, we are investigating whether an alternative programme could pick this up.

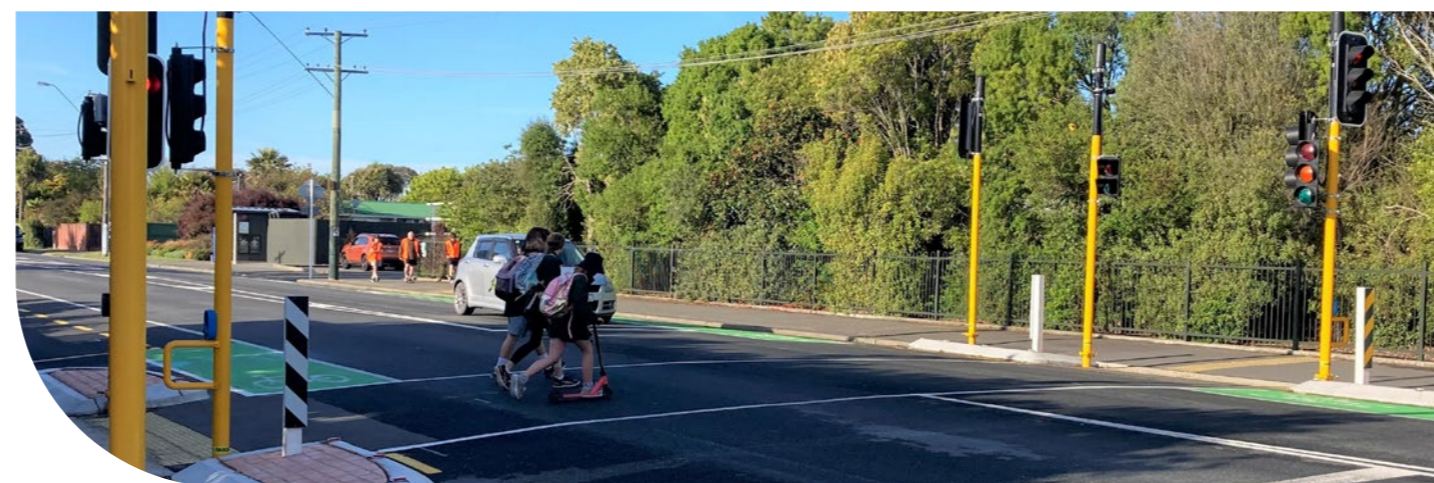

22-444

1 Saltwater Creek to Cam River, including Woodend, road safety improvements



We're moving ahead with our plans to make State Highway 1 (SH1) in North Canterbury safer for everyone who uses the road.

We're designing a range of significant safety improvements to be built between Saltwater Creek (north of the Ashley River) and the Cam River (just south of Williams Street), including Woodend Township.

These include wide centrelines, flexible median safety barriers, and improvements at intersections such as traffic lights, roundabouts or left-in/left-out access to the highway.

Thank you to the communities of Waikuku, Pegasus, Woodend, Tuahiwi and Kaiapoi for all the valuable conversations we've had in recent years about safety and access along this stretch of highway. Your insights, together with ongoing technical investigations, have helped shape our designs.

Find out more

After the holiday break we're holding a community information session where you can pop in, see our plans, and ask us questions.

Date

Thursday 16 February 2023

Time

Anytime between 3.30-6.00pm

Location

Woodend Community Centre,
School Road, Woodend

Download maps and more information on our project website at nzta.govt.nz/projects/sh1-north-canterbury-corridor

Email the project team at safetynorthcanterbury@nzta.govt.nz

ROAD TO
ZERO

TE ARA KI TE ORA

Road to Zero

Delivering safety improvements in speed and infrastructure is an important part of Road to Zero, Aotearoa New Zealand's road safety strategy.

People make mistakes, and by making safety improvements and reducing speed we can save lives and prevent serious injuries on our roads.

SH1 is the main road into Christchurch and is an important link for people driving to work, local businesses and freight. This road is becoming busier as more people make Waimakariri district their home.

The range of safety improvements being designed and constructed on SH1 will help New Zealand achieve its Road to Zero target of 40% fewer deaths and serious injuries on our roads by 2030.

Find more information on Road to Zero at nzta.govt.nz/road-to-zero

Better together

We're working with mana whenua, Waimakariri District Council, the community and others who want North Canterbury to be a great place to live. As part of planning, we've considered nearby areas and future projects. While some projects have different funding, timing and delivery, they will all work together to strengthen Waimakariri's transport network and make it safer for everyone using the roads.

Have your say on safer speeds

To ensure our transport system protects and helps us to get to the places and people important to us, we're delivering an Interim State Highway Speed Management Plan. Locations in North Canterbury include the Pegasus roundabout and Amberley south.

Have your say

Use our online form at nzta.govt.nz/ISMP

Consultation closes **Monday 12 December 2022**



Saltwater Creek to Pegasus roundabout

Planned safety improvements

This combination of safety improvements will be an effective way to save lives and reduce harm on SH1. Here's what we have planned (north to south):

- Road widening, wide centreline and high-performance road markings in places between Saltwater Creek and Tulls Road
- Extending the safety barriers at the approaches to Saltwater Creek and Ashley River Bridges
- Road widening, flexible median safety barriers and high-performance road markings between Gressons Road and Pegasus roundabout
- A 'jug handle' turnaround bay near Gressons Road
- Left in/left out intersections at Preeces Road and Wards Road
- Changes to Pegasus roundabout including a proposed speed limit of 60km/h, reduction to one through lane, raised safety platforms and a safer crossing point on the northern side for people walking, cycling and scooting

- Traffic lights at the Woodend Road intersection
- A left in/left out intersection at Rangiora Woodend Road
- A roundabout near the Woodend Beach Road intersection
- Road widening, flexible median safety barriers and high-performance road markings between Woodend Beach Road and Williams Street
- Left in/left out intersections at Sandhill Road and Pa Road
- A crossing refuge for people using the bus stops near Pineacres
- A roundabout at the Williams Street intersection
- Road widening, flexible median safety barriers and high-performance road markings between Williams Street and the Cam River.

Why change?

The 11.4km stretch of SH1 between Saltwater Creek and the Cam River is assessed as a high-risk section of highway, with high traffic volumes and speeds combining in some areas.

Five people were killed and 30 people were seriously injured in the 75 recorded crashes on this stretch of road between 2011 and 2020*.

Too many of these deaths and serious injuries were caused by head-on crashes.

While we can't remove every hazard, we can put in place effective measures to make SH1 in North Canterbury safer for everyone who uses the road.

*Data from the Crash Analysis System for the period 2011-2020

Flexible median safety barriers

Median barriers stand between you and an oncoming car, truck or motorcycle:

- When fitted along the centre of the road, barriers can reduce the number of people killed or seriously injured by up to 65 percent.
- If someone loses control or drifts across the centreline, the result isn't a head-on-crash.
- If you hit a flexible median safety barrier, the steel cables flex, acting like a safety net, slowing your vehicle down and keeping it upright. They absorb the impact so you and the people with you, don't.
- Where there's a median barrier, you may need to drive or ride a little further to turn around. We will provide places to do this where we can, and where it's safe.



Woodend Beach Road to Cam River

Concept Design - Not for Construction



Woodend Township

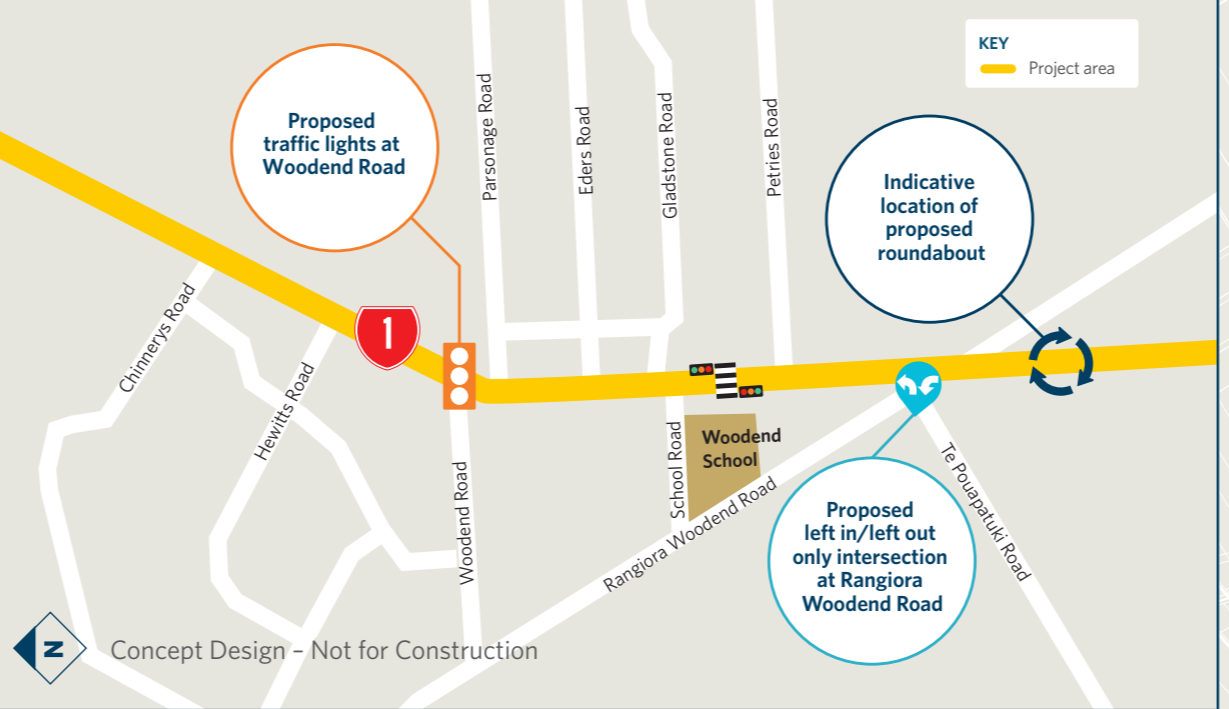

Need more information

More information on what's planned for SH1 North Canterbury is available on the project website and you can subscribe to updates at nzta.govt.nz/projects/sh1-north-canterbury-corridor Email the project team at safetynorthcanterbury@nzta.govt.nz

