

PAVING

P01 CONCRETE WITH BROOM FINISH
150mm thick reinforced concrete with 5kg/m³ black oxide.
Refer to Engineer's drawings 80504522-C4-0402_G011 to 80504522-C4-0402_G302 TYP.

P02 CONCRETE WITH EXPOSED AGGREGATE FINISH
150mm thick reinforced concrete with lightly exposed 19mm basalt chip with 8kg/m³ black oxide.
Refer to Engineer's details.

P03 CALCINED BAUXITE
The Charcoal Grey (RAL 7043) coloured surfacing shall be composed of:
A coloured epoxy or polyurethane resin binder, holding colour-through calcine bauxite chipping (approximate grading 1-3mm). Before application, the contractor shall grind the concrete surface to expose aggregate, and so ensuring the adhesion of the coloured coating. Available from www.resinsurfaces.co.nz or approved equivalent.

P03A RED CALCINED BAUXITE
The Traffic Red (RAL 3020) coloured surfacing shall be composed of:
A coloured epoxy or polyurethane resin binder, holding colour-through calcine bauxite chipping (approximate grading 1-3mm). Before application, the contractor shall grind the concrete surface to expose aggregate, and so ensuring the adhesion of the coloured coating. Available from www.resinsurfaces.co.nz or approved equivalent.

P04 DRIVEWAY RAMP
Vehicle crossing to AT standard drawing GD019A-1A

P05 NOT USED

P06 SAND-BLASTED ARTWORK
6mm depth sand-blasted artwork relief, retrofitted following path construction with edges machine ground to form a rounded chamfer. Refer to 80504522-C4-0402-G1602 for detail

P07 EXISTING PATH
Protected during the course of the construction works and reinstated as required to form a clean edge with the proposed works and its associated sawcuts.

P08 WATERCARE AND KIWI RAIL ACCESS
Asphalt Concrete with 10mm aggregate size (AC10).
Refer to Engineer's details.

FENCING

F01 EXISTING FENCE
Existing fence to be retained or otherwise to be replaced in agreement with landowner at Contractor's expense.

F02 POST, BATTEN, AND WIRE FENCE
1.2-metre-high (above ground) post, batten and wire fence. Stays, strainers, and tensioners applied at the change in fence direction and at intermediate points to maintain a taut wire and stable fence line. Fence to be comprised of the following units:

- 100x125x2100 mm H5 rough sawn timber posts @ 5000 mm centres. Post driven or augered, with the surrounding ground then rammed to achieve a stable footing.
- 6 intermediary 50x50mm H3 timber battens placed at equal intervals (approx. 715mm centres)
- 6 rows of 3.15 zinc aluminum wire held in place by 40mm plain shanked staples.

All timber should be free of imperfections such as large knots, bends or cracks.

F03 STAND ALONE TIMBER POSTS
100x125x2100 mm H5 rough sawn timber posts. Post driven to be 1.2m above finished ground level, with the surrounding ground then rammed to achieve a stable footing.

F04 BOLLARD
150x150mm Standalone steel bollards @1400MM centres embedded in concrete foundation. Refer to Engineer's details.

F04A REMOVABLE BOLLARD
150x150mm folding steel bollards or lockable steelm bollards slotted in steel socket @1400MM centres. Refer to Engineer's details

F05 TIMBER BALUSTRADE TO PATH EDGE
1.2m high balustrade (CH2090-2200) and 1.4m high balustrade (CH540-560 & CH2470-2565) Refer to Engineer's details 80504522-C4-0402_G679

F06 STEEL FIN BALUSTRADE
1.4m high steel fins appended to major bridges. Refer to Engineer's details 80504522-C4-0402_G537 to G538 for Bridge B2 80504522-C4-0402_G590 to G594 for Bridge B6

F07 TIMBER BALUSTRADE TO BOARDWALK
1.2m high H3.2 timber battens fixed to steel frame. Refer to Engineer's details 80504522-C4-0402_G679

F08 CHAIN LINK FENCE
1800mm high, 3.15mm gauge with 50mm diamond mesh galvanised chain link fence with 2m post spacing and top wire. Poles to be coated Bokara Grey.

LIGHTING:

L01 WALL WASH LIGHTING
LED strip up-lighting of naming wall. Glide 67 extrusion G125 or equivalent. Refer to Engineering Details.

L02 CODE NOT USED

VEGETATION

V01 - PLANTING TYP
Refer to Planting Plans A15155_S2_400 to A15155_S2_426

V02 - GRASS TYP
Reinstated grass areas where required following construction using Ryegrass/ Chewing Fescue/ Brown Top seed mix to be approved by the Landscape Architect.

V03 - COIR EROSION CONTROL FABRIC
450g/m² approved fully biodegradable Coir Mat with 100% warp and weft coir, such as 450J coir product from permathene or accepted equivalent by the Landscape Architect.

STRUCTURES

S01 INSITU CONCRETE WALL
Standard portland grey concrete with 3kg/m³ black oxide, light sandblast finished, sealed with stainstop by Lithofin, clear graffiti guard to be applied. Refer DWGs A15155_S2_110 and 131 for set out and details as below:

- S01 A** - Refer to 80504522-C4-0402_1605 and 80504522-C4-0402_1606
- S01 B** - Refer to 80504522-C4-0402_1605 and 80504522-C4-0402_1606
- S01 C** - Refer to 80504522-C4-0402_1605 and 80504522-C4-0402_1607
- S01 D** - Refer to 80504522-C4-0402_1605 and 80504522-C4-0402_1607

S02 POU
Location of pou to be installed by artist. Refer to 80504522-C4-0402-G1603 and 80504522-C4-0402-G1604

S03 ENTRY SIGN
Steel panel with entry signage to be fixed to wall. Refer DWGs A15155_S2_110 and 131 for set out and details as below:

- S01 A** - Refer to detail 01 80504522-C4-0402_1608
- S01 B** - Refer to detail 02 80504522-C4-0402_1608

- S01 C** - Refer to detail 01 80504522-C4-0402_1609
- S01 D** - Refer to detail 02 80504522-C4-0402_1609

S04 3M TIMBER SEAT WITH BACKING
3000 x 400 x 400mm Purple heart Hardwood with skateboard deterrents by Hunua Park Furniture. Refer to 80504522-C4-0402_1610 for detail

S04A TIMBER SEAT WITHOUT BACKING
3000 x 400 x 400mm Purpleheart heart Hardwood with skateboard deterrents by Hunua Park Furniture. Refer to 80504522-C4-0402_1610 for detail

S05 CARVED WOODEN HANDRAIL
Machine carved wooden holdrail as art installations at leads-ins to major bridges. Refer to 80504522-C4-0402-G1600

S06 FALL PROTECTION SCREEN WITH ARTWORK INTEGRATED
Laser cut/ hole punched, coated steel panels as art installations at leads-ins to major bridges. Refer to 80504522-C4-0402-G1601

S07 KIWI RAIL ACCESS WARNING SIGN
Warning sign design and detail to be provided by Kiwirail.

PLANTING LEGEND

- MIX01 - ENTRANCE**
- MIX03 - HARAKEKE**
- MIX04 - PATH EDGE**
- MIX05 - BOUNDARY**
- MIX06 - RETAINING WALL**
- MIX07 - GULLY**
- MIX08 - ENRICHMENT OF EXISTING BUSH- LOOKOUT AREA**
- MIX08a - ENRICHMENT OF EXISTING BUSH- ST JOHNS STREAM**
- MIX09 - PATH EDGE LOOKOUT**
- MIX10 - WILLOW WETLAND RESTORATION**
- MIX11 - LOOKOUT**
- MIX12 - MEADOW**
- MIX12a - MEADOW EDGE**
- MIX13 - WETLAND RESTORATION**
- MIX14 - RAIL EDGE SOUTH**
- MIX15 - RAIL EDGE NORTH**
- MIX16 - RAIL EDGE SETBACK**
- MIX16 - ENRICHMENT LOWLAND RIPARIAN**
- MIX18 - MANUKA SHRUBLAND**
- MIX19 - LOWLAND RIPARIAN FOREST**
- MIX20 - BISHOP SELWYN SITE**
- MIX21 - COASTAL SCRUB**
- MIX22 - PATH EDGE TAHAPA RESERVE**
- MIX23 - ENRICHMENT**
- MIX24 - COASTAL ESCARPMENT**
- MIX24a - COASTAL ESCARPMENT- MEADOWBANK CLIFF**
- MIX25 - COASTAL POHUTUKAWA BANK**
- MIX26 - BOARDWALK HIGH**
- MIX27 - BOARDWALK LOW**
- GRASS
- RIPRAP
- PROPOSED PLANTING EXTENT
- EXISTING TREE

- RIMU (*Dacrydium cupressinum*)
- KOHEKOHE (*Dysoxylum spectabile*)
- PURIRI (*Vitex lucens*)
- KAHIKATEA (*Dacrycarpus dacrydioides*)
- POHUTUKAWA (*Metrosideros excelsa*)
- POHUTUKAWA 80L (*Metrosideros excelsa*)
- TOTARA (*Podocarpus totara*)
- TITOKI (*Alectryon excelsus*)
- KARAKA (*Corynocarpus laevigata*)
- KARO (*Pittosporum crassifolium*)
- REWAREWA (*Knightsia excelsa*)
- KOWHAI (*Sophora tetraptera*)
- KOHUHU (*Pittosporum tenuifolium*)
- TARATA (*Pittosporum eugenoides*)
- CABBAGE TREE (*Cordyline australis*)
- NIKAU (*Rhopalostylis sapida*)
- MAMAKU (*Cyathea medullaris*)
- PONGA (*Cyathea dealbata*)

GENERAL NOTES:

All drawings to be read in conjunction with the landscape specifications.

All structural / building work and foundations to Engineer's approval.

All levels to be read with reference to the topographical survey file

Drawings not to be scaled, use dimensioned measurements only.

Set out to be checked and approved by the Engineer and Landscape Architect on site.

SOFT LANDSCAPE NOTES:

All grass areas to be finished 25mm higher than adjoining surface to allow for settlement.

Refer to Specification for growing medium requirements.

All trees to be inspected & approved by Landscape Architect prior to delivery to site.

Absolute planting numbers are indicative. Contractor to ensure sufficient stock to achieve specified planting densities.

All planted areas to be finished/mulched in accordance with Drawings and Specification.

Refer to Specification for requirements on preparation of planting areas.

FURNITURE NOTES:

All timber for seating elements to have 'Eco Barrier' graffiti guard applied.

METALWORK NOTES

Confirm on site all measurements prior to manufacturing.

Contractor to site measure all components and ensure accurate fit between cowl, collars, flanges, pipes, posts, base plates, fixing surfaces and the lile.

Shop drawings of all steel work elements to be provided to Engineer and Landscape Architect for approval prior to fabrication.

All welds to be buffed smooth prior to hot dip galvanising/zinc plating. All welds & metal work fixings to Engineers Specification

All non-stainless steel metal work shall be hot dipped galvanised (HDG) or zinc plated and painted - metal work to be cleaned, degreased following completion of all welds and hot dip galvanised/zinc plated in accordance with the Specifications.

All metalwork to be approved by Engineer after fabrication and before hot dip galvanising/zinc plating.

No welding or drilling to be carried out after zinc spraying, site welds permitted only with prior written approval from Engineer.

All galvanising to be cleanly finished with flakes removed and inspected prior to painting.

Primer and paint system to Specification. Colours to be confirmed prior to ordering.

Approved exterior grade silicon sealant to all joints after fixing.

Contractor to provide PS1 certification for metalwork elements and footings with final approved shop drawings.

All fixings to be non-ferrous - all fixings to ensure adequate separation of metalwork elements.

All stainless steel to be grade 316 unless otherwise specified.

Metalwork fixing plates and fittings not to be used as a guide for drilling or cutting.

PAVING NOTES

Compaction of subbase to be inspected by engineer prior to commencement of paving.

All insitu concrete paving to be sawcut in accordance with Specification and Drawings.

All insitu concrete paving to include expansion joints in accordance with Specification and Drawings to Engineers approval.

All concrete finishes to be in accordance with NZS 3114:1987

NOTES

CONTRACTORS TO VERIFY ALL DIMENSIONS ON SITE PRIOR TO COMMENCING WORK;

CONTRACTORS ARE RESPONSIBLE FOR CONFIRMING THE LOCATION OF ALL UNDERGROUND SERVICES ON SITE PRIOR TO COMMENCING WORK;

FIGURED DIMENSIONS TO BE TAKEN IN PREFERENCE TO SCALED DIMENSIONS.

KEY

REV	DATE	DESCRIPTION
-	21.04.20	FOR INFORMATION

CLIENT
AUCKLAND TRANSPORT

CONSULTANTS

FOR INFORMATION

TE ARA KI UTA KI TAI
Section 2

KEYSHEET

Design LCH	Scale N/A	Date 21.04.2020
Drawn LCH		
Check MLE		
App'd MLE		

DRAWING NO. REVISION

A15155_S2_001

This graphic has been prepared by Boffa Miskell Limited on the specific instructions of our Client. It is solely for our Client's use in accordance with the agreed scope of work. Any use or reliance by a third party is at that party's own risk. Where information has been supplied by the Client or obtained from other external sources, it has been assumed that it is accurate. No liability or responsibility is accepted by Boffa Miskell Limited for any errors or omissions to the extent that they arise from inaccurate information provided by the Client or any external source.



NOTES

CONTRACTORS TO VERIFY ALL DIMENSIONS ON SITE PRIOR TO COMMENCING WORK;

CONTRACTORS ARE RESPONSIBLE FOR CONFIRMING THE LOCATION OF ALL UNDERGROUND SERVICES ON SITE PRIOR TO COMMENCING WORK;

FIGURED DIMENSIONS TO BE TAKEN IN PREFERENCE TO SCALED DIMENSIONS.

TO BE READ IN CONJUNCTION WITH CIVIL DRAWINGS.

REFER TO CIVIL DRAWING 80504522-C4-0402_G410 FOR RIPRAP DETAILS.

KEY

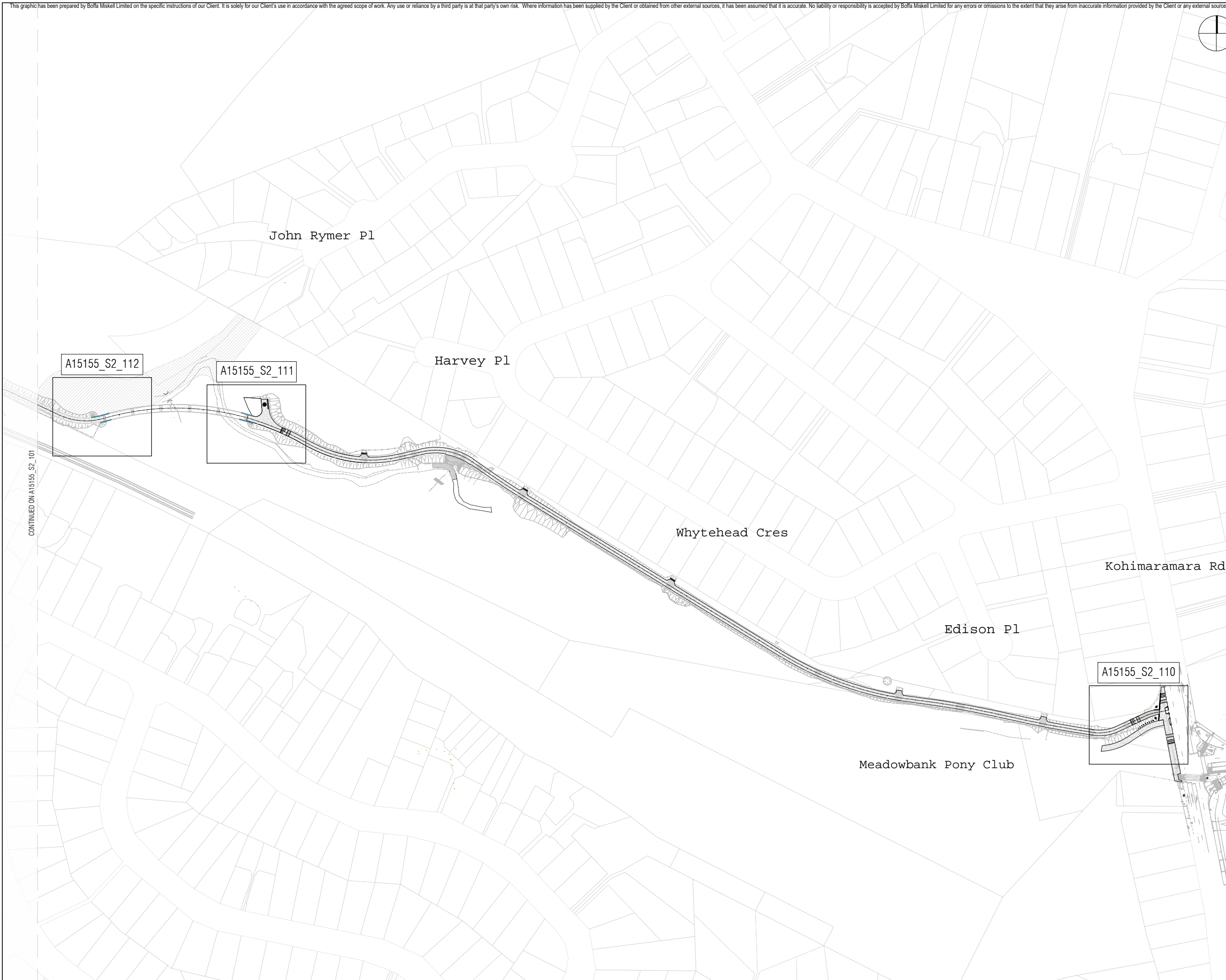

CONTINUED ON A15155_S2_101

REV	DATE	DESCRIPTION
-	21.04.20	FOR CONSTRUCTION

FOR CONSTRUCTION

Design	LCh	Scale	Date
Drawn	LCh	1:1250 @ A1	21.04.2020
Check	MLe	1:2500 @ A3	
App'vd	MLe		

CONSULTANTS

CLIENT
AUCKLAND TRANSPORT



Boffa Miskell Limited
Level 3 IBM Centre
82 Wyndham Street 1010
PO Box 91250, Auckland 1142, New Zealand
Tel: +64 9 358 2526
www.boffamiskell.co.nz

**TE ARA KI UTA KI TAI
Section 2**

GENERAL ARRANGEMENT
SHEET LOCATION PLAN

DRAWING NO.	REVISION
-------------	----------

A15155_S2_100



This graphic has been prepared by Boffa Miskell Limited on the specific instructions of our Client. It is solely for our Client's use in accordance with the agreed scope of work. Any use or reliance by a third party is at that party's own risk. Where information has been supplied by the Client or obtained from other external sources, it has been assumed that it is accurate. No liability or responsibility is accepted by Boffa Miskell Limited for any errors or omissions to the extent that they arise from inaccurate information provided by the Client or any external source.



NOTES

CONTRACTORS TO VERIFY ALL DIMENSIONS ON SITE PRIOR TO COMMENCING WORK;

CONTRACTORS ARE RESPONSIBLE FOR CONFIRMING THE LOCATION OF ALL UNDERGROUND SERVICES ON SITE PRIOR TO COMMENCING WORK;

FIGURED DIMENSIONS TO BE TAKEN IN PREFERENCE TO SCALED DIMENSIONS.

TO BE READ IN CONJUNCTION WITH CIVIL DRAWINGS.

REFER TO CIVIL DRAWING 80504522-C4-0402_G410 FOR RIPRAP DETAILS.

KEY



REV	DATE	DESCRIPTION
-	21.04.20	FOR CONSTRUCTION

FOR CONSTRUCTION

Design	LCh	Scale	Date
Drawn	LCh	1:1250 @ A1	21.04.2020
Check	MLe	1:2500 @ A3	
App'd	MLe		

CONSULTANTS

CLIENT
AUCKLAND TRANSPORT



Boffa Miskell Limited
Level 3 IBM Centre
82 Wyndham Street 1010
PO Box 91250, Auckland 1142, New Zealand
Tel: +64 9 358 2526
www.boffamiskell.co.nz

TE ARA KI UTA KI TAI
Section 2

GENERAL ARRANGEMENT
SHEET LOCATION PLAN

DRAWING NO.	REVISION
A15155_S2_101	-

A15155_S2_101



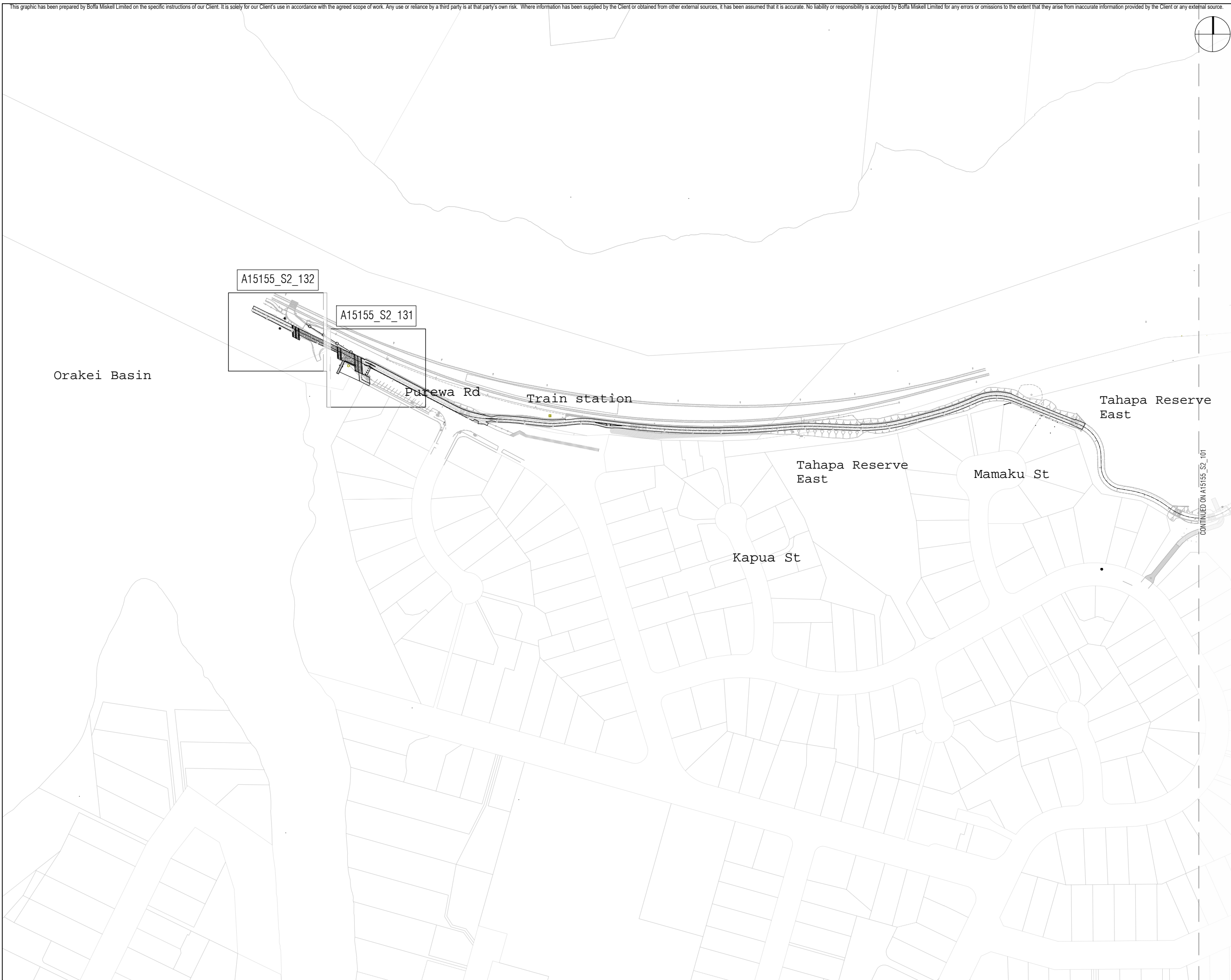

This graphic has been prepared by Boffa Miskell Limited on the specific instructions of our Client. It is solely for our Client's use in accordance with the agreed scope of work. Any use or reliance by a third party is at that party's own risk. Where information has been supplied by the Client or obtained from other external sources, it has been assumed that it is accurate. No liability or responsibility is accepted by Boffa Miskell Limited for any errors or omissions to the extent that they arise from inaccurate information provided by the Client or any external source.



NOTES

CONTRACTORS TO VERIFY ALL DIMENSIONS ON SITE PRIOR TO COMMENCING WORK;

CONTRACTORS ARE RESPONSIBLE FOR CONFIRMING THE LOCATION OF ALL UNDERGROUND SERVICES ON SITE PRIOR TO COMMENCING WORK;

FIGURED DIMENSIONS TO BE TAKEN IN PREFERENCE TO SCALED DIMENSIONS.

TO BE READ IN CONJUNCTION WITH CIVIL DRAWINGS.

REFER TO CIVIL DRAWING 80504522-C4-0402_G410 FOR RIPRAP DETAILS.

KEY

REV	DATE	DESCRIPTION
-	21.04.20	FOR CONSTRUCTION

FOR CONSTRUCTION

Design	LCh	Scale	Date
Drawn	LCh	1:1250 @ A1	21.04.2020
Check	MLe	1:2500 @ A3	
App'd	MLe		

CONSULTANTS

CLIENT
AUCKLAND TRANSPORT



Boffa Miskell Limited
Level 3 IBM Centre
82 Wyndham Street 1010
PO Box 91250, Auckland 1142, New Zealand
Tel: +64 9 358 2526
www.boffamiskell.co.nz

TE ARA KI UTA KI TAI
Section 2

GENERAL ARRANGEMENT
SHEET LOCATION PLAN

DRAWING NO.	REVISION
A15155_S2_102	-

This graphic has been prepared by Boffa Miskell Limited on the specific instructions of our Client. It is solely for our Client's use in accordance with the agreed scope of work. Any use or reliance by a third party is at that party's own risk. Where information has been supplied by the Client or obtained from other external sources, it has been assumed that it is accurate. No liability or responsibility is accepted by Boffa Miskell Limited for any errors or omissions to the extent that they arise from inaccurate information provided by the Client or any external source.

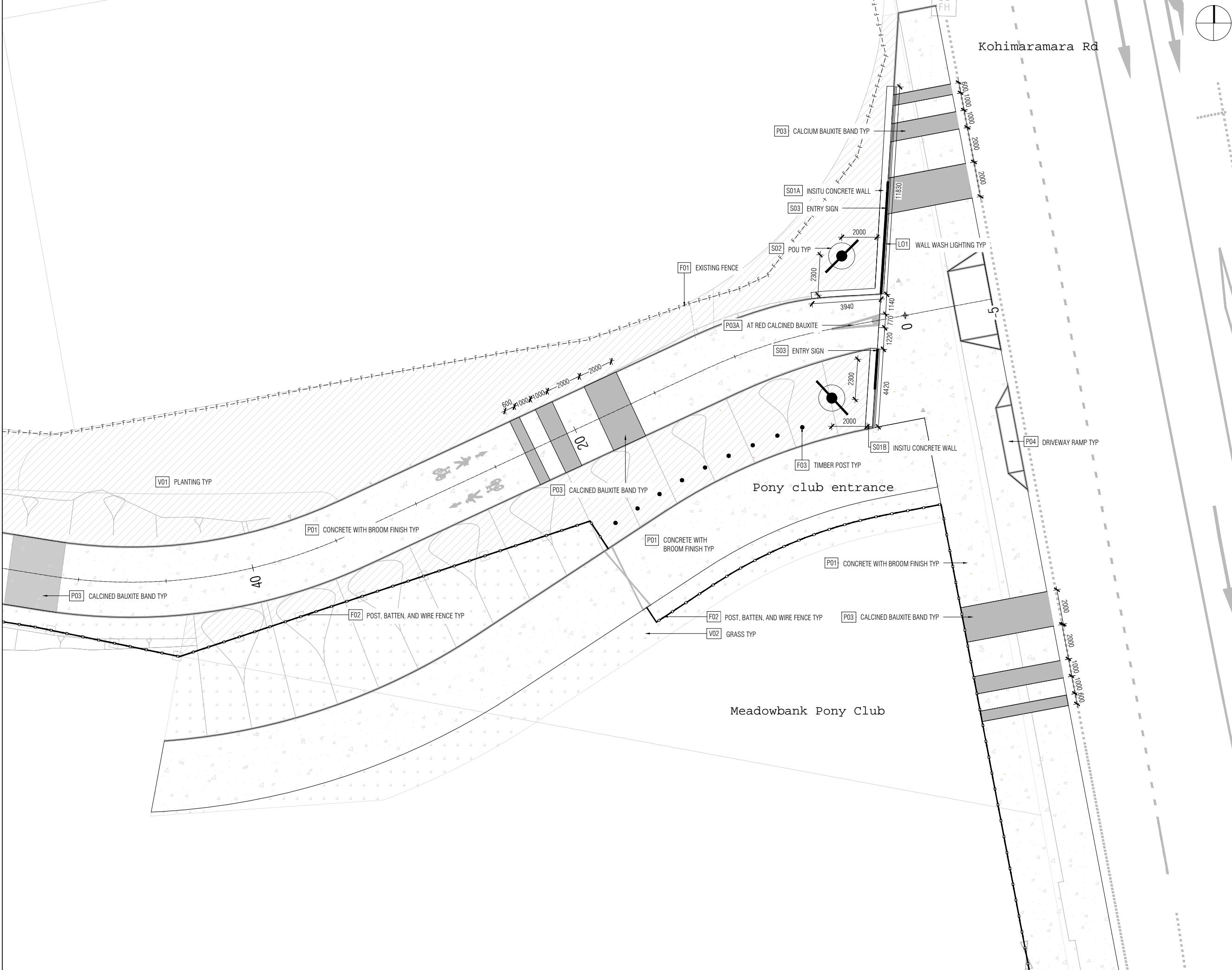

NOTES

CONTRACTORS TO VERIFY ALL DIMENSIONS ON SITE PRIOR TO COMMENCING WORK;

CONTRACTORS ARE RESPONSIBLE FOR CONFIRMING THE LOCATION OF ALL UNDERGROUND SERVICES ON SITE PRIOR TO COMMENCING WORK;

FIGURED DIMENSIONS TO BE TAKEN IN PREFERENCE TO SCALED DIMENSIONS.

TO BE READ IN CONJUNCTION WITH CIVIL DRAWINGS.

REFER TO CIVIL DRAWING 80504522-C4-0402_G410 FOR RIPRAP DETAILS.

KEY

21.04.20	FOR CONSTRUCTION
REV DATE	DESCRIPTION

FOR CONSTRUCTION

Design	LCh	Scale	Date
Drawn	LCh	1:100 @ A1	21.04.2020
Check	MLe	1:200 @ A3	
App'vd	MLe		

CONSULTANTS

CLIENT
AUCKLAND TRANSPORT

Boffa Miskell Limited
 Level 3 IBM Centre
 82 Wyndham Street 1010
 PO Box 91250, Auckland 1142, New Zealand
 Tel: +64 9 358 2526
 www.boffamiskell.co.nz

TE ARA KI UTA KI TAI
Section 2

GENERAL ARRANGEMENT
 FOCUS PLAN
 ST. JOHNS ENTRANCE

DRAWING NO.	REVISION
A15155_S2_110	-

This graphic has been prepared by Boffa Miskell Limited on the specific instructions of our Client. It is solely for our Client's use in accordance with the agreed scope of work. Any use or reliance by a third party is at that party's own risk. Where information has been supplied by the Client or obtained from other external sources, it has been assumed that it is accurate. No liability or responsibility is accepted by Boffa Miskell Limited for any errors or omissions to the extent that they arise from inaccurate information provided by the Client or any external source.



NOTES

- CONTRACTORS TO VERIFY ALL DIMENSIONS ON SITE PRIOR TO COMMENCING WORK;
 - CONTRACTORS ARE RESPONSIBLE FOR CONFIRMING THE LOCATION OF ALL UNDERGROUND SERVICES ON SITE PRIOR TO COMMENCING WORK;
 - FIGURED DIMENSIONS TO BE TAKEN IN PREFERENCE TO SCALED DIMENSIONS.
 - TO BE READ IN CONJUNCTION WITH CIVIL DRAWINGS.
 - REFER TO CIVIL DRAWING 80504522-C4-0402_G410 FOR RIPRAP DETAILS.
- KEY**

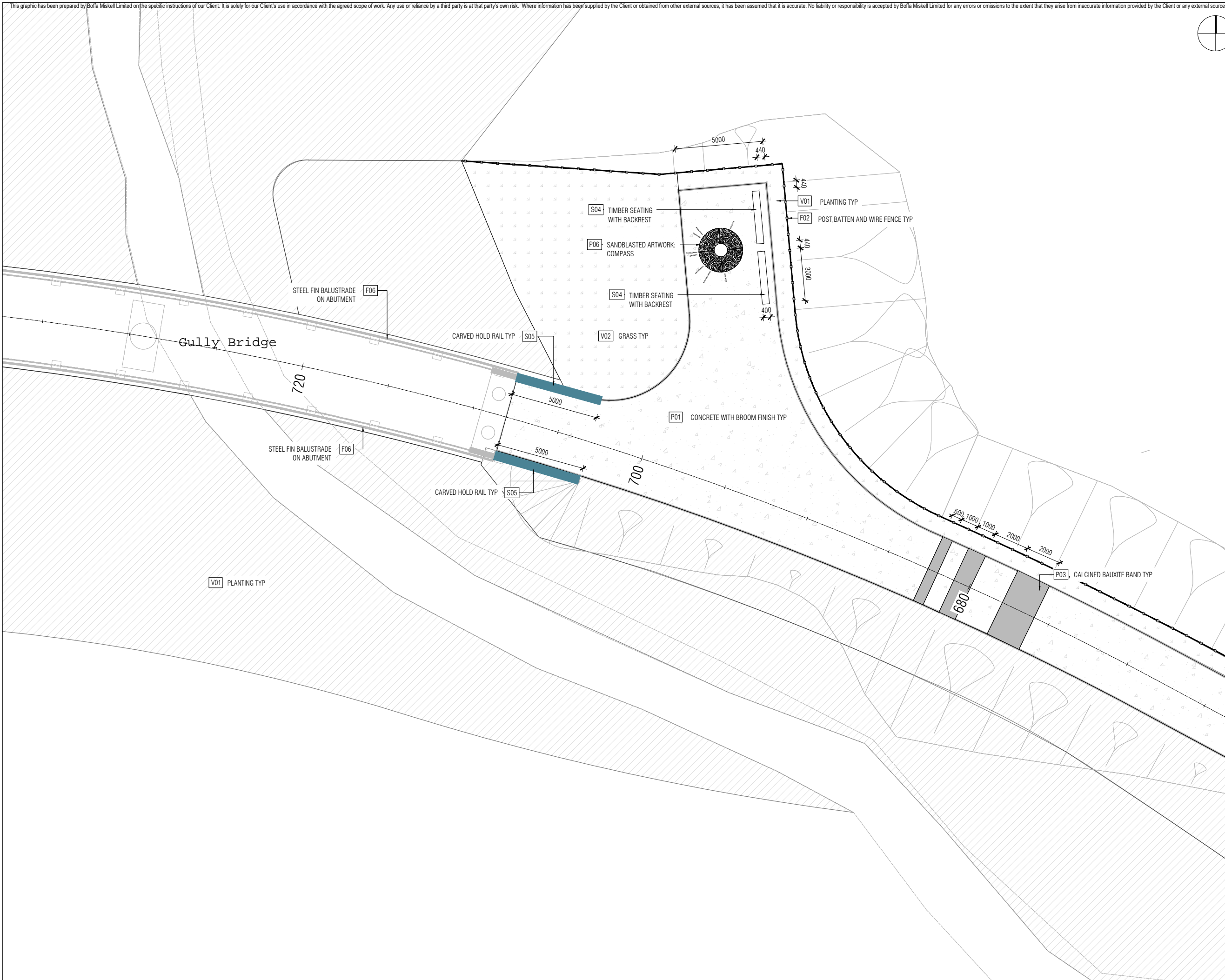

1	15.05.20	FOR INFORMATION
-	21.04.20	FOR INFORMATION
REV	DATE	DESCRIPTION

FOR INFORMATION

Design	LCh	Scale	Date
Drawn	LCh	1:100 @ A1	21.04.2020
Check	MLe	1:200 @ A3	
App'vd	MLe		

CONSULTANTS

CLIENT
AUCKLAND TRANSPORT



Boffa Miskell Limited
Level 3 IBM Centre
82 Wyndham Street 1010
PO Box 91250, Auckland 1142, New Zealand
Tel: +64 9 358 2526
www.boffamiskell.co.nz

TE ARA KI UTA KI TAI
Section 2

GENERAL ARRANGEMENT
FOCUS PLAN
TURN-AROUND B2 GULLY BRIDGE

DRAWING NO. REVISION

A15155_S2_111

1

This graphic has been prepared by Boffa Miskell Limited on the specific instructions of our Client. It is solely for our Client's use in accordance with the agreed scope of work. Any use or reliance by a third party is at that party's own risk. Where information has been supplied by the Client or obtained from other external sources, it has been assumed that it is accurate. No liability or responsibility is accepted by Boffa Miskell Limited for any errors or omissions to the extent that they arise from inaccurate information provided by the Client or any external source.



JOHN RHYMER PLACE
POTENTIAL CONNECTION PLANTING

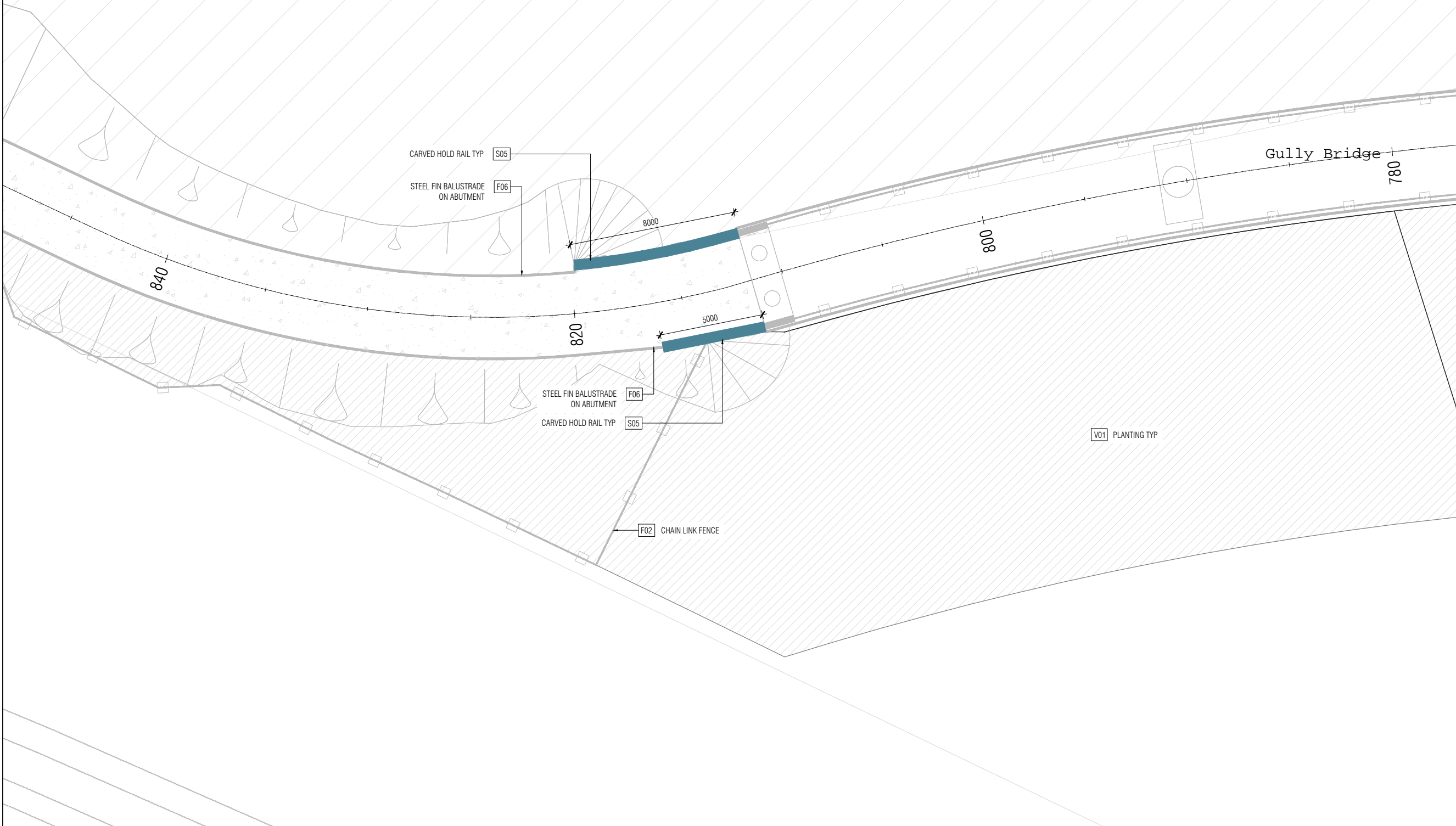

NOTES

CONTRACTORS TO VERIFY ALL DIMENSIONS ON SITE PRIOR TO COMMENCING WORK;

CONTRACTORS ARE RESPONSIBLE FOR CONFIRMING THE LOCATION OF ALL UNDERGROUND SERVICES ON SITE PRIOR TO COMMENCING WORK;

FIGURED DIMENSIONS TO BE TAKEN IN PREFERENCE TO SCALED DIMENSIONS.

TO BE READ IN CONJUNCTION WITH CIVIL DRAWINGS.

REFER TO CIVIL DRAWING 80504522-C4-0402_G410 FOR RIPRAP DETAILS.

KEY

1	15.05.20	FOR INFORMATION
-	21.04.20	FOR INFORMATION
REV	DATE	DESCRIPTION

FOR INFORMATION

Design	LCh	Scale	Date
Drawn	LCh	1:100 @ A1	21.04.2020
Check	MLe	1:200 @ A3	
App'vd	MLe		

CONSULTANTS

CLIENT
AUCKLAND TRANSPORT



Boffa Miskell Limited
Level 3 IBM Centre
82 Wyndham Street 1010
PO Box 91250, Auckland 1142, New Zealand
Tel: +64 9 358 2526
www.boffamiskell.co.nz

TE ARA KI UTA KI TAI
Section 2

GENERAL ARRANGEMENT
FOCUS PLAN
B2 GULLY BRIDGE WEST END

DRAWING NO.	REVISION
A15155_S2_112	1



NOTES

CONTRACTORS TO VERIFY ALL DIMENSIONS ON SITE PRIOR TO COMMENCING WORK;
 CONTRACTORS ARE RESPONSIBLE FOR CONFIRMING THE LOCATION OF ALL UNDERGROUND SERVICES ON SITE PRIOR TO COMMENCING WORK;
 FIGURED DIMENSIONS TO BE TAKEN IN PREFERENCE TO SCALED DIMENSIONS.
 TO BE READ IN CONJUNCTION WITH CIVIL DRAWINGS.
 REFER TO CIVIL DRAWING 80504522-C4-0402_G410 FOR RIPRAP DETAILS.
KEY

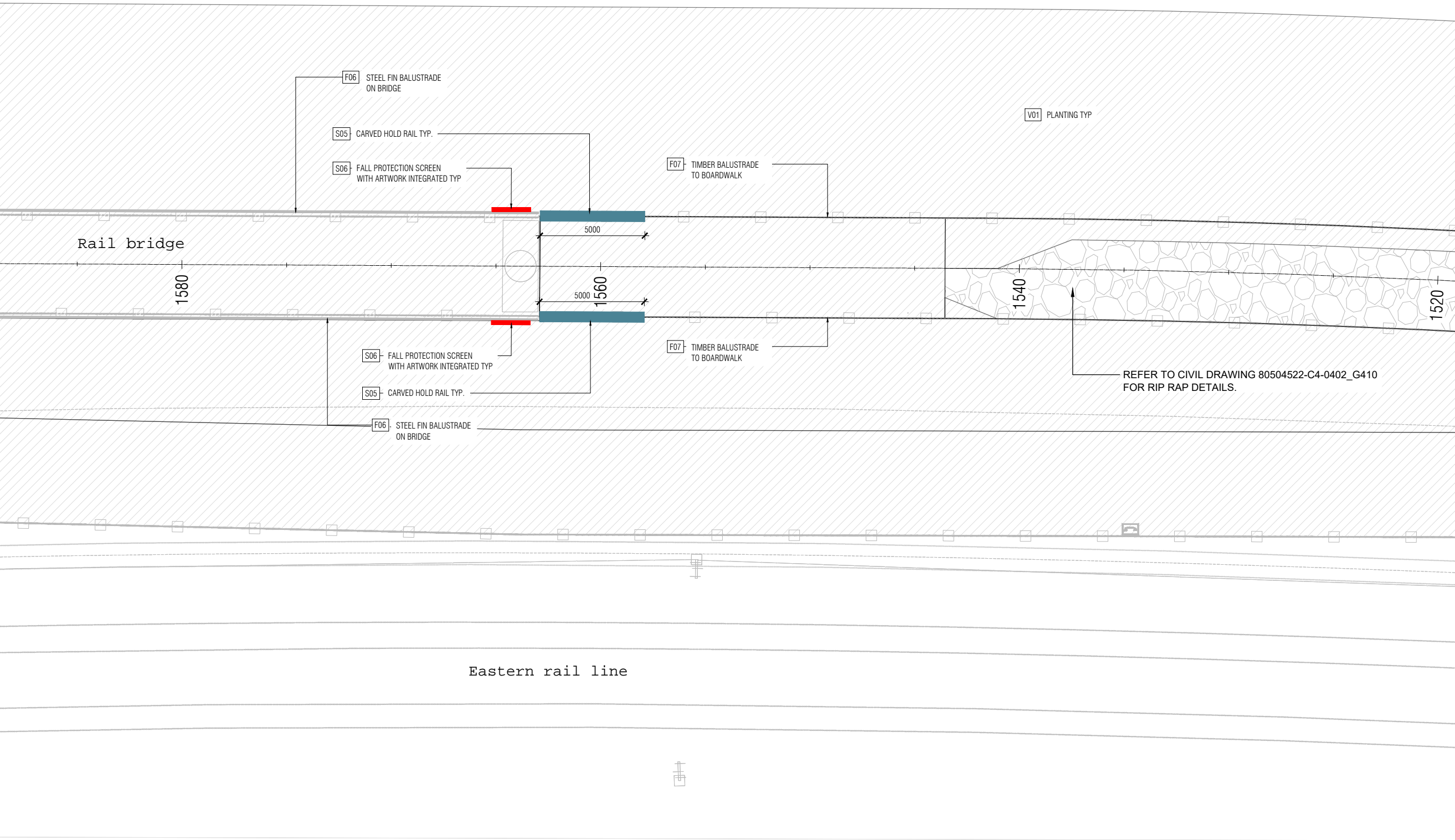

1	15.05.20	FOR INFORMATION
-	21.04.20	FOR INFORMATION
REV	DATE	DESCRIPTION

FOR INFORMATION

Design	LCh	Scale	Date
Drawn	LCh	1:1250 @ A1	21.04.2020
Check	MLe	1:2500 @ A3	
App'vd	MLe		

CONSULTANTS

CLIENT
AUCKLAND TRANSPORT



Boffa Miskell Limited
 Level 3 IBM Centre
 82 Wyndham Street 1010
 PO Box 91250, Auckland 1142, New Zealand
 Tel: +64 9 358 2526
 www.boffamiskell.co.nz

TE ARA KI UTA KI TAI
Section 2

GENERAL ARRANGEMENT
 FOCUS PLAN
 B6 BRIDGE EAST END

DRAWING NO. REVISION

A15155_S2_121

1

This graphic has been prepared by Boffa Miskell Limited on the specific instructions of our Client. It is solely for our Client's use in accordance with the agreed scope of work. Any use or reliance by a third party is at that party's own risk. Where information has been supplied by the Client or obtained from other external sources, it has been assumed that it is accurate. No liability or responsibility is accepted by Boffa Miskell Limited for any errors or omissions to the extent that they arise from inaccurate information provided by the Client or any external source.

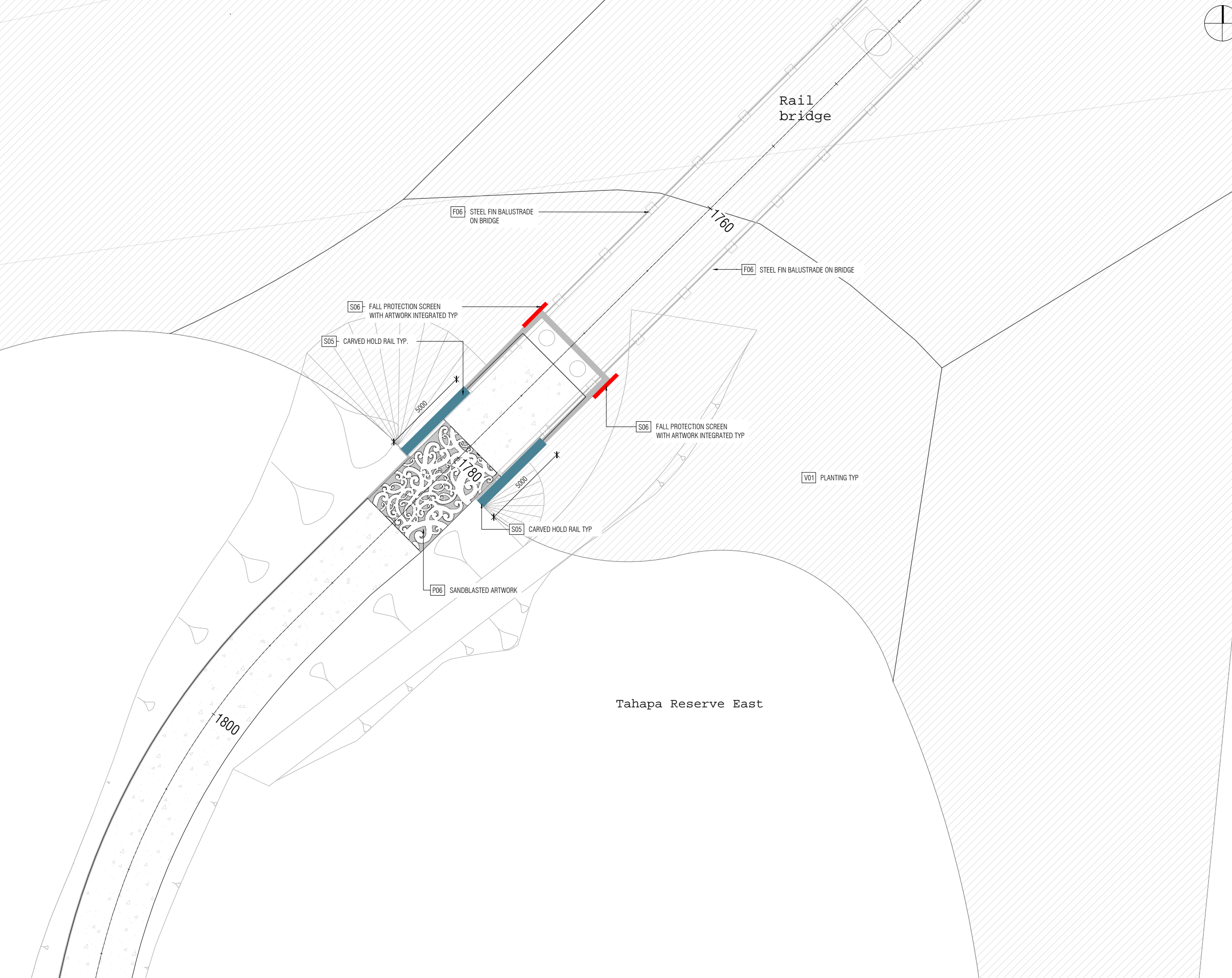

NOTES

- CONTRACTORS TO VERIFY ALL DIMENSIONS ON SITE PRIOR TO COMMENCING WORK;
 - CONTRACTORS ARE RESPONSIBLE FOR CONFIRMING THE LOCATION OF ALL UNDERGROUND SERVICES ON SITE PRIOR TO COMMENCING WORK;
 - FIGURED DIMENSIONS TO BE TAKEN IN PREFERENCE TO SCALED DIMENSIONS.
 - TO BE READ IN CONJUNCTION WITH CIVIL DRAWINGS.
 - REFER TO CIVIL DRAWING 80504522-C4-0402_G410 FOR RIPRAP DETAILS.
- KEY**

1	15.05.20	FOR INFORMATION
-	21.04.20	FOR INFORMATION
REV	DATE	DESCRIPTION

FOR INFORMATION

Design	LCh	Scale	Date
Drawn	LCh	1:1250 @ A1	21.04.2020
Check	MLe	1:2500 @ A3	
App'd	MLe		

CONSULTANTS

CLIENT
AUCKLAND TRANSPORT



Boffa Miskell Limited
Level 3 IBM Centre
82 Wyndham Street 1010
PO Box 91250, Auckland 1142, New Zealand
Tel: +64 9 358 2526
www.boffamiskell.co.nz

TE ARA KI UTA KI TAI
Section 2

GENERAL ARRANGEMENT
FOCUS PLAN
B6 BRIDGE WEST END

DRAWING NO. REVISION

A15155_S2_122

1

This graphic has been prepared by Boffa Miskell Limited on the specific instructions of our Client. It is solely for our Client's use in accordance with the agreed scope of work. Any use or reliance by a third party is at that party's own risk. Where information has been supplied by the Client or obtained from other external sources, it has been assumed that it is accurate. No liability or responsibility is accepted by Boffa Miskell Limited for any errors or omissions to the extent that they arise from inaccurate information provided by the Client or any external source.



NOTES

- CONTRACTORS TO VERIFY ALL DIMENSIONS ON SITE PRIOR TO COMMENCING WORK;
- CONTRACTORS ARE RESPONSIBLE FOR CONFIRMING THE LOCATION OF ALL UNDERGROUND SERVICES ON SITE PRIOR TO COMMENCING WORK;
- FIGURED DIMENSIONS TO BE TAKEN IN PREFERENCE TO SCALED DIMENSIONS.
- TO BE READ IN CONJUNCTION WITH CIVIL DRAWINGS.
- REFER TO CIVIL DRAWING 80504522-C4-0402_G410 FOR RIPRAP DETAILS.
- KEY

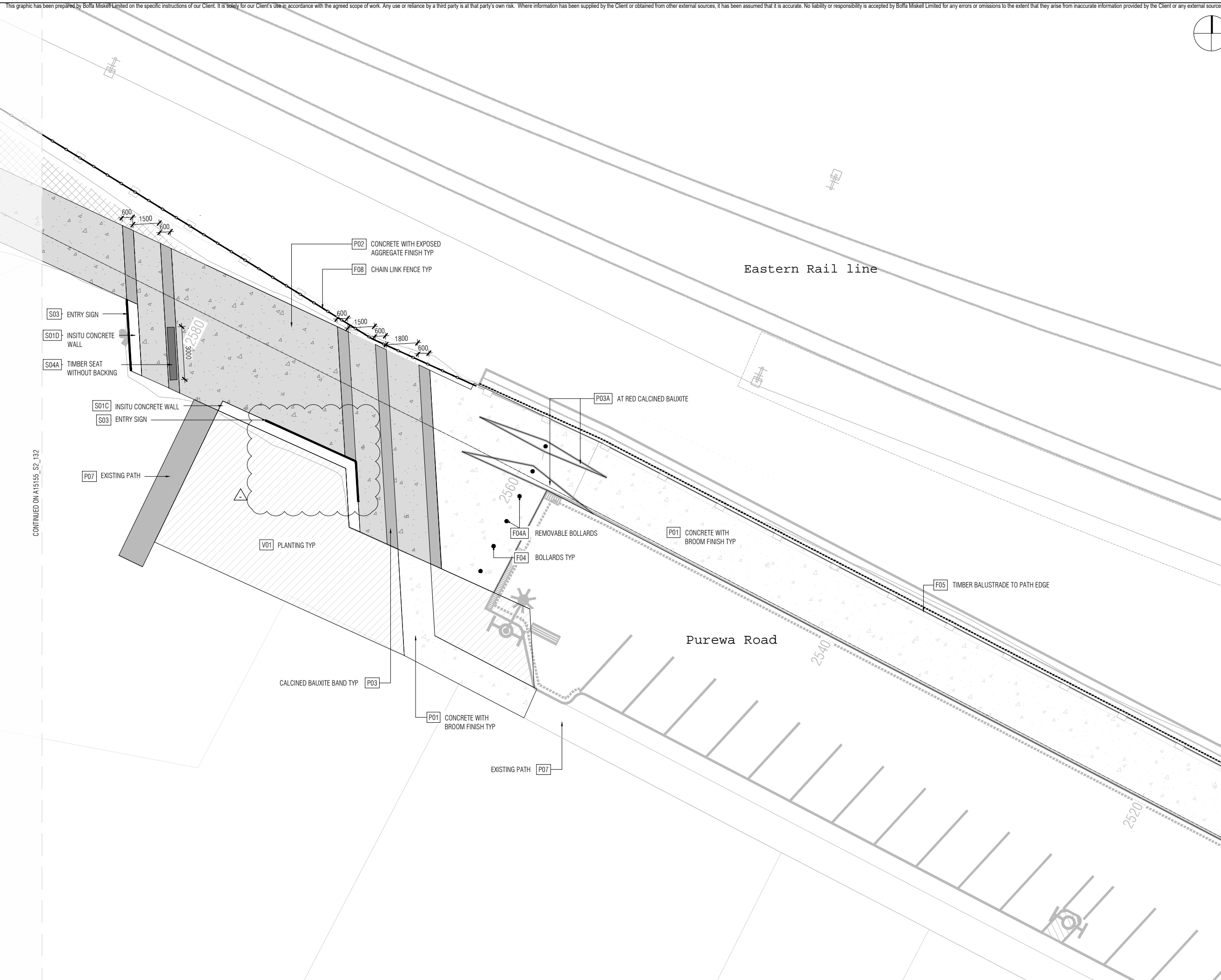

CONTINUED ON A15155_S2_132

REV	DATE	DESCRIPTION
-	21.04.20	FOR CONSTRUCTION

FOR CONSTRUCTION

Design	LCh	Scale	Date
Drawn	LCh	1:1250 @ A1	21.04.2020
Check	MLe	1:2500 @ A3	
App'vd	MLe		

CONSULTANTS

CLIENT
AUCKLAND TRANSPORT



Boffa Miskell Limited
Level 3 IBM Centre
82 Wyndham Street 1010
PO Box 91250, Auckland 1142, New Zealand
Tel: +64 9 358 2526
www.boffamiskell.co.nz

TE ARA KI UTA KI TAI
Section 2

GENERAL ARRANGEMENT
FOCUS PLAN
MEADOWBANK EAST

DRAWING NO.	REVISION
A15155_S2_131	-

This graphic has been prepared by Boffa Miskell Limited on the specific instructions of our Client. It is solely for our Client's use in accordance with the agreed scope of work. Any use or reliance by a third party is at that party's own risk. Where information has been supplied by the Client or obtained from other external sources, it has been assumed that it is accurate. No liability or responsibility is accepted by Boffa Miskell Limited for any errors or omissions to the extent that they arise from inaccurate information provided by the Client or any external source.



NOTES

CONTRACTORS TO VERIFY ALL DIMENSIONS ON SITE PRIOR TO COMMENCING WORK;

CONTRACTORS ARE RESPONSIBLE FOR CONFIRMING THE LOCATION OF ALL UNDERGROUND SERVICES ON SITE PRIOR TO COMMENCING WORK;

FIGURED DIMENSIONS TO BE TAKEN IN PREFERENCE TO SCALED DIMENSIONS.

TO BE READ IN CONJUNCTION WITH CIVIL DRAWINGS.

REFER TO CIVIL DRAWING 80504522-C4-0402_G410 FOR RIPRAP DETAILS.

KEY

Orakei Basin Boardwalk

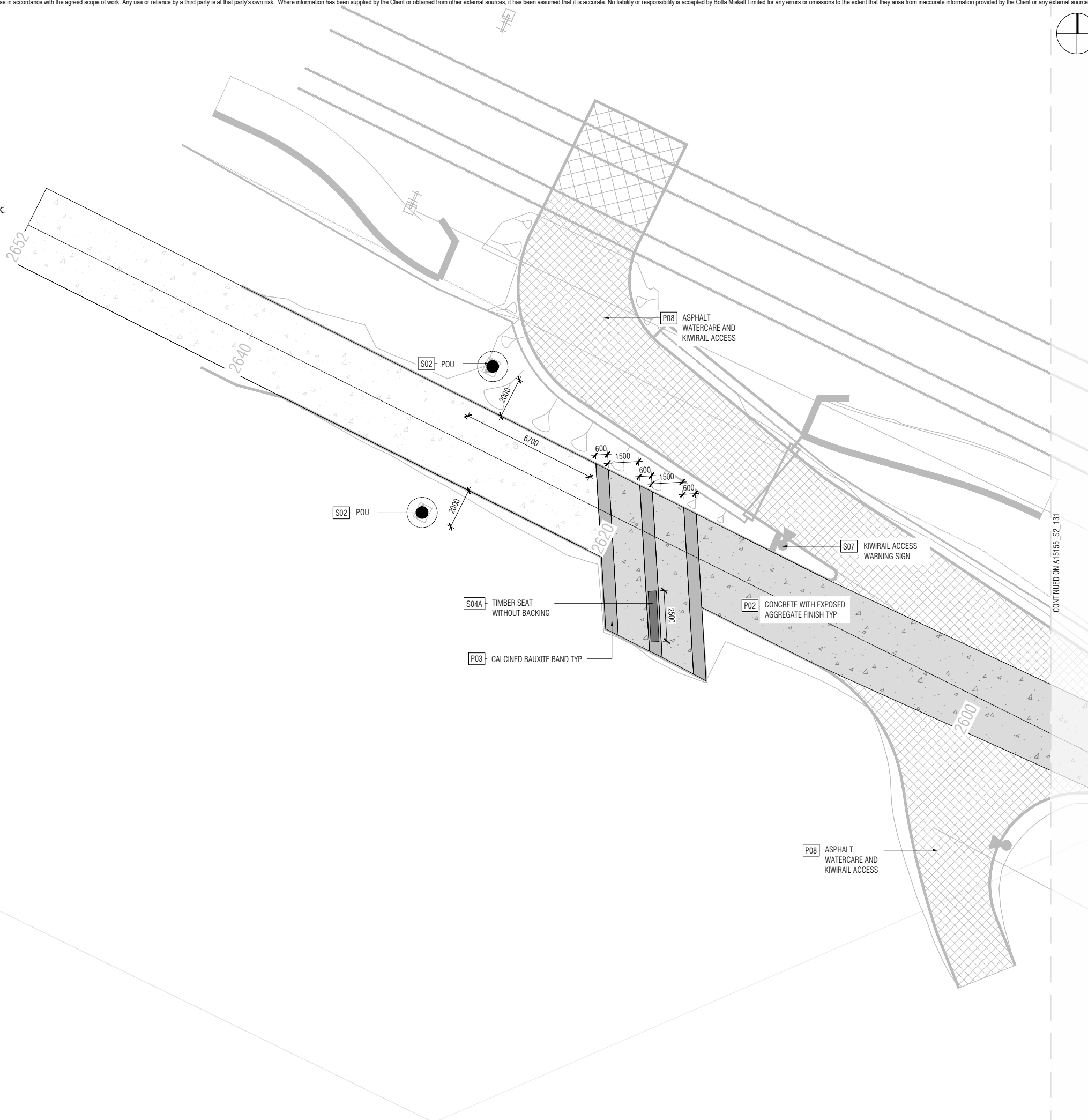

-	21.04.20	FOR CONSTRUCTION
REV	DATE	DESCRIPTION

FOR CONSTRUCTION

Design	LCh	Scale	Date
Drawn	LCh	1:1250 @ A1	21.04.2020
Check	MLe	1:2500 @ A3	
App'd	MLe		

CONSULTANTS

CLIENT
AUCKLAND TRANSPORT



Boffa Miskell Limited
Level 3 IBM Centre
82 Wyndham Street 1010
PO Box 91250, Auckland 1142, New Zealand
Tel: +64 9 358 2526
www.boffamiskell.co.nz

**TE ARA KI UTA KI TAI
Section 2**

GENERAL ARRANGEMENT
FOCUS PLAN
MEADOWBANK WEST

DRAWING NO.	REVISION
-------------	----------

A15155_S2_132

