

Rotorua Central Corridor confirmed design

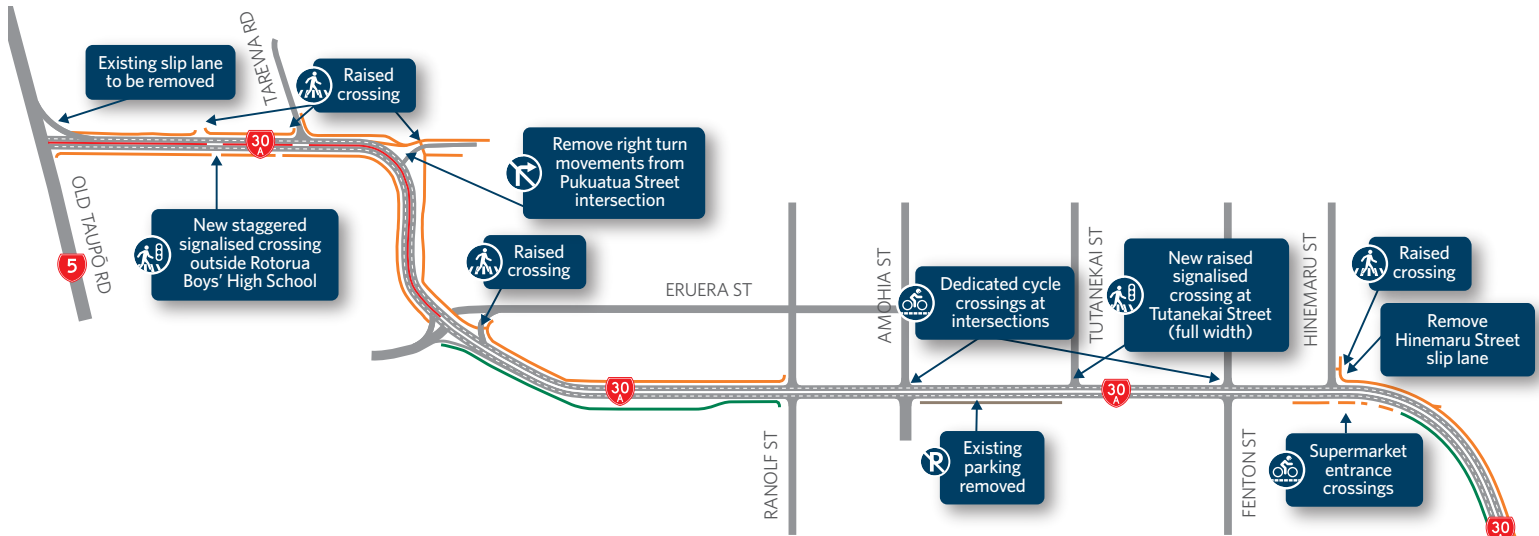

Central Corridor
(Old Taupō Road to Sala Street)

Benefits

Improved connectivity, multi-modal opportunities, and support for inner city revitalisation

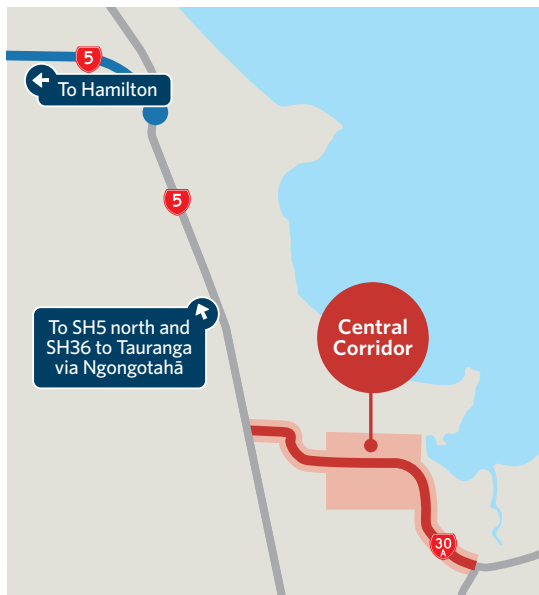

On-road cycle lanes (not shown on map)
Old Taupō Road to Amohia Street
Fenton Street to Sala Street

- EXISTING PATHS WIDENED
- NEW SHARED PATH
- NEW DUAL DIRECTION CYCLE LANE (SEPARATED) IN FRONT OF CENTRAL MALL
- SOLID MEDIAN THROUGHOUT (RIGHT TURNS STILL ONTO TAREWA ROAD AT ROTORUA BOYS' HIGH SCHOOL)

