







LEGEND

-  PROPOSED CONSTRUCTION FOOTPRINT
-  PROPOSED CONSTRUCTION SUBSURFACE
-  INDICATIVE CONSTRUCTION STORMWATER / SEDIMENT RETENTION PONDS
-  CONSTRUCTION YARD

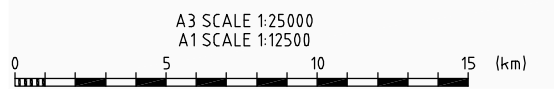

No.	Revision	By	Chk	Appd	Date
B	ISSUED FOR DC.1A/RC.3 COMPLIANCE	JRH			01.09.11
A	ISSUE FOR STATUTORY APPROVAL	ME			22.07.10

Drawing Originator:		Original Scale (A1) 1:12500	Designer RM
		Reduced Scale (A3) 1:25000	Reviewer BM
			Drafting Checked
			Consultant Approval AL
			Received by Beca



Project: **WATERVIEW CONNECTION PROJECT**
SH16 / SH20

Title: **CONSTRUCTION SCHEME PLANS**
KEY PLAN

FOR APPROVAL
NOT FOR ISSUE

Base level:
MSL AUCK. VERT. DATUM 1946

Grid Reference:
MT EDEN 2000

Originator No. _____

Project No. **20.111-3-D-N-912-100** Rev. **B**

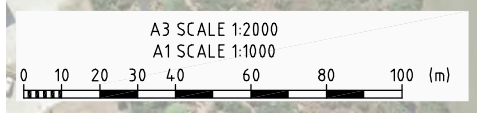
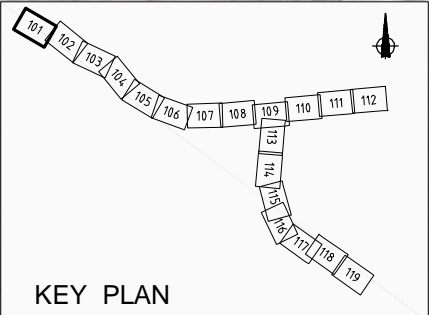

FOR APPROVAL
NOT FOR CONSTRUCTION

Base Level:
MSL AUCK. VERT. DATUM 1946
Grid Reference:

Mt Eden 2000
Originator No.
Project No.
20.1.11-3-D-N-912-101 Rev. D

No.	Revision	By	Chk	Appd	Date
D	ISSUED FOR STATUTORY APPROVAL	AG	COB	JH	02.08.10
C	ISSUE FOR EPA INFORMATION	AG	OB/NP	JH	25.06.10
B	ISSUE FOR SRT/NZTA REVIEW	WC	NP	JH	28.05.10
A	ISSUE FOR SRT/NZTA REVIEW	WC	NP	JH	18.05.10

Drawing Originator:
aurecon
Aurecon New Zealand Limited
138 Clarkson Drive Road (PO Box 6762) Newmarket, Auckland New Zealand
Telephone: +64 9 620-6010
Facsimile: +61 9 624-7916
Email: auckland@aurecongroup.com

Original Scale (A1)	1:1000	Design Engineer	AG
Reduced Scale (A3)	1:2000	Review Engineer	NP
		Drafting Checked	WC
		Consultant Approval	JH
		Reviewed by Beza	---



Project: **WATERVIEW CONNECTION PROJECT**
SH16 / SH20

Title: **CONSTRUCTION SCHEME PLANS**
SHEET 1

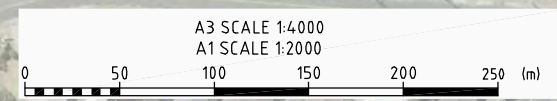
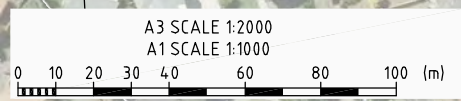

FOR APPROVAL
NOT FOR CONSTRUCTION

Base level:
MSL AUCK.VERT.DATUM 1946
Grid Reference:
Mt Eden 2000
Originator No.
Project No.
20.111-3-D-N-912-102
Rev.
E

No.	Revision	By	Chk	Appd	Date
E	ISSUED FOR DC1A/RC.3 COMPLIANCE	JRH			01.09.11
D	ISSUED FOR STATUTORY APPROVAL	AG	COB	JH	02.08.10
C	ISSUE FOR EPA INFORMATION	AG	DB/NP	JH	25.06.10
B	ISSUE FOR SRT/NZTA REVIEW	WC	NP	JH	28.05.10
A	ISSUE FOR SRT/NZTA REVIEW	WC	NP	JH	18.05.10

Drawing Originator:
aurecon
Aurecon New Zealand Limited
139 Canton Grove Road (PO Box 9782) Newmarket
Auckland New Zealand
Telephone: +64 9 825-2019
Facsimile: +61 9 824-7816
Email: auckland@aurecongroup.com

Original Scale (A1)	1:1000	Design Engineer	AG
Reduced Scale (A3)	1:2000	Review Engineer	NP
		Drafting Checked	WC
		Consultant Approval	JH
			--

NZ TRANSPORT AGENCY
WAKA KOTAHĪ

Project: **WATERVIEW CONNECTION**
CAUSEWAY

Title: **CONSTRUCTION SCHEME PLANS**
SHEET 2

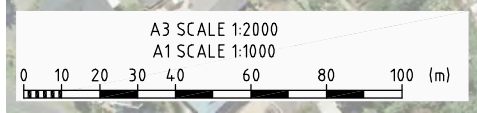
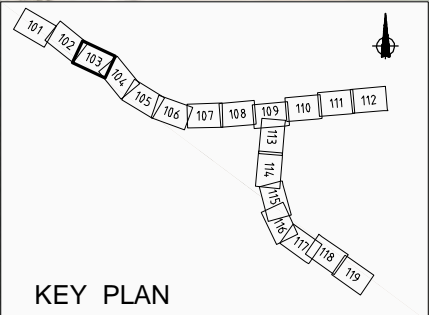

FOR APPROVAL
NOT FOR CONSTRUCTION

Base Level:
MSL AUCK. VERT. DATUM 1946
Grid Reference:

Mt Eden 2000
Originator No.
Project No.
20.111-3-D-N-912-103 Rev. D

No.	Revision	By	Chk	Appd	Date
D	ISSUED FOR STATUTORY APPROVAL	AG	COB	JH	02.08.10
C	ISSUE FOR EPA INFORMATION	AG	OB/NP	JH	25.06.10
B	ISSUED FOR SRT/NZTA REVIEW	WC	NP	JH	28.05.10
A	ISSUE FOR SRT/NZTA REVIEW	WC	NP	JH	18.05.10

Drawing Originator:
aurecon
Aurecon New Zealand Limited
139 Carlton Gore Road (PO Box 9762) Newmarket, Auckland, New Zealand
Telephone: +64 9 520-8019
Facsimile: +61 9 524-7816
Email: auckland@aurecongroup.com

Original Scale (A1)	1:1000	Design Engineer	AG
Reduced Scale (A3)	1:2000	Review Engineer	NP
		Drafting Checked	WC
		Consultant Approval	JH
		Reviewed by Becca	--

NZ TRANSPORT AGENCY
WAKA KOTAHAI

Project: **WATERVIEW CONNECTION PROJECT**
SH16 / SH20

Title: **CONSTRUCTION SCHEME PLANS**
SHEET 3

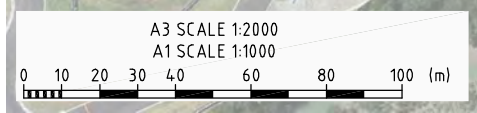
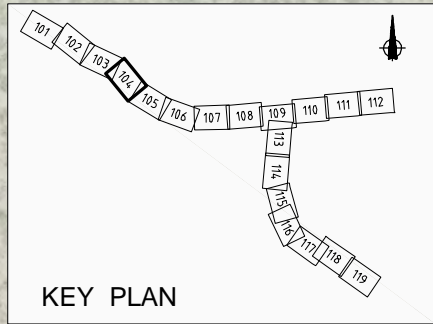

FOR APPROVAL
NOT FOR CONSTRUCTION

Base Level:
MSL AUCK.VERT.DATUM 1946
Grid Reference:

Mt Eden 2000
Originator No.
Project No.
20.111-3-D-N-912-104 Rev. D

No.	Revision	By	Chk	Appd	Date
D	ISSUED FOR STATUTORY APPROVAL	AG	COB	JH	02.08.10
C	ISSUE FOR EPA INFORMATION	AG	OB/NP	JH	25.06.10
B	ISSUE FOR SRT/NZTA REVIEW	WC	NP	JH	28.05.10
A	ISSUE FOR SRT/NZTA REVIEW	WC	NP	JH	18.05.10

Drawing Originator:
aurecon
Aurecon New Zealand Limited
139 Carlton Gore Road (PO Box 9762) Newmarket, Auckland, New Zealand
Telephone: +64 9 520-8019
Facsimile: +61 9 524-7816
Email: auckland@aurecongroup.com

Original Scale (A1)	1:1000	Design Engineer	AG
Reduced Scale (A3)	1:2000	Review Engineer	NP
		Drafting Checked	WC
		Consultant Approval	JH
		Reviewed by Beca	--



Project: **WATERVIEW CONNECTION PROJECT**
SH16 / SH20

Title: **CONSTRUCTION SCHEME PLANS**
SHEET 4



No.	Revision	By	Chk	Appd	Date
D	ISSUED FOR STATUTORY APPROVAL	AG	COB	JH	02.08.10
C	ISSUE FOR EPA INFORMATION	AG	OB/NP	JH	25.06.10
B	ISSUE FOR SRT/NZTA REVIEW	WC	NP	JH	28.05.10
A	ISSUE FOR SRT/NZTA REVIEW	WC	NP	JH	18.05.10

Drawing Originator:
aurecon
 Aurecon New Zealand Limited
 139 Carlton Gore Road (PO Box 9762) Newmarket, Auckland New Zealand
 Telephone: +64 9 520-8018
 Facsimile: +61 9 524-7816
 Email: auckland@aurecongroup.com

Original Scale (A1)	1:1000	Design Engineer	AG
Reduced Scale (A3)	1:2000	Review Engineer	NP
		Drafting Checked	WC
		Consultant Approval	JH
		Reviewed by Beqa	---



Project: **WATERVIEW CONNECTION PROJECT**
 SH16 / SH20

Title: **CONSTRUCTION SCHEME PLANS**
 SHEET 5

FOR APPROVAL
NOT FOR CONSTRUCTION

Base Level:
MSL AUCK. VERT. DATUM 1946
 Grid Reference:
Mt Eden 2000

Originator No. _____

Project No. **20.11-3-D-N-912-105** Rev. **D**

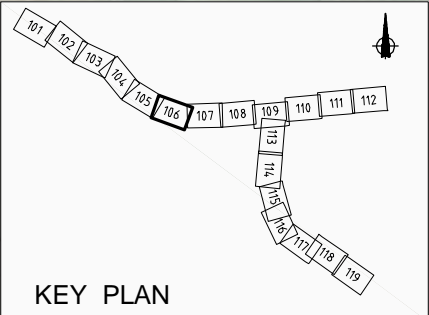

KEY PLAN

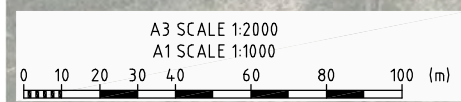

FOR APPROVAL
NOT FOR CONSTRUCTION

Base Level:	MSL AUCK.VERT.DATUM 1946
Grid Reference:	Mt Eden 2000
Originator No.	
Project No.	20.1.11-3-D-N-912-106
Rev.	D

No.	Revision	By	Chk	Appd	Date
D	ISSUED FOR STATUTORY APPROVAL	AG	COB	JH	02.08.10
C	ISSUE FOR EPA INFORMATION	AG	OB/NP	JH	25.06.10
B	ISSUE FOR SRT/NZTA REVIEW	WC	NP	JH	28.05.10
A	ISSUE FOR SRT/NZTA REVIEW	WC	NP	JH	18.05.10

Drawing Originator:
aurecon
Aurecon New Zealand Limited
139 Carlton Gore Road (PO Box 9762) Newmarket, Auckland New Zealand
Telephone: +64 9 520-8019
Facsimile: +61 9 524-7816
Email: auckland@aurecongroup.com

Original Scale (A1)	1:1000	Design Engineer	AG
Reduced Scale (A3)	1:2000	Review Engineer	NP
		Drafting Checked	WC
		Consultant Approval	JH
		Reviewed by Beca	--



Project: **WATERVIEW CONNECTION PROJECT**
SH16 / SH20

Title: **CONSTRUCTION SCHEME PLANS SHEET 6**

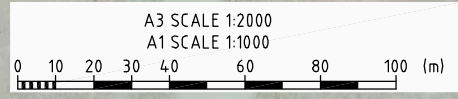
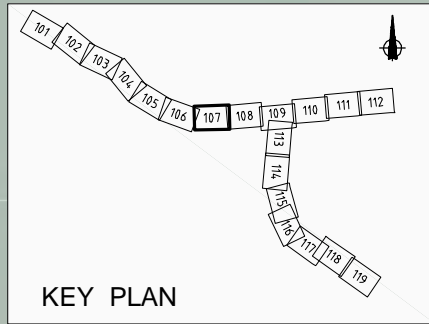

No.	Revision	By	Chk	Appd	Date
D	ISSUED FOR STATUTORY APPROVAL	AG	COB	JH	02.08.10
C	ISSUE FOR EPA INFORMATION	AG	OB/NP	JH	25.06.10
B	ISSUE FOR SRT/NZTA REVIEW	WC	NP	JH	28.05.10
A	ISSUE FOR SRT/NZTA REVIEW	WC	NP	JH	18.05.10

Drawing Originator:

Aurecon New Zealand Limited
139 Carlton Gore Road (PO Box 9762) Newmarket, Auckland New Zealand
Telephone: +64 9 520-8019
Facsimile: +61 9 524-7816
Email: auckland@aurecongroup.com

Original Scale (A1)	1:1000	Design Engineer	AG
Reduced Scale (A3)	1:2000	Review Engineer	NP
		Drafting Checked	WC
		Consultant Approval	JH
		Reviewed by Beca	--

NZ TRANSPORT AGENCY
WAKA KOTAHI

Project: **WATERVIEW CONNECTION PROJECT**
SH16 / SH20

Title: **CONSTRUCTION SCHEME PLANS**
SHEET 7

FOR APPROVAL
NOT FOR CONSTRUCTION

Base Level:
MSL AUCK.VERT.DATUM 1946
Grid Reference:
Mt Eden 2000

Originator No. _____

Project No. **20.1.11-3-D-N-912-107** Rev. **D**

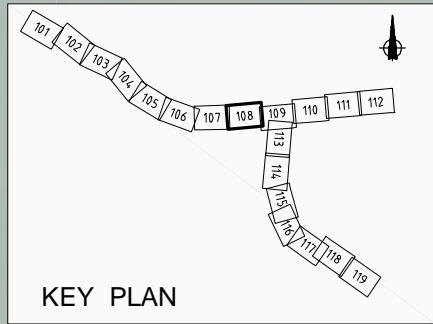

WAITEMATA HARBOUR

SH16

CONSTRUCTION YARD 3
(GNR INTERCHANGE)

WATERVIEW ESTUARY INLET

OAKLEY INLET

HEMINGTON ST

JOIN LINE SHEET 107

JOIN LINE SHEET 109

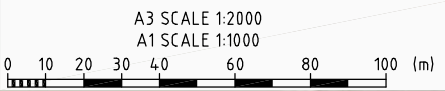

FOR APPROVAL
NOT FOR CONSTRUCTION

Base Level:
MSL AUCK. VERT. DATUM 1946
Grid Reference:
Mt Eden 2000

Originator No. _____

Project No. **20.1.11-3-D-N-912-108** Rev. **D**

No.	Revision	By	Chk	Appd	Date
D	ISSUED FOR STATUTORY APPROVAL	AG	COB	JH	02.08.10
C	ISSUE FOR EPA INFORMATION	AG	OB/NP	JH	25.06.10
B	ISSUE FOR SRT/NZTA REVIEW	WC	NP	JH	28.05.10
A	ISSUE FOR SRT/NZTA REVIEW	WC	NP	JH	18.05.10

Drawing Originator:

Aurecon New Zealand Limited
139 Carlton Gore Road (PO Box 9762) Newmarket, Auckland New Zealand
Telephone: +64 9 520-8019
Facsimile: +61 9 524-7816
Email: auckland@aurecongroup.com

Original Scale (A1)	1:1000	Design Engineer	AG
Reduced Scale (A3)	1:2000	Review Engineer	NP
		Drafting Checked	WC
		Consultant Approval	JH
		Reviewed by Beca	---

NZ TRANSPORT AGENCY
WAKA KOTAHĪ

Project: **WATERVIEW CONNECTION PROJECT**
SH16 / SH20

Title: **CONSTRUCTION SCHEME PLANS**
SHEET 8

XR 08-11-09-04-

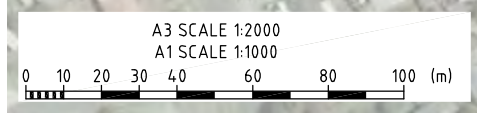
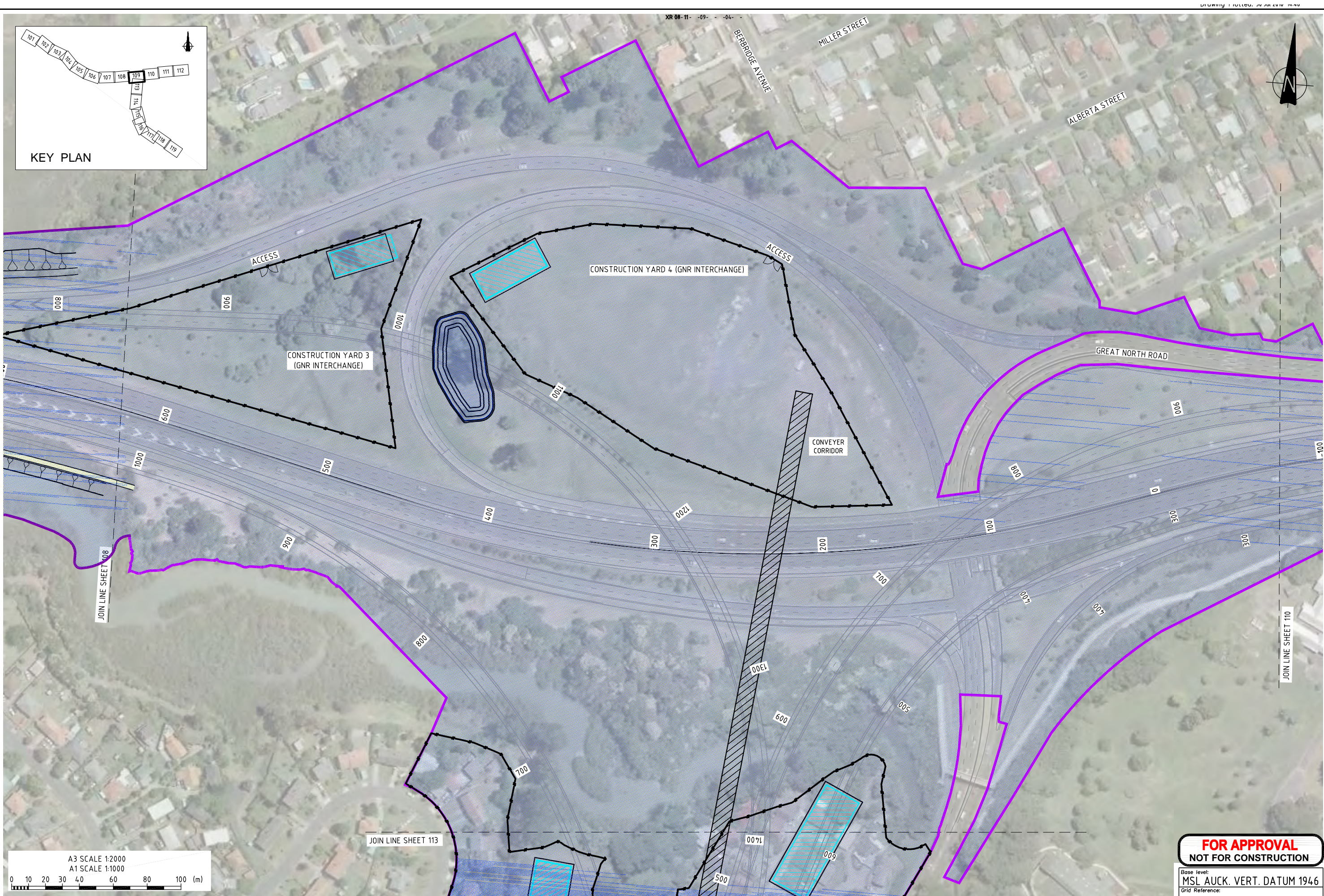
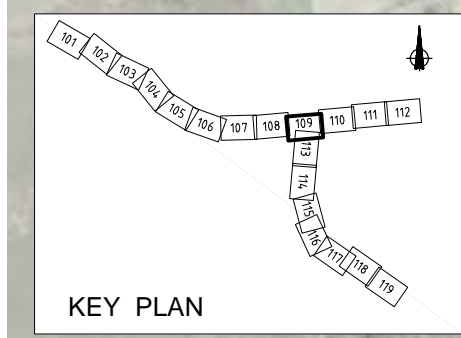

No.	Revision	By	Chk	Appd	Date
D	ISSUE FOR STATUTORY APPROVAL	BNRB			22.07.10
C	ISSUE FOR EPA INFORMATION	BNRB			25.06.10
B	ISSUE FOR SRT/NZTA REVIEW	BNRB			31.05.10
A	ISSUE FOR SRT/NZTA REVIEW	BNRB			17.05.10

Drawing Originator:

Original Scale (A1)	1:1000	Designer	RM
Reduced Scale (A3)	1:2000	Reviewer	BM
		Drafting Checked	BKD
		Consultant Approval	AL
		Received by Beca	-

NZ TRANSPORT AGENCY
WAKA KOTAHI

Project: WATERVIEW CONNECTION PROJECT
SH16 / SH20

Title: CONSTRUCTION SCHEME PLANS
SHEET 9

FOR APPROVAL
NOT FOR CONSTRUCTION

Base level: MSL AUCK. VERT. DATUM 1946
Grid Reference: MT EDEN 2000

Originator No. _____
Project No. 20.1.11-3-D-N-912-109
Rev. D

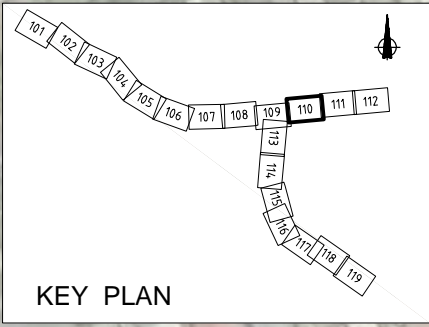

FOR APPROVAL
NOT FOR CONSTRUCTION

Base level:
MSL AUCK. VERT. DATUM 1946
Grid Reference:

MT EDEN 2000

Originator No.

Project No.
20.1.11-3-D-N-912-110

Rev.
D

No.	Revision	By	Chk	Appd	Date
D	ISSUE FOR STATUTORY APPROVAL	BNRB			22.07.10
C	ISSUE FOR EPA INFORMATION	BNRB			25.06.10
B	ISSUE FOR SRT/NZTA REVIEW	BNRB			31.05.10
A	ISSUE FOR SRT/NZTA REVIEW	BNRB			17.05.10

Drawing Originator:

Original Scale (A1)	1:1000	Designer	RM
Reduced Scale (A3)	1:2000	Reviewer	BM
		Drafting Checked	BKD
		Consultant Approval	AL
		Received by Beca	-

NZ TRANSPORT AGENCY
WAKA KOTAHI

Project: WATERVIEW CONNECTION PROJECT
SH16 / SH20

Title: CONSTRUCTION SCHEME PLANS
SHEET 10

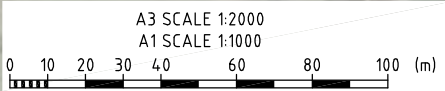
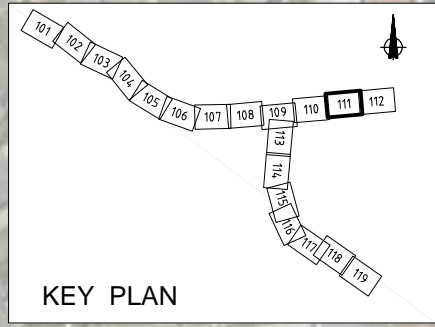

FOR APPROVAL
NOT FOR CONSTRUCTION

Base level:
MSL AUCK. VERT. DATUM 1946
Grid Reference:

MT EDEN 2000
Originator No.

Project No.
20.1.11-3-D-N-912-111
Rev.
D

No.	Revision	By	Chk	Appd	Date
D	ISSUE FOR STATUTORY APPROVAL	BNRB			22.07.10
C	ISSUE FOR EPA INFORMATION	BNRB			25.06.10
B	ISSUE FOR SRT/NZTA REVIEW	BNRB			31.05.10
A	ISSUE FOR SRT/NZTA REVIEW	BNRB			17.05.10

Drawing Originator:

Original Scale (A1)	1:1000	Designer	RM
Reduced Scale (A3)	1:2000	Reviewer	BM
		Drafting Checked	BKD
		Consultant Approval	AL
		Received by Beca	-

NZ TRANSPORT AGENCY
WAKA KOTAHI

Project: WATERVIEW CONNECTION
PROJECT
SH16 / SH20

Title: CONSTRUCTION SCHEME PLANS
SHEET 11

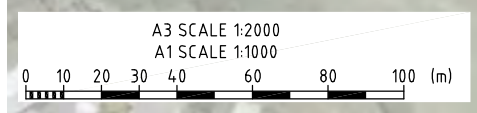
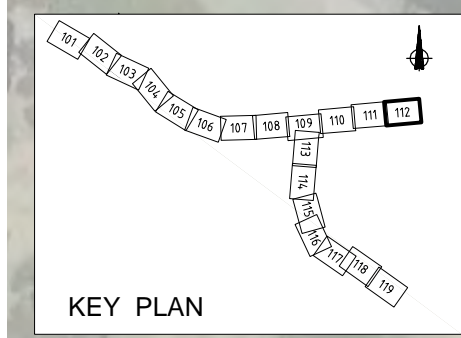

FOR APPROVAL
NOT FOR CONSTRUCTION

Base level:
MSL AUCK. VERT. DATUM 1946

Grid Reference:
MT EDEN 2000

Originator No.
Project No.
20.1.11-3-D-N-912-112

Rev.
D

No.	Revision	By	Chk	Appd	Date
D	ISSUE FOR STATUTORY APPROVAL	BNRB			22.07.10
C	ISSUE FOR EPA INFORMATION	BNRB			25.06.10
B	ISSUE FOR SRT/NZTA REVIEW	BNRB			31.05.10
A	ISSUE FOR SRT/NZTA REVIEW	BNRB			17.05.10

Drawing Originator:

Original Scale (A1)	1:1000	Designer	RM
Reduced Scale (A3)	1:2000	Reviewer	BM
		Drafting Checked	BKD
		Consultant Approval	AL
		Received by Beca	-

NZ TRANSPORT AGENCY
WAKA KOTAHI

Project: WATERVIEW CONNECTION
PROJECT
SH16 / SH20

Title: CONSTRUCTION SCHEME PLANS
SHEET 12

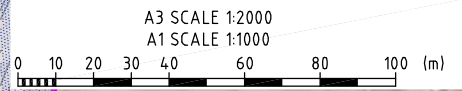
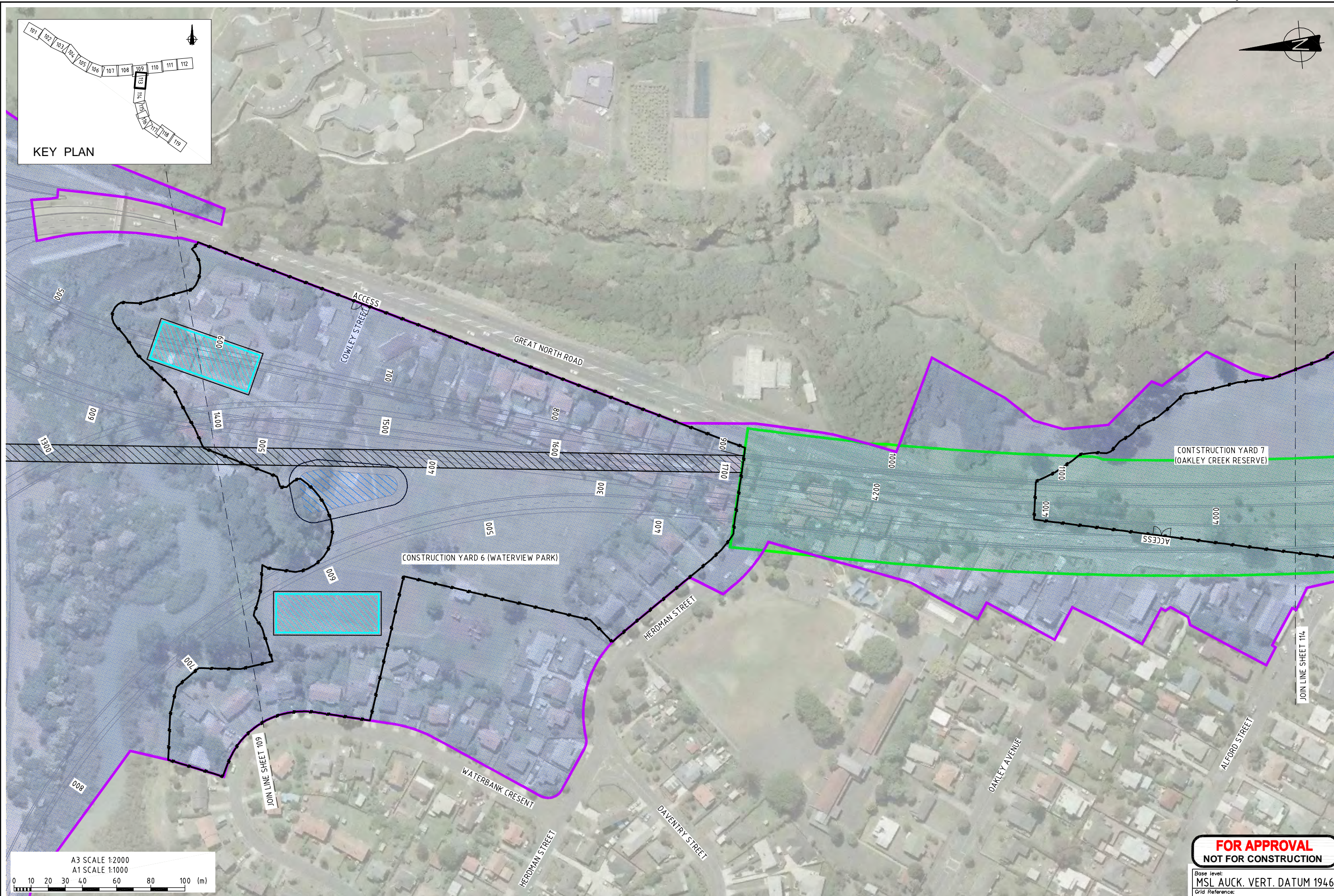
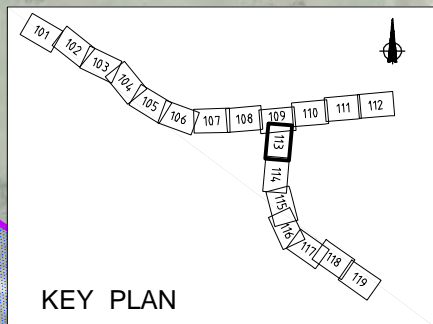

FOR APPROVAL
NOT FOR CONSTRUCTION

Base level:		MSL AUCK. VERT. DATUM 1946
Grid Reference:		MT EDEN 2000
Project No.		20.111-3-D-N-912-113
Rev.		E

No.	Revision	By	Chk	Appd	Date
E	ISSUE FOR STATUTORY APPROVAL	JRH			15.02.11
D	ISSUE FOR STATUTORY APPROVAL	BNRB			22.07.10
C	ISSUE FOR EPA INFORMATION	BNRB			25.06.10
B	ISSUE FOR SRT/NZTA REVIEW	BNRB			31.05.10
A	ISSUE FOR SRT/NZTA REVIEW	BNRB			17.05.10

Drawing Originator:		Original Scale (A1)		Designer		RM	
		1:1000		Reviewer		BM	
		Reduced Scale (A3)		Drafting Checked		BKD	
		1:2000		Consultant Approval		AL	
				Received by Beca		-	



Project: **WATERVIEW CONNECTION PROJECT**
SH16 / SH20

Title: **CONSTRUCTION SCHEME PLANS**
SHEET 13

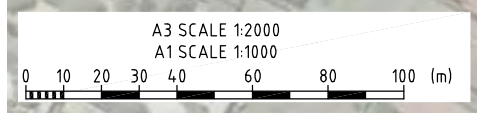
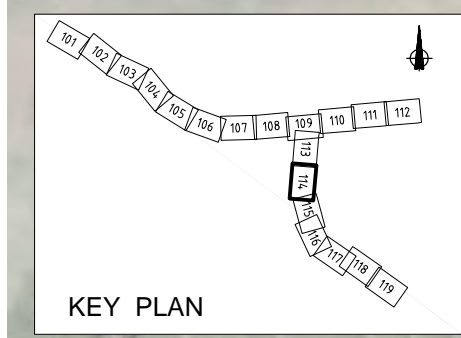

FOR APPROVAL
NOT FOR CONSTRUCTION

Base level:
MSL AUCK. VERT. DATUM 1946
Grid Reference:

MT EDEN 2000

Originator No.
Project No.
20.1.11-3-D-N-912-114

Rev.
D

No.	Revision	By	Chk	Appd	Date
D	ISSUE FOR STATUTORY APPROVAL	BNRB			22.07.10
C	ISSUE FOR EPA INFORMATION	BNRB			25.06.10
B	ISSUE FOR SRT/NZTA REVIEW	BNRB			31.05.10
A	ISSUE FOR SRT/NZTA REVIEW	BNRB			17.05.10

Drawing Originator:

Original Scale (A1)	1:1000	Designer	RM
Reduced Scale (A3)	1:2000	Reviewer	BM
		Drafting Checked	BKD
		Consultant Approval	AL
		Received by Beca	-

NZ TRANSPORT AGENCY
WAKA KOTAHI

Project: WATERVIEW CONNECTION
PROJECT
SH16 / SH20

Title: CONSTRUCTION SCHEME PLANS
SHEET 14

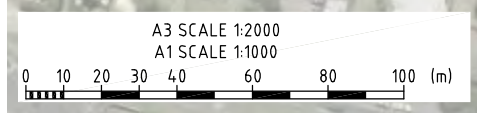
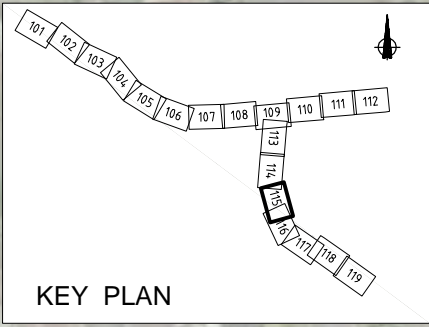

FOR APPROVAL
NOT FOR CONSTRUCTION

Base level:
MSL AUCK. VERT. DATUM 1946
Grid Reference:

MT EDEN 2000
Originator No.

Project No. 20.1.11-3-D-N-912-115
Rev. D

No.	Revision	By	Chk	Appd	Date
D	ISSUE FOR STATUTORY APPROVAL	BNRB			22.07.10
C	ISSUE FOR EPA INFORMATION	BNRB			25.06.10
B	ISSUE FOR SRT/NZTA REVIEW	BNRB			31.05.10
A	ISSUE FOR SRT/NZTA REVIEW	BNRB			17.05.10

Drawing Originator:

Original Scale (A1)	1:1000	Designer	RM
Reduced Scale (A3)	1:2000	Reviewer	BM
		Drafting Checked	BKD
		Consultant Approval	AL
		Received by Beca	-

NZ TRANSPORT AGENCY
WAKA KOTAHI

Project: WATERVIEW CONNECTION
PROJECT
SH16 / SH20

Title: CONSTRUCTION SCHEME PLANS
SHEET 15

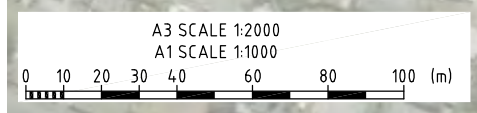
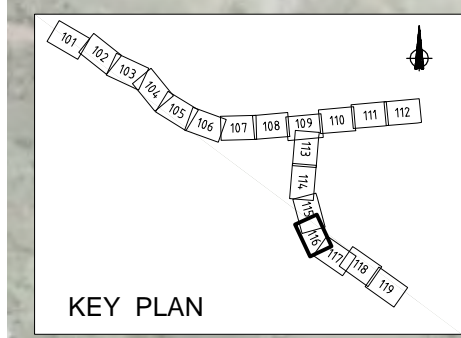

FOR APPROVAL
NOT FOR CONSTRUCTION

Base level:
MSL AUCK. VERT. DATUM 1946
Grid Reference:

MT EDEN 2000

Originator No.
Project No. 20.1.11-3-D-N-912-116
Rev. D

No.	Revision	By	Chk	Appd	Date
D	ISSUE FOR STATUTORY APPROVAL	BNRB			22.07.10
C	ISSUE FOR EPA INFORMATION	BNRB			25.06.10
B	ISSUE FOR SRT/NZTA REVIEW	BNRB			31.05.10
A	ISSUE FOR SRT/NZTA REVIEW	BNRB			17.05.10

Drawing Originator:

Original Scale (A1)	1:1000	Designer	RM
Reduced Scale (A3)	1:2000	Reviewer	BM
		Drafting Checked	BKD
		Consultant Approval	AL
		Received by Beca	-

NZ TRANSPORT AGENCY
WAKA KOTAHI

Project: WATERVIEW CONNECTION
PROJECT
SH16 / SH20

Title: CONSTRUCTION SCHEME PLANS
SHEET 16

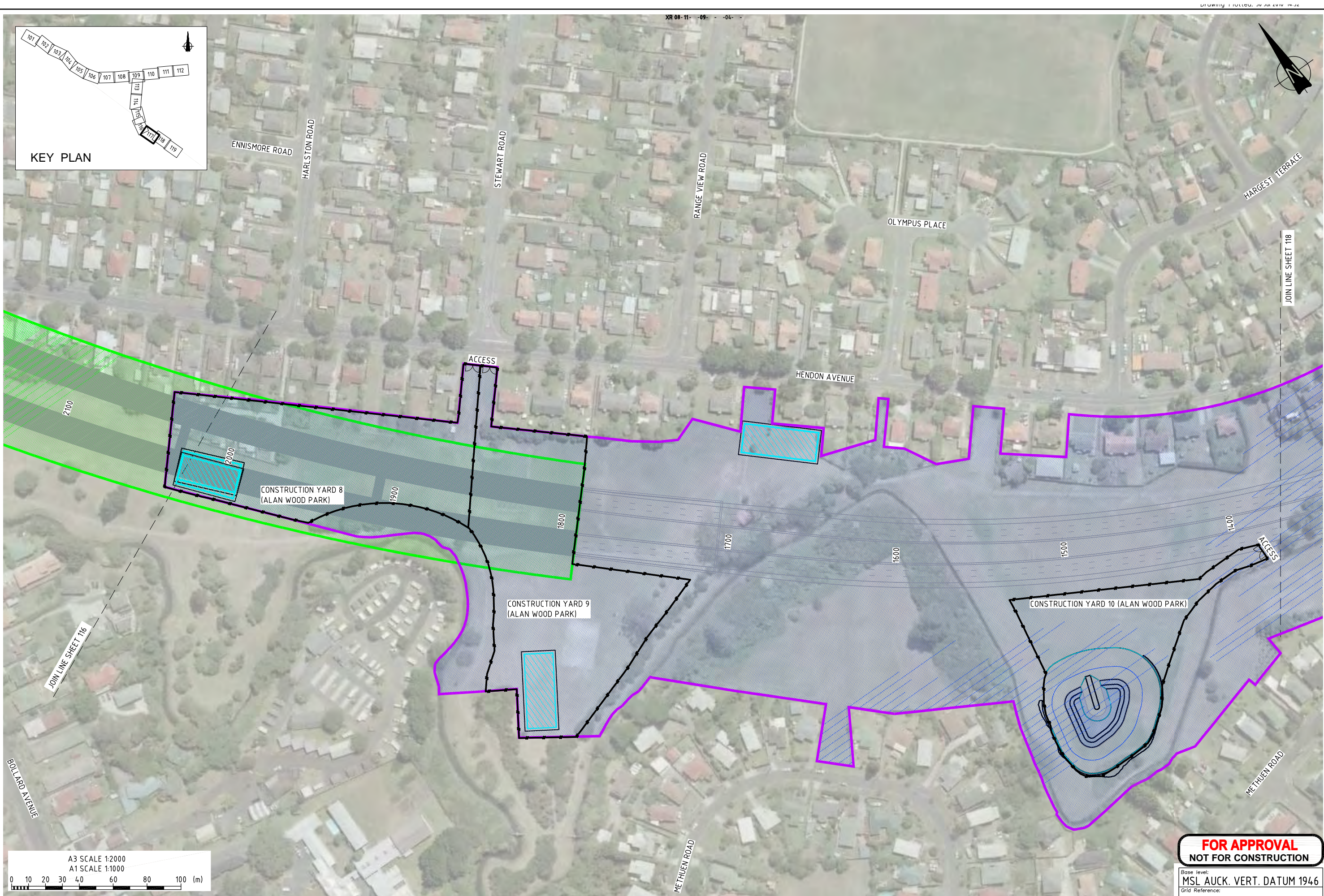
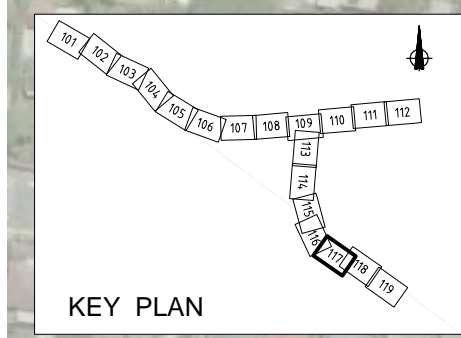

JOIN LINE SHEET 118

JOIN LINE SHEET 116

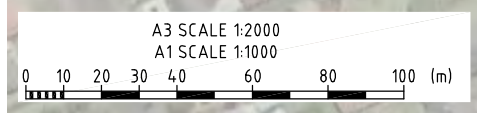

**FOR APPROVAL
NOT FOR CONSTRUCTION**

Base level:
MSL AUCK. VERT. DATUM 1946
Grid Reference:

MT EDEN 2000

Originator No.
Project No. 20.1.11-3-D-N-912-117
Rev. D

No.	Revision	By	Chk	Appd	Date
D	ISSUE FOR STATUTORY APPROVAL	BNRB			22.07.10
C	ISSUE FOR EPA INFORMATION	BNRB			25.06.10
B	ISSUE FOR SRT/NZTA REVIEW	BNRB			31.05.10
A	ISSUE FOR SRT/NZTA REVIEW	BNRB			17.05.10

Drawing Originator:

Original Scale (A1)	1:1000	Designer	RM
Reduced Scale (A3)	1:2000	Reviewer	BM
		Drafting Checked	BKD
		Consultant Approval	AL
		Received by Beca	-

NZ TRANSPORT AGENCY
WAKA KOTAHI

Project: WATERVIEW CONNECTION PROJECT
SH16 / SH20

Title: CONSTRUCTION SCHEME PLANS
SHEET 17

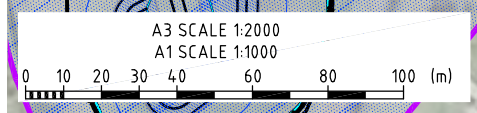
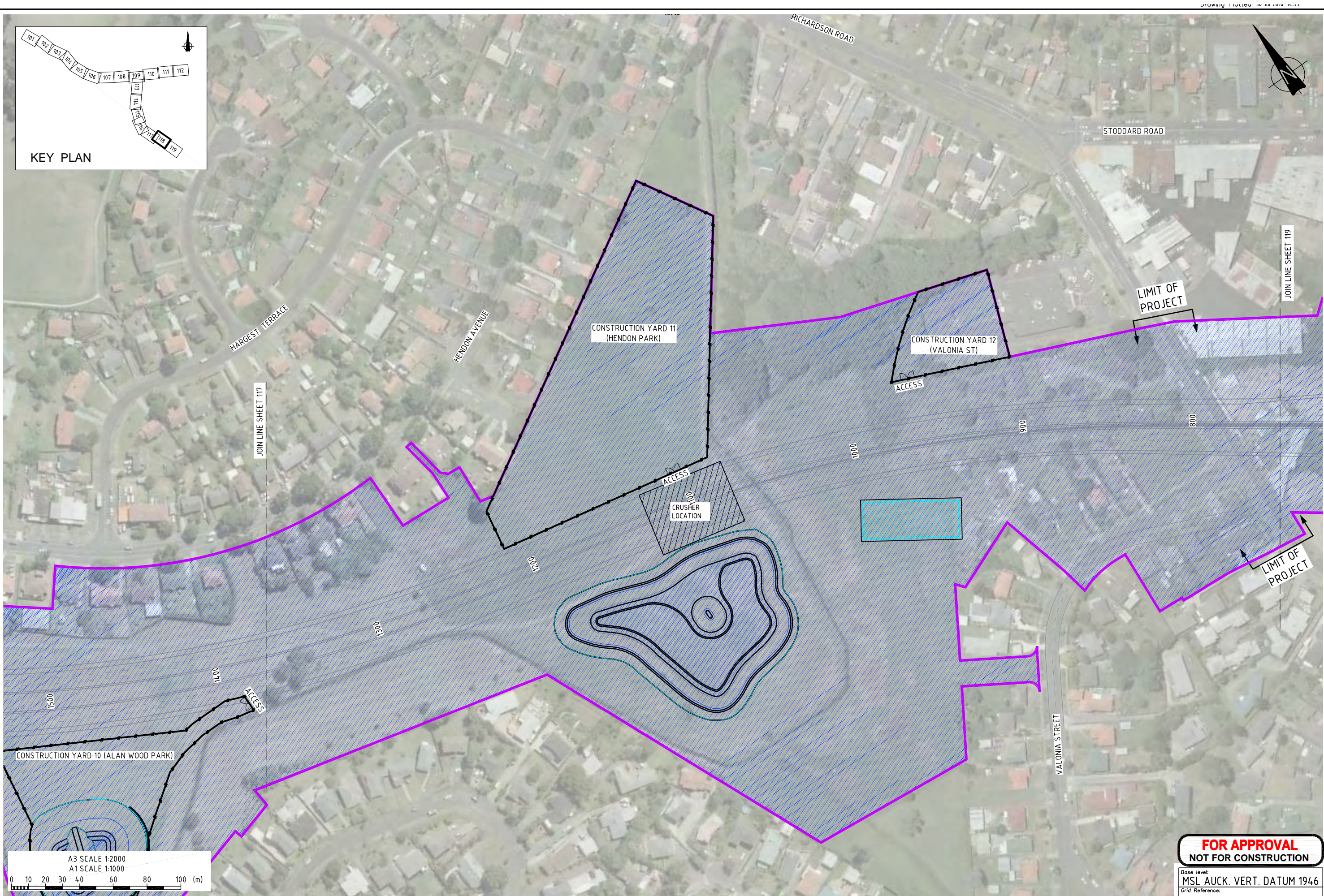
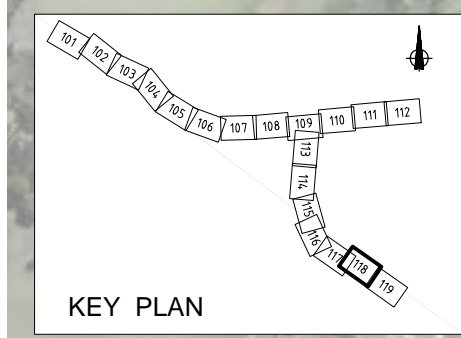

No.	Revision	By	Chk	Appd	Date
D	ISSUE FOR STATUTORY APPROVAL	BNRB			22.07.10
C	ISSUE FOR EPA INFORMATION	BNRB			25.06.10
B	ISSUE FOR SRT/NZTA REVIEW	BNRB			31.05.10
A	ISSUE FOR SRT/NZTA REVIEW	BNRB			17.05.10

Drawing Originator:

Original Scale (A1)	1:1000	Designer	RM
Reduced Scale (A3)	1:2000	Reviewer	BM
		Drafting Checked	BKD
		Consultant Approval	AL
		Received by Beca	-

NZ TRANSPORT AGENCY
WAKA KOTAHI

Project: WATERVIEW CONNECTION PROJECT
SH16 / SH20

Title: CONSTRUCTION SCHEME PLANS
SHEET 18

FOR APPROVAL
NOT FOR CONSTRUCTION

Base Level: MSL AUCK. VERT. DATUM 1946
Grid Reference: MT EDEN 2000

Originator No. _____
Project No. 20.1.11-3-D-N-912-118
Rev. D

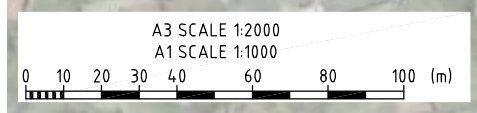
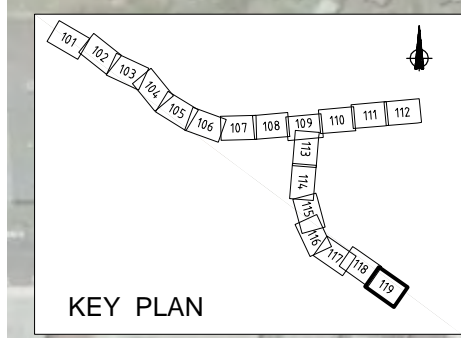

FOR APPROVAL
NOT FOR CONSTRUCTION

Base level:
MSL AUCK. VERT. DATUM 1946
Grid Reference:

MT EDEN 2000

Originator No.
Project No. 20.1.11-3-D-N-912-119
Rev. D

No.	Revision	By	Chk	Appd	Date
D	ISSUE FOR STATUTORY APPROVAL	BNRB			22.07.10
C	ISSUE FOR EPA INFORMATION	BNRB			25.06.10
B	ISSUE FOR SRT/NZTA REVIEW	BNRB			31.05.10
A	ISSUE FOR SRT/NZTA REVIEW	BNRB			17.05.10

Drawing Originator:
Beca

Original Scale (A1)	1:1000	Designer	RM
Reduced Scale (A3)	1:2000	Reviewer	BM
		Drafting Checked	BKD
		Consultant Approval	AL
		Received by Beca	-



Project: **WATERVIEW CONNECTION PROJECT**
SH16 / SH20

Title: **CONSTRUCTION SCHEME PLANS**
SHEET 19