

**LEGEND**

- - - EXISTING CMA BOUNDARY
- - - PROPOSED CMA BOUNDARY
- EXISTING OUTFALL STRUCTURE WITH CMA DISCHARGE
- OUTFALL STRUCTURE WITH CMA DISCHARGE.
- ACC EXISTING CMA DISCHARGE

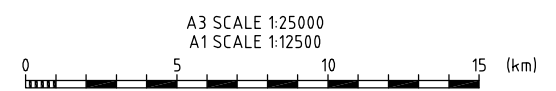

**FOR APPROVAL**  
**NOT FOR CONSTRUCTION**

Base level:  
MSL AUCK. VERT. DATUM 1946  
Grid Reference:

MT EDEN 2000  
Originator No.

Project No. 20.1.11-3-D-N-943-100  
Rev. B

No.	Revision	By	Chk	Appd	Date
B	ISSUE FOR STATUTORY APPROVAL	BNRB			22.07.10
A	ISSUE FOR SRT/NZTA REVIEW	BNRB			09.06.10

Drawing Originator:

Original Scale (A1)	1:12500	Designer	TF
Reduced Scale (A3)	1:25000	Reviewer	BM
		Drafting Checked	-
		Consultant Approval	AL
		Received by Beca	

NZ TRANSPORT AGENCY  
WAKA KOTAHI

Project: WATERVIEW CONNECTION PROJECT  
SH16 / SH20

Title: COASTAL DISCHARGES  
KEY PLAN



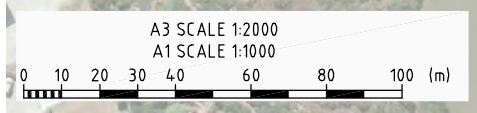
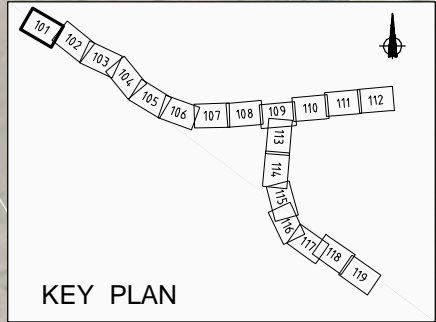

**FOR APPROVAL**  
**NOT FOR CONSTRUCTION**

Base Level:  
MSL AUCK. VERT. DATUM 1946  
Grid Reference:

MT EDEN 2000  
Originator No.  
Project No.  
20.11-3-D-N-943-101

No.	Revision	By	Chk	Appd	Date
B	ISSUED FOR STATUTORY APPROVAL	AG	COB	JH	02.08.10
A	ISSUED FOR SRT/NZTA REVIEW	AG	COB	JH	23.06.10

Drawing Originator:  
**aurecon**  
Aurecon New Zealand Limited  
139 Carlton Gore Road (PO Box 9762) Newmarket, Auckland New Zealand  
Telephone: +64 9 520-8019  
Facsimile: +61 9 524-7816  
Email: auckland@aurecongroup.com

Original Scale (A1)	1:1000	Designer	AG
Reduced Scale (A3)	1:2000	Reviewer	COB
		Drafting Checked	WC
		Consultant Approval	JH
		Received by Beca	---



Project: **WATERVIEW CONNECTION PROJECT**  
**SH16 / SH20**

Title: **COASTAL DISCHARGES SHEET 1**



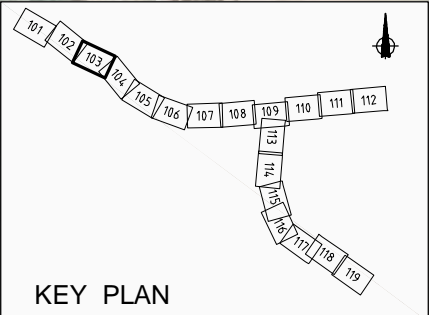

JOIN LINE SHEET 102  
ACCESSWAY

ROSEBANK PARK DOMAIN  
JOIN LINE SHEET 104

WHAU RIVER

SH16

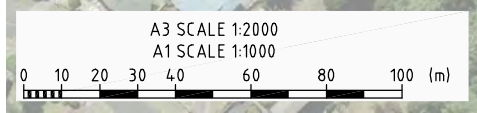

**FOR APPROVAL**  
**NOT FOR CONSTRUCTION**

Base Level:  
MSL AUCK. VERT. DATUM 1946  
Grid Reference:

MT EDEN 2000  
Originator No.  
Project No.  
20.11-3-D-N-943-103  
Rev.  
B

No.	Revision	By	Chk	Appd	Date
B	ISSUED FOR STATUTORY APPROVAL	AG	COB	JH	02.08.10
A	ISSUED FOR SRT/NZTA REVIEW	AG	COB	JH	23.06.10

Drawing Originator:  
**aurecon**  
Aurecon New Zealand Limited  
139 Carlton Gore Road (PO Box 9762) Newmarket  
Auckland New Zealand  
Telephone: +64 9 520-8019  
Facsimile: +61 9 524-7816  
Email: auckland@aurecongroup.com

Original Scale (A1)	1:1000	Designer	AG
Reduced Scale (A3)	1:2000	Reviewer	COB
		Drafting Checked	WC
		Consultant Approval	JH
		Received by Beca	--



Project: **WATERVIEW CONNECTION PROJECT**  
**SH16 / SH20**

Title: **COASTAL DISCHARGES SHEET 3**



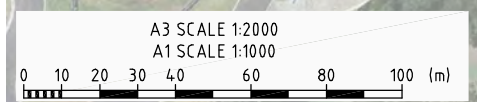
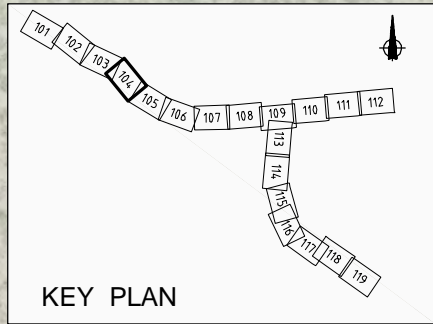

**FOR APPROVAL**  
**NOT FOR CONSTRUCTION**

Base Level:  
MSL AUCK. VERT. DATUM 1946  
Grid Reference:

MT EDEN 2000  
Originator No.  
Project No.  
20.111-3-D-N-943-104  
Rev.  
B

No.	Revision	By	Chk	Appd	Date
B	ISSUED FOR STATUTORY APPROVAL	AG	COB	JH	02.08.10
A	ISSUED FOR SRT/NZTA REVIEW	AG	COB	JH	23.06.10

Drawing Originator:  
**aurecon**  
Aurecon New Zealand Limited  
139 Carlton Gore Road (PO Box 9762) Newmarket, Auckland New Zealand  
Telephone: +64 9 520-8019  
Facsimile: +61 9 524-7816  
Email: auckland@aurecongroup.com

Original Scale (A1)	1:1000	Designer	AG
Reduced Scale (A3)	1:2000	Reviewer	COB
		Drafting Checked	WC
		Consultant Approval	JH
		Received by Beca	--



Project: **WATERVIEW CONNECTION PROJECT**  
**SH16 / SH20**

Title: **COASTAL DISCHARGES SHEET 4**



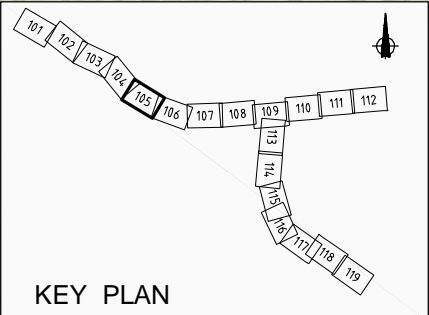

POLLEN ISLAND

SH16

ROSEBANK RD

LIMIT OF PROJECT

JOIN LINE SHEET 104

JOIN LINE SHEET 106



**FOR APPROVAL**  
**NOT FOR CONSTRUCTION**

Base Level:  
MSL AUCK. VERT. DATUM 1946

Grid Reference:  
MT EDEN 2000

Originator No.  
Project No.  
20.111-3-D-N-943-105

Rev.  
B

No.	Revision	By	Chk	Appd	Date
B	ISSUED FOR STATUTORY APPROVAL	AG	COB	JH	02.08.10
A	ISSUED FOR SRT/NZTA REVIEW	AG	COB	JH	23.06.10

Drawing Originator:  
  
 Aurecon New Zealand Limited  
 139 Carlton Gore Road (PO Box 9762) Newmarket, Auckland New Zealand  
 Telephone: +64 9 520-8018  
 Facsimile: +61 9 524-7816  
 Email: auckland@aurecongroup.com

Original Scale (A1)	1:1000	Designer	AG
Reduced Scale (A3)	1:2000	Reviewer	COB
		Drafting Checked	WC
		Consultant Approval	JH
		Received by	Beca

Project: **WATERVIEW CONNECTION PROJECT**  
SH16 / SH20

Title: **COASTAL DISCHARGES SHEET 5**



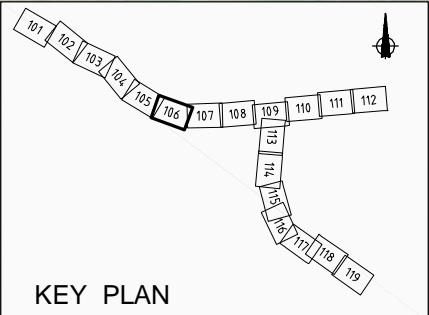

KEY PLAN

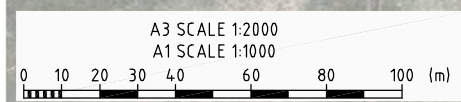

**FOR APPROVAL**  
**NOT FOR CONSTRUCTION**

Base Level:  
MSL AUCK. VERT. DATUM 1946  
Grid Reference:

**MT EDEN 2000**  
Originator No.  
Project No. 20.111-3-D-N-943-106  
Rev. B

No.	Revision	By	Chk	Appd	Date
B	ISSUED FOR STATUTORY APPROVAL	AG	COB	JH	02.08.10
A	ISSUED FOR SRT/NZTA REVIEW	AG	COB	JH	23.06.10

Drawing Originator:  
**aurecon**  
Aurecon New Zealand Limited  
139 Carlton Gore Road (PO Box 9762) Newmarket, Auckland New Zealand  
Telephone: +64 9 520-8019  
Facsimile: +61 9 524-7816  
Email: auckland@aurecongroup.com

Original Scale (A1)	1:1000	Designer	AG
Reduced Scale (A3)	1:2000	Reviewer	COB
		Drafting Checked	WC
		Consultant Approval	JH
		Received by Beca	--

**NZ TRANSPORT AGENCY**  
WAKA KOTAHI

Project: **WATERVIEW CONNECTION PROJECT**  
**SH16 / SH20**

Title: **COASTAL DISCHARGES SHEET 6**



XR 08 - - 09 - - - -

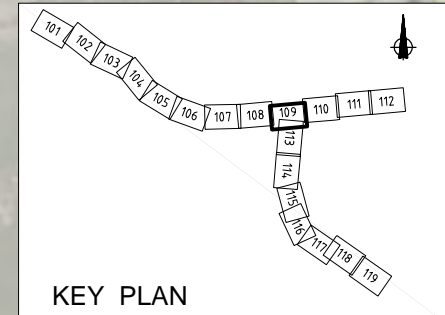

**NOTES:**  
 1. FOR DETAILS OF STORMWATER, STREAMWORK DESIGN AND CATCHMENT AREAS FOR EACH OUTFALL STRUCTURE, REFER DWGS: 20.1.11-3-D-D-30-100 TO 20.1.11-3-D-D-30-119.

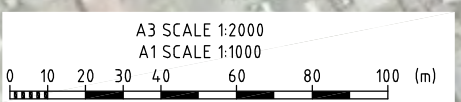

**FOR APPROVAL  
 NOT FOR CONSENT**

Base level:  
 MSL AUCK. VERT. DATUM 1946  
 Grid Reference:

MT EDEN 2000  
 Originator No.  
 Project No. 20.1.11-3-D-N-943-109  
 Rev. B

No.	Revision	By	Chk	Appd	Date
B	ISSUE FOR STATUTORY APPROVAL	BNRB			22.07.10
A	ISSUE FOR SRT/NZTA REVIEW	BNRB			03.06.10

Drawing Originator:

**Tonkin & Taylor**  
 Environmental and Engineering Consultants

Original Scale (A1)	1:1000	Design Engineer	TF
Reduced Scale (A3)	1:2000	Review Engineer	BM
		Drafting Checked	-
		Consultant Approval	AL
		Received by Beca	

**NZ TRANSPORT AGENCY**  
 WAKA KOTAHI

Project: **WATERVIEW CONNECTION PROJECT**  
 SH16 / SH20

Title: **COASTAL DISCHARGES SHEET 9**



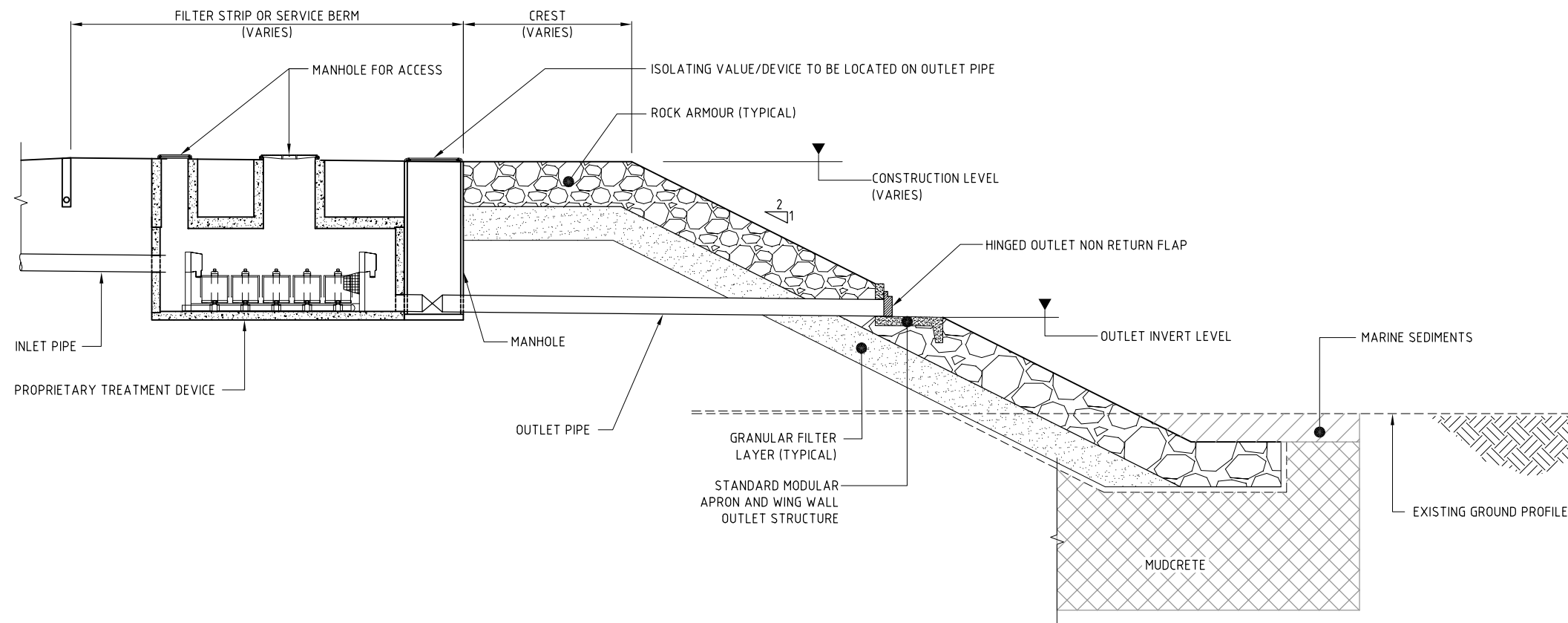

TYPICAL STORMWATER DRAINAGE DETAILS FOR SUPERELEVATED CARRIAGEWAYS

SCALE: 1:50 @ A1  
SCALE: 1:100 @ A3

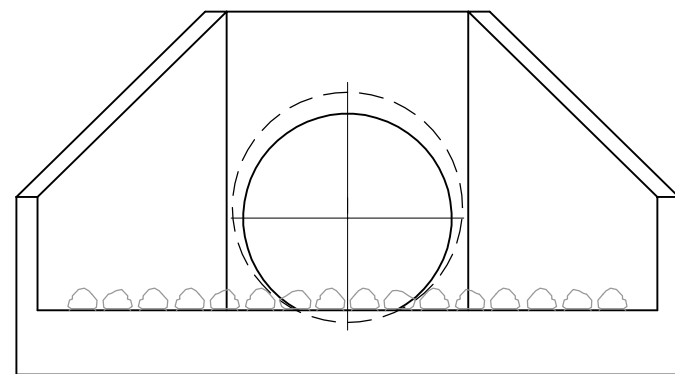

FRONT ELEVATION OF INLET/OUTLET TO POND

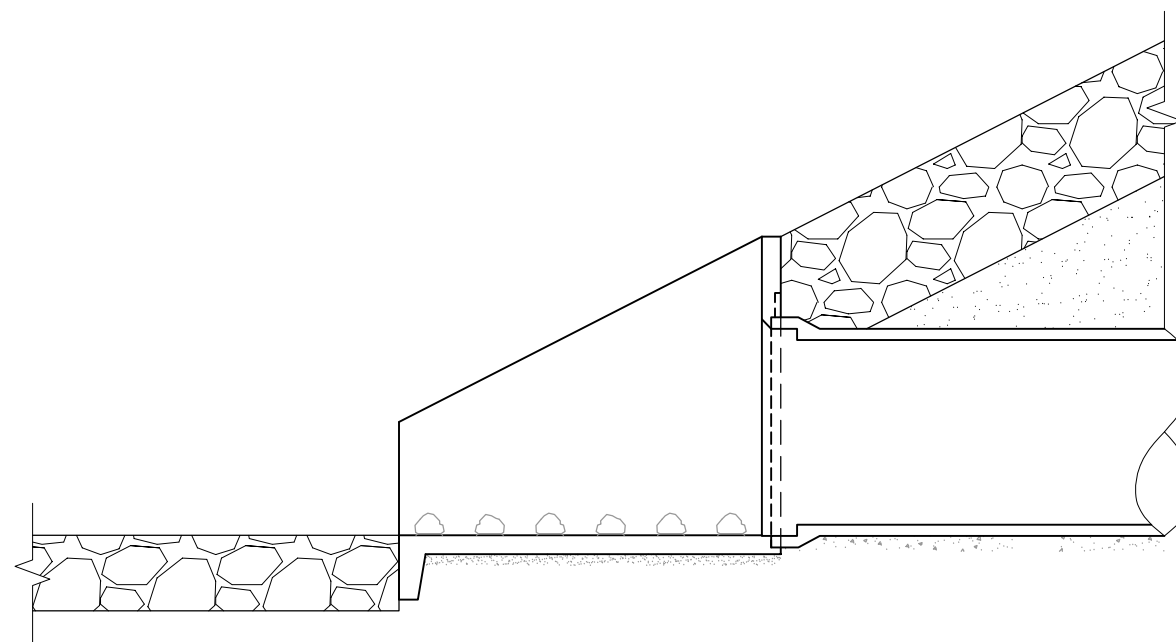

TYPICAL SECTION: INLET/OUTLET TO PONDS

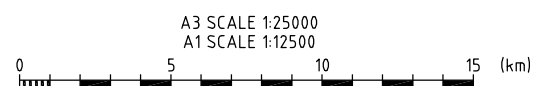

No.	Revision	By	Chk	Appd	Date
A	ISSUE FOR STATUTORY APPROVAL	ME			04.08.10

Drawing Originator:

Original Scale (A1)	Design Engineer	TF
1:50	Review Engineer	BM
Reduced Scale (A3)	Drafting Checked	
1:100	Consultant Approval	AL
	Received by Beca	

NZ TRANSPORT AGENCY  
WAKA KOTAHU

Project: WATERVIEW CONNECTION PROJECT  
SH16 / SH20

Title: COASTAL DISCHARGES  
OUTFALL STRUCTURES  
TYPICAL DETAILS

**FOR APPROVAL**  
**NOT FOR CONSTRUCTION**

Base Level: MSL AUCK. VERT. DATUM 1946  
Grid Reference: MT EDEN 2000

Originator No. \_\_\_\_\_  
Project No. 20.1111-3-D-N-943-301  
Rev. A