

LEGEND

- EXISTING CMA BOUNDARY
- PROPOSED CMA BOUNDARY
- PERMANENT OCCUPATION IN CMA
- PERMANENT OCCUPATION OVER CMA
- EXISTING PILE
- ▲ PROPOSED 0.5m PILE
- PROPOSED 1.0m PILE
- × PROPOSED 1.5m PILE
- PROPOSED 2.1m PILE

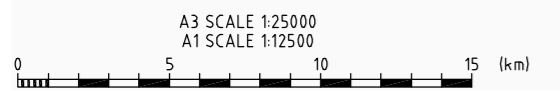

FOR APPROVAL
NOT FOR CONSTRUCTION

Base Level:		MSL AUCK.VERT.DATUM 1946	
Grid Reference:		Mt Eden 2000	
Originator No.			
Project No.	20.111-3-D-N-941-100	Rev.	B

No.	Revision	By	Chk	Appd	Date
B	ISSUED FOR STATUTORY APPROVAL	AH	COB	JH	02.08.10
A	ISSUED FOR SRT/NZTA REVIEW	AH	COB	JH	23.06.10

Drawing Originator:

aurecon

Aurecon New Zealand Limited
139 Carlton Gore Road (PO Box 9762) Newmarket Auckland New Zealand
Telephone: +64 9 520-8019
Facsimile: +61 9 524-7816
Email: auckland@aurecongroup.com

Original Scale (A1)	1:1000	Design Engineer	AH
Reduced Scale (A3)	1:2000	Review Engineer	JH
		Drafting Checked	WC
		Consultant Approval	COB
		Reviewed by	Beca

NZ TRANSPORT AGENCY
WAKA KOTAHĪ

Project: **WATERVIEW CONNECTION PROJECT**
SH16 / SH20

Title: **CMA PERMANENT OCCUPATION KEYPLAN**

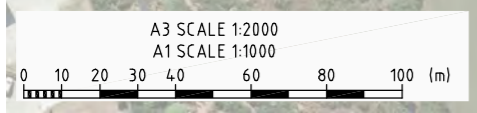
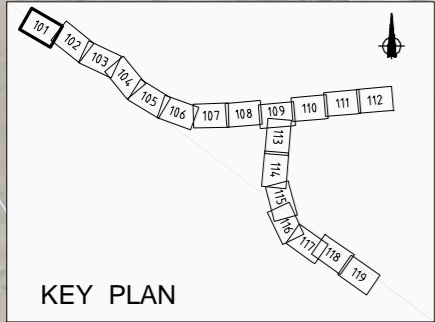

FOR APPROVAL
NOT FOR CONSTRUCTION

Base Level:
MSL AUCK. VERT. DATUM 1946
Grid Reference:

Mt Eden 2000
Originator No.
Project No. **20.111-3-D-N-94-101** Rev. **B**

No.	Revision	By	Chk	Appd	Date
B	ISSUED FOR STATUTORY APPROVAL	AG	COB	JH	02.08.10
A	ISSUED FOR SRT/NZTA REVIEW	AG	COB	JH	23.06.10

Drawing Originator:
aurecon
Aurecon New Zealand Limited
138 Clarkson Drive Road (PO Box 6762) Newmarket, Auckland New Zealand
Telephone: +64 9 520-5010
Facsimile: +61 6 524-7916
Email: auckland@aurecongroup.com

Original Scale (A1)	1:1000	Designer	AG
Reduced Scale (A3)	1:2000	Reviewer	COB
		Drafting Checked	WC
		Consultant Approval	JH
		Received by	Beca



Project: **WATERVIEW CONNECTION PROJECT**
SH16 / SH20

Title: **CMA PERMANENT OCCUPATION SHEET 1**

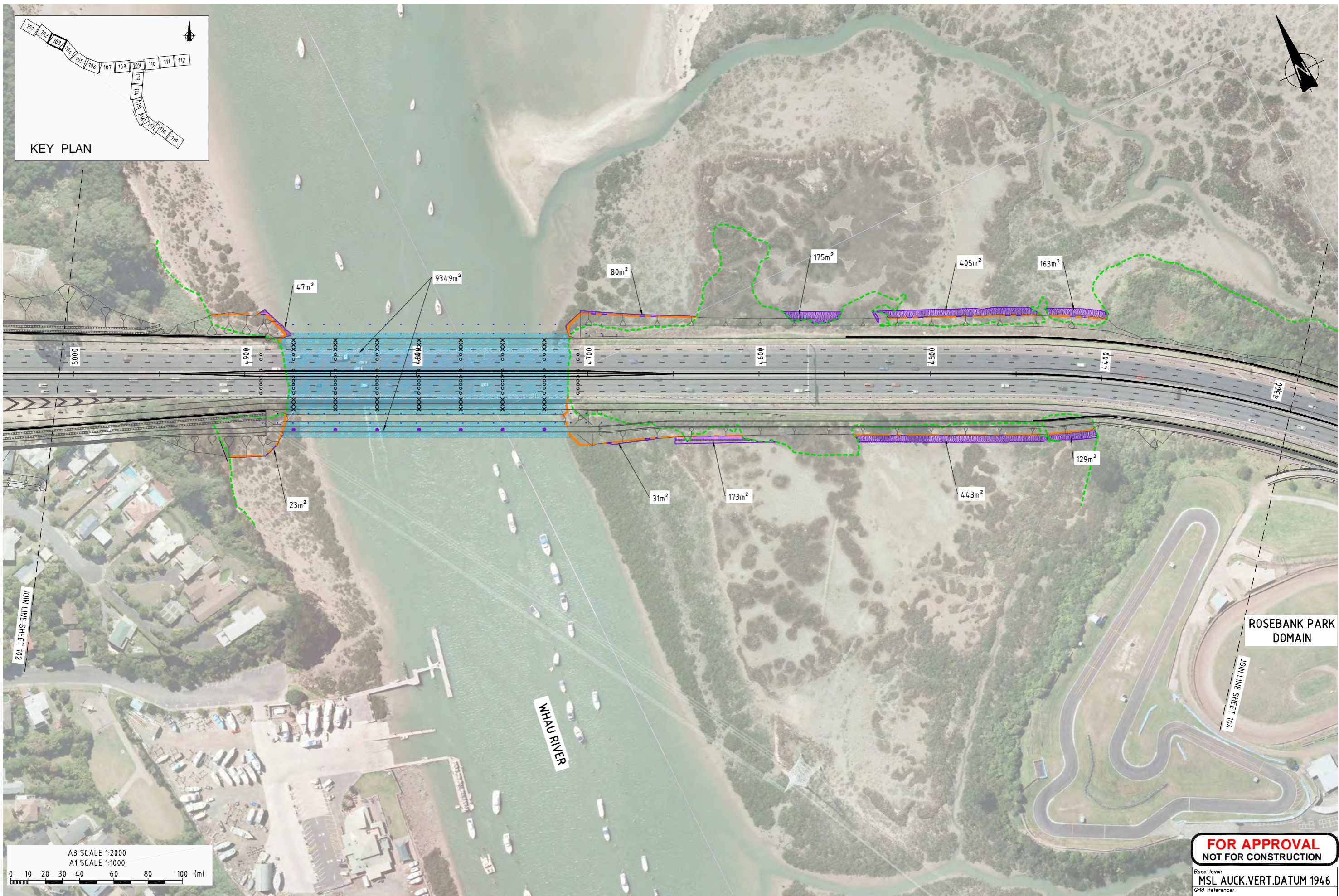

No.	Revision	By	Chk	Appd	Date
B	ISSUED FOR STATUTORY APPROVAL	AG	COB	JH	02.08.10
A	ISSUED FOR SRT/NZTA REVIEW	AG	COB	JH	23.06.10

Drawing Originator:
aurecon
 Aurecon New Zealand Limited
 139 Carlton Gore Road (PO Box 9762) Newmarket, Auckland, New Zealand
 Telephone: +64 9 520-8018
 Facsimile: +61 9 524-7816
 Email: auckland@aurecongroup.com

Original Scale (A1)	1:1000	Designer	AG
Reduced Scale (A3)	1:2000	Reviewer	COB
		Drafting Checked	WC
		Consultant Approval	JH
		Received by	Beca



Project: **WATERVIEW CONNECTION PROJECT**
 SH16 / SH20

Title: **CMA PERMANENT OCCUPATION SHEET 3**

FOR APPROVAL
NOT FOR CONSTRUCTION

Base Level: **MSL AUCK. VERT. DATUM 1946**
 Grid Reference: **Mt Eden 2000**

Originator No. _____
 Project No. **20.111-3-D-N-941-103** Rev. **B**

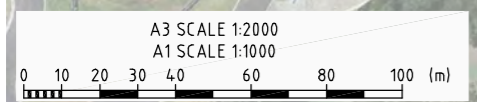
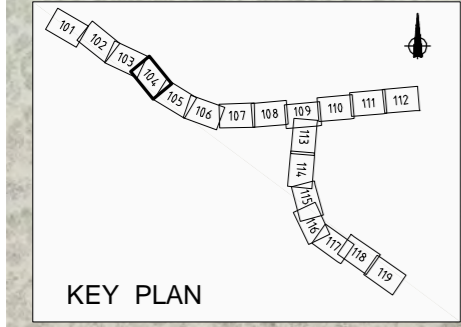

FOR APPROVAL
NOT FOR CONSTRUCTION

Base Level:
MSL AUCK.VERT.DATUM 1946
Grid Reference:

Mt Eden 2000
Originator No.
Project No.
20.111-3-D-N-941-104 Rev. B

No.	Revision	By	Chk	Appd	Date
B	ISSUED FOR STATUTORY APPROVAL	AG	COB	JH	02.08.10
A	ISSUED FOR SRT/NZTA REVIEW	AG	COB	JH	23.06.10

Drawing Originator:
aurecon
Aurecon New Zealand Limited
139 Carlton Gore Road (PO Box 9762) Newmarket, Auckland, New Zealand
Telephone: +64 9 520-8019
Facsimile: +61 9 524-7816
Email: auckland@aurecongroup.com

Original Scale (A1)	1:1000	Designer	AG
Reduced Scale (A3)	1:2000	Reviewer	COB
		Drafting Checked	WC
		Consultant Approval	JH
		Received by	Beca



Project: **WATERVIEW CONNECTION PROJECT**
SH16 / SH20

Title: **CMA PERMANENT OCCUPATION SHEET 4**

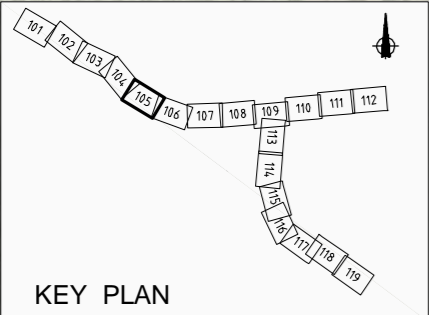

KEY PLAN

REFER TO NEXT DRAWING (106) FOR AREA

REFER TO NEXT DRAWING (106) FOR AREA

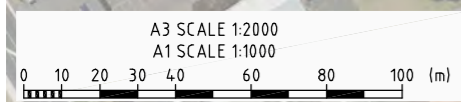

**FOR APPROVAL
NOT FOR CONSTRUCTION**

Base Level:
MSL AUCK.VERT.DATUM 1946
Grid Reference:

Mt Eden 2000
Originator No.
Project No.
20.111-3-D-N-941-105 Rev. B

No.	Revision	By	Chk	Appd	Date
B	ISSUED FOR STATUTORY APPROVAL	AG	COB	JH	02.08.10
A	ISSUED FOR SRT/NZTA REVIEW	AG	COB	JH	23.06.10

Drawing Originator:
aurecon
Aurecon New Zealand Limited
139 Carlton Gore Road (PO Box 9762) Newmarket, Auckland New Zealand
Telephone: +64 9 520-8019
Facsimile: +61 9 524-7816
Email: auckland@aurecongroup.com

Original Scale (A1)	1:1000	Designer	AG
Reduced Scale (A3)	1:2000	Reviewer	COB
		Drafting Checked	WC
		Consultant Approval	JH
		Received by	Beca



Project: **WATERVIEW CONNECTION PROJECT
SH16 / SH20**

Title: **CMA PERMANENT OCCUPATION SHEET 5**

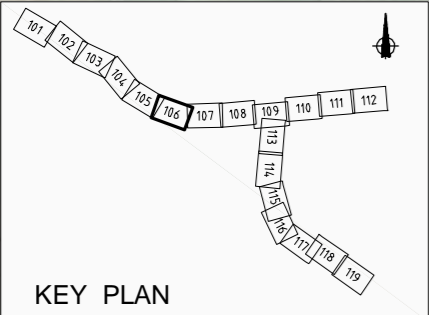

KEY PLAN

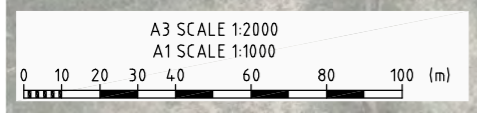

**FOR APPROVAL
NOT FOR CONSTRUCTION**

Base Level:
MSL AUCK.VERT.DATUM 1946
Grid Reference:

Mt Eden 2000
Originator No.
Project No. **20.111-3-D-N-941-106** Rev. **B**

No.	Revision	By	Chk	Appd	Date
B	ISSUED FOR STATUTORY APPROVAL	AG	COB	JH	02.08.10
A	ISSUED FOR SRT/NZTA REVIEW	AG	COB	JH	23.06.10

Drawing Originator:
aurecon
Aurecon New Zealand Limited
139 Carlton Gore Road (PO Box 9762) Newmarket, Auckland New Zealand
Telephone: +64 9 520-8019
Facsimile: +61 9 524-7816
Email: auckland@aurecongroup.com

Original Scale (A1)	1:1000	Designer	AG
Reduced Scale (A3)	1:2000	Reviewer	COB
		Drafting Checked	WC
		Consultant Approval	JH
		Received by	Beca



Project: **WATERVIEW CONNECTION PROJECT SH16 / SH20**

Title: **CMA PERMANENT OCCUPATION SHEET 6**

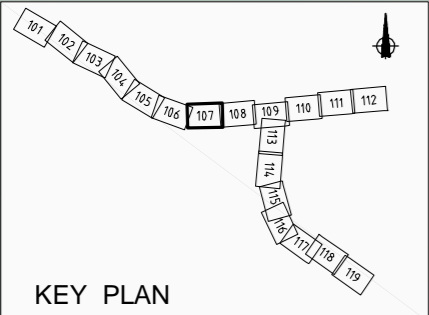

WAITEMATA HARBOUR

WATERVIEW ESTUARY

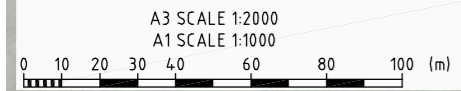

No.	Revision	By	Chk	Appd	Date
B	ISSUED FOR STATUTORY APPROVAL	AG	COB	JH	02.08.10
A	ISSUED FOR SRT/NZTA REVIEW	AG	COB	JH	23.06.10

Drawing Originator:
aurecon
 Aurecon New Zealand Limited
 139 Carlton Gore Road (PO Box 9762) Newmarket, Auckland New Zealand
 Telephone: +64 9 520-8019
 Facsimile: +61 9 524-7816
 Email: auckland@aurecongroup.com

Original Scale (A1)	1:1000	Designer	AG
Reduced Scale (A3)	1:2000	Reviewer	COB
		Drafting Checked	WC
		Consultant Approval	JH
		Received by	Beca



Project: **WATERVIEW CONNECTION PROJECT**
 SH16 / SH20

Title: **CMA PERMANENT OCCUPATION SHEET 7**

FOR APPROVAL
NOT FOR CONSTRUCTION

Base Level:
MSL AUCK.VERT.DATUM 1946
 Grid Reference:
Mt Eden 2000

Originator No. _____

Project No. **20.111-3-D-N-941-107** Rev. **B**

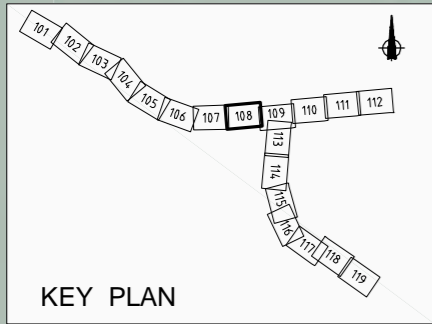

WAITEMATA HARBOUR

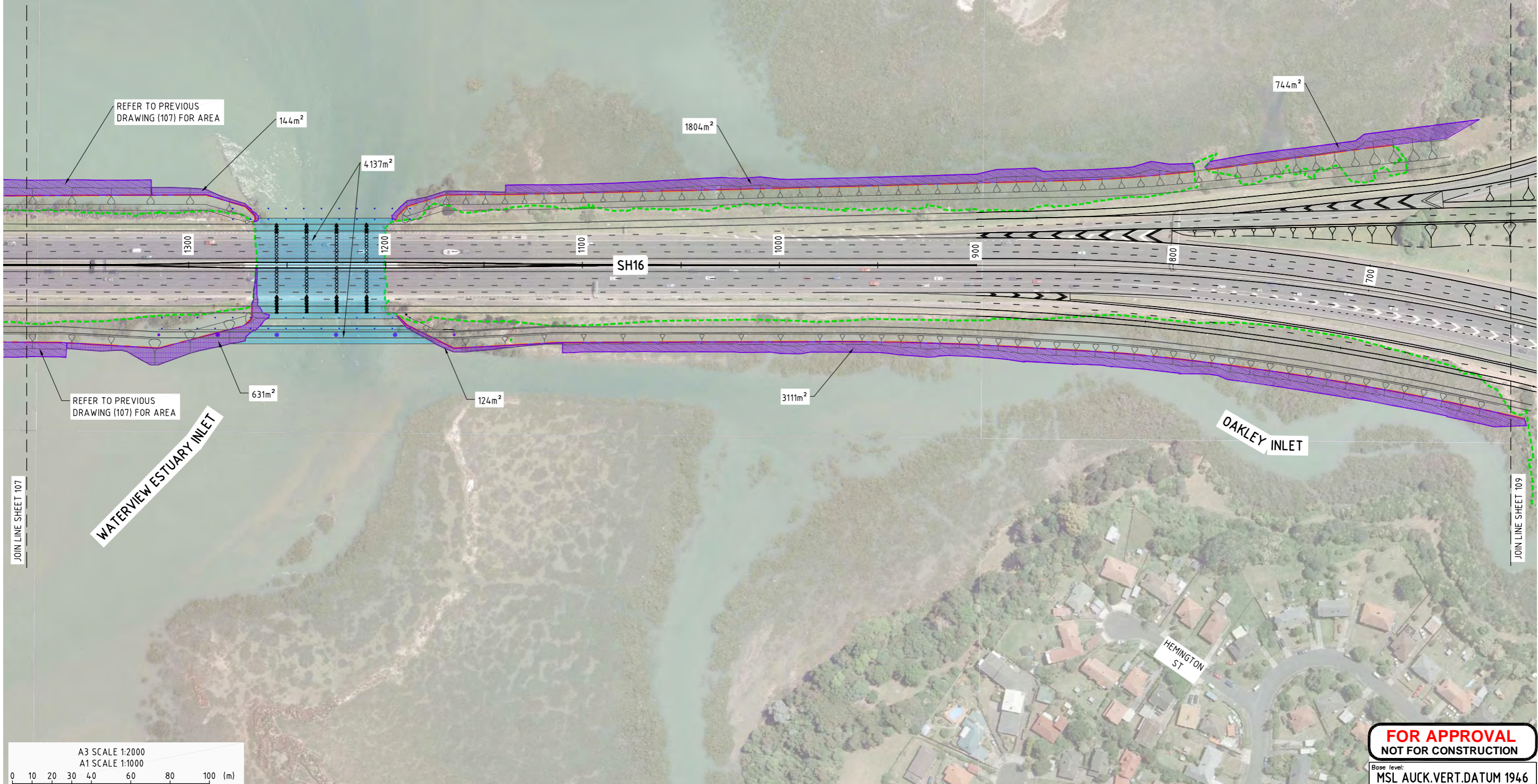

JOIN LINE SHEET 107

JOIN LINE SHEET 109

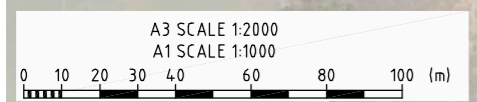

FOR APPROVAL
NOT FOR CONSTRUCTION

Base Level:
MSL AUCK. VERT. DATUM 1946

Grid Reference:
Mt Eden 2000

Originator No.

Project No.
20.111-3-D-N-941-108

Rev.
B

No.	Revision	By	Chk	Appd	Date
B	ISSUED FOR STATUTORY APPROVAL	AG	COB	JH	02.08.10
A	ISSUED FOR SRT/NZTA REVIEW	AG	COB	JH	23.06.10

Drawing Originator:
aurecon
Aurecon New Zealand Limited
139 Carlton Gore Road (PO Box 9762) Newmarket Auckland New Zealand
Telephone: +64 9 520-8019
Facsimile: +61 9 524-7816
Email: auckland@aurecongroup.com

Original Scale (A1)	1:1000	Designer	AG
Reduced Scale (A3)	1:2000	Reviewer	COB
		Drafting Checked	WC
		Consultant Approval	JH
		Received by	Beca



Project:
WATERVIEW CONNECTION PROJECT
SH16 / SH20

Title:
CMA PERMANENT OCCUPATION SHEET 8

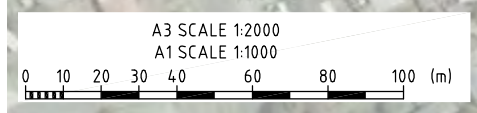
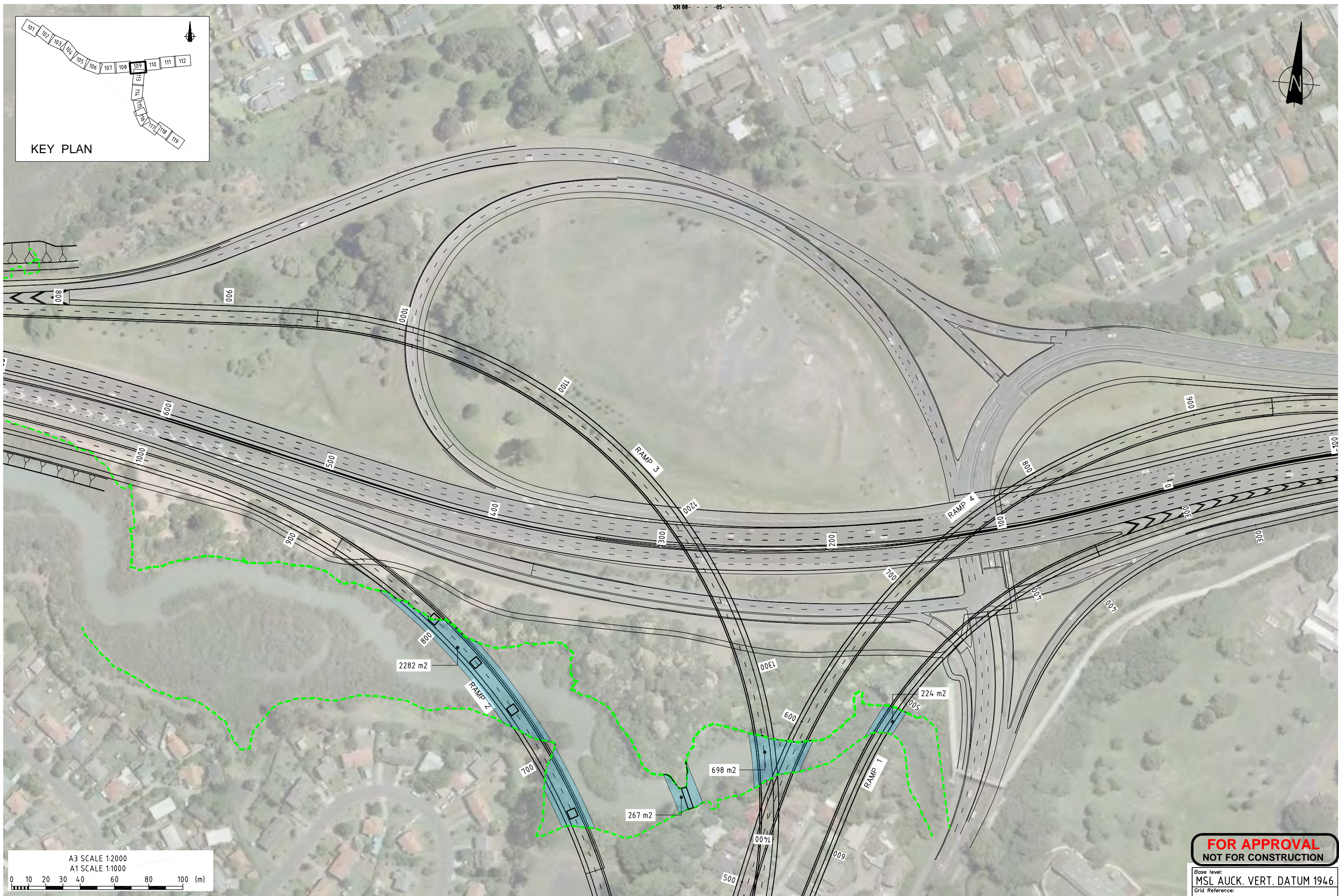
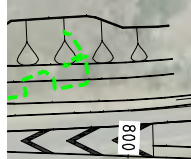
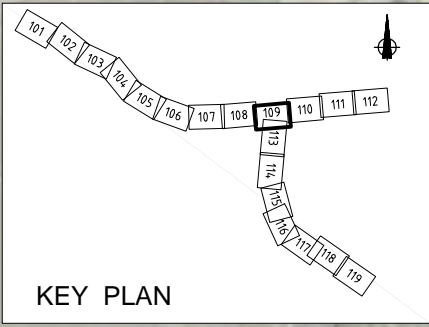

FOR APPROVAL
NOT FOR CONSTRUCTION

Base Level:
MSL AUCK. VERT. DATUM 1946
Grid Reference:

MT EDEN 2000

Originator No.
Project No.
20.111-3-D-N-941-109

Rev.
B

No.	Revision	By	Chk	Appd	Date
B	ISSUE FOR STATUTORY APPROVAL	BNRB			22.07.10
A	ISSUE FOR SRT/NZTA REVIEW	BNRB			06.06.10

Drawing Originator:

Original Scale (A1)	1:1000	Design Engineer	TF
Reduced Scale (A3)	1:2000	Review Engineer	BM
		Drafting Checked	-
		Consultant Approval	AL
		Received by Beca	

NZ TRANSPORT AGENCY
WAKA KOTAHI

Project: WATERVIEW CONNECTION
PROJECT
SH16 / SH20

Title: PERMANENT OCCUPATION FOR CMA
SHEET 9