

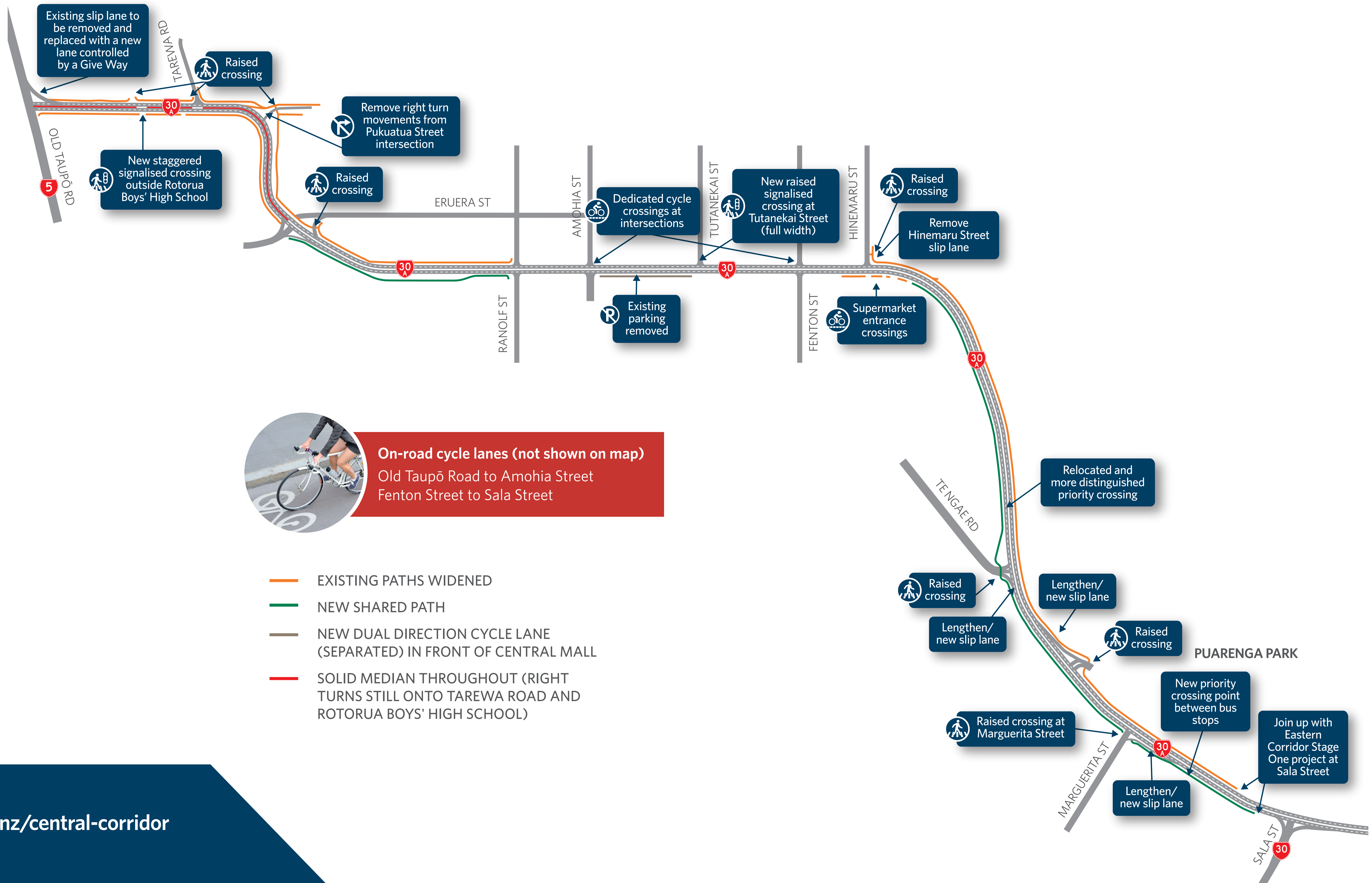

# SH30A CENTRAL CORRIDOR

## Confirmed design



### On-road cycle lanes (not shown on map)

Old Taupō Road to Amohia Street  
Fenton Street to Sala Street

- EXISTING PATHS WIDENED
- NEW SHARED PATH
- NEW DUAL DIRECTION CYCLE LANE (SEPARATED) IN FRONT OF CENTRAL MALL
- SOLID MEDIAN THROUGHOUT (RIGHT TURNS STILL ONTO TAREWA ROAD AND ROTORUA BOYS' HIGH SCHOOL)

[nzta.govt.nz/central-corridor](http://nzta.govt.nz/central-corridor)