

300 mm
200
100
50
10 mm
0

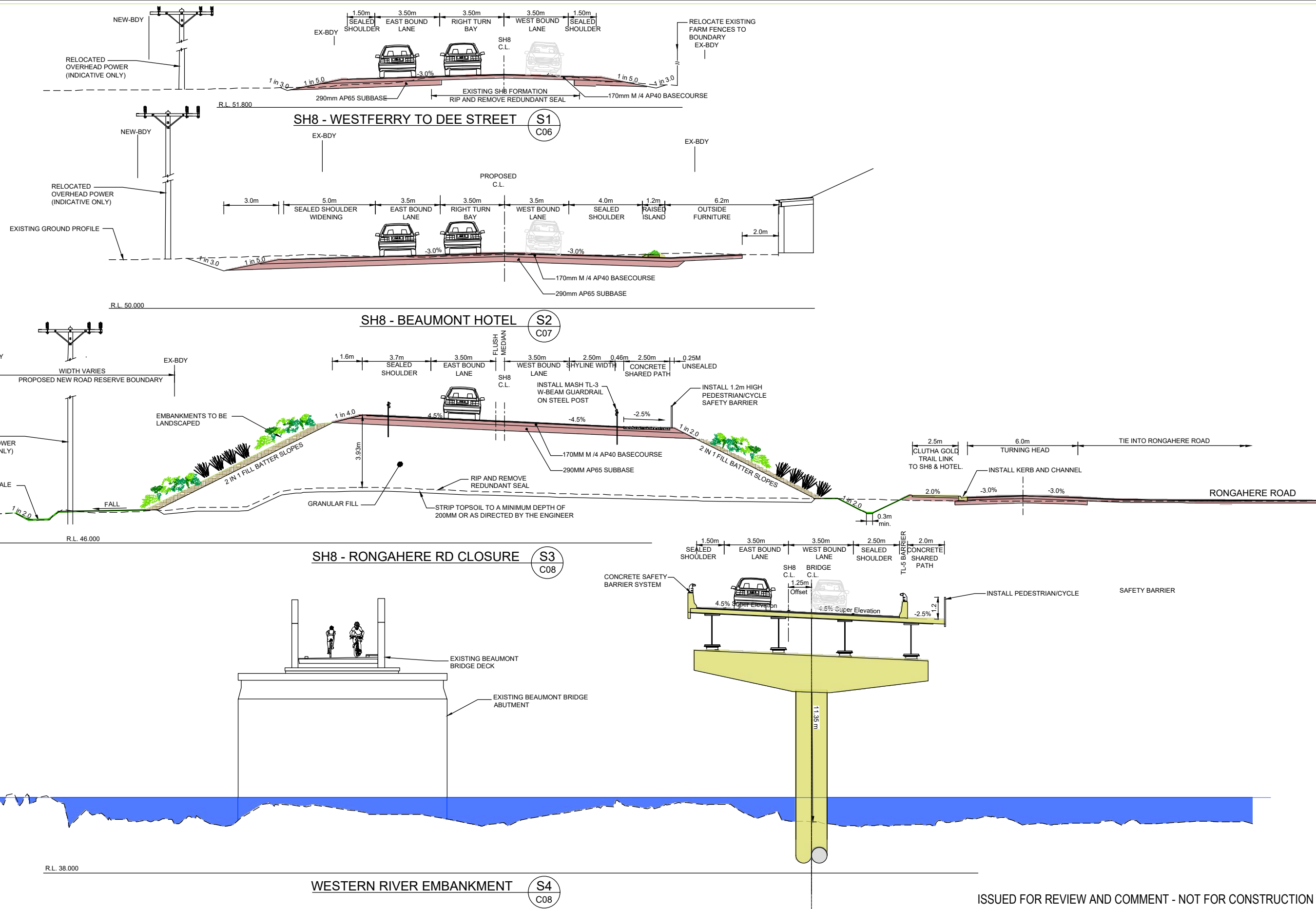

ISSUED FOR REVIEW AND COMMENT - NOT FOR CONSTRUCTION

Revision	Amendment	Approved	Revision Date
A	ISSUED FOR REVIEW AND COMMENT	M.D	03/04/2020



		Dunedin Office Private Bag 1913 Dunedin 9016 New Zealand	
Approved B MULHOLLAND	Approved M DAVIES	Approved Date 03/04/2020	Approved Date 03/04/2020
Drawn B MULHOLLAND	Scales A1 1:100 A3 1:200	Project No. 6-CT012.0	

Project WAKA KOTAHI NZ TRANSPORT AGENCY SH8 BEAUMONT OTAGO RS 401 / 6300 NEW BEAUMONT BRIDGE	
Sheet TYPICAL CROSS SECTIONS S1 TO S4	
Sheet No. C18	Revision A

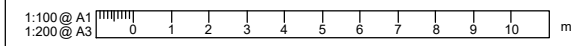

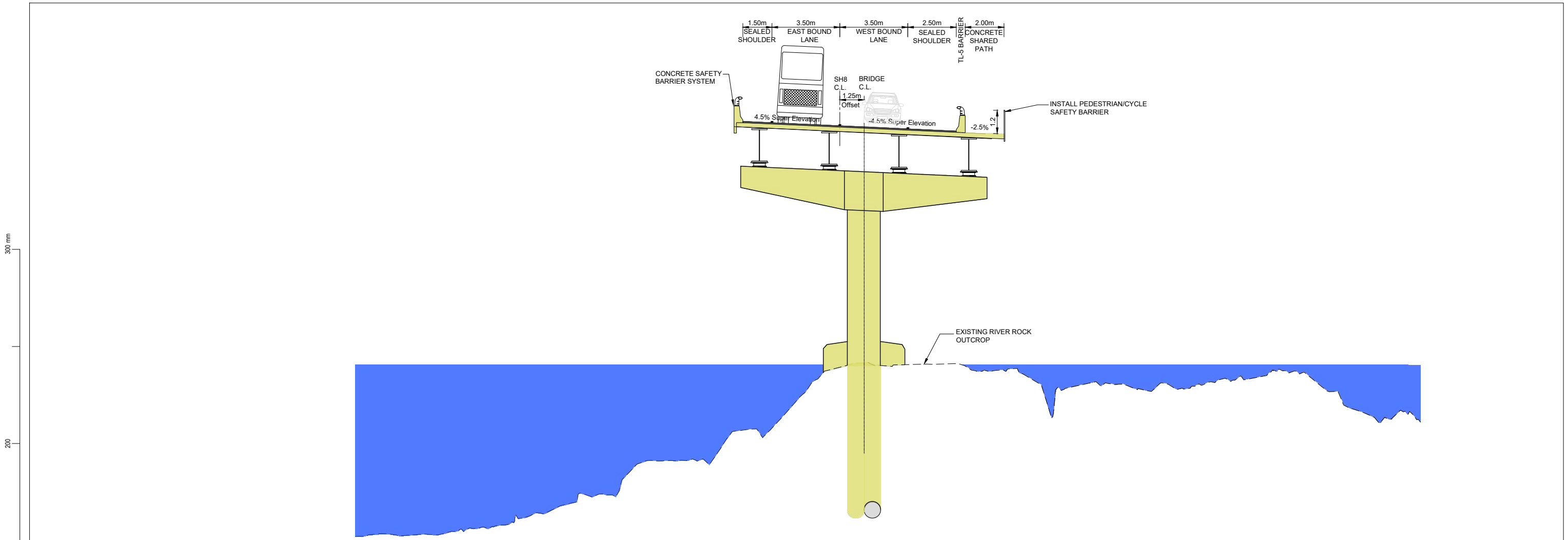

CLUTHA RIVER ROCK OUTCROP PIER LOCATION (S5 C02)

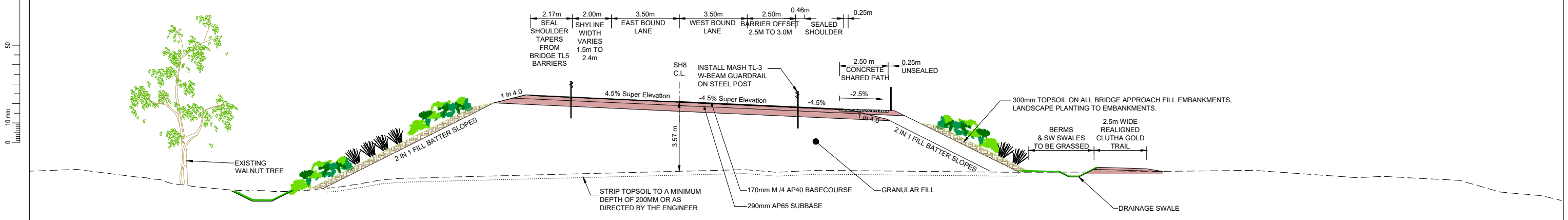

SH8 - BETWEEN EASTERN ABUTMENT AND CRAIG FLAT ROAD (S6 C10)

ISSUED FOR REVIEW AND COMMENT - NOT FOR CONSTRUCTION

Revision	Amendment	Approved	Revision Date
A	ISSUED FOR REVIEW AND COMMENT	M.D	03/04/2020



		Project WAKA KOTAHİ NZ TRANSPORT AGENCY SH8 BEAUMONT OTAGO RS 401 / 6300 NEW BEAUMONT BRIDGE	
Dunedin Office +64 3 471 5500		Private Bag 1913 Dunedin 9016 New Zealand	
Drawn B MULHOLLAND	Scales A1 1:100 A3 1:200	Approved M DAVIES 03/04/2020	Sheet TYPICAL CROSS SECTIONS S5 TO S6
Project No. 6-CT012.0		Sheet No. C19	Revision A

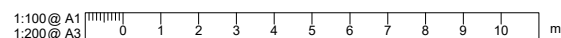

300 mm
200
100
50
10 mm
0

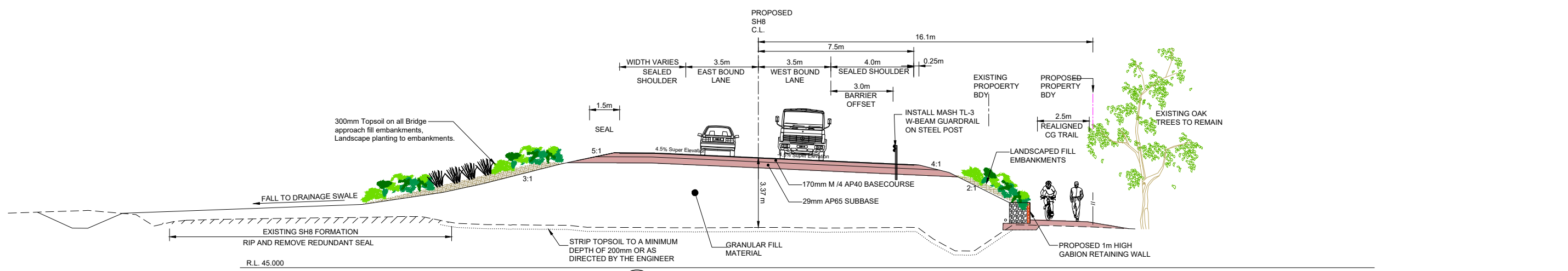

SH8 - CRAIG FLAT RD TO WEARDALE ST (S7 C10)

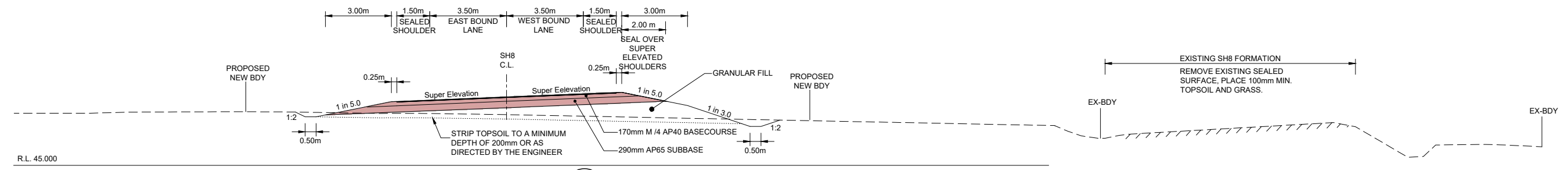

SH8 - WEARDALE ST TO STONEWELL ST (S8 C11)

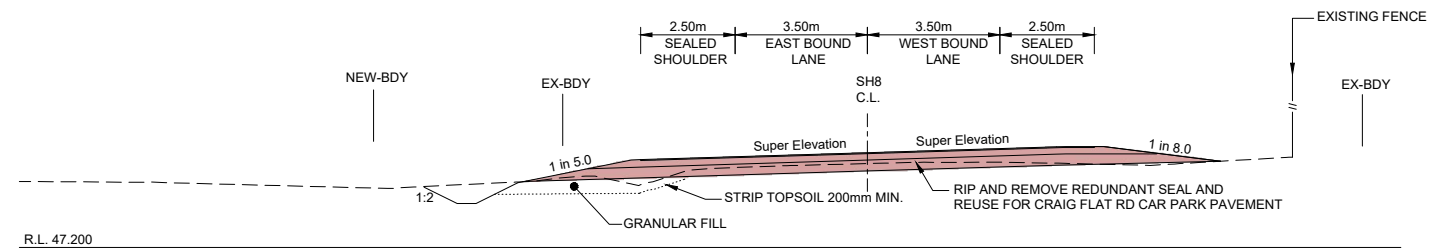

SH8 - STONEWELL ST TO LOWBURN BRIDGE (S9 C13)

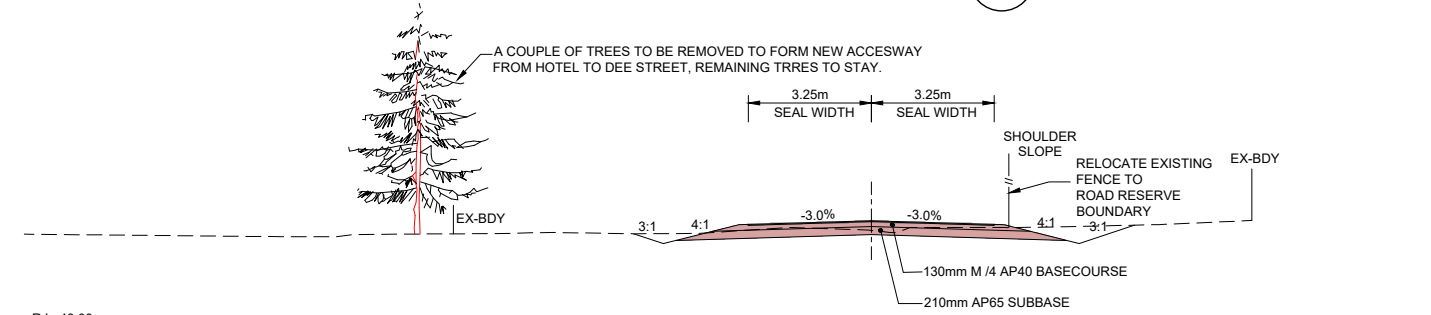

LOCAL ROAD - DEE STREET (S10 C06)

ISSUED FOR REVIEW AND COMMENT - NOT FOR CONSTRUCTION

Revision	Amendment	Approved	Revision Date
A	ISSUED FOR REVIEW AND COMMENT	M.D	03/04/2020



 Dunedin Office +64 3 471 5500		Private Bag 1913 Dunedin 9016 New Zealand	
Approved B MULHOLLAND	Approved M DAVIES	Approved Date 03/04/2020	Project WAKA KOTAHI NZ TRANSPORT AGENCY SH8 BEAUMONT OTAGO RS 401 / 6300 NEW BEAUMONT BRIDGE
Scales B MULHOLLAND	Scales A1 1:100 A3 1:200	Project No. 6-CT012.0	Sheet No. C20
		Revision A	

Project WAKA KOTAHI NZ TRANSPORT AGENCY SH8 BEAUMONT OTAGO RS 401 / 6300 NEW BEAUMONT BRIDGE	
Sheet TYPICAL CROSS SECTIONS S7 TO S10	
Project No. 6-CT012.0	Sheet No. C20
Revision A	

