

CAUSEWAY ALLIANCE
working for our **thriving** city

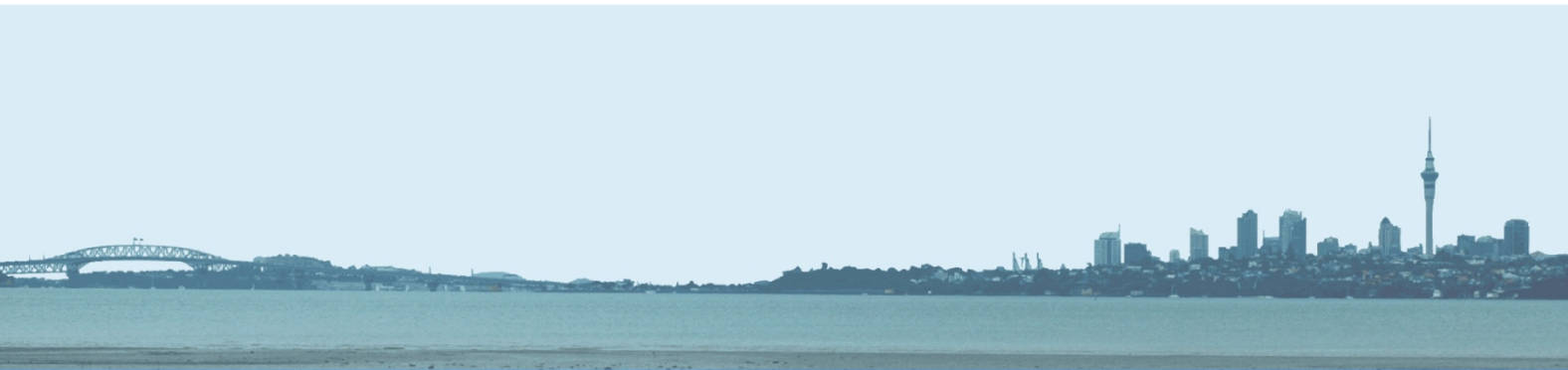

SH16 CAUSEWAY UPGRADE PROJECT



Monthly Environmental Report
February 2014

Document history and status

Revision	Date issued	Written By	Reviewed by	Approved by	Revision Status
A	27.02.2014	K Stevens	R Purdy/Brigitte Dunbar/ Elizabeth Collins		For REVIEW
B	21.03.14	K Stevens	M Evans		For APPROVAL
C	21.03.14	K Stevens		M Evans	FINAL

Distribution of copies

Revision	Purpose	Issued to
A	For review	R Purdy, B Dunbar, E Collins
B	For approval/release	M Evans
C	FINAL	Auckland Council

Printed:	21/03/2014 15:39
Last saved:	21/03/2014 15:39
File name:	K:\EN Environment\EN51 Construction\04 Council Reporting\Monthly Report\2014 Environmental Reports\2014 02 Report\Feb_2014_Causeway_Upgrade_Project_Monthly_Environmental_Report_Rev C.docx
Author:	Kevin Stevens
Environmental Manager:	Steve Jenkins
Name of organisation:	Causeway Alliance
Name of project:	SH16 Causeway Upgrade Project
Document version:	Revision C

Contents

1.0	INTRODUCTION	7
1.1	PURPOSE OF THE REPORT	7
2.0	OVERVIEW of ACTIVITIES UNDERTAKEN	7
2.1	Environmental	7
2.2	Communications and Stakeholder Management	7
2.3	Construction	7
3.0	MEETINGS, INSPECTIONS AND EVENTS	8
4.0	ENVIRONMENTAL MONITORING	8
4.1	EARTHWORKS COMPLIANCE	8
4.2	CONSTRUCTION NOISE AND VIBRATION	8
4.3	AIR QUALITY	8
4.4	CONTAMINATED SOIL	9
4.5	EROSION AND SEDIMENT CONTROL	9
4.6	ARCHAEOLOGICAL	9
4.7	COASTAL MONITORING	9
4.8	MARINE MONITORING	9
4.9	ECOLOGICAL	9
5.0	CORRESPONDENCE ON CONSENT CONDITIONS AND PLANS	9
6.0	WORKS PROPOSED FOR MARCH, APRIL AND MAY 2014	10

Appendix A: Causeway Alliance Construction Zone Plan

Appendix B: SH16 Causeway Imported and Exported Material Summary

-

1.0 INTRODUCTION

1.1 PURPOSE OF THE REPORT

To provide Auckland Council with a monthly overview of construction progress and compliance activity on the SH16 Causeway Upgrade project.

This report describes and details activities during the month of February 2014.

2.0 OVERVIEW of ACTIVITIES UNDERTAKEN

2.1 Environmental

Regular contact is continuing with the Auckland Council compliance team.

2.2 Communications and Stakeholder Management

- Produced fortnightly Causeway News project updates to stakeholders, project neighbours and wider community.
- Project updates were written for a variety of local community publications and distributed to stakeholders in the Rosebank business community
- Cycle Action Auckland as a key stakeholder group have been kept informed of cycleway diversions and changes and have expressed their appreciation.
- Positive community feedback has been received since the implementation of the orange temporary lane marking on State Highway 16 eastbound in the Great North Road interchange area.
- One neighbour in Alwyn Ave, Te Atatu South provided feedback about noise relating to crane movements in his neighbourhood. The project team has taken additional steps to ensure full noise mitigation from similar operations in the future.

2.3 Construction

- Alwyn Ave (Whau River bridge south-west) - ground improvements continued in the marine area at the bridge (soft material excavated and replaced), preparing access for constructing temporary staging for widening the southern side of the Whau River Bridge. Install rock revetment under Whau Bridge (western end).
- Whau River Bridge (north-west) – Installation of permanent bridge piling/crossheads for eastbound bridge widening continuing.
- Whau River Bridge (north-east) - permanent bridge piling/crossheads continuing.

- Patiki to Whau (westbound, around Rosebank Park Domain) – north-western cycleway relocated, and Construction Yard 2 in Rosebank Park Domain was established. Site clearance continuing in Rosebank Domain, reclamation work began in marine area.
- Whau to Rosebank (eastbound) – site clearing complete, reclamation work underway (under Patiki Road off ramp), retaining wall works continuing (including rock revetment)
- Causeway (from North Traherne Island eastbound direction) – continue installation of the preload fill layer (surcharge) up to full height opposite Traherne Island, further east continue coffer dam/stability berm, working platform, wick drain and drainage blanket installation.
- Causeway (South Traherne Island) – earthworks, wick drain and drainage layer installation (towards Rosebank Road off-ramp) continuing.
- Great North Road Interchange (GNRI) (northern side, eastbound from Causeway Bridge) – stability berm slump area being stabilised with timber piles. Filling further east of Causeway Bridge continuing.
- GNRI (southern side, westbound towards Causeway Bridge) – continue earthworks for raising the area, laying pavement layers, lighting poles and preparing to move onramp across in March. Embankment slump occurred into channel of Oakley Creek on 28 February. The slump transported the rock armouring into and across the western channel. Filling opposite the slump has stopped until a remedial solution is devised and agreed with Council.

3.0 MEETINGS, INSPECTIONS AND EVENTS

12 February – Auckland Council’s coastal compliance inspection

20 February – Auckland Council’s earthworks compliance inspection

4.0 ENVIRONMENTAL MONITORING

4.1 EARTHWORKS COMPLIANCE

Compliance Inspection was completed by Auckland Council officers on the 20 February and recorded a compliance score of 1 (Full Compliance).

4.2 CONSTRUCTION NOISE AND VIBRATION

There were no Site Specific Noise Management Plans submitted or approved in February.

4.3 AIR QUALITY

No air quality complaints or issues were received during the period.

4.4 CONTAMINATED SOIL

A summary of exported material disposal locations, along with material classifications, sample methods and quantities at various site locations along the alignment during February is included in Appendix B.

4.5 EROSION AND SEDIMENT CONTROL

There were no Erosion and Sediment Control Plans submitted or approved in February.

4.6 ARCHAEOLOGICAL

A resource consent application was submitted in February for vegetation clearance in Smale Street (Eric Armshaw Park), to assist with compliance of BoI Condition ARCH.7 for repairs to the stone wall (note this application was subsequently withdrawn in March following Auckland Council acceptance of an alternative methodology to undertake the vegetation removal and stone wall repair works in accordance with the relevant BoI conditions thus avoiding the need for a resource consent).

4.7 COASTAL MONITORING

Compliance Inspection was completed by Auckland Council officers on the 12 February and recorded a compliance score of 1.

4.8 MARINE MONITORING

The summer 2014 marine benthic monitoring continued during low tide periods at the same 12 sites as the pre-construction baseline monitoring undertaken in February/March 2012.

4.9 ECOLOGICAL

Inspections of Significant and Valued vegetation were undertaken on 11 and 27 February at Traherne Island (Zone 1), Patiki Road/Rosebank Domain/Whau River (Zone 2), Whau River Bridge (Zone 3) and at GNRI (Zone 5).

Monthly assessment of avian roosting locations was undertaken at Harbourview-Orangihina (Pony Club) and the temporary roosting rafts at the Causeway Bridge. The monthly avian count at Harbourview – Orangihina for February 2014 was 147 birds compared to the pre-establishment baseline counts in February 2011 of 92 and 296 birds. No coastal birds were observed to use the two temporary bird roost sites (floating pontoons) installed south of Causeway Bridge, as there was no construction activity affecting roosting sites.

5.0 CORRESPONDENCE ON CONSENT CONDITIONS AND PLANS

Letter received from Council on 5 February certifying the Urban Design and Landscape Master Plan is in compliance with BoI conditions LV.1 and LV.2.

6.0 WORKS PROPOSED FOR MARCH, APRIL AND MAY 2014

Refer Appendix A for Construction Zone Plan.

Zone 1 Causeway

- Eastbound: Continue installing the timber piles and Continuous Flight Auger piles at Causeway Bridge transitions, working platform, preload fill (surcharge), drainage blanket layer, wick drains, coffer dam and reclamation in the coastal area.
- Westbound: Divert cycleway onto closed bus lane westbound from Causeway Bridge to Traherne Island South, complete wick drain and preload in Traherne Island South

Zone 2 / Zone 3 Whau to Rosebank

- Eastbound: continue permanent piling for widening Whau Bridge and installing new bridge spans. Continue earthworks and construction of retaining wall (midway between Patiki and Rosebank ramps).
- Westbound: commence temporary and permanent piling for Whau Bridge widening, continue and complete earthworks between Whau River Bridge and Patiki Road (including reclamation and works on Rosebank Domain batter slope). Commence works for Patiki Road onramp widening, including culvert extension/outfalls.

Zone 5 GNRI

- East bound: continue earthworks to widen the embankment in an easterly direction alongside Great North Road east-bound off-ramp (towards Stone wall).
- Westbound: Continue filling new widened embankment area and open new on-ramp. Remediate Oakley Creek slump. Install blade wall in central median.

The environmental focus for March will continue to be on inspections prior to and during vegetation removal, monitoring material movements, management of replanted area at Traherne Island and ground clearance to ensure ecological and archaeological stand over requirements are met. The establishment and monitoring of sediment and erosion controls and monitoring slumps will also continue.

Appendix A: SH16 Causeway Alliance Construction Zone Plan

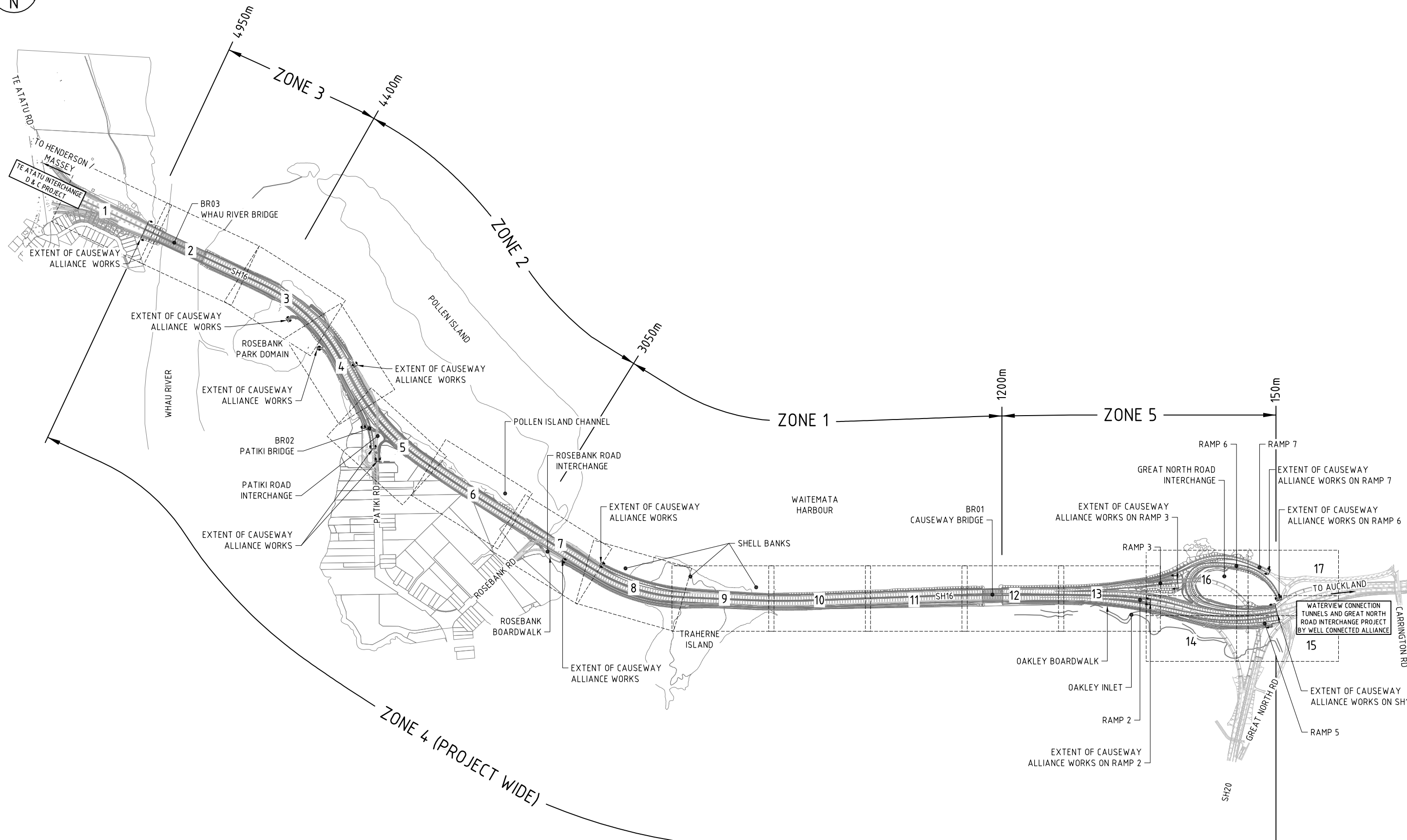

TE ATATU INTERCHANGE
D & C PROJECT

TO HENDERSON / MASSEY

1
EXTENT OF CAUSEWAY ALLIANCE WORKS

BR03
WHAU RIVER BRIDGE

2

EXTENT OF CAUSEWAY ALLIANCE WORKS

ROSEBANK PARK DOMAIN

EXTENT OF CAUSEWAY ALLIANCE WORKS

WHAU RIVER

BR02
PATIKI BRIDGE

PATIKI ROAD INTERCHANGE

EXTENT OF CAUSEWAY ALLIANCE WORKS

PATIKI RD

5

EXTENT OF CAUSEWAY ALLIANCE WORKS

POLLEN ISLAND CHANNEL

ROSEBANK ROAD INTERCHANGE

ROSEBANK RD

ROSEBANK BOARDWALK

EXTENT OF CAUSEWAY ALLIANCE WORKS

SHELL BANKS

TRAHERNE ISLAND

EXTENT OF CAUSEWAY ALLIANCE WORKS

WAITEMATA HARBOUR

BR01
CAUSEWAY BRIDGE

SH16

OAKLEY BOARDWALK

OAKLEY INLET

RAMP 2

EXTENT OF CAUSEWAY ALLIANCE WORKS ON RAMP 2

1200m

ZONE 1

ZONE 5

150m

RAMP 6

RAMP 7

GREAT NORTH ROAD INTERCHANGE

EXTENT OF CAUSEWAY ALLIANCE WORKS ON RAMP 3

RAMP 3

EXTENT OF CAUSEWAY ALLIANCE WORKS ON RAMP 7

EXTENT OF CAUSEWAY ALLIANCE WORKS ON RAMP 6

16

17

WATERVIEW CONNECTION TUNNELS AND GREAT NORTH ROAD INTERCHANGE PROJECT BY WELL CONNECTED ALLIANCE

15

EXTENT OF CAUSEWAY ALLIANCE WORKS ON SH16

RAMP 5

GREAT NORTH RD

14

SH20

CARRINGTON RD

ZONE 4 (PROJECT WIDE)

4950m

ZONE 3

4400m

ZONE 2

3050m

TE ATATU RD

POLLEN ISLAND

TO AUCKLAND

Appendix B: SH16 Causeway Imported and Exported Material Summary

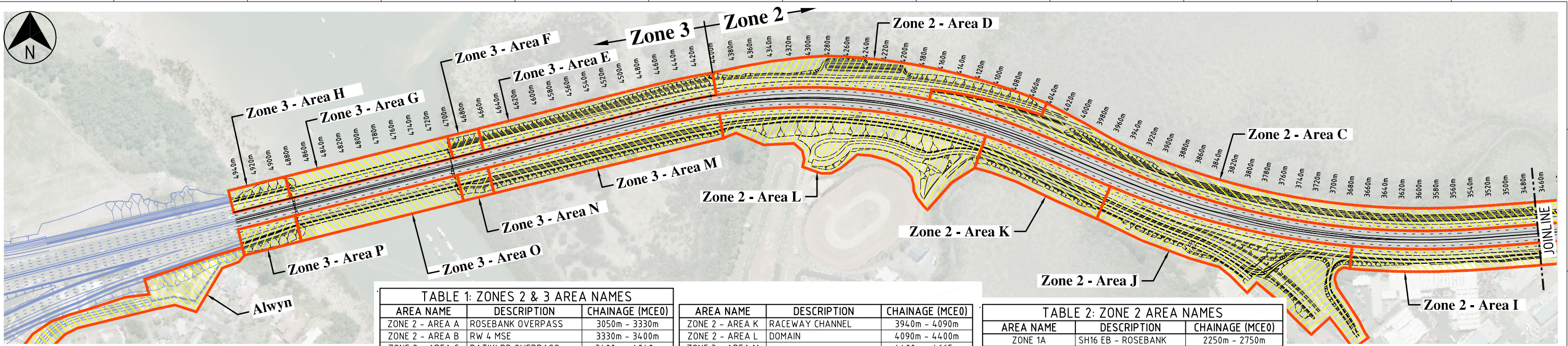

TABLE 1: ZONES 2 & 3 AREA NAMES

AREA NAME	DESCRIPTION	CHAINAGE (MCE0)
ZONE 2 - AREA A	ROSEBANK OVERPASS	3050m - 3330m
ZONE 2 - AREA B	RW 4 MSE	3330m - 3400m
ZONE 2 - AREA C	PATIKI RD OVERPASS	3400m - 4040m
ZONE 2 - AREA D	PATIKI RD OFF-RAMP	4040m - 4400m
ZONE 3 - AREA E	-	4400m - 4665m
AREA NAME	DESCRIPTION	CHAINAGE (MCE0)
ZONE 3 - AREA F	WHAU RIVER NE	4665m - 4700m
ZONE 3 - AREA G	WHAU RIVER BRIDGE EB	4700m - 4885m
ZONE 3 - AREA H	WHAU RIVER NW	4885m - 4950m
ZONE 2 - AREA I	ROSEBANK RD	3050m - 3670m
ZONE 2 - AREA J	PATIKI RD	3670m - 3940m

AREA NAME	DESCRIPTION	CHAINAGE (MCE0)
ZONE 2 - AREA K	RACEWAY CHANNEL	3940m - 4090m
ZONE 2 - AREA L	DOMAIN	4090m - 4400m
ZONE 3 - AREA M	-	4400m - 4665m
ZONE 3 - AREA N	WHAU RIVER SE	4665m - 4700m
ZONE 3 - AREA O	WHAU RIVER BRIDGE WB	4700m - 4885m
AREA NAME	DESCRIPTION	CHAINAGE (MCE0)
ALWYN AVE	ALWYN AVENUE	4950m - ALWYN

TABLE 2: ZONE 2 AREA NAMES

AREA NAME	DESCRIPTION	CHAINAGE (MCE0)
ZONE 1A	SH16 EB - ROSEBANK	2250m - 2750m
ZONE 1B	SH16 EB	1750m - 2250m
ZONE 1C	SH16 EB - CAUSEWAY	1330m - 1750m
ZONE 1D	SH16 EB - CAUSEWAY BR	1135m - 1330m
ZONE 1E	SH16 EB - CAUSEWAY	1000m - 1135m
ZONE 1F	SH16 WB - ROSEBANK	2000m - 3050m
ZONE 1G	SH16 WB - CAUSEWAY	1275m - 2000m
ZONE 1H	SH16 EB - CAUSEWAY	2650m - 3050m
ZONE 1J	SH16 WB - CAUSEWAY	2610m - 3050m

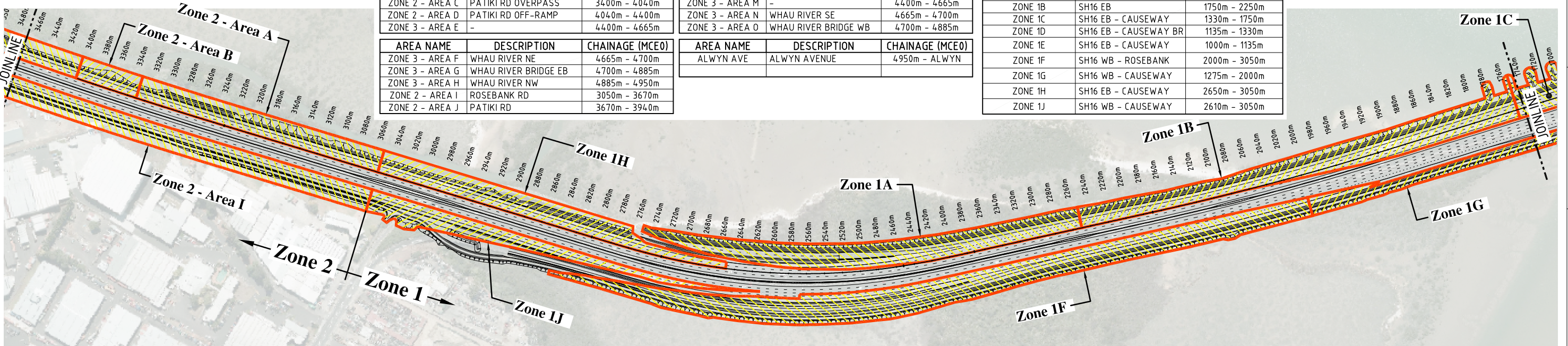

TABLE 3: ZONE 5 AREA NAMES

AREA NAME	DESCRIPTION	CHAINAGE (MCE0)
ZONE 5 - CAUSEWAY BR	CAUSEWAY BRIDGE	
ZONE 5 - AREA 1	RAMP 5 - WB ON-RAMP	150m - 0600m
ZONE 5 - AREA 2	SH16 WB	600m - 1200m
ZONE 5 - AREA 3	RAMP 7 - EB OFF-RAMP	635m - 1000m
ZONE 5 - OAKLEY BOARDWALK		
ZONE 5 - AREA 5	RAMP 3 - SH16 TO SH20	

AREA NAME	DESCRIPTION	CHAINAGE (MCE0)
ZONE 5 - AREA 6	SH16 EB	
ZONE 5 - AREA 7	MEDIAN BY WCA	
ZONE 5 - AREA 8	WB LANES	
ZONE 5 - AREA 9	MEDIAN BY WCA	
ZONE 5 - AREA 10	RAMP 6 - EB ON-RAMP	
ZONE 5 - AREA 11	SH16 WB	1000m - 1200m

ORIGINAL DRAWING IN COLOUR

UNCONTROLLED COPY DRAFT



STATUS: FOR REVIEW
SCALE: NOT TO SCALE
FILENAME: SH16-4-R-SK-0774.dwg

CLIENT: NEW ZEALAND TRANSPORT AGENCY
PROJECT: SH16 CAUSEWAY UPGRADE PROJECT (NZTA CA3685)
DRAFTER: R. Tauro
DRAFTING CHECK: R. Tauro
DESIGNER: R. Tauro
APPROVED: G. Houppapa

TITLE: GENERAL ARRANGEMENT ZONING AREAS
DRAWING No: SH16-4-R-SK-0774
REV: A

Login: rtauro Plot Date: 21 February, 2014, 11:59 AM

