

LEGEND

- B.O.I. DESIGNATION BOUNDARY
- EXISTING DESIGNATION BOUNDARY
- EXISTING NOISE WALLS TO BE RETAINED
- PROPOSED NOISE WALLS
- PROPOSED RETAINING WALL
- - - PLANTING AREA BOUNDARIES
- EXISTING TREE
- PROPOSED TREE
- CABBAGE TREE

NOTE:
 Colour coding in planting areas is for clarity only
 - Refer to labelling for plant varieties

1 No Phormium cookianum within 3m of live lane or 2m from shoulder elsewhere
 2 Where Muehlenbeckia is part of a mix, it shall be planted in single species swathes, not mixed with other species

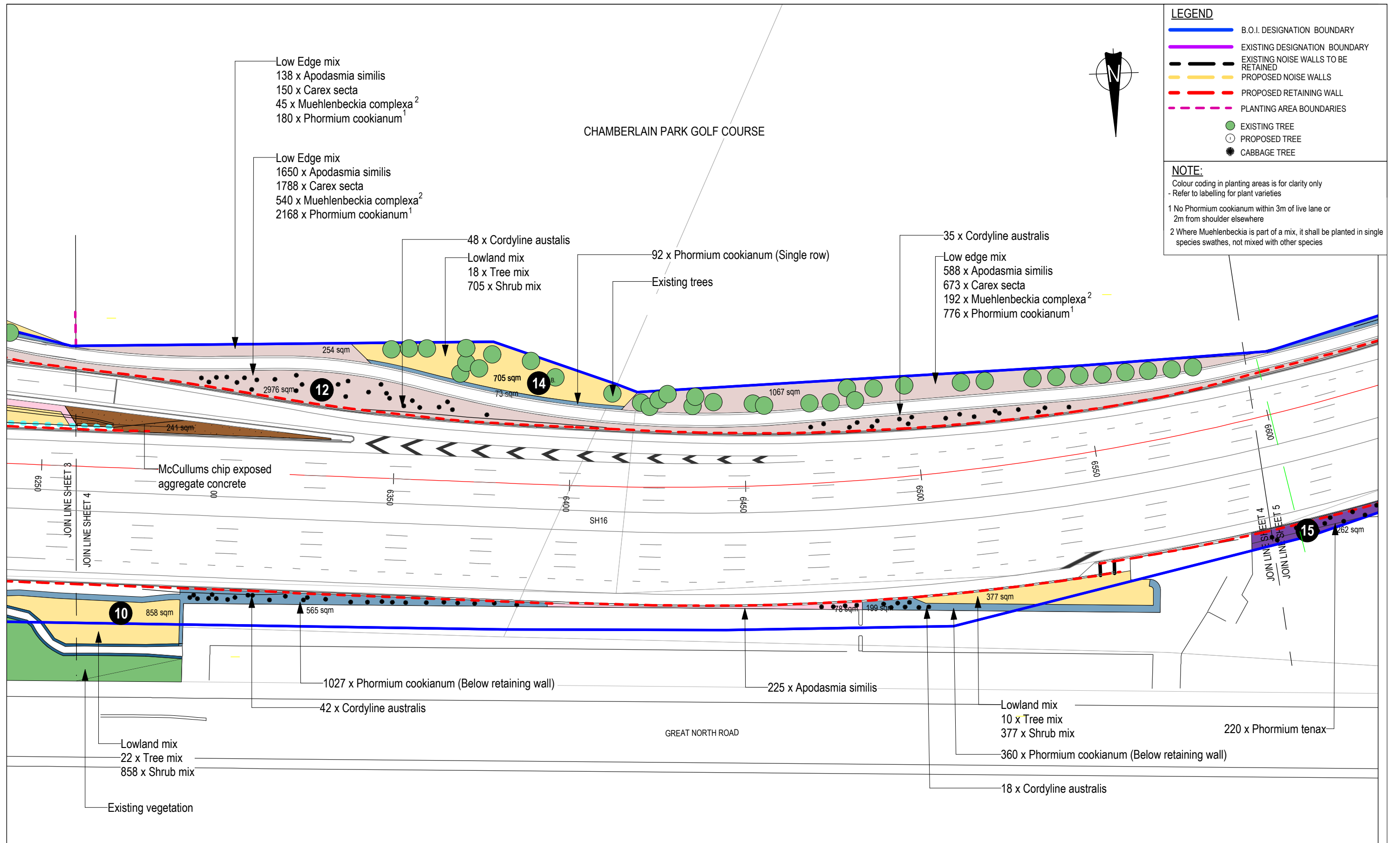

NOTE:
 Refer to sheets 9 and 10 for planting schedules

CONSTRUCTION

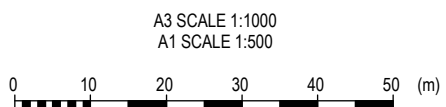

No.	Issue for Construction	Revision	JT	RP	JH	07.03.14
No.	Issue for Construction	Revision	By	Chk	Appd	Date
1	Issue for Construction		JT	RP	JH	07.03.14

LA4 Landscape Architects
 26 Kitchener Street, Auckland
 P.O. Box 5669, Wellesley Street, Auckland
 p: 09 358 0904 f: 09 358 0895
 e: la4@la4.co.nz www.la4.co.nz

Original Scale (A1)	1:500	Design	JH
Drafting	JT	Drafting Checked	JH
Reduced Scale (A3)	1:1000	Approval	JH



Project: SH 16 ST LUKES
 WESTERN RING ROUTE PROJECT

Title: PLANTING DETAILS
 4 of 10

Discipline:	LANDSCAPE/URBAN DESIGN
Project No.	215023-D-A-919-004
Rev.	1