

Christchurch City Council
MINUTES

Date: **Thursday 8 August 2019**
Time: **9.34am**
Venue: **Council Chambers, Civic Offices,
53 Hereford Street, Christchurch**

Present

Chairperson	Mayor Lianne Dalziel
Deputy Chairperson	Deputy Mayor Andrew Turner
Members	Councillor Vicki Buck
	Councillor Jimmy Chen
	Councillor Phil Clearwater
	Councillor Pauline Cotter
	Councillor Mike Davidson
	Councillor David East
	Councillor Anne Galloway
	Councillor James Gough
	Councillor Yani Johanson
	Councillor Aaron Keown
	Councillor Glenn Livingstone
	Councillor Raf Manji
	Councillor Tim Scandrett
	Councillor Deon Swiggs
	Councillor Sara Templeton

8 August 2019

Principal Advisor

Mary Richardson
Acting Chief Executive
Tel: 941 8999

Christopher Turner-Bullock
Community Governance Manager
941 8233
christopher.turner@ccc.govt.nz
www.ccc.govt.nz

This meeting is a continuation of the 6 August 2019 Council meeting, which adjourned to 9.30am on 8 August 2019

The agenda was dealt with in the following order.

1. Apologies

Council Resolved CNCL/2019/00161

That the apologies from Councillors Cotter, Manji and Scandrett for lateness be accepted.

Mayor/Councillor Chen

Carried

Councillors Cotter, Manji and Scandrett joined the meeting at 9.35am during item 2.

2. Declarations of Interest

There were no declarations of interest recorded.

3. Public Participation

3.1 Public Forum

- 3.1.1** Rebecca Finch and Clare Thompson presented to the Council regarding Extinction Rebellion

3.2 Deputations by Appointment

Deputations on item 5 Global Settlement Agreement were held on 6 August 2019. There were no further deputations.

4. Presentation of Petitions

There was no presentation of petitions.

20. Resolution to Include Supplementary Reports

Council Resolved CNCL/2019/00162

That the reports be received and considered at the Council meeting on Thursday 8 August 2019.

Open Items

21. Rates Remissions for Northwood Gas Explosion
22. Mayor's Monthly Report – July 2019

Mayor/Councillor Gough

Carried

Karolin Potter, Community Board Chairperson and Christopher Turner-Bullock, Community Governance Manager joined the table for item 6.

6. Waihoru/Spreydon-Cashmere Community Board Report to Council

Council Resolved CNCL/2019/00163

That the Council:

1. Receive the Waihoru/Spreydon-Cashmere Community Board report for July 2019.

Councillor Scandrett/Councillor Clearwater

Carried

Kim Money, Community Board Chairperson and Jo Wells, Community Governance Manager joined the table for item 7.

7. Waitai/Coastal-Burwood Community Board Report to Council

Council Resolved CNCL/2019/00164

That the Council:

1. Receive the Waitai/Coastal-Burwood Community Board report for July 2019.

Councillor East/Councillor Livingstone

Carried

Sam MacDonald, Community Board Chairperson and Maryanne Lomax, Community Governance Manager joined the table for item 8.

8. Waimāero/Fendalton-Waimairi-Harewood Community Board Report to Council

Council Resolved CNCL/2019/00165

That the Council:

1. Receive the Waimāero/Fendalton-Waimairi-Harewood Community Board report for July 2019.

Councillor Manji/Councillor Gough

Carried

Mike Mora, Community Board Chairperson and Matthew Pratt, Community Governance Manager joined the table for item 9.

9. Waipuna/Halswell-Hornby-Riccarton Community Board Report to Council

Council Resolved CNCL/2019/00166

That the Council:

1. Receive the Waipuna/Halswell-Hornby-Riccarton Community Board report for July 2019.

Councillor Chen/Councillor Galloway

Carried

Sally Buck, Community Board Chairperson and Arohanui Grace, Community Governance Manager joined the table for item 10.

10. Waikura/Linwood-Central-Heathcote Community Board Report to Council - July 2019

Council Resolved CNCL/2019/00167

That the Council:

1. Receive the Waikura/Linwood-Central-Heathcote Community Board report for July 2019.
2. Request staff report back with a simplified process to enable proper consideration of Te Reo options for naming of roads as well appropriate community engagement.

Councillor Swiggs/Councillor Johanson

Carried

Emma Norrish, Community Board Deputy Chairperson and Christine Lane, Community Governance Manager joined the table for item 11.

11. Waipapa/Papanui-Innes Community Board Report to Council for July 2019

Council Resolved CNCL/2019/00168

That the Council:

1. Receive the Waipapa/Papanui-Innes Community Board report for July 2019.

Councillor Cotter/Councillor Davidson

Carried

Pam Richardson, Community Board Chairperson and Joan Blatchford, Community Governance Manager joined the table for item 12.

12. Te Pātaka o Rākaihautū/Banks Peninsula Community Board Report to Council

Pam spoke to the loss of two significant Maori leaders, Pere Tainui and George Tikao. The Mayor requested a minutes silence in respect of the tremendous support they provided the community.

Council Resolved CNCL/2019/00169

That the Council:

1. Receive the Te Pātaka o Rākaihautū/Banks Peninsula Community Board report for July 2019.
2. Request staff to provide an update on the unlicensed structures on the Akaroa Wharf to the Community Board to enable the Board to report to the next Community Board Council meeting.

Deputy Mayor/Councillor Scandrett

Carried

22. Mayor's Monthly Report - July 2019

Council Resolved CNCL/2019/00170

That the Council:

1. Receive the information in this report.

Councillor Davidson/Councillor Swiggs

Carried

The meeting adjourned at 11.01am and reconvened 11.24am.

Report from Coastal-Burwood Community Board - 22 July 2019

14. 553F Pages Road - Revocation of Reserve Status and Creation of a Fee Simple Title

Council Resolved CNCL/2019/00171

That the Council:

1. Approves the commencement of revocation procedures under Section 24 of the Reserves Act 1977 seeking to revoke the Road Reserve status of the land at 553F Pages Road described as Lot 3 DP 36587, and having an area of 120m², subject to:
 - a. Public Notification as prescribed by Section 119 of the Reserves Act 1977 (and no sustainable objections being received), and;
 - b. The consent of the Minister of Conservation pursuant to Section 24 of the Reserves Act 1977.
2. Approves the subsequent retention of the land in Council ownership as a fee simple interest to be held as an integral part of the Knights Drain stormwater storage and wetland project, and;
3. Approves that the Property Consultancy Manager be delegated the authority to manage and conclude all of the negotiations and transactions required to finalise the revocation process and the subsequent registration of a new fee simple title in favour of Council.

Councillor Livingstone/Mayor

Carried

15. Draft Submission on Ministry of Transport's 'Road to Zero' Consultation on the 2020-2030 Road Safety Strategy

Council Resolved CNCL/2019/00172

That the Council:

1. Approve the draft Submission on the Ministry of Transport's Road to Zero Road Safety Strategy 2020-2030.

Councillor Davidson/Councillor Cotter

Carried

16. Chief Executive's Report - July 2019

Council Resolved CNCL/2019/00173

That the Council:

1. Receive the report.

Councillor Clearwater/Councillor Cotter

Carried

Report from Spreydon-Cashmere Community Board - 2 July 2019

13. Lincoln Road (Moorhouse to Whiteleigh) and Moorhouse Avenue (Selwyn to Lincoln) Bus Priority Improvements

Council Resolved CNCL/2019/00174

That the Council:

1. Approve the scheme design, subject to any resource consent required, for the section of Lincoln Road between Moorhouse Avenue and Whiteleigh Avenue and Moorhouse Avenue between Selwyn Street and Lincoln Road as detailed in Attachment A and recommend to Council approval of the Special Vehicle Lanes (bus lanes), the 30km/h speed restriction on Lincoln Road and installation of the new pedestrian traffic signals outside No 332 Lincoln Road.
2. Make the following resolutions relying on its powers under the Christchurch City Council Traffic and parking Bylaw 2008 and Part 21 of the Local Government Act 1974.

Existing Moorhouse Avenue – Selwyn Street and Grove Road - Traffic Controls

3. Approves that the special vehicle lanes on the south side of Moorhouse Avenue from its intersection with Selwyn Street to its intersection with Grove Road be revoked.

New Moorhouse Avenue – Selwyn Street to Grove Road - Traffic Controls

4. Approves that a special vehicle lane for the use of westbound cycles only, be established on the south side of Moorhouse Avenue, commencing at its intersection with Selwyn Street, and extending in a westerly direction for a distance of 87 metres, as detailed on **Attachment A**. This special vehicle lane is authorised under Clause 18 of the Christchurch City Council Traffic and Parking Bylaw 2017, and is therefore to be added to the Council's Register of Roads or Traffic Lanes Restricted to Specific Classes of Vehicles.
5. Approves that a special vehicle lane for the use of westbound buses and cycles only, be established on the south side of Moorhouse Avenue, commencing at a point 87 metres west of its intersection with Selwyn Street, and extending in a westerly direction for a distance of 142 metres as detailed on **Attachment A**. This special vehicle lane is to apply Monday to Friday, 4:00pm to 6:00pm. This special vehicle lane is authorised under Clause 18 of the Christchurch City Council Traffic and Parking Bylaw 2017, and is therefore to be added to the Council's Register of Roads or Traffic Lanes Restricted to Specific Classes of Vehicles.
6. Approves that a special vehicle lane for the use of westbound cycles only, be established on the south side of Moorhouse Avenue, commencing at a point 229 metres west of its intersection with Selwyn Street, and extending in a westerly direction to its intersection with Grove Road western kerb line, as detailed on **Attachment A**. This special vehicle

lane is authorised under Clause 18 of the Christchurch City Council Traffic and Parking Bylaw 2017, and is therefore to be added to the Council's Register of Roads or Traffic Lanes Restricted to Specific Classes of Vehicles.

7. Approves that a special vehicle lane for the use of westbound cycles only, be established on the south side of Moorhouse Avenue, located between the left turn lane and the leftmost straight ahead lane, commencing at a point 103 metres west of its intersection with Selwyn Street, and extending in a westerly direction to its intersection with Grove Road, as detailed on **Attachment A**. This special vehicle lane is authorised under Clause 18 of the Christchurch City Council Traffic and Parking Bylaw 2017, and is therefore to be added to the Council's Register of Roads or Traffic Lanes Restricted to Specific Classes of Vehicles.

Existing Grove Road – Moorhouse Avenue to Southern Extent on Grove Road - Traffic Control

8. Approves that the one way section on Grove Road from its intersection with Moorhouse Avenue, and extending in a southerly direction for a distance of 16 metres be revoked.

New Grove Road – Moorhouse Avenue to Southern Extent on Grove Road - Traffic Control

9. Approves that Grove Road be one way north to south from its intersection with Moorhouse Avenue, and extending in a southerly direction for a distance of 16 metres, as detailed on **Attachment A**, in accordance with Clause 16 of the Christchurch City Council Traffic and Parking Bylaw 2017. This one way section is to be added to the Register of One Way Streets in the Traffic and Parking bylaw 2017.

Existing Lincoln Road – Moorhouse Avenue to Barrington Street and Whiteleigh Avenue - Traffic Control

10. Approves that the existing traffic signals, special vehicle lanes, shared pedestrian/ cycle pathway and speed limit on Lincoln Road from its intersection with Moorhouse Avenue to its intersection with Barrington Street and Whiteleigh Avenue be revoked.

New Lincoln Road – Moorhouse Avenue to Barrington Street and Whiteleigh Avenue - Traffic Control

Lincoln Rd - Speed limit

11. Approves pursuant to Section 27(1) (a) of the Christchurch City Council Traffic and Parking Bylaw 2017, set the speed limit at 50 km /h on Lincoln Road commencing at its intersection with Moorhouse Avenue, and extending in a south-westerly direction for a distance of 202 metres as detailed on **Attachment A**. This speed limit is to be added to the Council's Register of Speed limits.
12. Approves pursuant to Section 27(1) (a) of the Christchurch City Council Traffic and Parking Bylaw 2017, set the speed limit at 30 km /h on Lincoln Road commencing at a point 202 metres southwest of its intersection with Moorhouse Avenue, and extending in a south-westerly direction for a distance of 632 metres as detailed on **Attachment A**. This speed limit is to be added to the Council's Register of Speed limits.
13. Approves pursuant to Section 27(1) (a) of the Christchurch City Council Traffic and Parking Bylaw 2017 to set the speed limit at 50 km /h on Lincoln Road commencing at a point 834 metres southwest of its intersection with Moorhouse Avenue, and extending in a south-westerly direction to its intersection with Barrington Street and Whiteleigh Avenue as detailed on **Attachment A**. This speed limit is to be added to the Council's Register of Speed limits.

Lincoln Road - Intersection Control

14. Approves that the intersection of Harman Street and Lincoln Road, be controlled by traffic signals in accordance with the Land Transport Rule: Traffic Control Devices 2004 as detailed on **Attachment A**.
15. Approves that pedestrian traffic signals be duly established and marked in accordance with Section 6 of the Land Transport Rule: Traffic Control Devices 2004, on Lincoln Road, located at a point 104 metres southwest of its intersection with Dickens Street, as detailed on **Attachment A**.
16. Approves that pedestrian traffic signals be duly established and marked in accordance with Section 6 of the Land Transport Rule: Traffic Control Devices 2004, on Lincoln Road, located at a point 82 metres southwest of its intersection with Parlane Street, as detailed on **Attachment A**.

Lincoln Road - Special Vehicle Lane

17. Approves that a special vehicle lane for the use of south-westbound cycles only, be established on the southeast side of Lincoln Road, commencing at its intersection with Moorhouse Avenue, and extending in a south-westerly direction for a distance of 38 metres, as detailed on **Attachment A**. This special vehicle lane is authorised under Clause 18 of the Christchurch City Council Traffic and Parking Bylaw 2017, and is therefore to be added to the Council's Register of Roads or Traffic Lanes Restricted to Specific Classes of Vehicles.
18. Approves that a special vehicle lane for the use of south-westbound buses and cycles only, be established on the southeast side of Lincoln Road, commencing at a point 38 metres southwest of its intersection with Moorhouse Avenue, and extending in a south-westerly direction to its intersection with Harman Street, as detailed on **Attachment A**. This special vehicle lane is authorised under Clause 18 of the Christchurch City Council Traffic and Parking Bylaw 2017, and is therefore to be added to the Council's Register of Roads or Traffic Lanes Restricted to Specific Classes of Vehicles.
19. Approves that a special vehicle lane for the use of south-westbound buses and cycles only, be established on the southeast side of Lincoln Road, commencing at its intersection with Harman Street, and extending in a south-westerly direction for a distance of 532 metres, as detailed on **Attachment A**. This special vehicle lane is to apply Monday to Friday, 4:00pm to 6:00pm. This special vehicle lane is authorised under Clause 18 of the Christchurch City Council Traffic and Parking Bylaw 2017, and is therefore to be added to the Council's Register of Roads or Traffic Lanes Restricted to Specific Classes of Vehicles.
20. Approves that a special vehicle lane for the use of south-westbound cycles only, be established on the southeast side of Lincoln Road, commencing at a point 532 metres southwest of its intersection with Harman Street, and extending in a south-westerly direction to its intersection with Barrington Street and Whiteleigh Avenue, as detailed on **Attachment A**. This special vehicle lane is authorised under Clause 18 of the Christchurch City Council Traffic and Parking Bylaw 2017, and is therefore to be added to the Council's Register of Roads or Traffic Lanes Restricted to Specific Classes of Vehicles.
21. Approves that a special vehicle lane for the use of north-eastbound cycles only, be established on the northwest side of Lincoln Road, commencing at its intersection with Whiteleigh Avenue, and extending in a north-easterly direction for a distance of 111 metres as detailed on **Attachment A**. This special vehicle lane is authorised under Clause 18 of the Christchurch City Council Traffic and Parking Bylaw 2017, and is

therefore to be added to the Council's Register of Roads or Traffic Lanes Restricted to Specific Classes of Vehicles.

22. Approves that a special vehicle lane for the use of north-eastbound buses and cycles only, be established on the northwest side of Lincoln Road, commencing at a point 111 metres northeast of its intersection with Whiteleigh Avenue, and extending in a north-easterly direction for a distance of 452 metres, as detailed on **Attachment A**. This special vehicle lane is to apply Monday to Friday, 7:00am to 9:00am. This special vehicle lane is authorised under Clause 18 of the Christchurch City Council Traffic and Parking Bylaw 2017, and is therefore to be added to the Council's Register of Roads or Traffic Lanes Restricted to Specific Classes of Vehicles.
23. Approves that a special vehicle lane for the use of north-eastbound cycles only, be established on the northwest side of Lincoln Road, commencing at a point 563 metres northeast of its intersection with Whiteleigh Avenue, and extending in a north-easterly direction to its intersection with Moorhouse Avenue as detailed on **Attachment A**. This special vehicle lane is authorised under Clause 18 of the Christchurch City Council Traffic and Parking Bylaw 2017, and is therefore to be added to the Council's Register of Roads or Traffic Lanes Restricted to Specific Classes of Vehicles.

New Moorhouse Avenue – Grove to Lincoln Road - Traffic Control

24. Approves that the pathway on the south side of Moorhouse Avenue commencing at its intersection with Grove Road western kerb line, and extending in a westerly direction for a distance of 13 metres, as detailed on Attachment A, be resolved as a shared pedestrian / westbound cycle pathway in accordance with Clause 21(1)(a) of the Christchurch City Council Traffic and Parking Bylaw 2017.

Existing Moorhouse Avenue – Selwyn Street to Grove Road - Traffic Control

25. Approves that the existing road layout including road markings, kerb alignments and road surface treatments on the south side of Moorhouse Avenue from its intersection with Selwyn Street to its intersection with Grove Road be revoked.

New Moorhouse Avenue – Selwyn Street to Grove Road - Traffic Control

26. Approves the road markings, kerb alignments and road surface treatments on the south side of Moorhouse Avenue, from its intersection with Selwyn Street to its intersection with Grove Road as detailed on **Attachment A**.

Existing Grove Road – Moorhouse Avenue to Southern Extent on Grove Road - Traffic Control

27. Approves that the existing road layout including road markings and kerb alignments on Grove Road from its intersection with Moorhouse Avenue, and extending in a southerly direction for a distance of 16 metres be revoked.

New Grove Road – Moorhouse Avenue to Southern Extent on Grove Road - Traffic Control

28. Approves the road markings, kerb alignments and road surface treatments on Grove Road from its intersection with Moorhouse Avenue, and extending in a southerly direction for a distance of 16 metres as detailed on **Attachment A**.

Existing Lincoln Road – Moorhouse Avenue to Barrington Street and Whiteleigh Avenue - Traffic Control

29. Approves that the existing road layout including road markings, kerb alignments and road surface treatments on Lincoln Road, from its intersection with Moorhouse Avenue to its intersection with Barrington Street and Whiteleigh Avenue be revoked.

30. Approves that a Give Way control on Hazeldean Road at its intersection with Lincoln Road be revoked.
31. Approves that a Give Way control on Clarence Street South at its intersection with Lincoln Road be revoked.
32. Approves that a Stop control on Spencer Street at its intersection with Lincoln Road be revoked.

Lincoln Road - Shared Path

33. Approves that the pathway on the southeast side of Lincoln Road commencing at its intersection with Moorhouse Avenue and extending in a south-westerly direction for a distance of 26 metres, as detailed on Attachment A, be resolved as a westbound then south-westbound shared pedestrian / cycle pathway in accordance with Clause 21(1)(a) of the Christchurch City Council Traffic and Parking Bylaw 2017.

New Lincoln Road – Moorhouse Avenue to Barrington Street and Whiteleigh Avenue - Traffic Control

34. Approves the road markings, kerb alignments, traffic islands and road surface treatments on Lincoln Road from its intersection with Moorhouse Avenue to its intersection with Barrington and Whiteleigh Avenue as detailed on **Attachment A**.
35. Approves that the right turn movement from Lincoln Road northeast approach into Dickens Street be prohibited, as detailed on Attachment A in accordance with Clause 17 of the Christchurch City Council Traffic and Parking Bylaw 2017.
36. Approves that the right turn movement from Lincoln Road northeast approach into Spencer Street be prohibited, as detailed on Attachment A in accordance with Clause 17 of the Christchurch City Council Traffic and Parking Bylaw 2017.

Existing Lincoln Road – Moorhouse Avenue to Barrington Street and Whiteleigh Avenue - Parking and Stopping Restrictions

37. Approves that all parking and stopping restrictions on the southeast side of Lincoln Road commencing at its intersection with Moorhouse Avenue and extending in a south-westerly to its intersection with Barrington Street be revoked.
38. Approves that all parking and stopping restrictions on the northwest side of Lincoln Road commencing at its intersection with Whiteleigh Avenue and extending in a north-easterly direction to its intersection with Moorhouse Avenue be revoked.

Moorhouse Avenue to Hazeldean Road

39. Approves that the stopping of vehicles be prohibited at any time on the southeast side of Lincoln Road commencing at its intersection with Moorhouse Avenue, and extending in a south-westerly direction to its intersection with Hazeldean Road.

Hazeldean Road to Harman Street

40. Approves that the stopping of vehicles be prohibited at any time on the southeast side of Lincoln Road commencing at its intersection with Hazeldean Road, and extending in a south-westerly direction for a distance of 13 metres.
41. Approves that a Bus Stop be installed on the southeast side of Lincoln Road commencing at a point 13 metres southwest of its intersection with Hazeldean Road, and extending in a south-westerly direction for a distance of 17 metres.
42. Approves that the stopping of vehicles be prohibited at any time on the southeast side of Lincoln Road commencing at a point 30 metres southwest of its intersection with

Hazeldean Road, and extending in a south-westerly direction to its intersection with Harman Street.

Harman Street to Dickens Street

43. Approves that the stopping of vehicles be prohibited at any time on the southeast side of Lincoln Road commencing at its intersection with Harman Street, and extending in a south-westerly direction for a distance of 44 metres.
44. Approves that the parking of vehicles be restricted to a maximum period of 60 minutes on the southeast side of Lincoln Road, commencing at point 44 metres southwest of its intersection with Harman Street, and extending in a south-westerly direction for a distance of 11 metres. This restriction is to apply Monday to Friday, 8:00am to 4:00pm and to apply Saturday to Sunday, 8:00am to 6:00pm.
45. Approves that the stopping of vehicles be prohibited at any time on the southeast side of Lincoln Road commencing at a point 55 metres southwest of its intersection with Harman Street, and extending in a south-westerly direction to its intersection with Dickens Street.

Dickens Street to Parlane Street

46. Approves that the stopping of vehicles be prohibited at any time on the southeast side of Lincoln Road commencing at its intersection with Dickens Street, and extending in a south-westerly direction for a distance of seven metres.
47. Approves that the parking of vehicles be restricted to a maximum period of 10 minutes on the southeast side of Lincoln Road, commencing at point seven metres southwest of its intersection with Dickens Street, and extending in a south-westerly direction for a distance of 18 metres. This restriction is to apply Monday to Friday, 8:00am to 4:00pm and to apply Saturday to Sunday, 8:00am to 6:00pm.
48. Approves that the parking of vehicles be restricted to a maximum period of 60 minutes on the southeast side of Lincoln Road, commencing at point 25 metres southwest of its intersection with Dickens Street, and extending in a south-westerly direction for a distance of 45.5 metres. This restriction is to apply Monday to Friday, 8:00am to 4:00pm and to apply Saturday to Sunday, 8:00am to 6:00pm.
49. Approves that the stopping of vehicles be prohibited at any time on the southeast side of Lincoln Road commencing at a point 70.5 metres southwest of its intersection with Dickens Street, and extending in a south-westerly direction for a distance of 30 metres.
50. Approves that a Bus Stop be installed on the southeast side of Lincoln Road commencing at a point 100.5 metres southwest of its intersection with Dickens Street, and extending in a south-westerly direction for a distance of 14 metres.
51. Approves that the stopping of vehicles be prohibited at any time on the southeast side of Lincoln Road commencing at a point 114.5 metres southwest of its intersection with Dickens Street, and extending in a south-westerly direction for a distance of 15 metres.
52. Approves that the parking of vehicles be restricted to a maximum period of 60 minutes on the southeast side of Lincoln Road, commencing at point 129.5 metres southwest of its intersection with Dickens Street, and extending in a south-westerly direction for a distance of six metres. This restriction is to apply Monday to Friday, 8:00am to 4:00pm and to apply Saturday to Sunday, 8:00am to 6:00pm.

53. Approves that the stopping of vehicles be prohibited at any time on the southeast side of Lincoln Road commencing at a point 135 metres southwest of its intersection with Dickens Street, and extending in a south-westerly direction for a distance of nine metres.
54. Approves that the parking of vehicles be restricted to a maximum period of 10 minutes on the southeast side of Lincoln Road, commencing at point 144.5 metres southwest of its intersection with Dickens Street, and extending in a south-westerly direction for a distance of 12 metres. This restriction is to apply Monday to Friday, 8:00am to 4:00pm and to apply Saturday to Sunday, 8:00am to 6:00pm.
55. Approves that the stopping of vehicles be prohibited at any time on the southeast side of Lincoln Road commencing at a point 156.5 metres southwest of its intersection with Dickens Street, and extending in a south-westerly direction for a distance of six metres.
56. Approves that the parking of vehicles be restricted to a maximum period of 60 minutes on the southeast side of Lincoln Road, commencing at point 162.5 metres southwest of its intersection with Dickens Street, and extending in a south-westerly direction for a distance of 17 metres. This restriction is to apply Monday to Friday, 8:00am to 4:00pm and to apply Saturday to Sunday, 8:00am to 6:00pm.
57. Approves that the stopping of vehicles be prohibited at any time on the southeast side of Lincoln Road commencing at a point 179.5 metres southwest of its intersection with Dickens Street, and extending in a south-westerly direction to its intersection with Parlane Street.

Parlane Street to Spencer Street

58. Approves that the stopping of vehicles be prohibited at any time on the southeast side of Lincoln Road commencing at its intersection with Parlane Street, and extending in a south-westerly for a distance of 18 metres.
59. Approves that the parking of vehicles be restricted to a maximum period of 60 minutes on the southeast side of Lincoln Road, commencing at point 18 metres southwest of its intersection with Parlane Street, and extending in a south-westerly direction for a distance of 13.5 metres. This restriction is to apply Monday to Friday, 8:00am to 4:00pm and to apply Saturday to Sunday, 8:00am to 6:00pm.
60. Approves that the stopping of vehicles be prohibited at any time on the southeast side of Lincoln Road commencing at a point 31 metres southwest of its intersection with Parlane Street, and extending in a south-westerly direction for a distance of eight metres.
61. Approves that the parking of vehicles be restricted to a maximum period of 60 minutes on the southeast side of Lincoln Road, commencing at point 39 metres southwest of its intersection with Parlane Street, and extending in a south-westerly direction for a distance of 23 metres. This restriction is to apply Monday to Friday, 8:00am to 4:00pm and to apply Saturday to Sunday, 8:00am to 6:00pm.
62. Approves that the stopping of vehicles be prohibited at any time on the southeast side of Lincoln Road commencing at a point 62 metres southwest of its intersection with Parlane Street, and extending in a south-westerly direction for a distance of 29 metres.
63. Approves that the parking of vehicles be restricted to a maximum period of 30 minutes on the southeast side of Lincoln Road, commencing at point 91 metres southwest of its intersection with Parlane Street, and extending in a south-westerly direction for a distance of 12 metres. This restriction is to apply Monday to Friday, 8:00am to 4:00pm and to apply Saturday to Sunday, 8:00am to 6:00pm.

64. Approves that the stopping of vehicles be prohibited at any time on the southeast side of Lincoln Road commencing at a point 103 metres southwest of its intersection with Parlane Street, and extending in a south-westerly direction for a distance of 10 metres.
65. Approves that the parking of vehicles be restricted to a maximum period of 10 minutes on the southeast side of Lincoln Road, commencing at point 113 metres southwest of its intersection with Parlane Street, and extending in a south-westerly direction for a distance of 19 metres. This restriction is to apply Monday to Friday, 8:00am to 4:00pm and to apply Saturday to Sunday, 8:00am to 6:00pm.
66. Approves that a Bus Stop be installed on the southeast side of Lincoln Road commencing at a point 132 metres southwest of its intersection with Parlane Street, and extending in a south-westerly direction for a distance of 22 metres.
67. Approves that the stopping of vehicles be prohibited at any time on the southeast side of Lincoln Road commencing at a point 154 metres southwest of its intersection with Parlane Street, and extending in a south-westerly direction for a distance of eight metres.
68. Approves that the parking of vehicles be restricted to a maximum period of 60 minutes on the southeast side of Lincoln Road, commencing at point 162 metres southwest of its intersection with Parlane Street, and extending in a south-westerly direction for a distance of 26 metres. This restriction is to apply Monday to Friday, 8:00am to 4:00pm and to apply Saturday to Sunday, 8:00am to 6:00pm.
69. Approves that the stopping of vehicles be prohibited at any time on the southeast side of Lincoln Road commencing at a point 188 metres southwest of its intersection with Parlane Street, and extending in a south-westerly direction to its intersection with Spencer Street.

Spencer Street to Barrington Street

70. Approves that the stopping of vehicles be prohibited at any time on the southeast side of Lincoln Road commencing at its intersection with Spencer Street, and extending in a south-westerly direction for a distance of 10 metres.
71. Approves that the parking of vehicles be restricted to a maximum period of 60 minutes on the southeast side of Lincoln Road, commencing at point 10 metres southwest of its intersection with Spencer Street, and extending in a south-westerly direction for a distance of 41 metres. This restriction is to apply Monday to Friday, 8:00am to 4:00pm and to apply Saturday to Sunday, 8:00am to 6:00pm.
72. Approves that the stopping of vehicles be prohibited at any time on the southeast side of Lincoln Road commencing at its intersection with Spencer Street, and extending in a south-westerly direction to its intersection with Barrington Street.

Whiteleigh Avenue to Clarence Street South

73. Approves that the stopping of vehicles be prohibited at any time on the northwest side of Lincoln Road commencing at its intersection with Whiteleigh Avenue, and extending in a north-easterly direction for a distance of 104 metres.
74. Approves that the parking of vehicles be restricted to a maximum period of 60 minutes on the northwest side of Lincoln Road, commencing at point 104 metres northeast of its intersection with Whiteleigh Avenue, and extending in a north-easterly direction for a distance of 67 metres. This restriction is to apply on Monday to Friday, 9:00am to 6:00pm and to apply on Saturday to Sunday, 8:00am to 6:00pm.

75. Approves that the stopping of vehicles be prohibited at any time on the northwest side of Lincoln Road commencing at a point 171 metres northeast of its intersection with Whiteleigh Avenue, and extending in a north-easterly direction to its intersection with Clarence Street South.

Clarence Street South to Wise Street

76. Approves that the stopping of vehicles be prohibited at any time on the northwest side of Lincoln Road commencing at its intersection with Clarence Street South, and extending in a north-easterly direction for a distance of 14 metres.
77. Approves that a Bus Stop be installed on the northwest side of Lincoln Road commencing at a point 14 metres northeast of its intersection with Clarence Street South, and extending in a north-easterly direction for a distance of 23 metres.
78. Approves that the stopping of vehicles be prohibited at any time on the northwest side of Lincoln Road commencing at a point 37 metres northeast of its intersection with Clarence Street South, and extending in a north-easterly direction for a distance of 33 metres.
79. Approves that a Loading Zone for Goods Vehicles Only be created on the northwest side of Lincoln Road and restricted to a maximum period of 10 minutes commencing at a point 70 metres northeast of its intersection with Clarence Street South, and extending in north-easterly direction for a distance of eight metres.
80. Approves that the stopping of vehicles be prohibited at any time on the northwest side of Lincoln Road commencing at a point 78 metres northeast of its intersection with Clarence Street South, and extending in a north-easterly direction for a distance of six metres.
81. Approves that the parking of vehicles be restricted to a maximum period of 60 minutes on the northwest side of Lincoln Road, commencing at point 84 metres northeast of its intersection with Clarence Street South, and extending in a north-easterly direction for a distance of 11 metres. This restriction is to apply on Monday to Friday, 9:00am to 6:00pm and to apply on Saturday to Sunday, 8:00am to 6:00pm.
82. Approves that the stopping of vehicles be prohibited at any time on the northwest side of Lincoln Road commencing at a point 95 metres northeast of its intersection with Clarence Street South, and extending in a north-easterly direction to its intersection with Wise Street.

Wise Street to Bernard Street

83. Approves that the stopping of vehicles be prohibited at any time on the northwest side of Lincoln Road commencing at its intersection with Wise Street, and extending in a north-easterly direction for a distance of six metres.
84. Approves that the parking of vehicles be restricted to a maximum period of 60 minutes on the northwest side of Lincoln Road, commencing at point six metres northeast of its intersection with Wise Street, and extending in a north-easterly direction for a distance of 83 metres. This restriction is to apply on Monday to Friday, 9:00am to 6:00pm and to apply on Saturday to Sunday, 8:00am to 6:00pm.
85. Approves that the stopping of vehicles be prohibited at any time on the northwest side of Lincoln Road commencing at a point 89 metres northeast of its intersection with Wise Street, and extending in a north-easterly direction for a distance of 42 metres.

86. Approves that the parking of vehicles be restricted to a maximum period of 60 minutes on the northwest side of Lincoln Road, commencing at point 131 metres northeast of its intersection with Wise Street, and extending in a north-easterly direction for a distance of 38 metres. This restriction is to apply on Monday to Friday, 9:00am to 6:00pm and to apply on Saturday to Sunday, 8:00am to 6:00pm.
87. Approves that the stopping of vehicles be prohibited at any time on the northwest side of Lincoln Road commencing at a point 169 metres northeast of its intersection with Wise Street, and extending in a north-easterly direction to its intersection with Bernard Street.

Bernard Street to Moorhouse Avenue

88. Approves that the stopping of vehicles be prohibited at any time on the northwest side of Lincoln Road commencing at its intersection with Bernard Street, and extending in a north-easterly direction for a distance of 20 metres.
89. Approves that a Bus Stop be installed on the northwest side of Lincoln Road commencing at a point 20 metres northeast of its intersection with Bernard Street, and extending in a north-easterly direction for a distance of 16.5 metres.
90. Approves that the stopping of vehicles be prohibited at any time on the northwest side of Lincoln Road commencing at a point 37 metres northeast of its intersection Bernard Street, and extending in a north-easterly direction to its intersection with Moorhouse Avenue.

New Hazeldean Road – Lincoln Road to South-eastern Extent – Traffic Controls

91. Approves that a Give Way control be placed against Hazeldean Road at its intersection with Lincoln Road as detailed on **Attachment A**.

Existing Dickens Street – Lincoln Road to South-eastern Extent – Traffic Controls

92. Approves that the existing road layout including road markings, kerb alignments and road surface treatments on Dickens Street from its intersection with Lincoln Road, and extending in a south-easterly direction for a distance of 47 metres be revoked.

New Dickens Street – Lincoln Road to South-eastern Extent – Traffic Controls

93. Approves the road markings, kerb alignments, traffic island and road surface treatments on Dickens Street from its intersection with Lincoln Road, and extending in a south-easterly direction for a distance of 47 metres as detailed on **Attachment A**.
94. Approves that a Give Way control be placed against Dickens Street at its intersection with Lincoln Road as detailed on **Attachment A**.

Existing Dickens Street – Lincoln Road to South-eastern Extent - Parking and Stopping Restrictions

95. Approves that all parking and stopping restrictions on the northeast side of Dickens Street commencing at its intersection with Lincoln Road and extending in south-easterly direction for a distance of 47 metres be revoked.
96. Approves that all parking and stopping restrictions on the southwest side of Dickens Street commencing at its intersection with Lincoln Road and extending in south-easterly direction for a distance of 13 metres be revoked.

New Dickens Street – Lincoln Road to South-eastern Extent - Parking and Stopping Restrictions

97. Approves that the stopping of vehicles be prohibited at any time on the northeast side of Dickens Street commencing at its intersection with Lincoln Road, and extending in a south-easterly direction for a distance of 13 metres.
98. Approves that the parking of vehicles be restricted to a maximum period of 60 minutes on the northeast side of Dickens Street, commencing at point 13 metres southeast of its intersection with Lincoln Road, and extending in a south-easterly direction for a distance of 34 metres. This restriction is to apply on Monday to Friday, 8:00am to 6:00pm.
99. Approves that the stopping of vehicles be prohibited at any time on the southwest side of Dickens Street commencing at its intersection with Lincoln Road, and extending in a south-easterly direction for a distance of 13 metres.

Existing Parlane Street – Lincoln Road to South-eastern Extent – Traffic Controls

100. Approves that the existing road layout including the road markings, kerb alignment and road surface treatments on Parlane Street from its intersection with Lincoln Road, and extending in a south-easterly direction for a distance of 57 metres be revoked.

New Parlane Street – Lincoln Road to South-eastern Extent – Traffic Controls

101. Approves the road markings, kerb alignments and road surface treatments on Parlane Street from its intersection with Lincoln Road, and extending in a south-easterly direction for a distance of 57 metres as detailed on **Attachment A**.
102. Approves that a Give Way control be placed against Parlane Street at its intersection with Lincoln Road as detailed on **Attachment A**.

Existing Parlane Street – Lincoln Road to South-eastern Extent - Parking and Stopping Restrictions

103. Approves that all parking and stopping restrictions on the northeast side of Parlane Street commencing at its intersection with Lincoln Road extending in south-easterly direction for a distance of 57 metres be revoked.
104. Approves that all parking and stopping restrictions on the southwest side of Parlane Street commencing at its intersection with Lincoln Road extending in south-easterly direction for a distance of 50 metres be revoked.

New Parlane Street – Lincoln Road to South-eastern Extent - Parking and Stopping Restrictions

105. Approves that the stopping of vehicles be prohibited at any time on the northeast side of Parlane Street commencing at its intersection with Lincoln Road, and extending in a south-easterly direction for a distance of eight metres.
106. Approves that the parking of vehicles be restricted to a maximum period of 60 minutes on the northeast side of Parlane Street, commencing at point eight metres southeast of its intersection with Lincoln Road, and extending in a south-easterly direction for a distance of 49 metres. This restriction is to apply on Monday to Friday, 8:00am to 6:00pm.
107. Approves that the stopping of vehicles be prohibited at any time on the southwest side of Parlane Street commencing at its intersection with Lincoln Road, and extending in a south-easterly direction for a distance of eight metres.
108. Approves that the parking of vehicles be restricted to a maximum period of 60 minutes on the southwest side of Parlane Street, commencing at point eight metres southeast of its intersection with Lincoln Road, and extending in a south-easterly direction for a

distance of 31 metres. This restriction is to apply on Monday to Friday, 8:00am to 6:00pm.

Existing Spencer Street – Lincoln Road to South-eastern Extent – Traffic Controls

109. Approves that the existing road layout including road markings, kerb alignments and road surface treatments on Spencer Street from its intersection with Lincoln Road, and extending in a south-easterly direction for a distance of 67 metres be revoked.

New Spencer Street – Lincoln Road to South-eastern Extent – Traffic Controls

110. Approves the road markings, kerb alignments, traffic island and road surface treatments on Spencer Street from its intersection with Lincoln Road, and extending in a south-easterly direction for a distance of 67 metres as detailed on **Attachment A**.
111. Approves that a Give Way control be placed against Spencer Street at its intersection with Lincoln Road as detailed on **Attachment A**.

Existing Spencer Street – Lincoln Road to South-eastern Extent - Parking and Stopping Restrictions

112. Approves that all parking and stopping restrictions on the northeast side of Spencer Street commencing at its intersection with Lincoln Road extending in south-easterly direction for a distance of 67 metres be revoked.
113. Approves that all parking and stopping restrictions on the southwest side of Spencer Street commencing at its intersection with Lincoln Road extending in south-easterly direction for a distance of 42 metres be revoked.

New Spencer Street – Lincoln Road to South-eastern Extent - Parking and Stopping Restrictions

114. Approves that the stopping of vehicles be prohibited at any time on the northeast side of Spencer Street commencing at its intersection with Lincoln Road, and extending in a south-easterly direction for a distance of eight metres.
115. Approves that the parking of vehicles be restricted to a maximum period of 60 minutes on the northeast side of Spencer Street, commencing at point eight metres southeast of its intersection with Lincoln Road, and extending in a south-easterly direction for a distance of 59 metres. This restriction is to apply on Monday to Friday, 8:00am to 6:00pm.
116. Approves that the stopping of vehicles be prohibited at any time on the southwest side of Spencer Street commencing at its intersection with Lincoln Road, and extending in a south-easterly direction for a distance of 20 metres.
117. Approves that the parking of vehicles be restricted to 90 degree angle parking and further restricted to a maximum period of 60 minutes on the south-western side of Spencer Street, commencing at point 20 metres southeast of its intersection with Lincoln Road, and extending in a south-easterly direction for a distance of 22 metres. This restriction is to apply on Monday to Friday, 8:00am to 6:00pm.

Existing Clarence Street South– Lincoln Road to North-western Extent – Traffic Controls

118. Approves that the existing road layout including road markings, kerb alignments and road surface treatments on Clarence Street South from its intersection with Lincoln Road, and extending in a north-westerly direction for a distance of 70 metres be revoked.

New Clarence Street South – Lincoln Road to North-western Extent – Traffic Controls

119. Approves the road markings, kerb alignments and road surface treatments on Clarence Street South from its intersection with Lincoln Road, and extending in a north-westerly direction for a distance of 70 metres as detailed on **Attachment A**.
120. Approves that a Give Way control be placed against Clarence Street South Street at its intersection with Lincoln Road as detailed on **Attachment A**.

Existing Clarence Street South – Lincoln Road to North-western Extent - Parking and Stopping Restrictions

121. Approves that all parking and stopping restrictions on the northeast side of Clarence Street South commencing at its intersection with Lincoln Road extending in north-westerly direction for a distance of 36 metres be revoked.
122. Approves that all parking and stopping restrictions on the southwest side of Clarence Street South commencing at its intersection with Lincoln Road extending in north-westerly direction for a distance of 70 metres be revoked.

New Clarence Street South – Lincoln Road to North-western Extent - Parking and Stopping Restrictions

123. Approves that the stopping of vehicles be prohibited at any time on the northeast side of Clarence Street South commencing at its intersection with Lincoln Road, and extending in a north-westerly direction for a distance of 23 metres.
124. Approves that the parking of vehicles be restricted to a maximum period of 60 minutes on the northeast side of Clarence Street South, commencing at point 23 metres northwest of its intersection with Lincoln Road, and extending in a north-westerly direction for a distance of 11 metres. This restriction is to apply on Monday to Friday, 8:00am to 6:00pm.
125. Approves that the stopping of vehicles be prohibited at any time on the southwest side of Clarence Street South commencing at its intersection with Lincoln Road, and extending in a north-westerly direction for a distance of eight metres.
126. Approves that the parking of vehicles be restricted to a maximum period of 60 minutes on the northwest side of Clarence Street South, commencing at point eight metres northwest of its intersection with Lincoln Road, and extending in a north-westerly direction for a distance of 61 metres. This restriction is to apply on Monday to Friday, 8:00am to 6:00pm.

Existing Wise Street – Lincoln Road to North-western Extent – Traffic Controls

127. Approves that the existing road layout including road markings, kerb alignments and road surface treatments on Wise Street from its intersection with Lincoln Road, and extending in a north-westerly direction for a distance of 62 metres be revoked.

New Wise Street – Lincoln Road to North-western Extent – Traffic Controls

128. Approves the road markings, kerb alignments and road surface treatments on Wise Street from its intersection with Lincoln Road, and extending in a north-westerly direction for a distance of 62 metres as detailed on **Attachment A**.
129. Approves that a Give Way control be placed against Wise Street at its intersection with Lincoln Road as detailed on **Attachment A**.

Existing Wise Street – Lincoln Road to North-western Extent - Parking and Stopping Restrictions

130. Approves that all parking and stopping restrictions on the northeast side of Wise Street commencing at its intersection with Lincoln Road extending in north-westerly direction for a distance of 80 metres be revoked.
131. Approves that all parking and stopping restrictions on the southwest side of Wise Street commencing at its intersection with Lincoln Road extending in north-westerly direction for a distance of 62 metres be revoked.

New Wise Street – Lincoln Road to North-western Extent - Parking and Stopping Restrictions

132. Approves that the stopping of vehicles be prohibited at any time on the northeast side of Wise Street commencing at its intersection with Lincoln Road, and extending in a north-westerly direction for a distance of 80 metres.
133. Approves that the stopping of vehicles be prohibited at any time on the southwest side of Wise Street commencing at its intersection with Lincoln Road, and extending in a north-westerly direction for a distance of 10 metres.
134. Approves that the parking of vehicles be restricted to a maximum period of 60 minutes on the southwest side of Wise Street, commencing at point 10 metres northwest of its intersection with Lincoln Road, and extending in a north-westerly direction for a distance of 52 metres. This restriction is to apply on Monday to Friday, 8:00am to 6:00pm.

Existing Bernard Street – Lincoln Road to North-western Extent – Traffic Controls

135. Approves that the existing road layout including road markings, kerb alignments and road surface treatments on Bernard Street from its intersection with Lincoln Road, and extending in a north-westerly direction for a distance of 56 metres be revoked.

New Bernard Street – Lincoln Road to North-western Extent – Traffic Controls

136. Approves the road markings, kerb alignments, traffic islands and road surface treatments on Bernard Street from its intersection with Lincoln Road, and extending in a north-westerly direction for a distance of 56 metres as detailed on **Attachment A**.
137. Approves that a Give Way control be placed against Bernard Street at its intersection with Lincoln Road as detailed on **Attachment A**.

Existing Bernard Street – Lincoln Road to North-western Extent - Parking and Stopping Restrictions

138. Approves that all parking and stopping restrictions on the northeast side of Bernard Street commencing at its intersection with Lincoln Road extending in north-westerly direction for a distance of 51 metres be revoked.
139. Approves that all parking and stopping restrictions on the southwest side of Bernard Street commencing at its intersection with Lincoln Road extending in north-westerly direction for a distance of 56 metres be revoked.

New Bernard Street – Lincoln Road to North-western Extent - Parking and Stopping Restrictions

140. Approves that the stopping of vehicles be prohibited at any time on the northeast side of Bernard Street commencing at its intersection with Lincoln Road, and extending in a north-westerly direction for a distance of eight metres.
141. Approves that the parking of vehicles be restricted to a maximum period of 60 minutes on the northeast side of Bernard Street, commencing at a point eight metres northwest of its intersection with Lincoln Road, and extending in a north-westerly direction for a distance of 43 metres. This restriction is to apply on Monday to Friday, 8:00am to 6:00pm.

142. Approves that the stopping of vehicles be prohibited at any time on the southwest side of Bernard Street commencing at its intersection with Lincoln Road, and extending in a north-westerly direction for a distance of 14 metres.
143. Approves that the parking of vehicles be restricted to a maximum period of 60 minutes on the southwest side of Bernard Street, commencing at a point 14 metres northwest of its intersection with Lincoln Road, and extending in a north-westerly direction for a distance of 42 metres. This restriction is to apply on Monday to Friday, 8:00am to 6:00pm.
144. Recommend to that the parking Restrictions Subcommittee approve the following resolutions:

Councillor Clearwater/Councillor Galloway

Carried

Council Resolved CNCL/2019/00175 (continued)

Part A

That the Parking Restrictions Subcommittee approve the following parking and stopping restriction resolutions :

Existing Moorhouse Avenue – Selwyn Street to Grove Road - Parking and Stopping Restrictions

145. Approves that all parking and stopping restrictions on the south side of Moorhouse Avenue commencing at its intersection with Selwyn Street and extending in a westerly direction to its intersection with Grove Road be revoked.

New Moorhouse Avenue – Selwyn Street to Grove Road - Parking and Stopping Restrictions

146. Approves that the stopping of vehicles be prohibited at any time on the south side of Moorhouse Avenue commencing at its intersection with Selwyn Street, and extending in a westerly direction for a distance of 105 metres.
147. Approves that a Bus Stop be installed on the south side of Moorhouse Avenue commencing at a point 105 metres west of its intersection with Selwyn Street and extending in a westerly direction for a distance of 18 metres.
148. Approves that the stopping of vehicles be prohibited at any time on the south side of Moorhouse Avenue commencing at a point 123 metres west of its intersection with Selwyn Street, and extending in a westerly direction for a distance of 36 metres.
149. Approves that the parking of vehicles be restricted to a maximum period of 60 minutes on the south side of Moorhouse Avenue, commencing at point 159 metres west of its intersection with Selwyn Street, and extending in a westerly direction for a distance of 18.5 metres. This restriction is to apply Monday to Friday, 8:00am to 4:00pm and to apply Saturday to Sunday, 8:00am to 6:00pm.
150. Approves that the stopping of vehicles be prohibited on the south side of Moorhouse Avenue commencing at a point 159 metres west of its intersection with Selwyn Street, and extending in a westerly direction for a distance of 18.5 metres. This restriction is to apply Monday to Sunday, 10:00pm to 6:00am including Public Holidays.
151. Approves that the stopping of vehicles be prohibited at any time on the south side of Moorhouse Avenue commencing at a point 177.5 metres west of its intersection with Selwyn Street, and extending in a westerly direction for a distance of 42 metres.
152. Approves that the parking of vehicles be restricted to a maximum period of 60 minutes on the south side of Moorhouse Avenue, commencing at point 219.5 metres west of its intersection with Selwyn Street, and extending in a westerly direction for a distance of

18.5 metres. This restriction is to apply Monday to Friday, 8:00am to 4:00pm and to apply Saturday to Sunday, 8:00am to 6:00pm.

153. Approves that the stopping of vehicles be prohibited on the south side of Moorhouse Avenue commencing at a point 219.5 metres west of its intersection with Selwyn Street, and extending in a westerly direction for a distance of 18.5 metres. This restriction is to apply Monday to Sunday, 10:00pm to 6:00am including Public Holidays.
154. Approves that the stopping of vehicles be prohibited at any time on the south side of Moorhouse Avenue commencing at a point 230 metres west of its intersection with Selwyn Street, and extending in a westerly direction to its intersection with Grove Road.

Councillor Clearwater/Councillor Galloway

Carried

Councillors Gough, Johanson and Keown requested that their vote against the resolutions be recorded.

21. Rates Remissions for Northwood Gas Explosion

Council Resolved CNCL/2019/00176

The Council resolves that:

1. It is fair and equitable to provide a rates remission to those ratepayers most affected by the Northwood gas explosion event on 19 July 2019.
2. The remission will be 100 per cent of rates charged on the value of improvements (that is, rates will effectively be charged on land value only, as if the building had been demolished) for the period any property is unoccupied and uninhabitable due to damage caused by the gas explosion on 19 July 2019.
3. Affected ratepayers must apply for the remission in writing. Supporting evidence may be requested if council staff consider it necessary.
4. Any remissions will be back-dated to the date of departure from the property
5. Any remissions will cease on the earliest of:
 - (i) 30 June 2020, or
 - (ii) the date that the building becomes occupied again, or the date the building becomes able to be occupied, in the opinion of the relevant council staff
6. All administrative decisions relating to this remission are delegated to the Manager Transactions, Manager Funds and Financial Policy, and Head of Financial Management, including the decision on whether the criteria are met.
7. Request staff to undertake a review of the Rates Remission Policy to consider how land-value rating could apply for residential properties that become uninhabitable due to an event beyond the owner's control in order to achieve a more consistent and equitable approach to this issue, with the intention of it being in place for the 2020/21 Annual Plan.
8. Request staff report back with advice regarding how to deal with residential properties which may become uninhabitable due to an event beyond the owner's control in the current financial year 2019/20.

Mayor/Councillor Keown

Carried

The meeting adjourned at 1pm and reconvened at 2.04pm.

5. Global Settlement Agreement

Council Resolved CNCL/2019/00177

That the Council:

1. Notes that, consistent with previous Council decisions, senior Council staff have led a process with Crown officials to negotiate and recommend a global settlement with the Crown.
2. Notes that this process has included progress on determining and allocating the \$300m Christchurch Regeneration Acceleration Fund; as well as a preliminary and detailed due diligence exercise; and direct negotiation with the Crown in arriving at a proposed Global Settlement Agreement.
3. Notes the supplementary information provided following the hearing of Deputations on 6 August 2019 (in the memorandum dated 8 August 2019) that will be attached to Item 5, the Global Settlement Agreement, of the 8 August Council agenda.
4. Note the inclusion of summary financial payment information; budgeted opex maintenance comparison; advice on s77 and s97 of the LGA; and a number of additional matters raised through Deputations or directly by councillors.
5. Agrees to the Global Settlement Agreement detailed as Attachment D to the memorandum dated 8 August 2019 and as amended below:
 - a. Amend Schedule 1 by deleting clause 20.1(c) and deleting clause 25.1 and replacing it as detailed in this memorandum.
 - b. Amends Schedule 3, Clause 28.1(c) – “Sharing revenue 50/50 with the Crown” in the manner recommended by staff in the accompanying memorandum.
 - c. Amends Schedule 3 by deleting the Encumbrance Instrument in Schedule B of Schedule 3.
 - d. Amends Schedule 3 by deleting clauses 22.10 and 23.4.
 - e. Amends the Global Settlement Agreement proper (Clause 19(b)(iv)) to include the words “and ecological” after the word “environment”.
 - f. Amends Schedule 1, Clause 23.1 – “Bus Interchange Agreement” in the manner recommended by staff in the accompanying memorandum.
 - g. Amends Clause 20e by adding the words “Clause 4 and Schedule 1” in the last sentence before the words “Schedules 5 and 6” to ensure that these provisions of the cost sharing agreement do not become void and of no effect.
 - h. Amend the reference to Clause 1k to identify which payments were included in the Crown investment as a result of the Christchurch Earthquakes.
6. Delegates authority to:
 - a. the Mayor to sign the final agreement on behalf of Council once it has also been agreed by the Crown.
 - b. the Chief Executive to take the necessary steps to implement the terms and conditions of the Global Settlement Agreement, once signed.
 - c. the Mayor and General Manager Strategy and Transformation, to raise the matters of the unsuitability of the current exit clauses in LINZ RRZ leases and maintenance

of invasive species, with the responsible Minister (Associate Minister Williams) and LINZ officials, respectively.

- d. the Mayor and Deputy Mayor to negotiate any final matters on the Global Settlement Agreement directly with the Minister and/or Associate Minister, and notes that if the Crown wishes to make any material changes to the Agreement that this would require re-consideration and approval of the Council.
7. Notes that the three detailed investment cases that comprise the \$300m Christchurch Regeneration Acceleration Fund (Canterbury Multiuse Arena, \$220m; Avon Ōtākaro River Corridor regeneration funding, \$40m; and roading and transport infrastructure funding, \$40m) will now be completed and presented for endorsement to Council over coming months before final submission and approval by the Crown.

Mayor/Councillor Swiggs

Carried

Councillors Johanson and Keown requested that their votes against the resolutions be recorded.

17. Resolution to Exclude the Public

Council Resolved CNCL/2019/00178

That at 3.46pm the resolution to exclude the public set out on pages 214 to 215 of the agenda be adopted.

Mayor/Councillor Davidson

Carried

The public were re-admitted to the meeting at 4.12pm at which time the meeting concluded.

CONFIRMED THIS 22ND DAY OF AUGUST 2019

MAYOR LIANNE DALZIEL
CHAIRPERSON

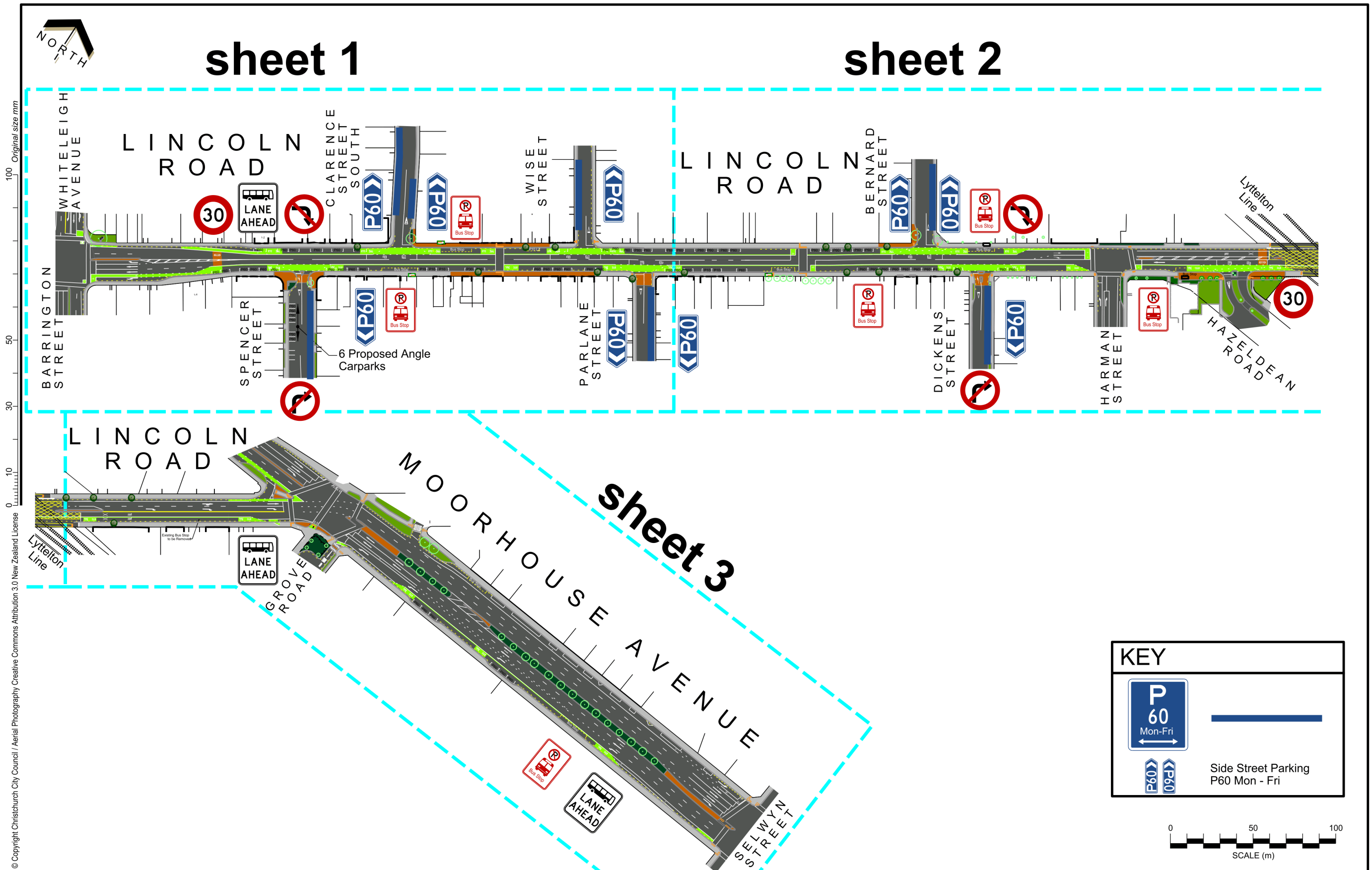

© Copyright Christchurch City Council / Aerial Photography Creative Commons Attribution 3.0 New Zealand License

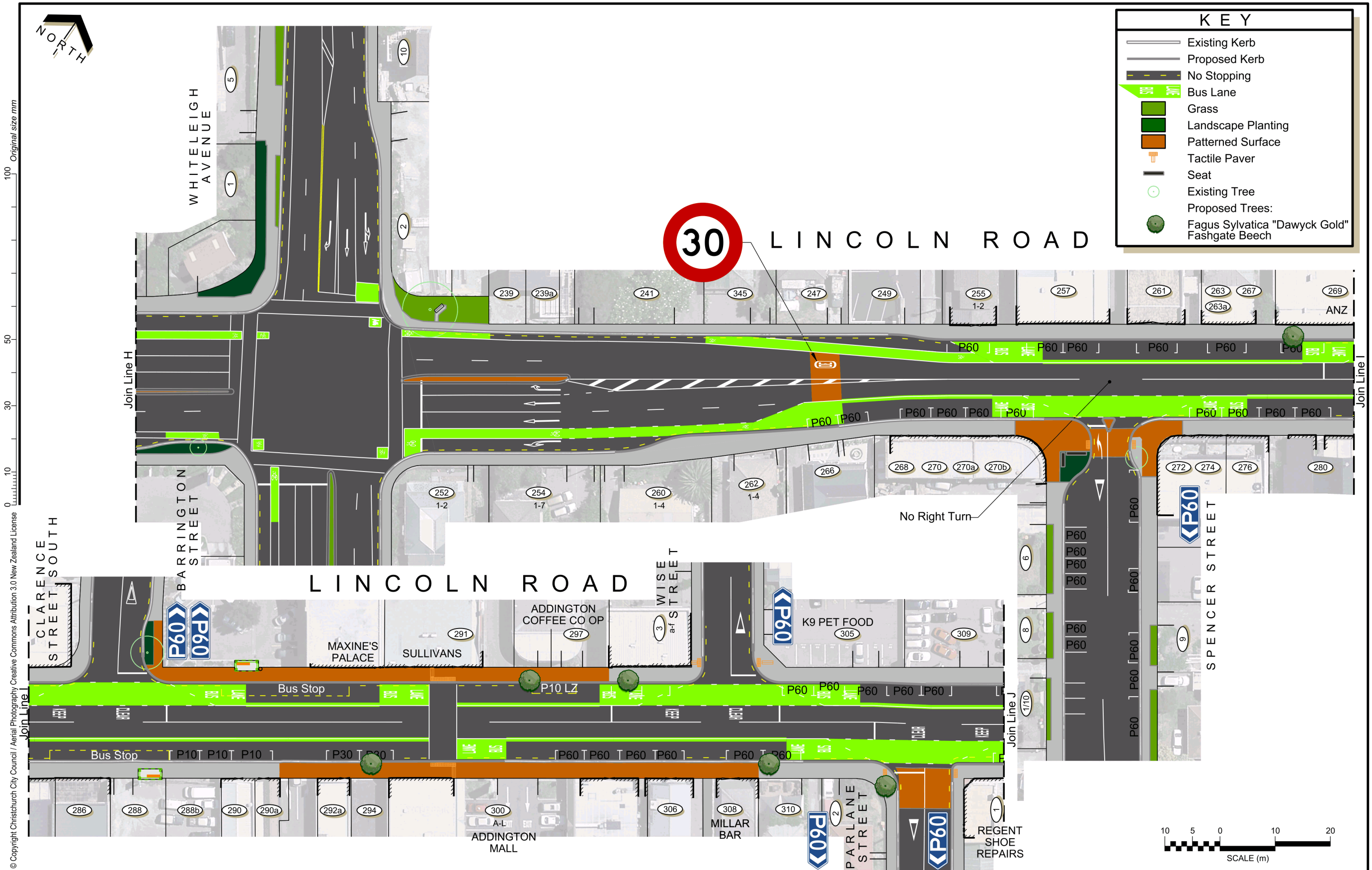

© Copyright Christchurch City Council / Aerial Photography Creative Commons Attribution 3.0 New Zealand License

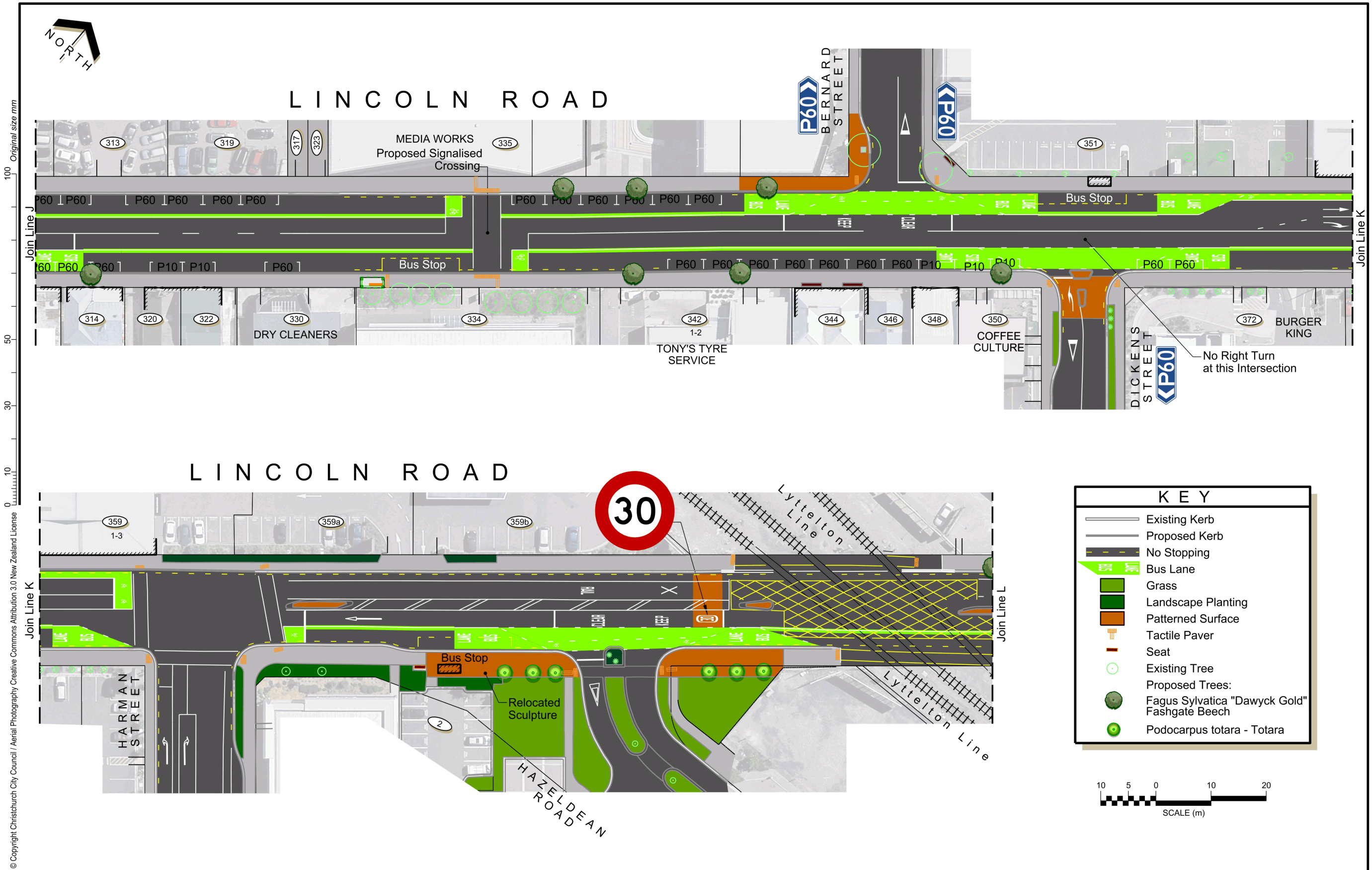

© Copyright Christchurch City Council / Aerial Photography Creative Commons Attribution 3.0 New Zealand License

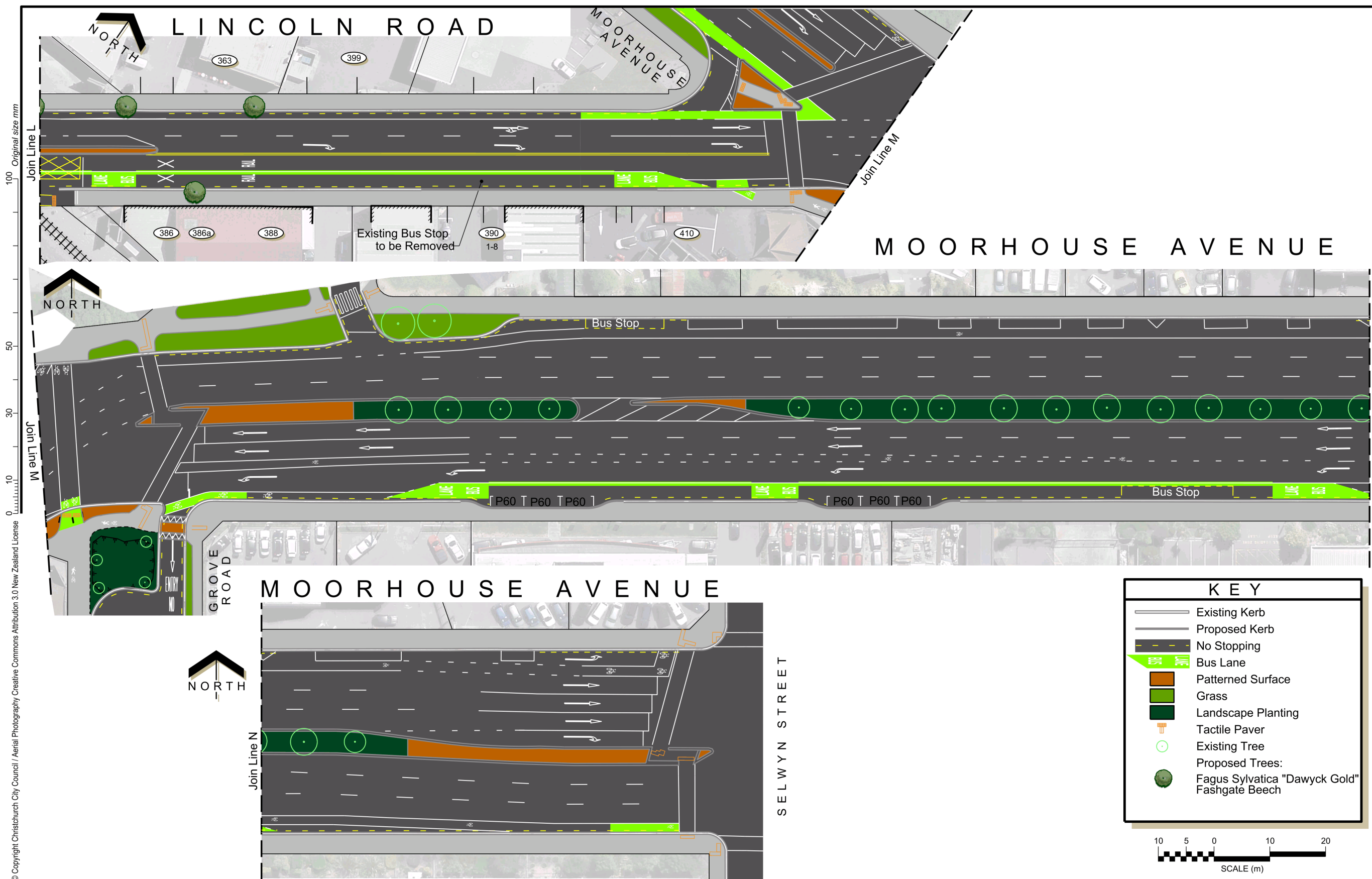

Christchurch City Council

Traffic and Parking Bylaw 2017



CHRISTCHURCH CITY COUNCIL TRAFFIC AND PARKING BYLAW 2017

Contents

1. Title
2. Commencement
3. Application
4. Purpose
5. Interpretation
6. Resolutions made under this bylaw

- Part 1: Parking
7. Stopping, Standing and Parking
8. Parking Places, Parking Buildings, Transport Stations and Zone Parking Areas
9. Temporary Discontinuance of a Parking Place
10. Residents' Parking
11. No Parking on certain parts of road
12. Motorhomes, immobilised vehicles and trailers
13. Storage of vehicles on road
14. Parking for display or sale
15. Working on vehicles

- Part 2: Traffic movement restrictions
16. One way streets/roads
17. Left or right turns and U-turns
18. Special vehicle lanes
19. Control of vehicles on roads
20. Shared zones
21. Shared paths
22. Restricting vehicles on unformed roads

- Part 3: Interference with road, traffic, pedestrians
23. Events on or affecting road
24. Other temporary use of legal road
25. Vehicle crossings
26. Temporary access ways

- Part 4: Speed Limits
27. Speed limits

- Part 5: Miscellaneous
28. Permissions under this bylaw
29. Material/Debris on roads and damage to roads
30. Vehicle Removal
31. Exempted Vehicles
32. Defences
33. Penalties
34. Revocations and Savings
35. Christchurch City Council General Bylaw
36. Consequential Amendment to Christchurch City Council Parks and Reserves Bylaw

CHRISTCHURCH CITY COUNCIL TRAFFIC AND PARKING BYLAW 2017

This bylaw is made under the Land Transport Act 1998, the Local Government Act 2002, and Part 4 is also made in accordance with the Land Transport Rule: Setting of Speed Limits 2017.

1. SHORT TITLE

(1) This bylaw is the Christchurch City Council Traffic and Parking Bylaw 2017.

2. COMMENCEMENT

(1) This bylaw comes into force on 1 March 2018.

3. APPLICATION

(1) This bylaw applies generally to all roads under the care, control and management of the Council.

4. PURPOSE

(1) The purpose of this bylaw is to set out the requirements for parking and control of vehicular or other traffic on any road or area under the care, control or management of the Council.

5. INTERPRETATION

(1) In this bylaw, unless the context otherwise requires,

ACT	means the Land Transport Act 1998 and the regulations and the rules made under that Act.
AUTHORISED OFFICER	means an officer or other person appointed by the Council to perform duties, or give permissions under this bylaw.
CLASS OF VEHICLE	means groupings of vehicles defined by reference to any common feature and includes - (a) vehicles by type, description, weight, size or dimension; (b) vehicles carrying specified classes of load by the mass, size or nature of such loads; (c) vehicles carrying no fewer or less than a specified number of occupants;

	(d) vehicles used for specified purposes;
	(e) vehicles driven by specified classes of persons;
	(f) carpool and shared vehicles; and
	(g) vehicles displaying a permit authorised by the Council.
CARRIAGEWAY	means that part of a road laid out for vehicular traffic as determined by the Council under section 319 of the Local Government Act 1974.
CORRIDOR ACCESS REQUEST (CAR)	means an application to carry out any work or activity that affects the normal operation of the road, footpath and grass berm prior to performing the work or activity.
COUNCIL	means the Christchurch City Council and includes any person authorised by the Council to act on its behalf.
DESIGNATED LOCATION	means, in accordance with section 8.2 of the Speed Limits Rule, any of the following: a car park, an educational or scientific institution; a commercial or industrial facility; a health facility; a residential facility; marae land; a camping ground; a sports facility or other recreational area; a botanical garden; a cultural reserve; a port or wharf area; an airport; a beach; a cemetery or urupā; a facility operated by the New Zealand Defence Force; a facility operated by the Department of Corrections; any other location approved by the New Zealand Transport Agency by notice in the Gazette.
ENFORCEMENT OFFICER	means - (a) any person who has been appointed as an enforcement officer by the Council under the Local Government Act 2002; or (b) any person who is an enforcement officer under the Land Transport Act 1998.
GRASS BERM	is the area behind a kerb which is laid out in grass.
IMMOBILISED VEHICLE	means any vehicle that cannot be moved on its own because it is mechanically not able to be moved or has a wheel or wheels missing from the vehicle.
MOTORHOME	means any vehicle designed or converted to be used for human habitation, whether self contained or not, and includes a caravan, campervan, or house truck.
PARKING COUPON or COUPON	means a coupon issued by or on behalf of the Council to any person for the purpose of parking a vehicle in accordance with the provisions of this bylaw.
PARKING MACHINE	means a parking meter or other device that is used to collect payment in exchange for parking a vehicle in a particular place for a limited time.

PARKING PLACE	means a place (including a building or a road) where vehicles, or any class of vehicles, may stop, stand, or park.
PARKING RECEIPT	means a receipt produced by a parking machine to indicate the payment of a parking fee for parking and the end of the period allowed.
SHARED PATH	<p>means a cycle path, a cycle track, a footpath, or some other kind of path that may be used by some or all or of the following persons at the same time -</p> <ul style="list-style-type: none"> (a) cyclists; (b) pedestrians; (c) riders of mobility devices; (d) riders of wheeled recreational devices.
SHARED ZONE	means a length of roadway intended to be used by pedestrians and vehicles (including cyclists).
SPEED LIMIT	<ul style="list-style-type: none"> (a) means in accordance with Part 2(1) of the Speed Limits Rule – <ul style="list-style-type: none"> (i) an urban, rural, permanent, holiday, temporary, emergency, or variable speed limit; and (ii) the maximum speed at which a vehicle may legally be operated on a particular road; but (b) does not mean the maximum permitted operating speed for classes or types of vehicle specified in any Act, regulation, or rule.
SPEED LIMITS RULE	means the Land Transport Rule: Setting of Speed Limits Rule 2017.
TRAFFIC MANAGEMENT PLAN	means a document describing the design, implementation, management, and removal of temporary traffic management measures (such as signs and road cones) while an activity or event is taking place within the road or adjacent to and affecting the road. This includes plans prepared for one-off events and generic plans to cover activities carried out frequently.
TRANSPORT STATION	has the same meaning as in section 591(6) of the Local Government Act 1974 <i>and generally means a place where transport-service vehicles may wait between trips, and all buildings and facilities associated with the use of that place.</i>
URBAN TRAFFIC AREA	means an area designated pursuant to the Speed Limits Rule that consists of one or more specified roads or a specified geographical area, to which the urban speed limit generally applies.
ZONE PARKING	has the same meaning as in Part 2 of the Land Transport Rule: Traffic Control Devices 2004.

ZONE PARKING AREA means an area where zone parking applies.

- (2) In this bylaw, unless the context otherwise requires -
- (a) **motor vehicle, owner, parking, road, and vehicle** have the same meanings as in section 2(1) of the Land Transport Act 1998; and
 - (b) **bus lane, cycle, cycle lane, cycle path, driver, emergency vehicle, footpath, mobility device, power assisted cycle, roadway, and special vehicle lane** have the same meanings as in clause 1.6 of the Land Transport (Road User) Rule 2004.
- (3) Any undefined words, phrases or expressions used in this bylaw have the same meaning as in the Act unless the context plainly requires a different meaning.
- (4) The Interpretation Act 1999 applies to the interpretation of this bylaw.
- (5) Explanatory notes are not part of the bylaw, and the Council may add, amend or delete explanatory notes at any time without amending the bylaw.

Explanatory note: Explanatory notes are used for a number of reasons, including to explain the intent of a clause in less formal language, to include additional helpful information, or because the information may be subject to change and need to be updated before the bylaw itself has to be updated.

6. RESOLUTIONS MADE UNDER THIS BYLAW

- (1) A resolution may be made under this bylaw -
- (a) to regulate, control or prohibit any matter or thing generally, or for any specific classes of case, or in a particular case; or
 - (b) that applies to all vehicles or traffic or to any specified class of vehicles or traffic using a road; or
 - (c) that applies to any road or part of a road, greenspace adjoining the road, building, or transport station under the care, control, or management of the Council; or
 - (d) that applies at any specified time or period of time.
- (2) The Council may subsequently amend or revoke any resolution made under this bylaw at any time.

PART 1

PARKING

7. STOPPING, STANDING AND PARKING

- (1) The Council may by resolution -
- (a) prohibit or restrict the stopping, standing or parking of vehicles, or any class of vehicles, on any road; or
 - (b) limit the stopping, standing or parking of vehicles on any road to any class of vehicles.
- (2) Any prohibition, restriction or limitation may be subject to such conditions as the Council thinks fit.

- (3) A person must not stop, stand or park a vehicle on any road in contravention of a prohibition, restriction or limitation made by the Council.

Explanatory note: Examples of restrictions include:

- *prohibiting parking on any roads (“No Stopping”);*
- *prohibiting heavy motor vehicles from parking on roads in residential areas;*
- *prohibiting trailers and motorhomes from parking in certain locations (e.g. next to slipway entrances); and*
- *providing for bus stops, taxi stands and loading zones.*

8. PARKING PLACES, PARKING BUILDINGS, TRANSPORT STATIONS AND ZONE PARKING AREAS

- (1) The Council may by resolution -

- (a) designate an area to be a zone parking area and the restrictions that apply in that zone parking area (“zone parking controls”); and
- (b) reserve any area of land or any road or any part of a road or any building or any part of a building owned or under the care, management or control of the Council to be a parking place or a transport station, subject to restrictions; and
- (c) specify the vehicles or classes of vehicle that can use or must not use a parking place or transport station or zone parking area; and
- (d) prescribe the restrictions that apply including (without limitation) the times, manner and other conditions for the parking of vehicles or classes of vehicles in a parking place or transport station or zone parking area; and
- (e) prescribe:
 - (i) any charges to be paid for the use of a parking place or transport station or in a zone parking area; and
 - (ii) the manner by which parking charges may be paid by the use of parking machines or in any other specified manner; and
- (f) make provision for the efficient management and control of a parking place or transport station or zone parking area.

- (2) Any restrictions that apply to a zone parking area, do not apply in locations within that zone parking area where other specific stopping, standing or parking restrictions apply.

- (3) Where the Council has prescribed a fee for parking in a parking place or transport station or zone parking area, any person parking there must -

- (a) pay the fee without delay and in the manner so prescribed; and
- (b) if a parking receipt or parking coupon, in paper form, states that it must be displayed in or on the vehicle, display the parking receipt or parking coupon in accordance with the instructions printed on it.

- (4) A person must not park a vehicle in a parking place or transport station or zone parking area in contravention of any prohibition or restriction made by the Council.

Explanatory note: This clause provides for both on-street and off-street parking that is subject to restrictions. Examples of restrictions include prescribing:

- *the number and location of parking spaces;*
- *when restrictions apply and the length of those restrictions; and*
- *parking charges and the method of payment for those charges.*

If the Council designates an area as a zone parking area, the parking restrictions in that zone may apply to a number of roads. Parking zones can apply in areas where people using vehicles within the area can reasonably be expected to be aware of the application of the parking restriction to the area, without the need for signs at each intersection within the area.

9. TEMPORARY DISCONTINUANCE OF A PARKING PLACE

- (1) If an authorised officer is of the opinion that any parking place should be temporarily discontinued as a parking place, the authorised officer may authorise the placement of a sign or other controls that sufficiently indicates "No Stopping" at such parking place.
- (2) If an authorised officer is of the opinion that any parking place should be temporarily discontinued as a parking place, except for the use by specified vehicles or classes of vehicle, the authorised officer may authorise the placement of a sign or other controls that sufficiently reserves parking, stopping or standing provisions for specified vehicles or classes of vehicles at such parking place.

Explanatory Note: From time to time, the Council may need to temporarily discontinue parking places and use those places for other temporary activities. For example, temporary bus stops, temporary bus lanes, and construction activity spaces.

- (3) No person may -
 - (a) stop or park a vehicle at:
 - (i) a parking place affected by a sign or other traffic controls under subclause (1); or
 - (ii) a parking place affected by a sign or traffic control under subclause (2) unless that person is specifically authorised by the authorised officer or complies with any specified condition by the sign or traffic control.
 - (b) remove any signs or traffic controls authorised under subclauses (1) or (2).
- (4) Any sign or traffic control installed under this clause must be removed after a period of three months from installation unless the Council, by resolution, has approved its continued use.

10. RESIDENTS' PARKING

- (1) The Council may by resolution reserve any specified parking place or places as -
 - (a) a residents' only parking area for the exclusive use of persons who reside in the vicinity; or
 - (b) a residents' exemption parking area for the use of persons who reside in the vicinity.

Explanatory note: residents with a residents' parking permit are exempt from general parking, stopping and standing restrictions in the exemption area, for example a parking place with time restrictions.

- (2) The Council may by resolution prescribe -
 - (a) any fees to be paid annually or in any other specified manner, for the use of a residents' parking area or a residents' exemption parking area; and
 - (b) the manner by which any such fees may be paid for the use of a residents' parking area or a residents' exemption area; and

- (c) which parking, stopping and standing restrictions permit holders are exempt from within a residents' exemption parking area.
- (3) Any person who parks a vehicle in a residents' only parking area must pay the prescribed residents' parking permit fee and display a current approved residents' parking permit so that it is clearly visible.
- (4) To be exempt from parking restrictions, including parking charges, any person who parks a vehicle in a residents' exemption parking area must pay the prescribed residents' parking permit fee and display a current approved residents' parking permit so that it is clearly visible.
- (5) A person must not park a vehicle in a residents' parking area in contravention of a prohibition or restriction made by the Council under this clause.

11. NO PARKING ON CERTAIN PARTS OF THE ROAD

- (1) A person must not stop, stand or park a motor vehicle, wholly or partially, on that part of any road which is laid out as a cultivated area, being a garden or grass berm.
- (2) A person must not stop, stand or park, wholly or partially, a motor vehicle on that part of any road which has been separated from the roadway by a kerb that is a paved or other surfaced landscaped area, with or without a planted area, and whether or not it is designed for use by pedestrians.
- (3) A person may stop, stand or park a motor vehicle in contravention of sub-clauses (1) and (2) if-
 - (a) that part of the road is designed and constructed to accommodate a parked vehicle; or
 - (b) an authorised officer has given written permission to stop, stand or park a vehicle in that part of the road; or
 - (c) the Council, by resolution, has allowed motor vehicles to stop, stand, or park in that part of the road.
- (4) Clause 6.2(2) of the Land Transport (Road User) Rule 2004 applies to this clause, and clause 6.2(1) of that Rule does not apply.

Explanatory Note: This clause still allows a person to stop, stand or park a motor vehicle off the roadway where there is no kerb unless otherwise restricted by signs and/or markings. For example, a person may park a motor vehicle off the roadway on a rural road on the grass verge or on a beachfront area.

All resolutions made under this clause by the Council will be recorded in a register which is available to members of the public on request

12. MOTORHOMES, IMMOBILISED VEHICLES AND TRAILERS

- (1) No person may park a motorhome, immobilised vehicle or trailer, whether or not the trailer is attached to another vehicle, on any road for a continuous period exceeding seven days without the prior written permission of an authorised officer.
- (2) Parking on any road for a continuous period exceeding seven days in sub-clause (1) includes parking on any road within 500 metres of the original parking place, at any time during the seven days.

Explanatory Note: The restriction on the parking of trailers to a maximum of seven days continuous period is consistent with Rule 6.19 of the Land Transport (Road User) Rule 2004.

13. STORAGE OF VEHICLES ON ROAD

- (1) No person (**Person A**) may place or park, or allow another person to place or park (**Person B**) a vehicle on any road for storage in connection with Person A's trade or business, whether or not the vehicle is owned by Person A.
- (2) Sub-clause (1) does not apply if Person A has the prior written permission of an authorised officer.

Explanatory Note: In order to constitute storage in connection with a person's trade or business, there will need to be the notion of "commercial advantage" of some kind. For example if a panel-beater or a mechanic is in the practice of parking their customers' vehicles in the street adjacent to their premises or a car dealer who parks vehicles for sale on the street. This clause is not intended to apply to customers parking on the street while undertaking a transaction at a premises.

14. PARKING FOR DISPLAY OR SALE

- (1) A person must not stop, stand or park a vehicle on any road or parking place -
 - (a) for the purpose of advertising a good or service to be provided elsewhere; or
 - (b) for the purpose of offering the vehicle for sale –unless the vehicle is being used for day to day travel.

15. WORKING ON VEHICLES

- (1) No person may stop, stand or park any vehicle on any road to carry out repairs unless those repairs are of a minor but urgent nature.

PART 2

TRAFFIC MOVEMENT RESTRICTIONS

16. ONE WAY STREETS/ROADS

- (1) The Council may by resolution specify any road or part of a road where vehicles must travel in one specified direction only.
- (2) No person may drive a vehicle in a manner that contravenes a restriction made under this clause.

Explanatory note: All resolutions made under this clause by the Council will be recorded in a register which is available to members of the public on request.

17. LEFT OR RIGHT TURNS AND U-TURNS

- (1) The Council may by resolution prohibit or restrict turning movements, including -
 - (a) vehicles or classes of vehicles on any road from turning to the right, or to the left, or from proceeding in any other direction; and
 - (b) vehicles turning from facing or travelling in one direction to facing or travelling in the opposite direction (performing a U-turn) on specified roads.
- (2) Any resolution made under this clause may specify the hours or days of the week that a restricted turning movement may be made (if any).
- (3) A person must not turn a vehicle to the left, or to the right, or perform a U-turn, or proceed in any other direction on any road where the Council has prohibited or restricted such movements.

18. SPECIAL VEHICLE LANES

- (1) The Council may by resolution prescribe a road, or a part of a road, as a special vehicle lane.
- (2) Any resolution made under this clause must specify, as the case may be -
 - (a) the type of special vehicle lane; and
 - (b) the hours of operation of the special vehicle lane (if any) when it is restricted to specific classes of vehicles.
- (3) A person must not use a special vehicle lane contrary to any restriction made by the Council under this clause.

Explanatory note: A special vehicle lane includes a bus, small passenger service vehicle or cycle lane.

19. CONTROL OF VEHICLES ON ROADS

- (1) The Council may by resolution prohibit or restrict, subject to such conditions as the Council thinks fit, any specified class of traffic or any specified motor vehicles or class of vehicle that, by reason of its size or nature or the nature of the goods carried, is unsuitable for use on any road or roads.
- (2) A person must not use a vehicle on a road, or any part of a road, contrary to a prohibition or restriction made by the Council under this clause.

Explanatory note: Under this clause, the Council could, for example, prohibit:

- *Heavy motor vehicles from using certain roads in the City, or*
- *Cycles from using busy roads in the City*

All resolutions made under this clause by the Council will be recorded in a register which is available on the Council's website

20. SHARED ZONES

- (1) The Council may by resolution specify any road or part of a road to be a shared zone.
- (2) Any resolution made under this clause may specify -
 - (a) whether the shared zone may be used by specified classes of vehicles;
 - (b) the days and hours of operation of the shared zone (if they differ from 24 hours per day, 7 days per week); and
 - (c) any other restrictions on how the shared zone is to be used by the public, including how traffic and pedestrians will interact.
- (3) Except where the Council has by resolution specified otherwise, no person may stand or park a vehicle in a road or part of a road specified as a shared zone.
- (4) No person may use a shared zone in a manner that contravenes a restriction made by the Council under this clause.

Explanatory note: All resolutions made under this clause by the Council will be recorded in a register which is available to members of the public on request

21. SHARED PATHS

- (1) The Council may by resolution —
 - (a) determine the length, route and/or location of a shared path; and
 - (b) determine priority for users on a shared path.
- (2) No person may use a shared path in a manner that contravenes a restriction made by the Council under this clause.

22. RESTRICTING VEHICLES ON UNFORMED ROADS

- (1) The Council may by resolution restrict the use of motor vehicles on unformed legal roads for the purposes of protecting the environment, or the road and adjoining land, or the safety of road users.
- (2) A person must not use a motor vehicle on an unformed legal road contrary to a restriction made by the Council under this clause.

Explanatory note: All resolutions made under this clause by the Council will be recorded in a register which is available on the Council's website

PART 3

INTERFERENCE WITH THE ROAD, TRAFFIC, OR PEDESTRIANS

Explanatory Note: Section 357 of the Local Government Act 1974 provides for a number of offences where a person encroaches on a road or damages a road without permission. For example, a person commits an offence where he or she, without permission, "encroaches on a road by making or erecting any building, fence, ditch, or other obstacle or work of any kind upon, over, or under the road, or by planting any tree or shrub thereon". It is open to the Council to bring enforcement action under this section or use the Council's other enforcement remedies under the Local Government Act 2002.

23. EVENTS ON OR AFFECTING THE ROAD

- (1) No person may hold an event that affects the normal operating conditions of a road, unless the person has prior written permission of an authorised officer.

Explanatory note: An event includes major public events (such as the Christchurch Marathon and the Santa Parade), as well as community events (including street parties). Organisers of all events held on or affecting public road need to apply to Council for an Events Permit and supply all necessary information to support an event permit application.

24. OTHER TEMPORARY USE OF LEGAL ROAD

- (1) No person may carry out a temporary act that affects the normal operating conditions of a road, unless the person has the prior written permission of an authorised officer.

Explanatory Note: Examples of temporary acts include operating construction equipment or machinery from the road, placing a shipping container/skip on the road; erecting temporary fencing or scaffolding on the road; and temporary art installations. Road within this context includes the footpath, berm, verge, carriageway, etc.

In certain cases, a Corridor Access Request (CAR) is required. For example, a CAR is required for digging, drilling, resurfacing, or doing any other activity that will alter, or cause to be altered, the surface of the road corridor. If there is any doubt, submit a CAR prior to carrying out any works or other activity.

- (2) If any object is placed on the road without permission under this clause or does not comply with the conditions of the permission, the Council may -
 - (a) request the owner to remove the object or repair the damage to the Council's satisfaction within 24 hours or a timeframe set by an authorised officer, or charge the owner for this work; and
 - (b) place adjacent to, or affix to, the object any safety or warning devices, and the costs of the safety or warning device will be charged to the owner of the object.
- (3) This clause does not apply to any object that may be placed on the road which has been authorised by the Council (for example, wheelie bins that are specifically for the purpose of Council rubbish collection).

- (4) This clause does not apply to stock droving or roadside grazing. The Christchurch City Council Stock on Roads Bylaw 2017, or any bylaw passed to replace it, covers stock on roads.

Explanatory note: All utility operators in legal road are generally covered under the CAR process, including those done during emergency situations. The CAR process reflects requirements in the Utilities Access Act 2010 and the National Code of Practice for Utility Operators' Access to Transport (Code). Where the utility operators occupy the legal road corridor to do their works, it is considered a worksite and an approved Traffic Management Plan is required.

25. VEHICLE CROSSINGS

- (1) No person may construct or alter any vehicle crossing across a footpath or a road unless the person has the prior written permission of an authorised officer.
- (2) Where the vehicle crossing will be a new crossing and there is a difference in level between the edge of the kerb or road seal on a formed road and the property boundary, then the standard of any works carried out on the road must be the standard that would be appropriate for a right-of-way to a new subdivision.
- (3) Where the vehicle crossing requires a structure on the road (for example a retaining wall, ramp or bridge), the applicant must also comply with the Christchurch City Council Public Places Bylaw 2008, or any bylaw passed to replace it, and any policies made under that bylaw.

Explanatory Note: By way of example, the Council's Structures on Roads Policy 2010 will be applicable here.

- (4) The applicant is responsible for all costs associated with the vehicle crossing construction and/or alteration and any other related structures.

26. TEMPORARY ACCESS WAYS

- (1) No person may construct or use a temporary access way across a footpath or a road unless the person has the prior written permission of an authorised officer.
- (2) Where a person is authorised to construct or use a temporary access way, the person must protect the footpath or road to ensure no damage occurs. This protection may be wooden planks 20mm thick plywood with minimum dimensions 1200mm by 2400mm, held and laid close together, steel plates, a combination of wooden and steel materials, or some other approved material.
- (3) Where damage occurs to a footpath or road as a result of a vehicle crossing it on an unprotected or inadequately protected point, the cost of repairing the road, including the footpath, is recoverable from the owner of the property, contractor undertaking the works, or person in charge of the vehicle.

Explanatory Note: the owner of the property, contractor undertaking the works, or person in charge of the vehicle must notify Council if damage is caused to the footpath. Damage to the road must be repaired to the Council's Construction Standard Specification (Part 6).

PART 4
SPEED LIMITS

27. SPEED LIMITS

- (1) For any roads under the Council's jurisdiction in accordance with Section 2.7 of the Speed Limits Rule, or any Rule passed to replace the Speed Limits Rule, the Council may, by resolution -
 - (a) set speed limits;
 - (b) designate urban traffic areas.
- (2) The Council may, by resolution, set speed limits for roads in any designated location under the Council's jurisdiction in accordance with Section 8.1 of the Speed Limits Rule, or any Rule passed to replace the Speed Limits Rule.

Explanatory Note: Section 2.8 of the Rule requires the Council to maintain a register of speed limits that records all speed limits, except temporary speed limits, and records all designated urban traffic areas for the roads under its jurisdiction. The register of speed limits must be available for inspection by members of the public. The Council's speed limits register including maps showing the designated urban traffic areas can be found on the Council website.

In accordance with Section 2.2 of the Rule the Council may set speed limits of 10, 20, 30, 40, 50, 60, 70, 80, 90, 100 or 110 km/h.

Part 5
MISCELLANEOUS

28. PERMISSIONS UNDER THIS BYLAW

- (1) The Council may set application fees for permissions under this bylaw and any application for a permission must be accompanied by the relevant application fee (if any).
- (2) An application for permission must be in writing, contain all information necessary for the authorised officer to consider issuing a permit, and be submitted in accordance with applicable Council policy.
- (3) Any permission under this bylaw may –
 - (a) include conditions (including the payment of ongoing fees and charges); and
 - (b) be granted by an authorised officer at the officer's discretion.
- (4) An authorised officer determining an application for permission may require the applicant to provide further information, such as (without limitation) a Traffic Management Plan, site location plan, and a Corridor Access Request.
- (5) The Council may, in its discretion, at any time, review any permission given under this bylaw.

- (6) Any breach of the conditions of a permission granted under this bylaw -
 - (a) may result in the permission being withdrawn (in accordance with the Council's General Bylaw 2008); and
 - (b) is a breach of this bylaw.

29. MATERIAL/DEBRIS ON ROADS AND DAMAGE TO ROADS

- (1) No person may cause damage to the road or to any associated signage.
- (2) Any material or debris deposited on the road must be removed as soon as practicable.
- (3) The Council may give any person who has damaged, or deposited material or debris on a road notice:
 - (a) to remove that material or debris from the road or to repair the damage caused to the road to Council's satisfaction, within 24 hours; and
 - (b) that if the person does not comply, that person commits a further breach of this bylaw and the Council may undertake the work and recover all costs from that person.
- (4) Subclauses (2) and (3) do not apply to faecal matter deposited on the road by stock. The Christchurch City Council Stock on Roads Bylaw 2017, or any bylaw passed to replace it, applies to faecal matter deposited on the road from stock.

Explanatory Note: Section 357 of the Local Government Act 1974 provides for a number of offences where a person encroaches on a road or damages a road without permission. It is open to the Council to bring enforcement action under this section or use the Council's other enforcement remedies under the Local Government Act 2002.

30. VEHICLE AND OBJECT REMOVAL

- (1) An enforcement officer may remove or cause to be removed any vehicle or other thing from any road, or other area controlled by the Council, which contravenes this bylaw, or any resolution made under this bylaw, and the Council may recover from the person committing the breach of this bylaw all expenses incurred in connection with the removal of the offending vehicle or thing.
- (2) The powers that may be exercised under this clause are in addition to those provided by any other enactment.

31. EXEMPTED VEHICLES

- (1) This bylaw does not apply to any of the following vehicles being used in the execution of duty:
 - (a) an emergency vehicle; or
 - (b) a vehicle that is used by a Parking Warden/Officer; or
 - (c) a vehicle that is used by an enforcement officer.

32. DEFENCES

- (1) A person is not in breach of this bylaw if that person proves:
 - (a) that the act complained of was done in an emergency on the road or immediately adjoining the road; or
 - (b) that the act complained of was done in compliance with the directions of a Police Officer, Parking Warden/Officer, authorised officer, traffic control signal or traffic sign.

33. PENALTIES

- (1) Every person who breaches this bylaw (including any control, restriction, limitation or prohibition made under this bylaw) commits an offence under the Act, or the Local Government Act 2002 and is liable to the penalties set out in the relevant Act.

34. REVOCATIONS AND SAVINGS

- (1) The following bylaws are revoked:
 - (a) Christchurch City Council Traffic and Parking Bylaw 2008:
 - (b) Christchurch City Council Speed Limits Bylaw 2010.
- (2) Any approval, permit or other act of authority which originated under or was continued by either of the bylaws revoked in subclause (1) that is continuing at the commencement of this bylaw, continues to have full force and effect for the purposes of this bylaw, but is subject to the application of any relevant clauses in this bylaw.
- (3) The resolutions of the Council made or continued under the bylaws revoked under subclause (1) continue to have full force and effect for the purposes of this bylaw as if they were resolutions made under this bylaw.
- (4) The contents of the First, Second, Third, and Fourth Schedules of the Christchurch City Council Traffic and Parking Bylaw 2008 continue for the purposes of this bylaw to have full force and effect as if the content of those schedules were made by resolution of the Council under this bylaw, and any notices given by the Council under clause 12(8) of the Christchurch City Council Traffic and Parking Bylaw 2008 continue for the purposes of this bylaw to have full force and effect until the Council resolves otherwise under this bylaw.
- (5) The revocation of the bylaws under subclause (1) do not prevent any legal proceedings, criminal or civil, being taken to enforce those bylaws or any speed limit set under the Speed Limits Bylaw and such proceedings continue to be dealt with and completed as if the bylaws had not been revoked.

35. CHRISTCHURCH CITY COUNCIL GENERAL BYLAW

- (1) The provisions of the Christchurch City Council General Bylaw 2008 and any bylaw passed in amendment or substitution are implied into and form part of this bylaw.

36. CONSEQUENTIAL AMENDMENT TO CHRISTCHURCH CITY COUNCIL PARKS AND RESERVES BYLAW

- (1) The Christchurch City Council Parks and Reserves Bylaw 2016 is amended by replacing clause 9.3 with the following clause:

- 9.3 Any place in a reserve that has been set aside for the parking of vehicles may be subject to parking restrictions under the Christchurch City Council Traffic and Parking Bylaw 2017.

The initial resolution to make this bylaw was passed by the Christchurch City Council at a meeting of the Council held on 3 August 2017 and was confirmed following consideration of submissions received during the special consultative procedure, by a resolution of the Council at a subsequent meeting of the Council held on 23 November 2017.
